

B

(SUBMIT IN TRIPPLICATE)

UNITED STATES  
DEPARTMENT OF THE INTERIOR  
GEOLOGICAL SURVEY

Budget Bureau No. 42-R358.4.  
Form Approved.

Land Office **Santa Fe**  
Lease No. **078496**  
Unit **San Juan 28-7 Unit**

SUNDRY NOTICES AND REPORTS ON WELLS

NOTICE OF INTENTION TO DRILL	<input checked="" type="checkbox"/>	SUBSEQUENT REPORT OF WATER SHUT-OFF
NOTICE OF INTENTION TO CHANGE PLANS		SUBSEQUENT REPORT OF SHOOTING OR ACIDIZING
NOTICE OF INTENTION TO TEST WATER SHUT-OFF		SUBSEQUENT REPORT OF ALTERING CASING
NOTICE OF INTENTION TO RE-DRILL OR REPAIR WELL		SUBSEQUENT REPORT OF RE-DRILLING OR REPAIR
NOTICE OF INTENTION TO SHOOT OR ACIDIZE		SUBSEQUENT REPORT OF ABANDONMENT
NOTICE OF INTENTION TO PULL OR ALTER CASING		SUPPLEMENTARY WELL HISTORY
NOTICE OF INTENTION TO ABANDON WELL		

**RECEIVED**  
OCT 31 1962  
U. S. GEOLOGICAL SURVEY  
FARMINGTON, NEW MEXICO

(INDICATE ABOVE BY CHECK MARK NATURE OF REPORT, NOTICE, OR OTHER DATA)

October 30, 1962

Well No. 133 is located 990 ft. from ~~XXXX~~ line and 1460 ft. from ~~XXXX~~ line of sec. 35.

SW/4 Sec. 35  
(1/4 Sec. and 1/4 Sec. No.)

28N  
(Twp.)

7W  
(Range)

N.M.P.M.  
(Meridian)

Basin Dakota  
(Field)

Rio Arriba  
(County or Subdivision)

New Mexico  
(State or Territory)

The elevation of the derrick floor above sea level is 6102 ft.

DETAILS OF WORK

(State names of and expected depths to objective sands, shales, sizes, weights, and lengths of proposed casings; indicate mudding jobs, cementing points, and all other important proposed work)

It is intended to mud drill a well with rotary tools thru the Dakota formation and to perforate and fracture possible producing zones. Est. T. D. 7242'.

Casing Program:

- 10 3/4" @ 300' w/232 sks. cement circulated to surface.
- 4 1/2" @ 7242' w/2 & 3 stage collars. Set 2nd stage collar 50' - 100' below base of Mesa Verde; 3rd stage 50' - 100' below base of Pictured Cliffs.
- Cement first stage w/216 sacks to cover 200' above Greenhorn.
- Second stage w/195 sks. to cover 100' above Cliff House.
- Third stage w/168 sks. to cover Ojo Alamo.

The W/2 of Section 35 is dedicated to this well.

I understand that this plan of work must receive approval in writing by the Geological Survey before operations may be commenced.

Company El Paso Natural Gas Company

Address Box 990

Farmington, New Mexico

By

Title

Petroleum Engineer

## NEW MEXICO OIL CONSERVATION COMMISSION

## Well Location and Acreage Dedication Plat

Section A.

Date **OCTOBER 29, 1962**

Operator **EL PASO NATURAL GAS COMPANY** Lease **SAN JUAN 28-7 UNIT** **SF078496**  
 Well No. **133** Unit Letter **N** Section **35** Township **28-N,** Range **7-W** NMPM  
 Located **990** Feet From **SOUTH** Line, **1460** Feet From **WEST** Line  
 County **SAN JUAN** G. L. Elevation **6092** Dedicated Acreage **324.70** Acres  
 Name of Producing Formation **DAKOTA** Pool **BASIN DAKOTA**

1. Is the Operator the only owner in the dedicated acreage outlined on the plat below?  
 Yes ☒ No
2. If the answer to question one is "no", have the interests of all the owners been consolidated by community unit agreement or otherwise? Yes No If answer is "yes", Type of Consolidation.

3. If the answer to question two is "no", list all the owners and their respective interests below:

Owner Land Description



Section B.

This is to certify that the information in Section A above is true and complete to the best of my knowledge and belief.

**El Paso Natural Gas Company**  
 (Operator)

**ORIGINAL SIGNED H.E. McANALLY**  
 (Representative)

**Box 990**  
 (Address)

**Farmington, New Mexico**

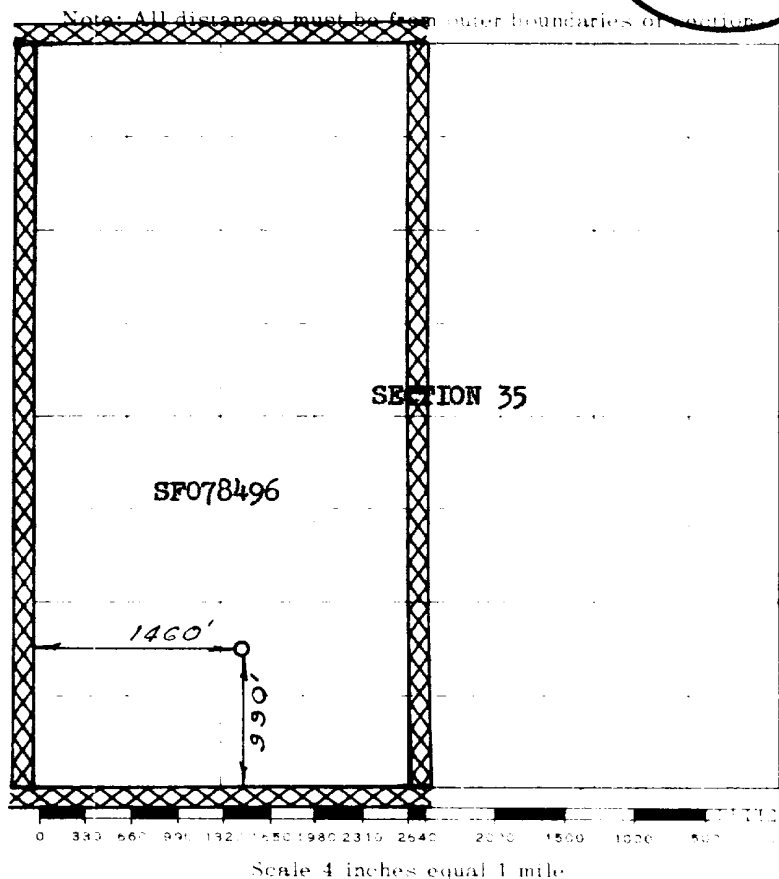

This is to certify that the above plat was prepared from field notes of actual surveys made by me or under my supervision and that the same are true and correct to the best of my knowledge and belief.

(Seal)

Date Surveyed **OCTOBER 24, 1962**

*David L. Jones*  
 Registered Professional Engineer and/or Land Surveyor

Farmington, New Mexico