

- 3 - WASH
2 - MINNESOTA
1 - State Land Office
1 - L.O. Study (SUBMIT IN TRIPLICATE)
1 - File

Budget Bureau No. 42-R358.4
Approval expires 12-31-60.

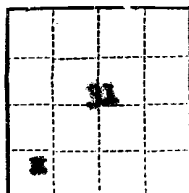

UNITED STATES
DEPARTMENT OF THE INTERIOR
GEOLOGICAL SURVEY

Land Office Santa Fe
Lease No. ST-079732
Unit 14-02-001-231

SUNDRY NOTICES AND REPORTS ON WELLS

NOTICE OF INTENTION TO DRILL	<input checked="" type="checkbox"/>	SUBSEQUENT REPORT OF WATER SHUT-OFF	
NOTICE OF INTENTION TO CHANGE PLANS		SUBSEQUENT REPORT OF SHOOTING OR ACIDIZING	
NOTICE OF INTENTION TO TEST WATER SHUT-OFF		SUBSEQUENT REPORT OF ALTERING CASING	
NOTICE OF INTENTION TO RE-DRILL OR REPAIR WELL		SUBSEQUENT REPORT OF RE-DRILLING OR REPAIR	
NOTICE OF INTENTION TO SHOOT OR ACIDIZE		SUBSEQUENT REPORT OF ABANDONMENT	
NOTICE OF INTENTION TO PULL OR ALTER CASING		SUPPLEMENTARY WELL HISTORY	
NOTICE OF INTENTION TO ABANDON WELL			

(INDICATE ABOVE BY CHECK MARK NATURE OF REPORT, NOTICE, OR OTHER DATA)

July 9th, 1958

S.J. 25-4 Unit
Well No. 12-31 is located 930 ft. from N line and 990 ft. from W line of sec. 31

SW/4 SW/4 Sec. 31 20 North 4 West N.M.P.M.
(1/4 Sec. and Sec. No.) (Twp.) (Range) (Meridian)

Blanco Mesa Verde Rio Arriba New Mexico
(Field) (County or Subdivision) (State or Territory)

The elevation of the ground above sea level is 7323 ft.

DETAILS OF WORK

(State names of and expected depths to objective sands; show sizes, weights, and lengths of proposed casings; indicate mudlogging jobs, cementing points, and all other important proposed work)

Propose to drill to 200' and set 10-3/4" casing, cement to surface. Set 7-5/8" casing to 120', cement w/150 lb w/8% gel and 50 lb w/8% CaCl. Set 5-1/2" liner @ 6750', cement w/200 lb w/1% floccs per sz.

Propose to drill with water or minimum mud to 7-5/8" casing point and gas to T.B.

Reservoir to be fractured thru perforations using approximately 150,000 gallons of water and 50,000# of sand. Clean out to total depth, set tubing and complete well.

The 1/2 of Section 31, containing 315.82 acres, is dedicated to this well.

100% Pacific Northwest Pipeline Corp. Contractor: Arapahoe Drilling Company

I understand that this plan of work must receive approval in writing by the Geological Survey before operations may be commenced.

Company PACIFIC NORTHWEST PIPELINE CORPORATION

Address 418 1/2 West Broadway

Farmington, New Mexico

By Original signed by Geo. H. Pappin

Title District Production Engineer

NEW MEXICO OIL CONSERVATION COMMISSION

Well Location and Acreage Dedication Plat

Section A.

Date JUNE 11, 1958

Operator PACIFIC NORTHWEST PIPELINE CORPORATION Lease SAN JUAN 28-4 UNIT SF 079732
 Well No. 18-31 Unit Letter M Section 31 Township 28-N Range 4-W NMPM
 Located 990 Feet From SOUTH Line, 990 Feet From WEST Line
 County RIO ARriba G. L. Elevation 7323 Dedicated Acreage 319.82 Acres
 Name of Producing Formation MESA VERDE Pool BLANCO MESA VERDE

1. Is the Operator the only owner in the dedicated acreage outlined on the plat below?
 Yes ☒ No ☐
2. If the answer to question one is "no", have the interests of all the owners been consolidated by communitization agreement or otherwise? Yes ☐ No ☐ If answer is "yes", Type of Consolidation.

3. If the answer to question two is "no", list all the owners and their respective interests below:

Owner

Land Description

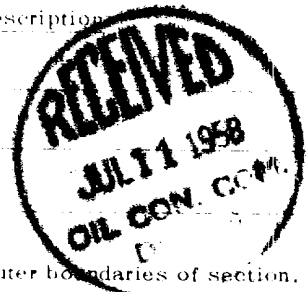

Section B.

Note: All distances must be from outer boundaries of section.

This is to certify that the information in Section A above is true and complete to the best of my knowledge and belief.

PACIFIC NORTHWEST PIPELINE CORP.
 (Operator)

Original signed by Geo. E. Poppin
 (Representative)

418 1/2 West Broadway
 (Address)

Farmington, New Mexico

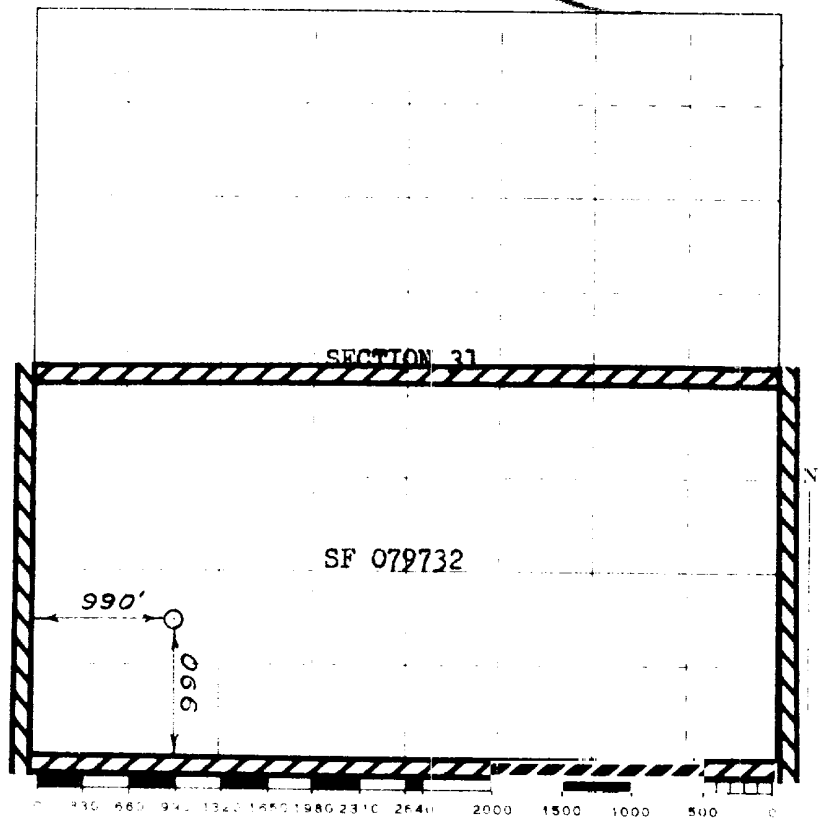

Scale 4 inches equal 1 mile

This is to certify that the above plat was prepared from field notes of actual surveys made by me or under my supervision and that the same are true and correct to the best of my knowledge and belief.

(Seal)

Date Surveyed JUNE 9, 1958

Farmington, New Mexico

E. O. Walker
 Registered Professional Engineer and of Land Surveyor