

WELL LOCATION AND PLAT INFORMATION PLAT

JUNE 19, 1956

EL PASO NATURAL GAS COMPANY

SAN JUAN 28-7 UNIT

SF 078498

45

27

28-N

7-W

1700

SOUTH

1050

WEST

RIO ARRIBA

6080

MESA VERDE

BLANCO

320 ACRES
(1917 PLAT)

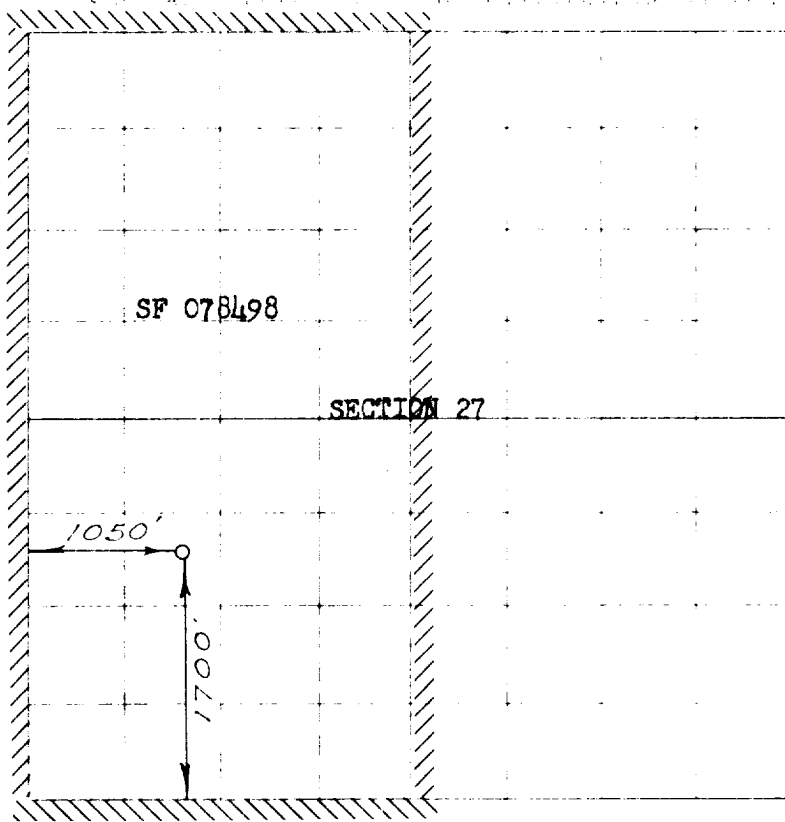

NOTE
The location of
this well is shown
on the well plat.

I hereby certify that the above plat was prepared by
field notes and original surveys made by me or an authorized
surveyor and that the same are true and correct to the
best of my knowledge and belief.

Date Surveyed MAY 18, 1956

C. O. Walker

Registered Professional Engineer and of Land Surveyor

1. Is this well a Dry Well?

Yes No

2. If the answer to question 1

is "Yes" are there any other wells
completed well within the
dedicated acreage?

Yes No

Edward M. [Signature]

Petroleum Engineer

Position

El Paso Natural Gas Co.

Representing

Box 997, Farmington, N.M.

Address