

(SUBMIT IN TRIPLICATE)

UNITED STATES
DEPARTMENT OF THE INTERIOR
GEOLOGICAL SURVEY

Land Office _____

Lease No. **SF-079050-A**

Unit _____

~~XXXXXXXXXXXX~~

San Juan Unit 25-6

SUNDRY NOTICES AND REPORTS ON WELLS

NOTICE OF INTENTION TO DRILL.....	<input checked="" type="checkbox"/>	SUBSEQUENT REPORT OF WATER SHUT-OFF.....	
NOTICE OF INTENTION TO CHANGE PLANS.....		SUBSEQUENT REPORT OF SHOOTING OR ACIDIZING.....	
NOTICE OF INTENTION TO TEST WATER SHUT-OFF.....		SUBSEQUENT REPORT OF ALTERING CASING.....	
NOTICE OF INTENTION TO RE-DRILL OR REPAIR WELL.....		SUBSEQUENT REPORT OF RE-DRILLING OR REPAIR.....	
NOTICE OF INTENTION TO SHOOT OR ACIDIZE.....		SUBSEQUENT REPORT OF ABANDONMENT.....	
NOTICE OF INTENTION TO PULL OR ALTER CASING.....		SUPPLEMENTARY WELL HISTORY.....	
NOTICE OF INTENTION TO ABANDON WELL.....			

(INDICATE ABOVE BY CHECK MARK NATURE OF REPORT, NOTICE, OR OTHER DATA)

September 12, 19 63

Well No. **102** is located **1850** ft. from **[N]** line and **790** ft. from **[E]** line
SE/4 NE/4 Sec. **26** **28N** **6W** **NMPM**
(1/4 Sec. and Sec. No.) (Twp.) (Range) (Meridian)
Basin Dakota **Rio Arriba** **New Mexico**
(Field) (County or Subdivision) (State or Territory)



The elevation of the ~~Arriba~~ above sea level is **6650** ft. G. L.

DETAILS OF WORK

(State names of and expected depths to objective sands; show sizes, weights, and lengths of proposed casings; indicate mudding jobs, cementing points, and all other important proposed work)

Propose to drill to an estimated depth of 8000 feet or to test the Dakota formation. Casing program will be as follows:

9 5/8" 36.00# Spang surface casing set at approximately 200' w/200 sx cement to be circulated.

4 1/2" 10.50# & 11.60# casing set at approximately 8000' /,

1st stage

150 sx regular cement / 1% Halad #9. 2nd stage Set DV tool below Point Lookout & cement to protect the Mesaverde cemented w/300 cu. ft. 50-50 pozmix & class C cement. 3rd stage Set DV tool below Pictured Cliffs cement w/350 cu. ft. 50-50 pozmix and class C cement.

Will perforate and sand water frac the Dakota formation.

I understand that this plan of work must receive approval in writing by the Geological Survey before operations may be commenced.

Company **Beta Development Co.**

Address **234 Petr. Club Plaza**

Farmington, New Mexico

By *John S. Haupt*
 Title **Manager**

NEW MEXICO OIL CONSERVATION COMMISSION
Well Location and Acreage Dedication Plat

SECTION A.

Date September 12, 1963

Operator Beta Development Company Lease ~~Multiple Dakota~~ S 11 28-6
Well No. 102 Unit Letter H Section 26 Township 28 North Range 6 West NMPM
Located 1850 Feet From North Line, 790 Feet From East Line
County Rio Arriba G. L. Elevation 6650 Dedicated Acreage 1/320 Acres
Name of Producing Formation Dakota Pool Basin Dakota

1. Is the Operator the only owner* in the dedicated acreage outlined on the plat below? Yes No
2. If the answer to question One is "No," have the interests of all the owners been consolidated by communitization agreement or otherwise? Yes No If answer is "Yes," Type of Consolidation _____

3. If the answer to question Two is "No," list all the owners and their respective interest _____

OWNER

LAND DESCRIPTION

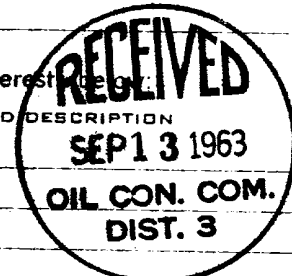

SECTION B.

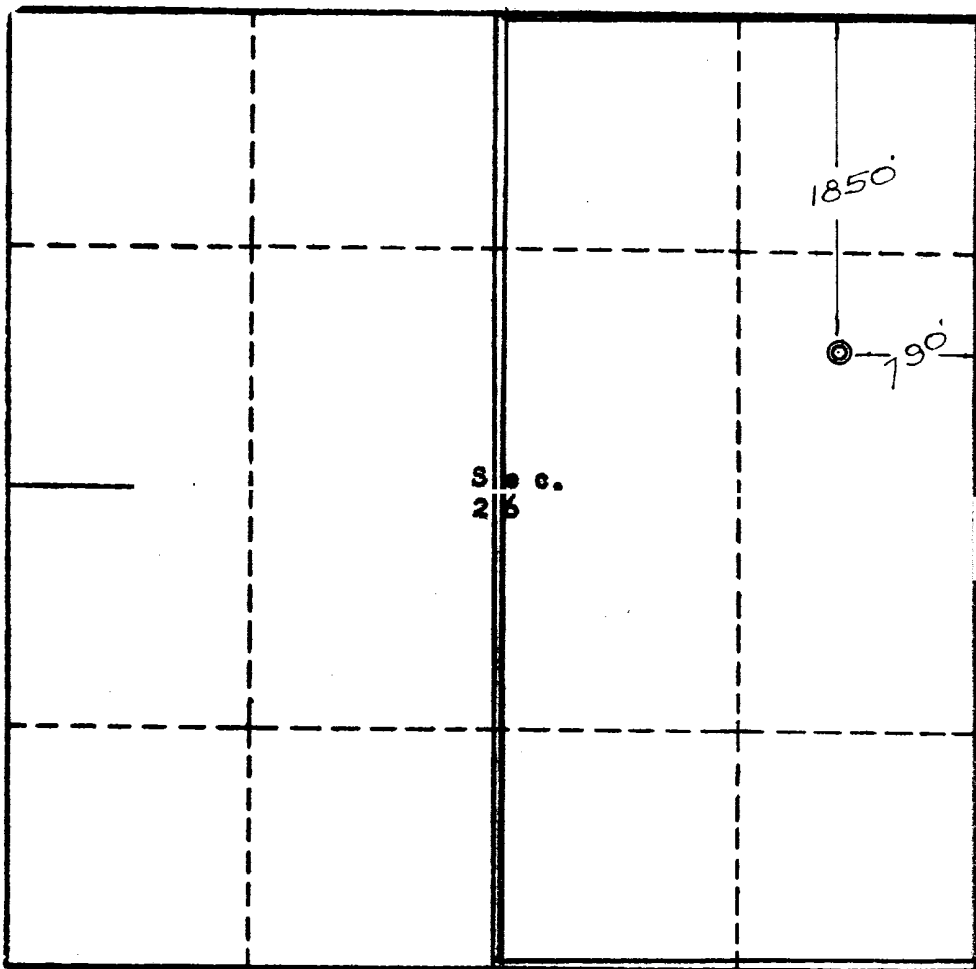

This is to certify that the information in Section A above is true and complete to the best of my knowledge and belief.

Beta Development Co.

(OPERATOR)
John J. Flunty
(REPRESENTATIVE)
Manager
234 Petr. Club Plaza
Farmington, N. M.

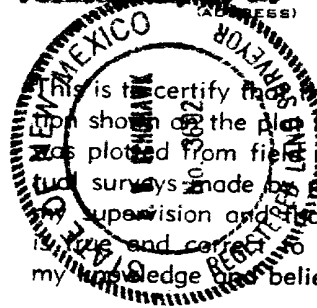

This is to certify that the well location shown on the plat in Section B was plotted from field notes of actual surveys made by me or under my supervision and that the same are true and correct to the best of my knowledge and belief.

Date Surveyed Sept. 11, 1963
Four States Engineering Co.
FARMINGTON, NEW MEXICO

Conrad N. Cook, Rank
REGISTERED ENGINEER OR
LAND SURVEYOR

Certificate No. 3602

