



 COPY TO O.G.C.

IN REPLY REFER TO:

UNITED STATES
DEPARTMENT OF THE INTERIOR
GEOLOGICAL SURVEY
P. O. Box 965
Farmington, New Mexico

March 10, 1956

Pacific Northwest Pipeline Corporation
413 1/2 West Main
Farmington, New Mexico

Re: Santa Fe 079193
14-08-001-1051

Gentlemen:

Receipt is acknowledged of your "Notice of Intention to Drill" dated March 7, 1956 covering your well No. 60-21 San Juan 28-6 Unit in NE 1/4 sec. 21, T. 28 N., R. 6 W., N. M. P. M., Rio Arriba County, New Mexico, Blanco Mesa Verde pool.

Your proposed work is hereby approved subject to compliance with the provisions of the "Oil and Gas Operating Regulations" revised May 25, 1942, a copy of which will be sent to you on request, and subject to the following conditions:

1. Drilling operations so authorized are subject to the attached sheet for general conditions of approval.
2. Furnish copies of all logs.

Very truly yours,

(Orig. Sgd.) J. W. LONG

Jerry W. Long
Acting District Engineer



LONG: 22

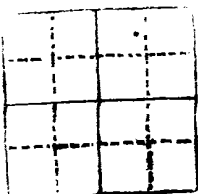

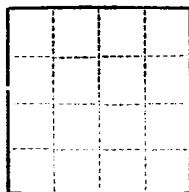

5- 10000
1- 10000
1- 10000
2- 10000
10000

(SUBMIT IN TRIPLICATE)
UNITED STATES
DEPARTMENT OF THE INTERIOR
GEOLOGICAL SURVEY

Land Office 32-115-70
Lease No. 079193
Unit 2-1
12-11-1051

SUNDRY NOTICES AND REPORTS ON WELLS

NOTICE OF INTENTION TO DRILL.....	<input checked="" type="checkbox"/>	SUBSEQUENT REPORT OF WATER SHUT-OFF.....	
NOTICE OF INTENTION TO CHANGE PLANS.....		SUBSEQUENT REPORT OF SHOOTING OR ACIDIZING.....	
NOTICE OF INTENTION TO TEST WATER SHUT-OFF.....		SUBSEQUENT REPORT OF ALTERING CASING.....	
NOTICE OF INTENTION TO RE-DRILL OR REPAIR WELL.....		SUBSEQUENT REPORT OF RE-DRILLING OR REPAIR.....	
NOTICE OF INTENTION TO SHOOT OR ACIDIZE.....		SUBSEQUENT REPORT OF ABANDONMENT.....	
NOTICE OF INTENTION TO PULL OR ALTER CASING.....		SUPPLEMENTARY WELL HISTORY.....	
NOTICE OF INTENTION TO ABANDON WELL.....			

RECEIVED

(INDICATE ABOVE BY CHECK MARK NATURE OF REPORT, NOTICE, OR OTHER DATA)

MAR 10 1956

U. S. GEOLOGICAL SURVEY
FARMINGTON, NEW MEXICO

March 7, 1956

Well No. 20-21 is located 3140 ft. from (N) line and 1150 ft. from (E) line of sec. 42

36/4 (1/4 Sec. and Sec. No.) 36 E (Twp.) 42 (Range) 36/4 (Meridian)

11500 (Field) 36-4 (County or Subdivision) 36-4 (State or Territory)

The elevation of the surface above sea level is 460 ft.

DETAILS OF WORK

(State names of and expected depths to objective sands; show sizes, weights, and lengths of proposed casings; indicate mudding jobs, cementing points, and all other important proposed work)

Propose to drill to 200' set 10 3/4" casg. cased. w/150 sz 4 1/2 gal. Drill w/water or mixture mud to 120' run 7 1/8" casg. cased. w/100 sz. 31 gal. and 50 sz. next. Drill w/gel to 5-44. (total depth). run 5 1/2" casg. cased. w/100 sz. 23 gal. perforate and stop frac The Cliff House. Remove ann. pl. to about 200' depth. Wash w/100, 100 gal water. Clean out to total depth. Run tubing and ann. well. 100 screws, 1/2" x 21" set cased to this well.

I understand that this plan of work must receive approval in writing by the Geological Survey before operations may be commenced.

Company Pacific Northwest Pipeline Corporation

Address 113 1/2 N. Main

Farmington, New Mexico

By Original signed by E. J. Dugan

Title District Engineer

NEW MEXICO
OIL CONSERVATION COMMISSION

Form C-128

Well Location and/or Gas Proration Plat

Date March 7, 1956

Operator Pacific Northwest Pipeline Corporation Lease San Juan 28-6

Well No. 10-21 Section 21 Township 28N Range 6W NMPM

Located 1140 Feet From North Line, 1450 Feet From East Line,

Rio Arriba County, New Mexico. G. L. Elevation 6460, ungraded

Name of Producing Formation Mesa Verde Pool Blanco Dedicated Acreage 320

(Note: All distances must be from outer boundaries of Section)

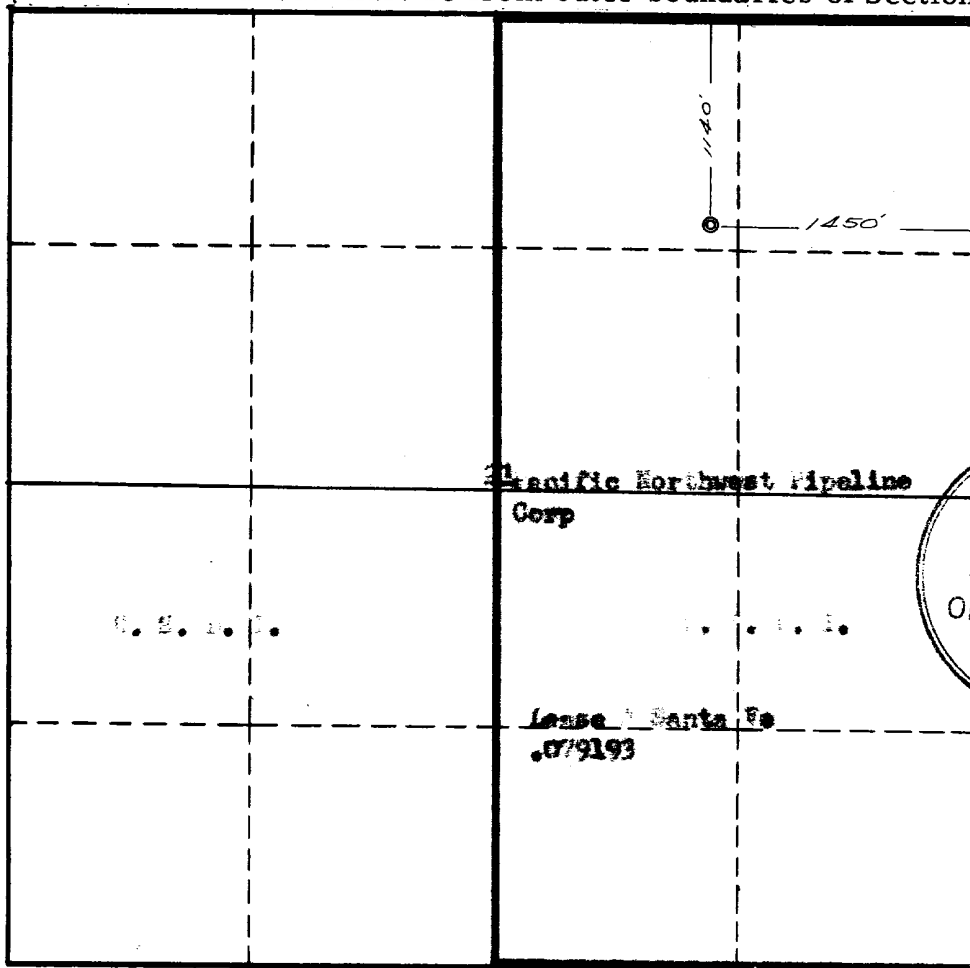

SCALE: 1"=1000'

1. Is this Well a Dual Comp. ? Yes No
2. If the answer to Question 1 is yes, are there any other dually completed wells within the dedicated acreage? Yes No

This is to certify that the above plat was prepared from field notes of actual surveys made by me or under my supervision and that the same are true and correct to the best of my knowledge and belief.

Name Original signed by T. A. Dugan
Position District Engineer
Representing Pacific Northwest Pipeline Corp.
Address 413 1/2 W Main Farmington, New Mexico

Date Surveyed January 28, 1956
Ernest V. Cochran
Registered Professional Engineer and/or
Land Surveyor
FOUR STATES OIL FIELD SURVEYS
FARMINGTON, NEW MEXICO