

NEW MEXICO
OIL CONSERVATION COMMISSION

Form O-128

WELL LOCATION AND/OR GAS PRORATION PLAT

DATE APRIL 25, 1956

OPERATOR EL PASO NATURAL GAS COMPANY SAN JUAN 28-7 UNIT SF 079290-A

WELL NO. 50 SECTION 23 TOWNSHIP 28-N RANGE 7-W N.M.P.M.

CORNER 990 FEET FROM NORTH CORNER 990 FEET FROM EAST CORNER

RIO ARriba COUNTY NEW MEXICO ELEVATION 6684

NAME OF LAND OWNERS MESA VERDE BLANCO TOTAL ACRES 320
(1916 PLAT)

Note: All distances must be from corner boundaries of section.

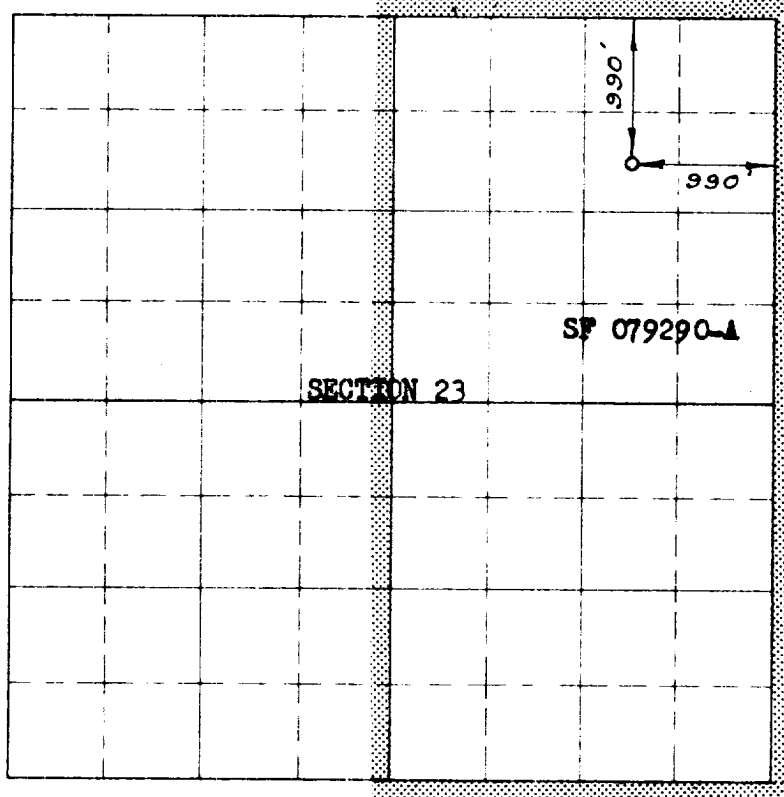

Scale 1 inch = equal 1 mile

NOTE

This section of
form is to be used
for gas wells only

This is to certify that the above plat was prepared from
field notes of actual surveys made by me or under my
supervision and that the same are true and correct to the
best of my knowledge and belief.

Date Surveyed AUGUST 16, 1951

C. O. Walker
Registered Professional Engineer and ~~and~~ Land Surveyor

1. Is this well a Dual Comp.

Yes _____ No X

2. If the answer to Question 1

is yes, are there any other dually
completed wells within the
dedicated acreage.

Yes _____ No _____

Name J. N. Boyd

Position Petroleum Engineer

Representing El Paso Natural Gas Co.

Address Box 997, Farmington, N.M.

(Seal)

Farmington, New Mexico