

NEW MEXICO OIL CONSERVATION COMMISSION

FORM C-103
(Rev 3-55)

MISCELLANEOUS REPORTS ON WELLS

(Submit to appropriate District Office as per Commission Rule 1106)

Name of Company El Paso Natural Gas Company				Address Box 990, Farmington, New Mexico			
Lease San Juan 28-6 Unit		Well No. 100	Unit Letter N	Section 13	Township 28N	Range 6W	
Date Work Performed		Pool Basin Dakota			County Rio Arriba		
THIS IS A REPORT OF: (Check appropriate block)							
<input type="checkbox"/> Beginning Drilling Operations		<input type="checkbox"/> Casing Test and Cement Job		<input checked="" type="checkbox"/> Other (Explain):			
<input type="checkbox"/> Plugging		<input type="checkbox"/> Remedial Work		Corrected Dedication			
Detailed account of work done, nature and quantity of materials used, and results obtained. This plat is being reissued to show corrected dedication from W/2 to S/2							
Witnessed by		Position		Company			
FILL IN BELOW FOR REMEDIAL WORK REPORTS ONLY							
ORIGINAL WELL DATA							
D F Elev.		T D		P B T D		Producing Interval	
Tubing Diameter		Tubing Depth		Oil String Diameter		Oil String Depth	
Perforated Interval(s)							
Open Hole Interval				Producing Formation(s)			
RESULTS OF WORKOVER							
Test	Date of Test	Oil Production BPD	Gas Production MCFPD	Water Production BPD	GOR Cubic feet/Bbl	Gas Well Potential MCFPD	
Before Workover							
After Workover							
OIL CONSERVATION COMMISSION				I hereby certify that the information given above is true and complete to the best of my knowledge.			
Approved by Original Signed Emery C. Arnold				Name ORIGINAL SIGNED F. S. OBERLY			
Title Supervisor Dist. # 3				Position Petroleum Engineer			
Date OCT 3 1963				Company El Paso Natural Gas Company			

NEW MEXICO OIL CONSERVATION COMMISSION

Well Location and Acreage Dedication Plat

Section A.

Date: **OCTOBER 26, 1961**

Operator	EL PASO NATURAL GAS COMPANY				Lease	SAN JUAN 28-6 UNIT		FEE	
Well No.	100	Unit Letter	N	Section	13	Township	28-N	Range	6-W
Located	1000	Feet From	SOUTH	Line	1850	Feet From	WEST		
County	RIO ARriba	G. L. Elevation	6454			Dedicated Acreage	320		
Name of Producing Formation	DAKOTA				Pool	BASIN DAKOTA			

1. Is the Operator the only owner in the dedicated acreage outlined on the plat below?
Yes ☒ No ☐
2. If the answer to question one is "no", have the interests of all the owners been consolidated by communization agreement or otherwise? Yes ☐ No ☐. If answer is "yes", Type of Consolidation, _____

3. If the answer to question two is "no", list all the owners and their respective interests to low;

Owner

Land Description:

Section B.

Note: All distances must be from outer boundaries of sections.

This is to certify that the information in Section A above is true and complete to the best of my knowledge and belief.

El Paso Natural Gas Company

Operator:

ORIGINAL SIGNED E. S. OBERLY
(Representative)

(Representative)

Box 990

(Address)

Farmington, New Mexico

NOTE: THIS PLAT REISSUED TO
SHOW CHANGE IN DEDICATION.

9 25 63

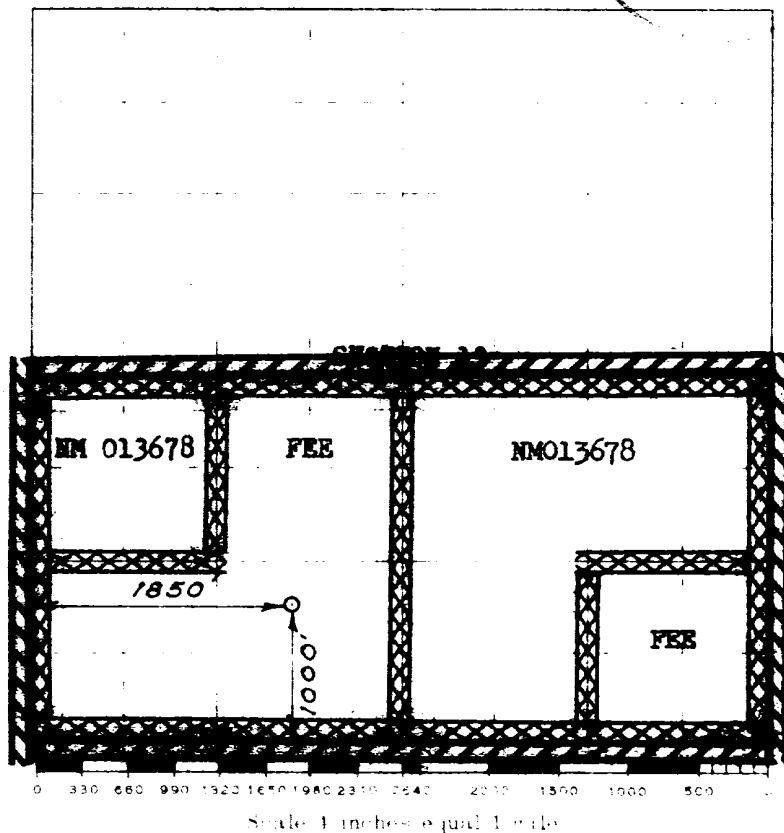

This is to certify that the above plat was prepared from field notes of actual surveys made by me or under my supervision and that the same are true and correct to the best of my knowledge and belief.

(Seal)

Date Surveyed _____

OCTOBER 20, 1961

Farmington, New Mexico

David O. Kilren
Registered Professional Engineer and/or Land Surveyor