

Form 9-331a  
(Feb. 1961)

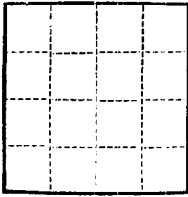

(SUBMIT IN TRIPLICATE)

UNITED STATES  
DEPARTMENT OF THE INTERIOR  
GEOLOGICAL SURVEY

Land Office San Juan  
Lease No. 079250  
Unit San Juan 28-5 Unit  
14-08-001-949

SUNDRY NOTICES AND REPORTS ON WELLS

NOTICE OF INTENTION TO DRILL	<input checked="" type="checkbox"/>	SUBSEQUENT REPORT OF WATER SHUT-OFF	
NOTICE OF INTENTION TO CHANGE PLANS		SUBSEQUENT REPORT OF SHOOTING OR ACIDIZING	
NOTICE OF INTENTION TO TEST WATER SHUT-OFF		SUBSEQUENT REPORT OF ALTERING CASING	
NOTICE OF INTENTION TO RE-DRILL OR REPAIR WELL		SUBSEQUENT REPORT OF RE-DRILLING OR REPAIR	
NOTICE OF INTENTION TO SHOOT OR ACIDIZE		SUBSEQUENT REPORT OF ABANDONMENT	
NOTICE OF INTENTION TO PULL OR ALTER CASING		SUPPLEMENTARY WELL HISTORY	
NOTICE OF INTENTION TO ABANDON WELL			

(INDICATE ABOVE BY CHECK MARK NATURE OF REPORT, NOTICE, OR OTHER DATA)

January 25, 1950

Well No. 27 is located 350 ft. from N line and 1045 ft. from E line of sec. 15  
NE Sec. 15 28N 5W N.M.P.M.  
(1/4 Sec. and Sec. No.) (Twp.) (Range) (Meridian)  
Blanco Rio Arriba New Mexico  
(Field) (County or Subdivision) (State or Territory)

The elevation of the derrick floor above sea level is 6621 ft.

DETAILS OF WORK

(State names of and expected depths to objective sands; show sizes, weights, and lengths of proposed casings; indicate mudlogging jobs, cementing points, and all other important proposed work)

It is intended to drill a well with rotary tools thru the Mesa Verde formation. Mud circulation will be used thru the Pictured Cliffs and set intermediate casing. Gas circulation will be used thru the Mesa Verde and production liner will be set. Possible productive intervals will be perforated and fractured. Estimated Total Depth 6023'.

Casing Program:

10 3/4" at 170' with 150 sacks cement circulated to the surface.  
7 5/8" at 3878' with 250 sacks cement.  
5 1/2" liner at 6023' with 300 sacks cement.

The N/2 of Section 15 is dedicated to this well.  
N/2 SF 079250

I understand that this plan of work must receive approval in writing by the Geological Survey before operations may be commenced.

Company El Paso Natural Gas Company

Address Box 947  
Farmington, New Mexico

By Original Signed D. C. Johnston

Title Petroleum Engineer

## NEW MEXICO OIL CONSERVATION COMMISSION

## Well Location and Acreage Dedication Plat

Section A.

Date **JANUARY 24, 1958**

Operator **EL PASO NATURAL GAS COMPANY** Lease **SAN JUAN 28-5 UNIT** SF **079250**  
 Well No. **27** Unit Letter **B** Section **15** Township **28-N** Range **5-W** NMPM  
 Located **850** Feet From **NORTH** Line **1845** Feet From **EAST** Line  
 County **RIO ARriba** G. L. Elevation **6681** Dedication Acreage **320** Acres  
 Name of Producing Formation **MESA VERDE** Pool **BLANCO**

1. Is the Operator the only owner in the dedicated acreage outlined on the plat below?  
 Yes ☒ No
2. If the answer to question one is "no", have the interests of all the owners been consolidated by communitization agreement or otherwise? Yes No If answer is "yes", Type of Consolidation.
3. If the answer to question two is "no", list all the owners and their respective interests below:

Owner

Land Description

Section B.

I hereby certify that the information in Section A above is true and complete to the best of my knowledge and belief.

**El Paso Natural Gas Company**

(Operator)

Signed **D. C. Johnston**

(Representative)

Box **997**

(Address)

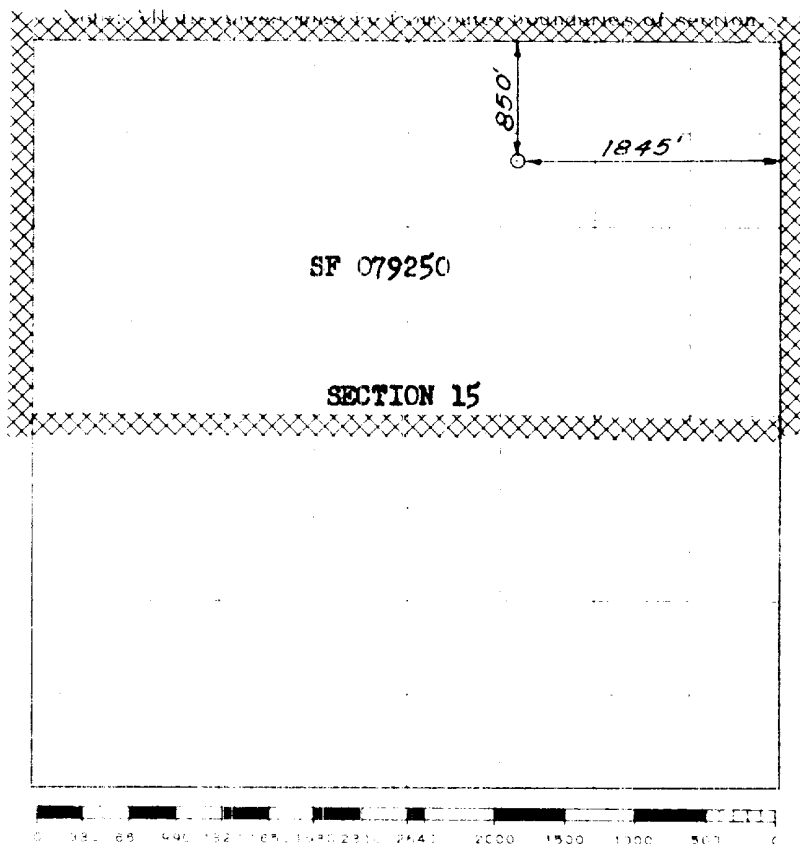
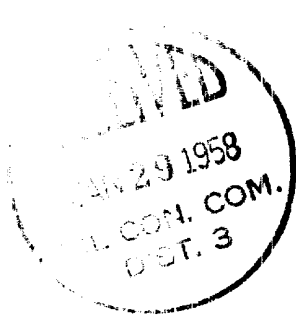
**Farmington, New Mexico**

Scale: 4 inches equal 1 mile

This is to certify that the above plat was prepared from field notes of actual surveys made by me or under my supervision and that the same are true and correct to the best of my knowledge and belief.

(Seal)

Date Surveyed

**JANUARY 20, 1958**

*David O. Wilson*  
 Registered Professional Engineer and/or Land Surveyor

Farmington, New Mexico