

NEW KICO OIL CONSERVATION COMMISSION  
WELL LOCATION AND ACREAGE DEDICATION PLAT

Form C-102  
Supersedes C-128  
Effective 1-1-55

All distances must be from the outer boundaries of the Section.

Operator <b>EL PASO NATURAL GAS CO.</b>		Lease <b>SAN JUAN 28-7 UNIT SF 078496</b>		Well No. <b>189</b>
Unit Letter <b>A</b>	Section <b>35</b>	Township <b>28-N</b>	Range <b>7-W</b>	County <b>RIO ARriba</b>
Actual Postage Location of Well: <b>1180</b> feet from the <b>NORTH</b> line and <b>1180</b> feet from the <b>EAST</b> line				
Ground Level Elev. <b>6156</b>	Producing Formation <b>DAKOTA</b>	Pool <b>BASIN DAKOTA</b>	Dedicated Acreage <b>320.00</b> Acres	

1. Outline the acreage dedicated to the subject well by colored pencil or hachure marks on the plat below.
2. If more than one lease is dedicated to the well, outline each and identify the ownership thereof (other than to working interest and royalty).
3. If more than one lease of different ownership is dedicated to the well, have the interests been consolidated by communitization, unitization, force-pooling, etc?

☒ Yes ☐ No If answer is "yes," type of consolidation \_\_\_\_\_

Unitization \_\_\_\_\_

If answer is "no," list the owners and tract descriptions which have actually been consolidated. (Reverse side of this form if necessary.) \_\_\_\_\_

No allowable will be assigned to the well until all interests have been consolidated (by communitization, unitization, forced-pooling, or otherwise) or until a non-standard unit, eliminating such interests, has been approved by the Commission. **NOTE: THIS PLAT REISSUED TO SHOW CHANGE IN DEDICATION. 1-29-73**

CERTIFICATION

I hereby certify that the information contained herein is true and complete to the best of my knowledge and belief.

Original Signed **F. H. WOOD**

Name  
**Petroleum Engineer**  
El Paso Natural Gas Company

Company  
**January 31, 1973**

Date

I hereby certify that the well location shown on this plat was plotted from field notes of actual surveys made by me or under my supervision, and that the same is true and correct to the best of my knowledge and belief.

Date received

**DECEMBER 27, 1972**

Received by \_\_\_\_\_  
and \_\_\_\_\_

*[Signature]*

**1760**

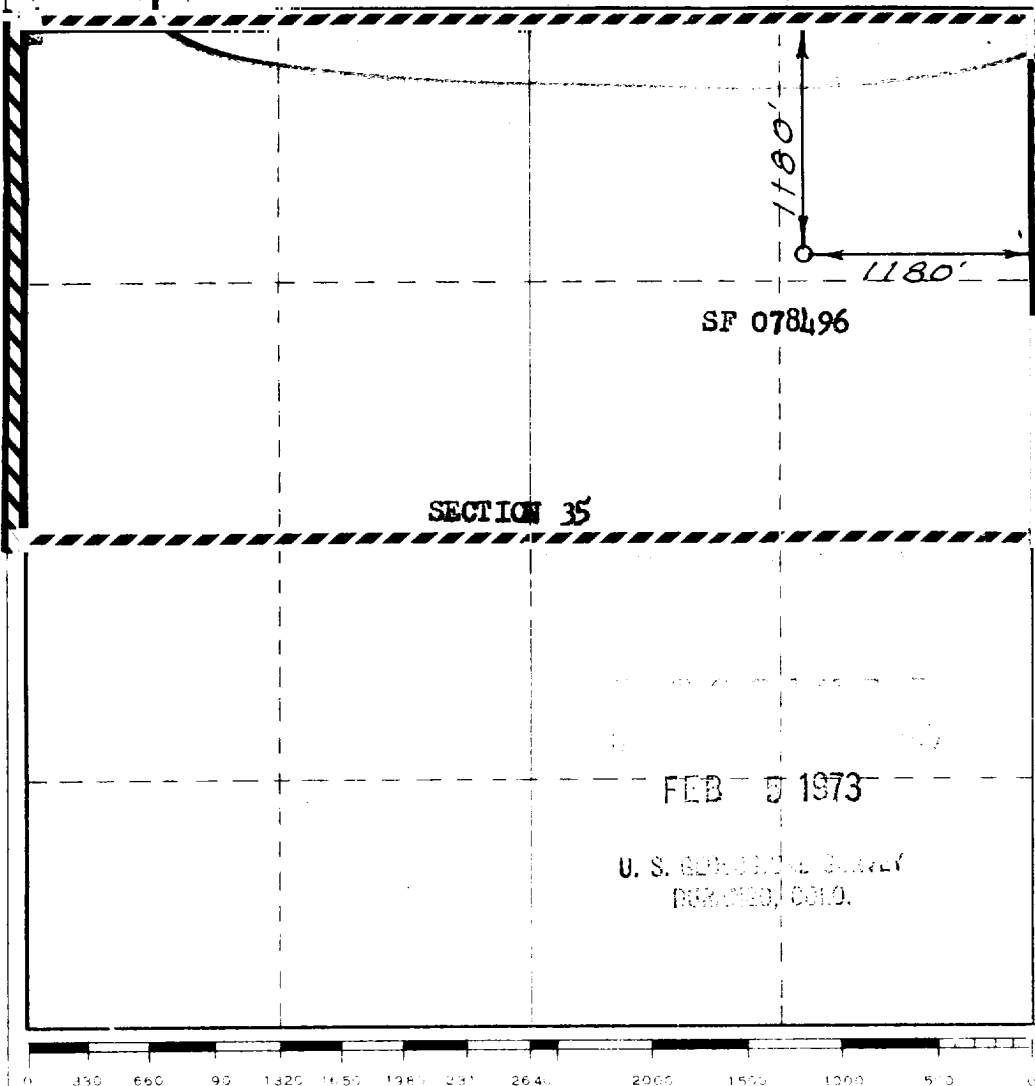

11