

LOCATION AND EQUIPMENT LAY-OUT

SAN JUAN, 28-6 Unit No. 172

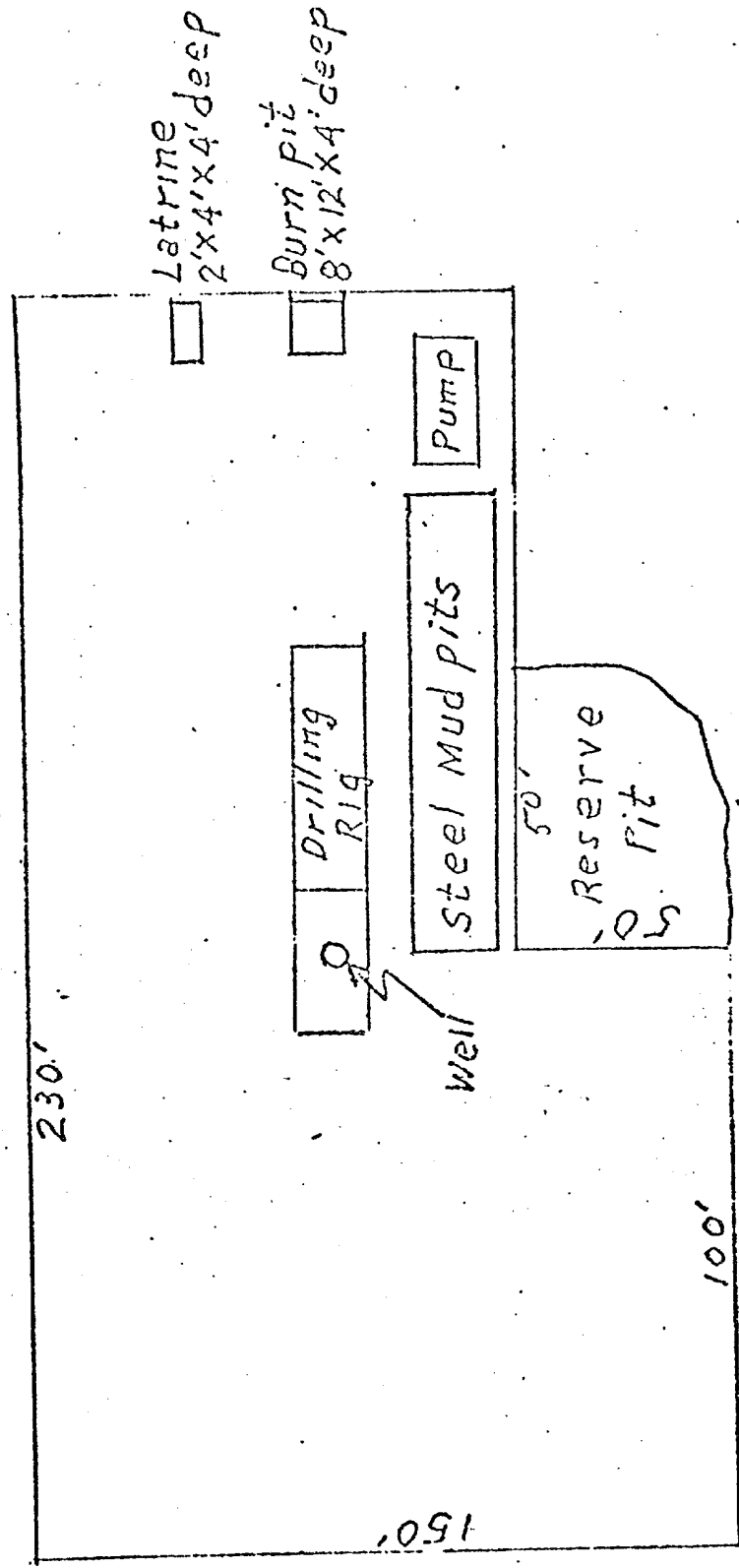

EXISTING AND PROPOSED ROADS AND PIPELINE RIGHTS-OF-WAY

SAN JUAN 28-6 Unit No. 172

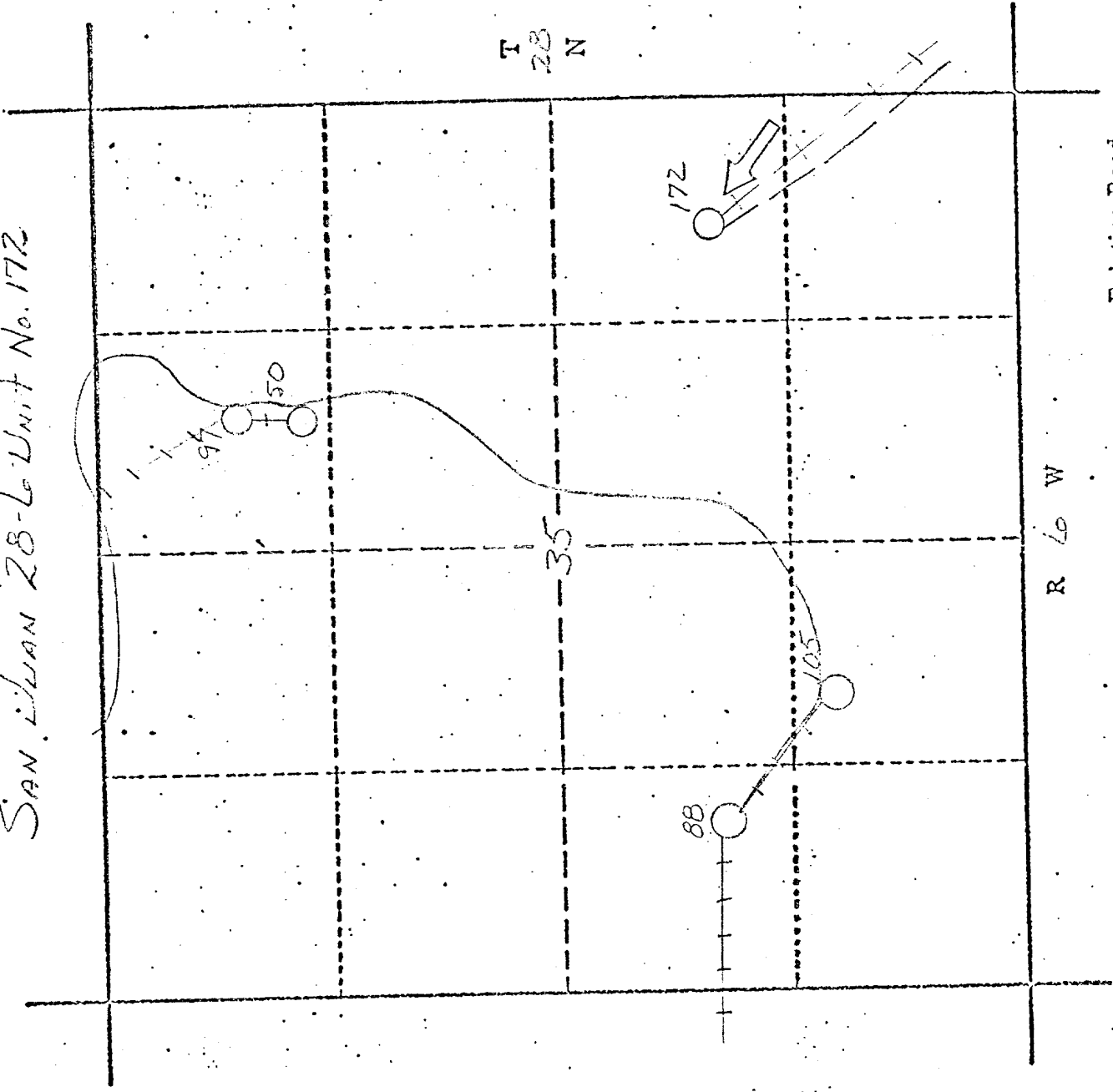

Existing Road
Proposed Road
Existing Right-of-Way
Proposed Right-of-Way