

Frank Chavez

THE APPLICATION OF EL PASO NATURAL GAS
COMPANY FOR A DUAL COMPLETION

ORDER NO. MC-2636



ADMINISTRATIVE ORDER
OF THE OIL CONSERVATION DIVISION

Under the provisions of Rule 112-A, El Paso Natural Gas Company made application to the New Mexico Oil Conservation Division on April 23, 1980, for permission to dually complete its San Juan 28-7 Unit Well No. 94-A located in Unit E of Section 30, Township 28 North, Range 7 West, NMPM, Rio Arriba County, New Mexico, in such a manner as to permit production of gas from the Pictured Cliffs formation adjacent to the South Blanco-Pictured Cliffs Pool and gas from Mesaverde formation in the Blanco-Mesaverde Pool.

Now, on this 23rd day of April, 1980, the Division Director finds:

(1) That application has been filed under the provisions of Rule 112-A of the Division's Rules and Regulations;

(2) That satisfactory information has been provided that all operators of offset acreage have been duly notified; and

(3) That no objections have been received within the waiting period as prescribed by said rule.

(4) That the proposed dual completion will not cause waste nor impair correlative rights.

(5) That the mechanics of the proposed dual completion are feasible and consonant with good conservation practices.

IT IS THEREFORE ORDERED:

That the applicant herein, El Paso Natural Gas Company, be and the same is hereby authorized to dually complete its San Juan 28-7 Unit Well No. 94-A located in Unit E of Section 30, Township 28 North, Range 7 West, NMPM, Rio Arriba County, New Mexico, in such a manner as to permit production of gas from the Pictured Cliffs formation adjacent to the South Blanco-Pictured Cliffs Pool and gas from the Mesaverde formation in the Blanco-Mesaverde Pool through parallel strings of tubing.

PROVIDED HOWEVER, That applicant shall complete, operate, and produce said well in accordance with the provisions of Rule 112-A.

PROVIDED FURTHER, That applicant shall take packer-leakage tests upon completion and annually thereafter.

IT IS FURTHER ORDERED: That jurisdiction of this cause is hereby retained for the entry of such further orders as the Division may deem necessary.

DONE at Santa Fe, New Mexico, on the day and year hereinabove designated.

STATE OF NEW MEXICO
OIL CONSERVATION DIVISION

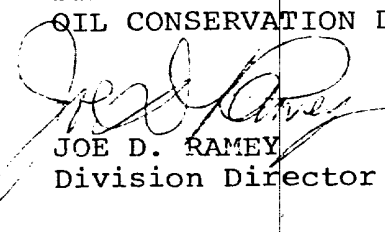
JOE D. RAMEY
Division Director

SEAL

OIL CONSERVATION COMMISSION
Alto DISTRICT

OIL CONSERVATION COMMISSION
BOX 2088
SANTA FE, NEW MEXICO

DATE April 24, 1980

RE: Proposed MC x
Proposed DHC _____
Proposed NSL _____
Proposed SWD _____
Proposed WFX _____
Proposed PMX _____

Gentlemen:

I have examined the application dated April 22, 1980
for the E.P.M.B. Co. San Juan 28-72 Unit #94A E-30-2807W
Operator Lease and Well No. Unit, S-T-R

and my recommendations are as follows:

Agree

Yours very truly,

Frank S. Chav

NEW MEXICO OIL CONSERVATION COMMISSION
SANTA FE, NEW MEXICO
APPLICATION FOR MULTIPLE COMPLETION

Form C-107
5-1-61

Operator <u>El Paso Natural Gas Co.</u>		County <u>Rio Arriba</u>	Date <u>4-17-80</u>
Address <u>Box 289, Farmington, New Mexico</u>		Lease <u>San Juan 28-7 Unit</u>	Well No. <u>94 A</u>
Location of Well <u>E</u>	Unit <u>30</u>	Township <u>28 N</u>	Range <u>7 W</u>

1. Has the New Mexico Oil Conservation Commission heretofore authorized the multiple completion of a well in these same pools or in the same zones within one mile of the subject well? YES * NO
2. If answer is yes, identify one such instance: Order No. * ; Operator Lease, and Well No.:

* Re: NMOCC Memo #18-58

3. The following facts are submitted:	Upper Zone	Intermediate Zone	Lower Zone
a. Name of Pool and Formation	<u>Pictured Cliffs</u>		<u>Mesa Verde</u>
b. Top and Bottom of Pay Section (Perforations)	<u>2872' - 2978'</u>		<u>4509' - 5400'</u>
c. Type of production (Oil or Gas)	<u>Gas</u>		<u>Gas</u>
d. Method of Production (Flowing or Artificial Lift)	<u>Flow</u>		<u>Flow</u>

4. The following are attached. (Please check YES or NO)

Yes No

- | | | |
|-------------------------------------|-------------------------------------|---|
| <input checked="" type="checkbox"/> | <input type="checkbox"/> | a. Diagrammatic Sketch of the Multiple Completion, showing all casing strings, including diameters and setting depths, centralizers and/or turbolizers and location thereof, quantities used and top of cement, perforated intervals, tubing strings, including diameters and setting depth, location and type of packers and side door chokes, and such other information as may be pertinent. |
| <input checked="" type="checkbox"/> | <input type="checkbox"/> | b. Plat showing the location of all wells on applicant's lease, all offset wells on offset leases, and the names and addresses of operators of all leases offsetting applicant's lease. |
| <input type="checkbox"/> | <input checked="" type="checkbox"/> | c. Waivers consenting to such multiple completion from each offset operator, or in lieu thereof, evidence that said offset operators have been furnished copies of the application.* |
| <input type="checkbox"/> | <input checked="" type="checkbox"/> | d. Electrical log of the well or other acceptable log with tops and bottoms of producing zones and intervals of perforation indicated thereon. (If such log is not available at the time application is filed it shall be submitted as provided by Rule 112-A.) |

5. List all offset operators to the lease on which this well is located together with their correct mailing address.

NONE

6. Were all operators listed in Item 5 above notified and furnished a copy of this application? YES NO . If answer is yes, give date of such notification .

CERTIFICATE: I, the undersigned, state that I am the Drilling Clerk of the El Paso Natural Gas (company), and that I am authorized by said company to make this report; that this report was prepared under my supervision and direction and that the facts stated therein are true, correct and complete to the best of my knowledge.

[Signature]
Signature

APR 22 1980

OIL CON. COM.

DIST. 3

*Should waivers from all offset operators not accompany an application for administrative approval, the New Mexico Oil Conservation Commission will hold the application for a period of twenty (20) days from date of receipt by the Commission's Santa Fe office. If, after said twenty-day period, no protest nor request for hearing is received by the Santa Fe office, the application will then be processed.

NOTE: If the proposed multiple completion will result in an unorthodox well location and/or a non-standard perforation unit in one or more of the producing zones, then separate application for approval of the same should be filed simultaneously with this application.

PLAT SHOWING LOCATION OF INTENDED DUAL COMPLETION
 El Paso Natural Gas Co. San Juan 28-7 Unit #94 A (PM) Well
 and Offset Acreage

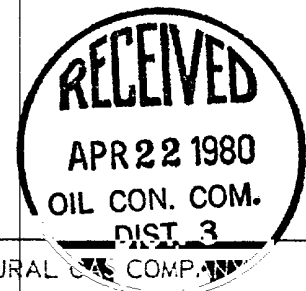
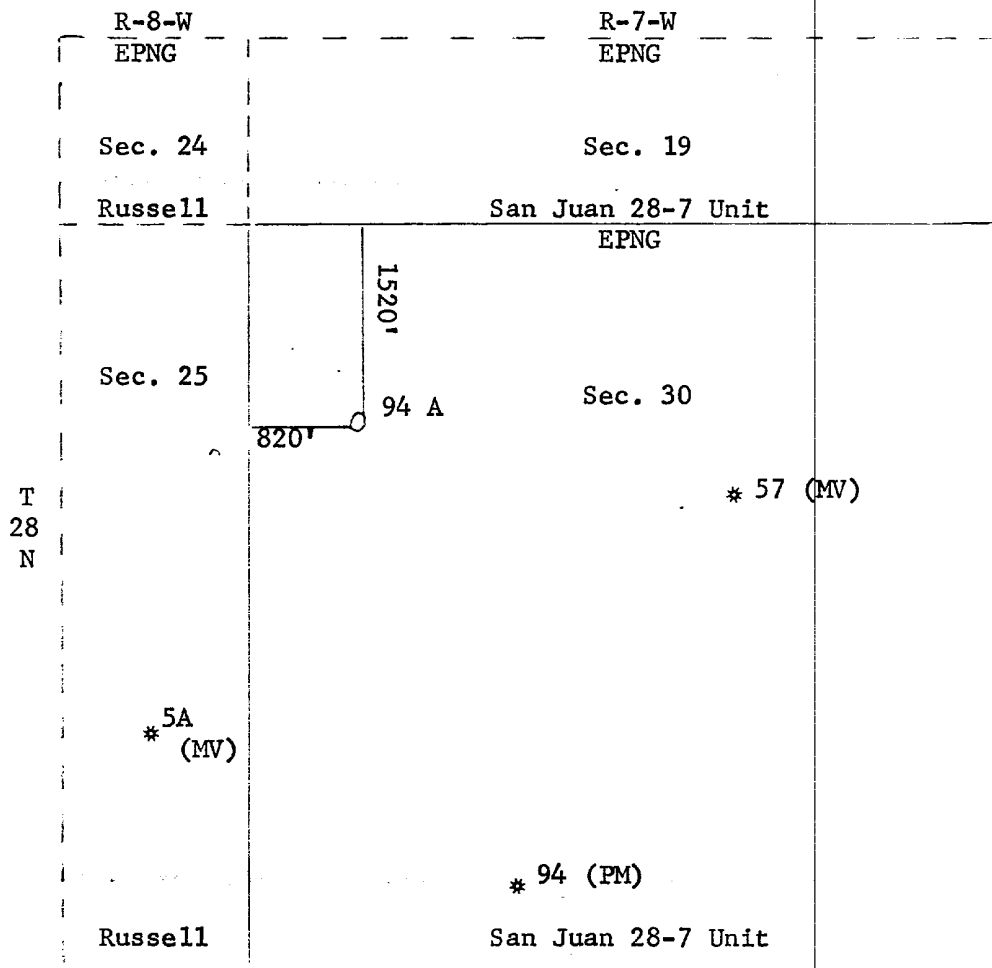

EL PASO NATURAL GAS COMPANY

SCALE

DATE

No.

DRAWN BY

CHECKED BY

SCHEMATIC DIAGRAM OF INTENDED DUAL COMPLETION
El Paso Natural Gas Co. San Juan 28-7 Unit #94 A (PM)

NW/4 Sec. 30 T-28-N, R-7-W

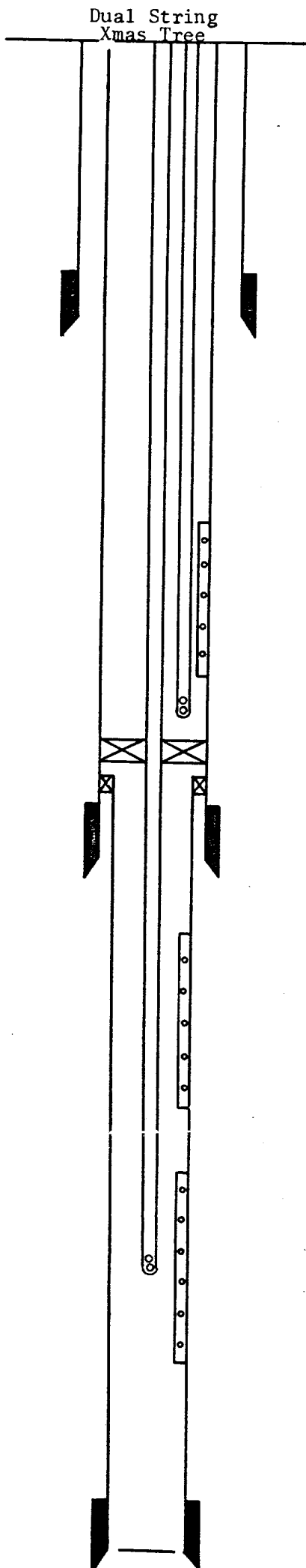

Zero reference point 10.0' above top
flange of tubing hanger.

9 5/8", 32.3#, H-40 casing set at approximately 200' with
sufficient cement to circulate to surface.

Pictured Cliffs formation will be selectively perforated
and sand water fractured.

1 1/4", 2.3#, IJ Pictured Cliffs tubing.

Production Packer

4 1/2" Liner Hanger.

7", 20#, J-55 casing set approximately 3178' with
sufficient cement to fill to 3200' (Top Ojo Alamo).

Cliff House formation will be selectively perforated and
sand water fractured.

Point Lookout formation will be selectively perforated
and sand water fractured.

2 3/8", 4.7#, EUE Mesa Verde tubing.

4 1/2", 10.5#, J-55 liner will be set from approximately
3028' to 5505' with sufficient cement to circulate top
of liner at 3028'.