

DISTRICT I

P.O. Box 1980, Hobbs, NM 88241-1980

DISTRICT II

811 South First St., Artesia, NM 88210-2835

DISTRICT III

1000 Rio Brazos Rd, Aztec, NM 87410-1693

State of New Mexico  
Energy, Minerals and Natural Resources Department

OIL CONSERVATION DIVISION

2040 S. Pacheco  
Santa Fe, New Mexico 87505-6429

Form C-107-A  
New 3-12-96

APPROVAL PROCESS :

☒ Administrative  
☐ Hearing

APPLICATION FOR DOWNHOLE COMMINGLING

EXISTING WELLBORE

☒ YES ☐ NO

Burlington Resources Oil and Gas

PO Box 4289, Farmington, NM 87499

Operator

San Juan 28-5 Unit

#59M

Address

C-30-28N-05W

Rio Arriba

Lease

Well No.

Unit Ltr. - Sec - Twp - Rge

County

Spacing Unit Lease Types: (check 1 or more)

OGRID NO. 14538 Property Code 7460

API NO. 30-039-22616

Federal ☒ X ☐ State ☐ Fee ☐

The following facts are submitted in support of downhole commingling:	Upper Zone	Intermediate Zone	Lower Zone
1. Pool Name and Pool Code	Blanco Mesaverde - 72399		Basin Dakota - 71599
2. Top and Bottom of Pay Section (Perforations)	5090'-5958'		7604'-7804'
3. Type of production (Oil or Gas)	Gas		Gas
4. Method of Production (Flowing or Artificial Lift)	Flowing		Flowing
5. Bottomhole Pressure Oil Zones - Artificial Lift: Estimated Current Gas & Oil - Flowing: Measured Current All Gas Zones: Estimated or Measured Original	(Current) a. 495 psi (see attachment)  (Original) b. 721 psi (see attachment)		a. 334 psi (see attachment)  b. 2387 psi (see attachment)
6. Oil Gravity (°API) or Gas BTU Content	BTU 1214		BTU 1057
7. Producing or Shut-In?	Producing		Producing
Production Marginal? (yes or no)	No		Yes
* If Shut-In and oil/gas/water rates of last production  Note: For new zones with no production history, applicant shall be required to attach production estimates and supporting data	Date: N/A Rates:		Date: N/A Rates:
* If Producing, give data and oil/gas/water of recent test (within 60 days)	Date: 6/18/98 Rates: 227 mcf/d 1.2 bopd		Date: 6/18/98 Rates: 167 mcf/d 0.0 bopd
8. Fixed Percentage Allocation Formula - % for each zone (total of %'s to equal 100%)	Will be supplied upon completion.		Will be supplied upon completion.

9. If allocation formula is based upon something other than current or past production, or is based upon some other method, submit attachments with supporting data and/or explaining method and providing rate projections or other required data.
10. Are all working, overriding, and royalty interests identical in all commingled zones? ☐ Yes ☒ No  
If not, have all working, overriding, and royalty interests been notified by certified mail? ☐ Yes ☒ No  
Have all offset operators been given written notice of the proposed downhole commingling? ☒ Yes ☐ No
11. Will cross-flow occur? ☒ Yes ☐ No If yes, are fluids compatible, will the formations not be damaged, will any cross-flowed production be recovered, and will the allocation formula be reliable. ☒ Yes ☐ No (If No, attach explanation)
12. Are all produced fluids from all commingled zones compatible with each other? ☒ Yes ☐ No
13. Will the value of production be decreased by commingling? ☐ Yes ☒ No (If Yes, attach explanation)
14. If this well is on, or communitized with, state or federal lands, either the Commissioner of Public Lands or the United States Bureau of Land Management has been notified in writing of this application. ☒ Yes ☐ No
15. NMOCD Reference Cases for Rule 303(D) Exceptions: ORDER NO(S). R-10695 attached
16. ATTACHMENTS:  
\* C-102 for each zone to be commingled showing its spacing unit and acreage dedication.  
\* Production curve for each zone for at least one year. (If not available, attach explanation.)  
\* For zones with no production history, estimated production rates and supporting data.  
\* Data to support allocation method or formula.  
\* Notification list of all offset operators.  
\* Notification list of working, overriding, and royalty interests for uncommon interest cases.  
\* Any additional statements, data, or documents required to support commingling.

I hereby certify that the information above is true and complete to the best of my knowledge and belief.

SIGNATURE 

TITLE Production Engineer DATE 6/23/98

TYPE OR PRINT NAME

L. Tom Loveland

TELEPHONE NO. ( 505 ) 326-9700

All distances must be from the outer boundaries of the Section.

Operator EL PASO NATURAL GAS COMPANY			Lease SAN JUAN 28-5 UNIT (SF-080505)		Well No. 59H
Unit Letter C	Section 30	Township 28N	Range 5W	County Rio Arriba	
Actual Footage Location of Well: 1000 feet from the North line and 1690 feet from the West line					
Ground Level Elev. 6582	Producing Formation Mesa Verde-Dakota		Pool BLANCO MESA VERDE BASIN DAKOTA	Dedicated Acreage: 320.00 ± 320.00 Acres	

1. Outline the acreage dedicated to the subject well by colored pencil or hatchure marks on the plat below.
2. If more than one lease is dedicated to the well, outline each and identify the ownership thereof (both as to working interest and royalty).
3. If more than one lease of different ownership is dedicated to the well, have the interests of all owners been consolidated by communitization, unitization, force-pooling, etc?

☒ Yes ☐ No If answer is "yes," type of consolidation Unitization

If answer is "no," list the owners and tract descriptions which have actually been consolidated. (Use reverse side of this form if necessary.)

No allowable will be assigned to the well until all interests have been consolidated (by communitization, unitization, forced-pooling, or otherwise) or until a non-standard unit, eliminating such interests, has been approved by the Commission.

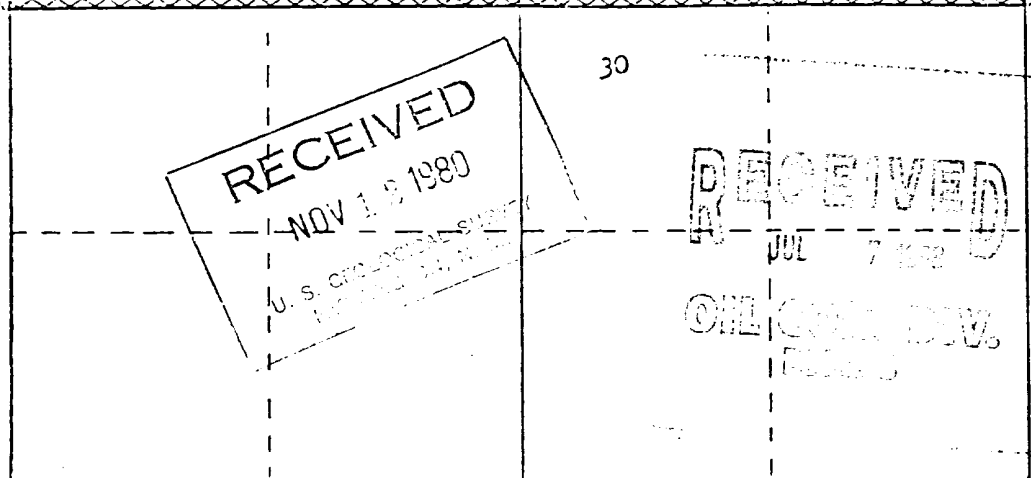
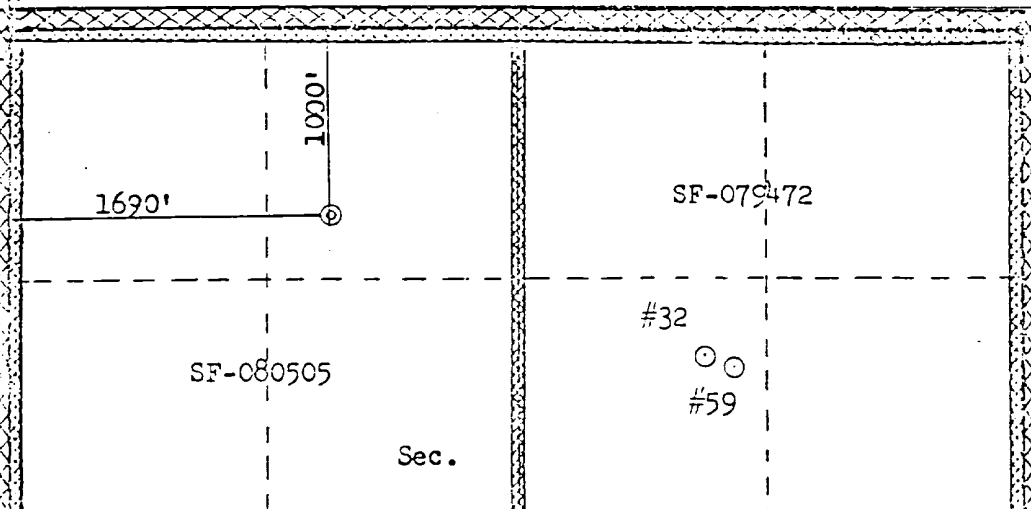

Scale: 1"=1000'

## CERTIFICATION

I hereby certify that the information contained herein is true and complete to the best of my knowledge and belief.

*J. G. Guico*

Name  
Drilling Clerk

Position  
El Paso Natural Gas Co

Company  
November 12, 1980

Date

I hereby certify that the well location shown on this plat was plotted from field notes of actual surveys made by me or under my supervision, and that the same is true and correct to the best of my knowledge and belief.

Date Surveyed  
September 19, 1980

Registered Professional Engineer  
and Land Surveyor

*Fred B. Kerr Jr.*  
Fred B. Kerr Jr.

Certificate No.  
3950

• OIL  
• WATER/GAS  
• GAS  
• WATER

SAN JUAN 28-5 UNIT : 59M : MESAVERDE

— DAILY RATE  
— TBG PRESSURE

Prop 173 \*

- • WATER Bbls/d
- • GAS Mcf/d
- • WATER/GAS
- • OIL Bbl/d



RateTime  
Semi Log

Major = GAS

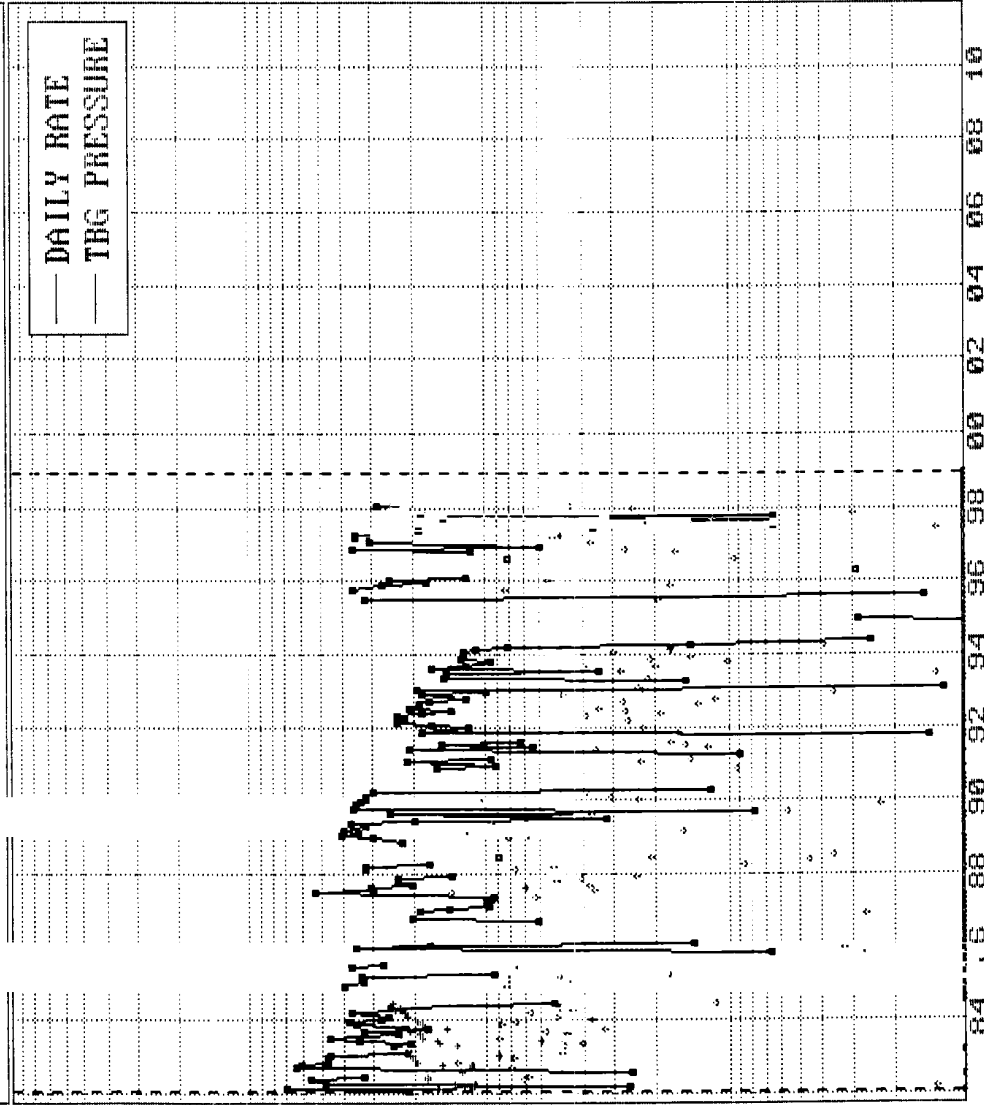

# SAN JUAN 28-5 UNIT : 59M : DAKOTA

Prop 174 \*

\* OIL  
\* WATER/GAS  
\* GAS  
\* WATER

— DAILY RATE  
— TBG PRESSURE

- ☐ \* WATER Bbls/d
- ☒ \* GAS Mcf/d
- ☐ \* WATER/GAS
- ☐ \* OIL Bbl/d

RateTime  
Semi Log

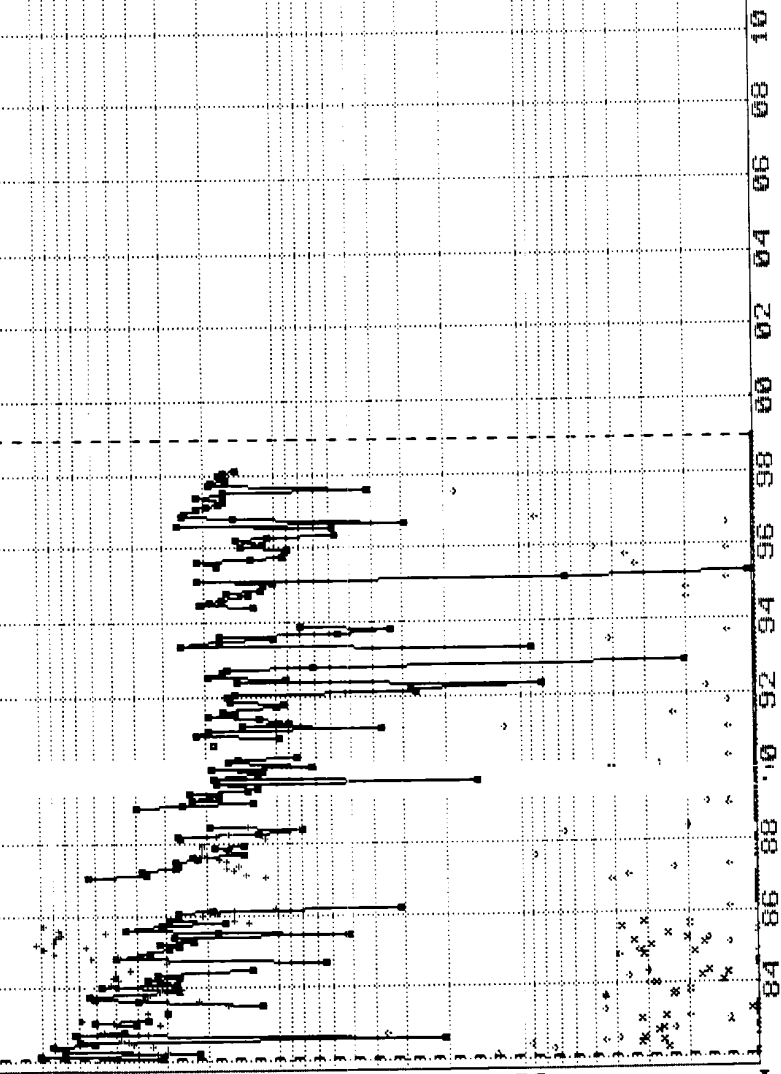

Major = GAS

**San Juan 28-5 Unit #59M**  
**Bottom Hole Pressures**  
**Flowing and Static BHP**  
**Cullender and Smith Method**

Version 1.0 1/14/98

<b>Mesaverde</b>		<b>Dakota</b>	
<b><u>MV-Current</u></b>		<b><u>DK-Current</u></b>	
GAS GRAVITY	<u>0.706</u>	GAS GRAVITY	<u>0.616</u>
COND. OR MISC. (C/M)	<u>C</u>	COND. OR MISC. (C/M)	<u>C</u>
%N2	<u>0.25</u>	%N2	<u>0.15</u>
%CO2	<u>0.84</u>	%CO2	<u>1.21</u>
%H2S	<u>0</u>	%H2S	<u>0</u>
DIAMETER (IN)	<u>7</u>	DIAMETER (IN)	<u>2.375</u>
DEPTH (FT)	<u>5524</u>	DEPTH (FT)	<u>7704</u>
SURFACE TEMPERATURE (DEG F)	<u>60</u>	SURFACE TEMPERATURE (DEG F)	<u>60</u>
BOTTOMHOLE TEMPERATURE (DEG F)	<u>143</u>	BOTTOMHOLE TEMPERATURE (DEG F)	<u>175</u>
FLOWRATE (MCFPD)	<u>0</u>	FLOWRATE (MCFPD)	<u>0</u>
SURFACE PRESSURE (PSIA)	<u>430</u>	SURFACE PRESSURE (PSIA)	<u>284</u>
BOTTOMHOLE PRESSURE (PSIA)	<u>495.1</u>	BOTTOMHOLE PRESSURE (PSIA)	<u>333.5</u>
<b><u>MV-Original</u></b>		<b><u>DK-Original</u></b>	
GAS GRAVITY	<u>0.706</u>	GAS GRAVITY	<u>0.616</u>
COND. OR MISC. (C/M)	<u>C</u>	COND. OR MISC. (C/M)	<u>C</u>
%N2	<u>0.25</u>	%N2	<u>0.15</u>
%CO2	<u>0.84</u>	%CO2	<u>1.21</u>
%H2S	<u>0</u>	%H2S	<u>0</u>
DIAMETER (IN)	<u>7</u>	DIAMETER (IN)	<u>2.375</u>
DEPTH (FT)	<u>5524</u>	DEPTH (FT)	<u>7704</u>
SURFACE TEMPERATURE (DEG F)	<u>60</u>	SURFACE TEMPERATURE (DEG F)	<u>60</u>
BOTTOMHOLE TEMPERATURE (DEG F)	<u>143</u>	BOTTOMHOLE TEMPERATURE (DEG F)	<u>175</u>
FLOWRATE (MCFPD)	<u>0</u>	FLOWRATE (MCFPD)	<u>0</u>
SURFACE PRESSURE (PSIA)	<u>623</u>	SURFACE PRESSURE (PSIA)	<u>1978</u>
BOTTOMHOLE PRESSURE (PSIA)	<u>720.9</u>	BOTTOMHOLE PRESSURE (PSIA)	<u>2387.4</u>

Page No.: 13  
Print Time: Fri May 08 08:28:40 1998  
Property ID: 173  
Property Name: SAN JUAN 28-5 UNIT | 59M | MESAVERDE  
Table Name: S:\ARIES\78LTL\TEST.DBF

<u>--DATE--</u>	<u>--CUM OIL--</u> Bbl	<u>---CUM GAS---</u> Mcf	<u>M SIWHP</u> Psi
11/11/81		0	623.0
11/18/81		0	622.0
03/04/82		28555	665.0
09/19/83		213764	486.0
05/01/84		283884	447.0
10/20/86		375768	581.0
09/18/89		573056	362.0
01/24/91		648551	470.0
08/26/91		671520	482.0
07/05/93		764119	462.0
04/01/98		932963	430.0

*Original*

*Current Estimated from P/z data*

Page No.: 14

Print Time: Fri May 08 08:28:40 1998

Property ID: 174

Property Name: SAN JUAN 28-5 UNIT | 59M | DAKOTA

Table Name: S:\ARIES\78LTL\TEST.DBF

<u>--DATE--</u>	<u>--CUM_OIL--</u> Bbl	<u>---CUM_GAS---</u> Mcf	<u>M_SIWHP</u> Psi
-----------------	---------------------------	-----------------------------	-----------------------

11/11/81		0	1978.0
03/04/82		47673	1120.0
09/19/83		262274	611.0
11/01/84		385862	612.0
11/18/85		483650	593.0
11/09/88		634868	584.0
04/22/90		722677	612.0
05/28/92		800657	718.0
05/24/93		834299	638.0

04/01/98

1044898

284.0

*Original*

*Current Estimated from P/z data*

# Package Preparation Volume Data

DPNo: 63424A SAN JUAN 28-5 UNIT 59M Form: MV

Supt: 60 KEN RAYBON FF: 335 LARY BYARS MS: 319 STEVE BAIRD  
Pipeline: WFS Plunger: No Dual: Yes Compressor: No

<u>Ownership (No Trust)</u>			<u>Prior Year</u>			<u>Current Year</u>			
	<u>Gas</u>	<u>Oil</u>			<u>Days</u>			<u>Days</u>	
				<u>MCF/M</u>	<u>BOPM</u>	<u>On</u>	<u>MCF/M</u>	<u>BOPM</u>	<u>On</u>
GWI:	73.1659%	73.1659%	Jan	9,399	114.0	18.2	8,771	157.0	31
GNI:	62.3562%	62.3562%	Feb	0	0.0	0	6,736	83.0	28
			Mar	10,810	162.0	11.5	7,128	17.0	31
<u>Volumes</u>			Apr	10,919	153.0	30	6,816	94.0	30
<u>(Days On)</u>	<u>MCFD</u>	<u>BOPD</u>	May	5,792	0.0	24.5	0	0.0	28.9
7 Day Avg	239	13.2	Jun	1,007	4.0	21	0	0.0	0
30 Day Avg	244	1.3	Jul	0	67.0	31	0	0.0	0
60 Day Avg	235	2.2	Aug	0	0.0	31	0	0.0	0
3 Mo Avg	232	2.2	Sept	4,523	36.0	26.2	0	0.0	0
6 Mo Avg	231	2.4	Oct	0	0.0	31	0	0.0	0
12 MoAvg	154	1.6	Nov	5,666	9.0	30	0	0.0	0
			Dec	6,712	76.0	31	0	0.0	0
<u>Volumes</u>			Total	54,828	621.0		29,451	351.0	
<u>(Days in Month)</u>	<u>MCFD</u>	<u>BOPD</u>							
30 Day Avg	227	1.2							
60 Day Avg	227	2.2							
3 Mo Avg	232	2.2							
6 Mo Avg	229	2.4							
12 Mo Avg	146	1.5							

Print Form

Exit Volumes Data

**Print Form**

**Exit Volumes Data**



# Package Preparation Volume Data

DPNo: 53424B

SAN JUAN 28-6 UNIT

59M

Form: DK

Supt: 60 KEN RAYBON

FF: 335 LARY BYARS

MS: 319 STEVE BAIRD

Pipeline: WFS

Plunger: No

Dual: Yes

Compressor: No

<u>Ownership (No Trust)</u>			<u>Prior Year</u>			<u>Current Year</u>		
	<u>Gas</u>	<u>Oil</u>			<u>Days</u>			<u>Days</u>
				<u>MCF/M</u>	<u>BOPM</u>	<u>On</u>	<u>MCF/M</u>	<u>BOPM</u>
	GWI: 69.6124%	69.6124%	Jan	6,532	0.0	31	4,991	0.0
	GNI: 58.8960%	58.8960%	Feb	5,929	1.0	28	4,399	0.0
			Mar	5,261	0.0	31	4,810	0.0
<u>Volumes</u>			Apr	4,991	0.0	30	5,744	0.0
<u>(Days On)</u>	<u>MCFD</u>	<u>BOPD</u>	May	6,431	0.0	29.1	0	0.0
7 Day Avg	145	0.0	Jun	4,913	0.0	30	0	0.0
30 Day Avg	180	0.0	Jul	4,905	56.0	31	0	0.0
60 Day Avg	186	0.0	Aug	1,120	0.0	31	0	0.0
3 Mo Avg	168	0.0	Sept	5,817	0.0	24.2	0	0.0
6 Mo Avg	166	0.0	Oct	5,621	0.0	31	0	0.0
12 MoAvg	165	0.2	Nov	4,881	0.0	30	0	0.0
			Dec	5,187	0.0	31	0	0.0
<u>Volumes</u>			Total	61,588	57.0		19,944	0.0
<u>(Days in Month)</u>	<u>MCFD</u>	<u>BOPD</u>						
30 Day Avg	167	0.0						
60 Day Avg	179	0.0						
3 Mo Avg	168	0.0						
6 Mo Avg	164	0.0						
12 Mo Avg	161	0.2						

**Print Form**

**Exit Volumes Data**

6/19/98

***BURLINGTON RESOURCES OIL AND GAS COMPANY***

**San Juan 28-5 Unit #59M**

**Offset Operator/Owner Plat**

**Mesaverde (N/2) / Dakota (N/2) Formations Commingle Well**

**Township 28 North, Range 5 West**

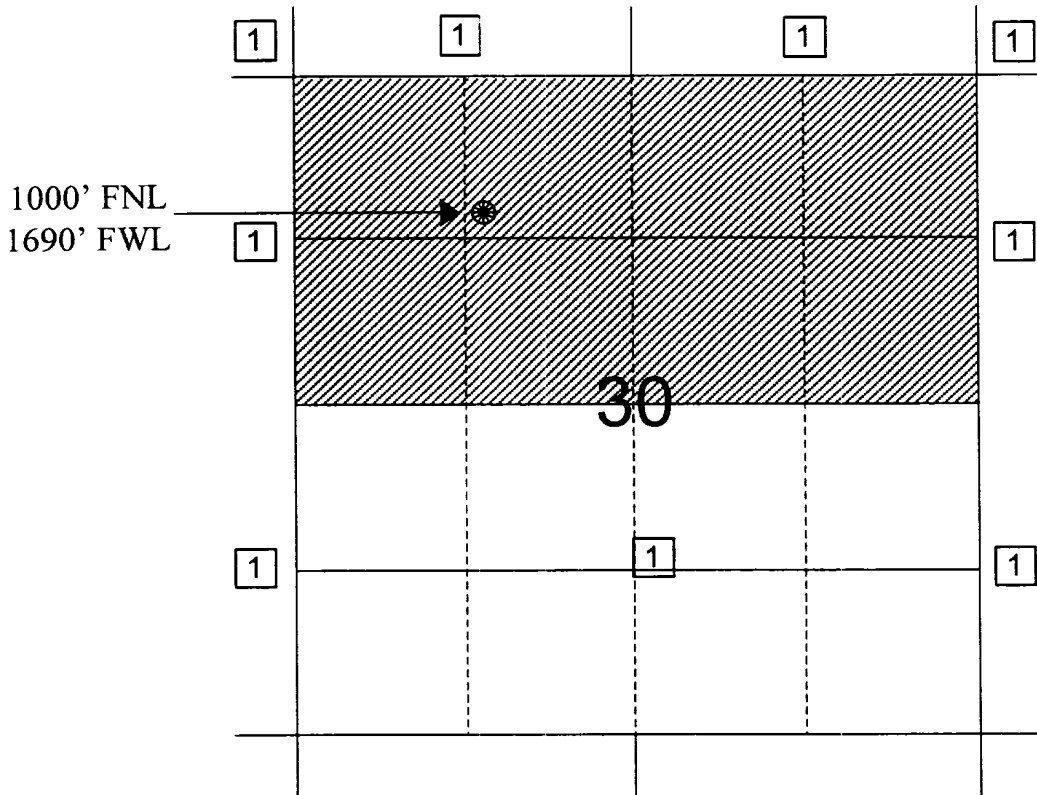

1) Burlington Resources

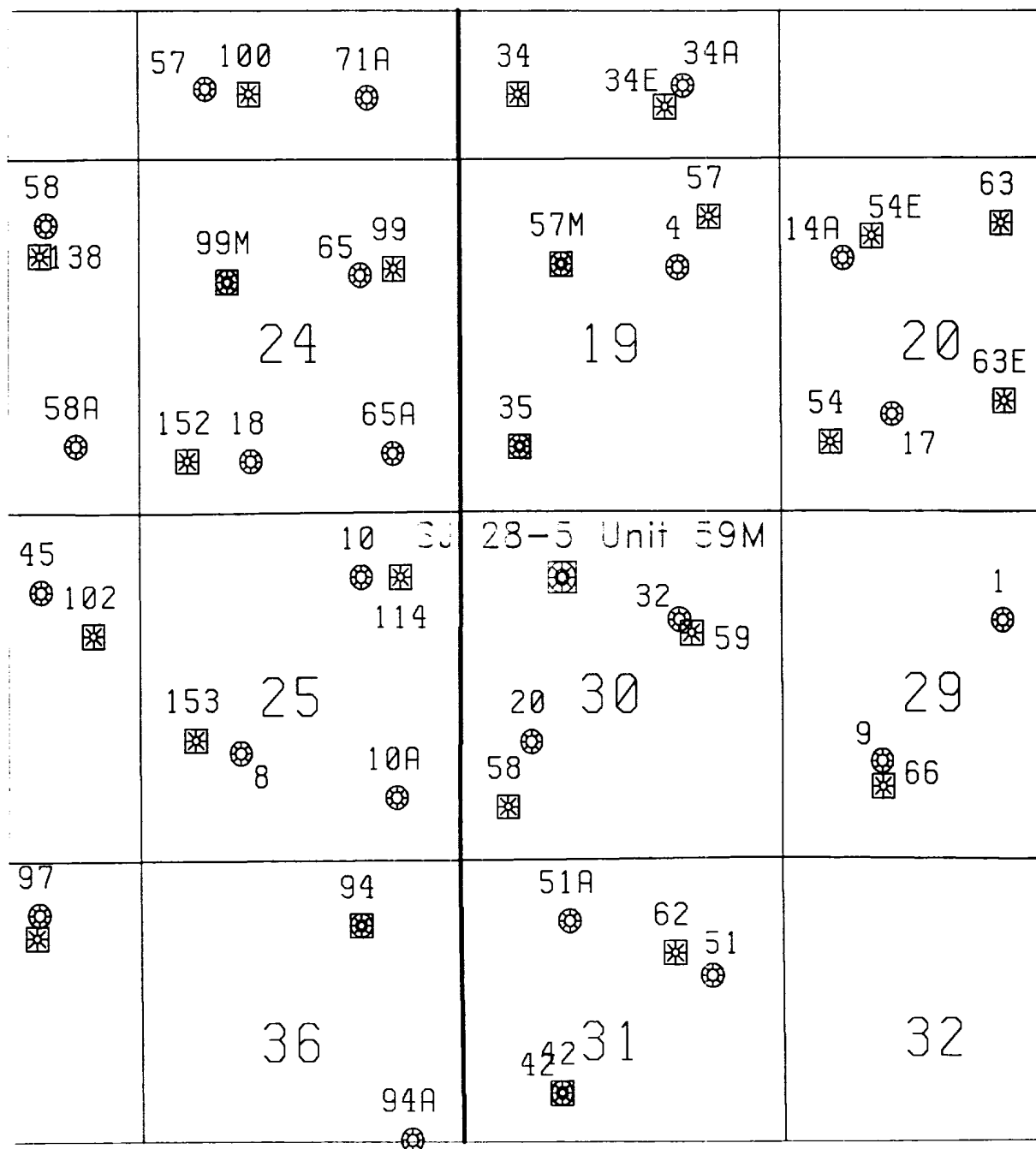

PLH 5/7/98

*SJ 28-5 Unit 59M*  
*Sec. 30, T28N, R5W*  
*Mesaverde/Dakota*

STATE OF NEW MEXICO  
ENERGY, MINERALS AND NATURAL RESOURCES DEPARTMENT  
OIL CONSERVATION DIVISION

IN THE MATTER OF THE HEARING CALLED  
BY THE OIL CONSERVATION DIVISION FOR  
THE PURPOSE OF CONSIDERING:

CASE NO. 11627  
ORDER NO. R-10695

APPLICATION OF BURLINGTON RESOURCES  
OIL & GAS COMPANY FOR THE ESTABLISHMENT  
OF A DOWNHOLE COMMINGLING "REFERENCE  
CASE" FOR ITS SAN JUAN 28-5 UNIT PURSUANT  
TO DIVISION RULE 303.E. AND THE ADOPTION  
OF SPECIAL ADMINISTRATIVE RULES THEREFOR,  
SAN JUAN COUNTY, NEW MEXICO.

ORDER OF THE DIVISION

BY THE DIVISION:

This cause came on for hearing at 8:15 a.m. on October 17 and November 7, 1996, at Santa Fe, New Mexico, before Examiners David R. Catanach and Michael E. Stogner, respectively.

NOW, on this 12th day of November, 1996, the Division Director, having considered the testimony, the record and the recommendations of the Examiner, and being fully advised in the premises,

FINDS THAT:

(1) Due public notice having been given as required by law, the Division has jurisdiction of this cause and the subject matter thereof.

(2) The applicant, Burlington Resources Oil & Gas Company (Burlington), pursuant to the provisions of Division Rule 303.E., seeks to establish a downhole commingling "reference case" to provide exceptions for (a) marginal economic criteria, (b) pressure criteria, (c) allocation formulas and (d) modification of notification rules on a unit-wide basis for downhole commingling of Dakota, Mesaverde, Fruitland Coal and Pictured Cliffs gas production within existing or future drilled wells within the San Juan 28-5 Unit, San Juan County, New Mexico.

(3) Division Rule No. 303.E., amended by Order No. R-10470-A, currently states:

"If sufficient data exists on a lease, pool, formation, geographic area, etc., so as to render it unnecessary to repeatedly provide such data on Form C-107-A, an operator may except any of the various criteria required under Paragraph 303.D. of this rule by establishing a "reference case". The Division, upon its own motion, or by application from an operator, may establish "reference cases" either administratively or by hearing. Upon Division approval of such "reference cases" for specific criteria, subsequent applications to downhole commingle (Form C-107-A) will be required only to cite the Division order number which established such exceptions and shall not be required to submit data for those criteria."

(4) The applicant is the current operator of the San Juan 28-5 Unit which encompasses some 17,399 acres in Township 28 North, Range 5 West, NMPM, San Juan County, New Mexico.

(5) Within the San Juan 28-5 Unit, the applicant currently operates sixty-seven (67) Basin-Dakota Gas Pool wells, seventy-one (71) Blanco-Mesaverde Gas Pool wells, sixteen (16) Gobernador-Pictured Cliffs, Oso-Pictured Cliffs and Tapacito-Pictured Cliffs Gas Pool wells, and nineteen (19) Basin-Fruitland Coal Gas Pool wells.

(6) According to its evidence and testimony, Burlington seeks to:

- a) establish a "reference case" for marginal economic criteria in the Dakota and Pictured Cliffs formations whereby these formations and/or pools may be identified as "marginal" on Form C-107-A's subsequently filed for wells within the San Juan 28-5 Unit. The applicant further proposes that the data provided in the immediate case serve as supplemental data or confirmation that these formations and/or pools should be classified as "marginal";
- b) establish a "reference case" for pressure criteria in the Dakota and Pictured Cliffs formations whereby the Division may utilize data provided in the immediate case to verify the pressure data provided on Form C-107-A's subsequently filed for wells within the San Juan 28-5 Unit;

- c) establish a "reference case" whereby the Division utilizes the data presented in the immediate case to endorse or approve certain methods of allocating production whereby the applicant need not submit additional data or justification when proposing a certain method of allocating production on Form C-107-A's subsequently filed for wells within the San Juan 28-5 Unit; and,
- d) establish a "reference case" or an administrative procedure for authorizing the downhole commingling of existing or future drilled wells within the San Juan 28-5 Unit without additional notice to each affected interest owner as required by Division Rule No. 303.D.

(7) In support of its request to except marginal economic criteria, the applicant presented geologic and engineering evidence and testimony which indicates that within the San Juan 28-5 Unit:

- a) the structure and thickness of the Dakota and Pictured Cliffs formations are very consistent;
- b) the average recoverable Dakota and Pictured Cliffs gas reserves underlying an undeveloped drill block are approximately 1,258 MMCFG and 77 MMCFG, respectively;
- c) the average initial producing rate for a newly drilled or recompleted Dakota and Pictured Cliffs gas well is approximately 276 MCFGD and 136 MCFGD, respectively; and,
- d) the estimated ultimate gas recoveries and initial producing rates from the Dakota and Pictured Cliffs formations are insufficient to justify drilling stand alone wells and/or dually completed wells to recover such gas reserves.

(8) The evidence and testimony presented by the applicant indicates that the Dakota and Pictured Cliffs formations within the San Juan 28-5 Unit should be properly classified as "marginal".

(9) In support of its request to except pressure criteria within the Dakota and Pictured Cliffs formations within the San Juan 28-5 Unit, the applicant presented engineering evidence and testimony which indicates that:

- a) the average shut-in bottomhole pressure within the Dakota and Pictured Cliffs formations at the time of initial development were approximately 3,149 psi and 1,143 psi, respectively; and.
- b) the average current shut-in bottomhole pressure within the Dakota and Pictured Cliffs formations are approximately 1,059 psi and 714 psi, respectively.

(10) There is sufficient pressure data available within the San Juan 28-5 Unit so as to except pressure criteria as proposed by the applicant.

(11) The applicant testified that various allocation methods will be utilized for downhole commingled wells within the San Juan 28-5 Unit depending on the circumstances. Some of the methods and circumstances are described as follows:

- a) the subtraction method will likely be utilized in those instances involving the Basin-Fruitland Coal Gas Pool and in those instances where a zone with a well established decline rate is commingled with a newly completed zone;
- b) a fixed allocation formula will be utilized in those instances where production history for both zones is available, or in those instances where newly completed zones are tested and stabilized flow rates obtained.

(12) The allocation methods proposed by the applicant are routinely utilized by industry and approved by the Division and therefore, the proposal to except allocation formulas should be approved.

(13) In support of its request to establish a "reference case" or administrative procedure for providing notice within the San Juan 28-5 Unit the applicant presented evidence and testimony which indicates that:

- a) the interest ownership between two zones within a given wellbore in the San Juan 28-5 Unit is generally not common;
- b) pursuant to Division Rule No. 303.D., applicant is currently required to notify all interest owners within the San Juan 28-5 Unit every time a Form C-107-A is submitted to the Division. There are a considerable number of such interest owners within the unit;

- c) providing notice to each interest owner within the San Juan 28-5 Unit of subsequent downhole comminglings is unnecessary and is an excessive burden on the applicant;
- d) the downhole commingling of wells within the San Juan 28-5 Unit Area will benefit working, royalty, and overriding royalty interest owners. In addition, the downhole commingling of wells within the San Juan 28-5 Unit should not violate the correlative rights of any interest owner;
- e) no interest owner appeared at the hearing in opposition to the establishment of a "reference case" or administrative procedure for notice.

(14) An administrative procedure should be established within the San Juan 28-5 Unit for obtaining approval for subsequent downhole commingled wells without notice to Unit interest owners, provided however that, all other provisions contained within Division Rule No. 303.C. are complied with.

(15) Approval of the proposed "reference cases" for marginal economic criteria, pressure criteria, allocation formulas and notice will lessen the burden on the applicant insofar as providing the data required pursuant to Division Rule No. 303.D. and Form C-107-A, will provide the applicant a streamlined method for obtaining downhole commingling approvals within the San Juan 28-5 Unit, and will not violate correlative rights.

**IT IS THEREFORE ORDERED THAT:**

(1) The application of Burlington Resources Oil & Gas Company to establish a "reference case" for (a) marginal economic criteria, (b) pressure criteria, (c) allocation formulas and (d) modification of notification rules on a unit-wide basis for downhole commingling of Dakota, Mesaverde, Fruitland Coal and Pictured Cliffs gas production within existing or future drilled wells within the San Juan 28-5 Unit, San Juan County, New Mexico, is hereby approved.



(2) Upon filing of Division Form No. C-107-A's for wells subsequently downhole commingled within the San Juan 28-5 Unit Area, the applicant shall not be required to submit supporting data to justify the classification of the Pictured Cliffs and Dakota formations as "marginal", supporting data to verify the Pictured Cliffs and Dakota pressure information provided, and support or justification for utilizing a given method or formula for allocation of production, provided however, in the event any of the data described above appearing on Form C-107-A appears to be beyond the data range provided in this case, the Division may require the submittal of additional supporting data.

(3) In order to obtain Division authorization to downhole commingle wells within the San Juan 28-5 Unit, the applicant shall file a Form C-107-A with the Santa Fe and Aztec Offices of the Division. Such application shall contain all the information required under Rule No. 303.C. of the Division Rules and Regulations, provided however that the applicant shall not be required to provide notice to all interest owners within the San Juan 28-5 Unit of such proposed commingling.

(4) Jurisdiction of this cause is retained for the entry of such further orders as the Division may deem necessary.

DONE at Santa Fe, New Mexico, on the day and year hereinabove designated.

STATE OF NEW MEXICO  
OIL CONSERVATION DIVISION

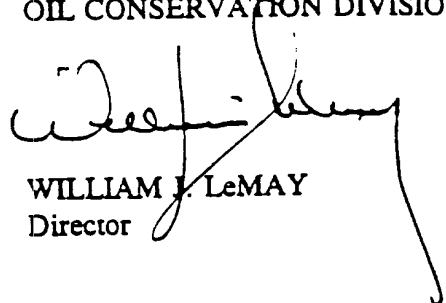

WILLIAM J. LeMAY  
Director

S E A L