

UNITED STATES
DEPARTMENT OF THE INTERIOR
GEOLOGICAL SURVEY

30-039-24002
SF-078498

APPLICATION FOR PERMIT TO DRILL, DEEPEN, OR PLUG BACK

1a. TYPE OF WORK
 DRILL DEEPEN PLUG BACK

b. TYPE OF WELL
 OIL WELL GAS WELL OTHER
 SINGLE ZONE MULTIPLE ZONE

2. NAME OF OPERATOR
 Tenneco Oil Company

3. ADDRESS OF OPERATOR
 P. O. Box 3249, Englewood, CO 80155

4. LOCATION OF WELL (Report location clearly and in accordance with any State requirements.)
 At surface 1300' FNL, 1840' FWL
 At proposed prod. zone

14. DISTANCE IN MILES AND DIRECTION FROM NEAREST TOWN OR POST OFFICE
 22 miles SE Blanco, NM

15. DISTANCE FROM PROPOSED* LOCATION TO NEAREST PROPERTY OR LEASE LINE, FT. (Also to nearest drlg. unit line, if any)
 1300'

16. NO. OF ACRES IN LEASE
 1.988A

17. NO. OF ACRES ASSIGNED TO THIS WELL
 W 320A

18. DISTANCE FROM PROPOSED LOCATION* TO NEAREST WELL, DRILLING, COMPLETED, OR APPLIED FOR, ON THIS LEASE, FT.

19. PROPOSED DEPTH
 +/- 5925' KB

20. ROTARY OR CABLE TOOLS
 Rotary

21. ELEVATIONS (Show whether DF, RT, GR, etc.)
 6580' GL DRILLING OPERATIONS AUTHORIZED ARE

22. APPROX. DATE WORK WILL START*
 ASAP

23. SUBJECT TO COMPLIANCE WITH ATTACHED PROPOSED CASING AND CEMENTING PROGRAM "GENERAL REQUIREMENTS"

This action is subject to technical and procedural review pursuant to 43 CFR 3165.3 and appeal pursuant to 43 CFR 3165.4.

SIZE OF HOLE	SIZE OF CASING	WEIGHT PER FOOT	SETTING DEPTH	
12 1/4"	9 5/8"	36.0#	+/- 280' KB	200 sx, 236 CF
8 3/4"	7"	23.0#	+/- 3675' KB	650 sx, 1130 CF
6 1/4"	4 1/2"	10.50#	+/- 5925' KB	295 sx, 444 CF

See attachments.

The gas is dedicated.

Note: Well was previously staked & inspected as the San Juan 28-7 Unit # 135M.

R
 FEB 27 1986
 OIL CON. DIV.
 DIST 3

IN ABOVE SPACE DESCRIBE PROPOSED PROGRAM: If proposal is to deepen or plug back, give data on present productive zone and proposed new productive zone. If proposal is to drill or deepen directionally, give pertinent data on subsurface locations and measured and true vertical depths. Give blowout preventer program, if any.

24. SIGNED Scott McKinney TITLE Senior Regulatory Analyst DATE 1/10/86

(This space for Federal or State office use)

PERMIT NO. _____ APPROVAL DATE _____

APPROVED BY _____ TITLE _____ DATE _____

CONDITIONS OF APPROVAL, IF ANY:

Hold C-104
for 1986

NMOCC

John Kelly
 AREA MANAGER

NEW MEXICO OIL CONSERVATION COMMISSION
WELL LOCATION AND ACREAGE DEDICATION PLAT

Form C-102
Supersedes C-128
Effective 1-1-65

All distances must be from the outer boundaries of the Section.

Operator TENNECO OIL CO.		Lease SAN JUAN 28-7 UNIT(SF 078498)		Well No. 45A
Unit Letter C	Section 27	Township 28N	Range 7W	County Rio Arriba
Actual Footage Location of Well: 1300 feet from the North line and 1840 feet from the West line				
Ground Level Elev. 6580	Producing Formation Mesa Verde	Pool Blanco Mesaverde	Dedicated Acreage: 320 Acres	

1. Outline the acreage dedicated to the subject well by colored pencil or hachure marks on the plat below.
2. If more than one lease is dedicated to the well, outline each and identify the ownership thereof (both as to working interest and royalty).
3. If more than one lease of different ownership is dedicated to the well, have the interests of all owners been consolidated by communitization, unitization, force-pooling, etc?

Yes No If answer is "yes," type of consolidation Unitization

If answer is "no," list the owners and tract descriptions which have actually been consolidated. (Use reverse side of this form if necessary.) _____

No allowable will be assigned to the well until all interests have been consolidated (by communitization, unitization, forced-pooling, or otherwise) or until a non-standard unit, eliminating such interests, has been approved by the Commission.

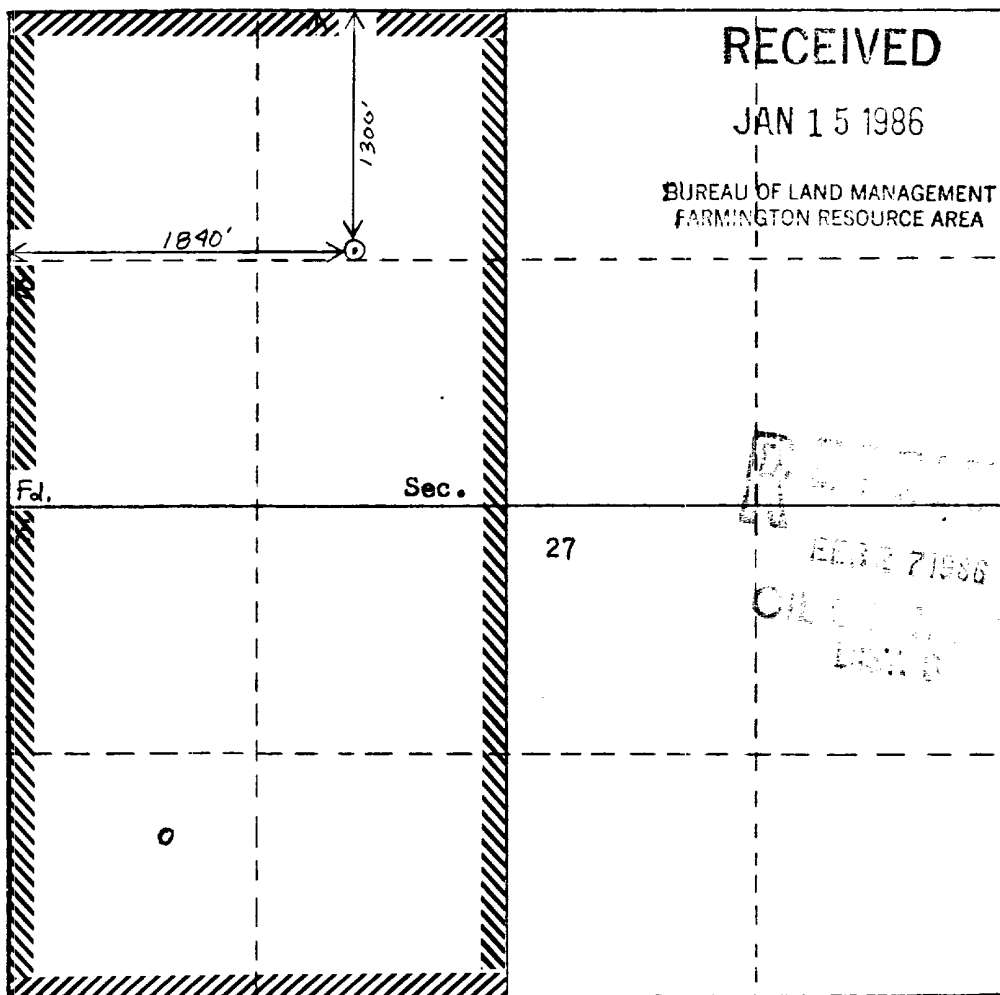

Scale: 1"=1000'

CERTIFICATION	
I hereby certify that the information contained herein is true and complete to the best of my knowledge and belief.	
<i>Scott McKinney</i>	
Name	Scott McKinney
Position	Sr. Regulatory Analyst
Company	Tenneco Oil Co.
Date	January 9, 1986
I hereby certify that the well location shown on this plat was plotted from field notes of actual surveys made by me or under my supervision, and that the same is true and correct to the best of my knowledge and belief.	
Date Surveyed	JAN 9 1986
Registered Professional Engineer and Land Surveyor	8466
Certificate No.	8466

