

UNITED STATES
DEPARTMENT OF THE INTERIOR
BUREAU OF LAND MANAGEMENT

30-029-25172

APPLICATION FOR PERMIT TO DRILL, DEEPEN, OR PLUG BACK

1a. TYPE OF WORK

DRILL ☒

DEEPEN ☐

PLUG BACK ☐

b. TYPE OF WELL

OIL
WELL ☐

GAR
WELL ☒

OTHER

Coal Seam

SINGLE
ZONE ☒

MULTIPLE
ZONE ☐

2. NAME OF OPERATOR

Amoco Production Company

ATTN: J. L. Hampton

3. ADDRESS OF OPERATOR

P. O. Box 800 Denver, Colorado 80201

4. LOCATION OF WELL (Report location clearly and in accordance with any State requirements.)

At surface

1450' FSL, 1450' FWL NE/SW Unit "K"

At proposed prod. zone

14. DISTANCE IN MILES AND DIRECTION FROM NEAREST TOWN OR POST OFFICE*

40 Miles-Aztec, NM

10. DISTANCE FROM PROPOSED*

LOCATION TO NEAREST

PROPERTY OR LEASE LINE, FT.

(Also to nearest drlg. unit line, if any)

1450'

16. NO. OF ACRES IN LEASE

960.00

17. NO. OF ACRES ASSIGNED
TO THIS WELL.

320 acres W 1/2

18. DISTANCE FROM PROPOSED LOCATION*

TO NEAREST WELL, DRILLING, COMPLETED,
OR APPLIED FOR, ON THIS LEASE, FT.

19. PROPOSED DEPTH

3649' TD

20. ROTARY OR CABLE TOOLS

Rotary

21. ELEVATIONS (Show whether DE, RT, GR, etc.)

6692'

GR

22. APPROX. DATE WORK WILL START*

As soon as permitted

23. This action is subject to technical and
procedural review pursuant to 43 CFR 3165.3
and appeal pursuant to 43 CFR 3165.4

SIZE OF HOLE	SIZE OF CASING	WEIGHT PER FOOT	SETTING DEPTH
12 1/4"	8 5/8"	24#	250'
7 7/8"	5 1/2"	17#	3649' (TD)

DRILLING OPERATIONS AUTHORIZED ARE
SUBJECT TO COMPLIANCE WITH ATTACHED
GENERAL REQUIREMENTS
250 cf (cement to surface)
1022 cf (cement to surface)

Notice of Staking was submitted: 10/30/90

Lease Description:

T28N-R7W

Sec. 13: W/2

SEC. 23: E/2

Sec. 24: E/2

RECEIVED

APR 1 1992

OIL CON. DIV
DIST. 3

Replacement APD for expired permit.

IN ABOVE SPACE DESCRIBE PROPOSED PROGRAM: If proposal is to deepen or plug back, give data on present productive zone and proposed new productive zone. If proposal is to drill or deepen directionally, give pertinent data on subsurface locations and measured and true vertical depths. Give blowout preventer program, if any.

24. J. L. Hampton

SIGNED

J. L. Hampton

TITLE Sr. Staff Admin. Supv.

(This space for Federal or State office use)

PERMIT NO.

APPROVAL DATE

APPROVED BY

CONDITIONS OF APPROVAL, IF ANY:

TITLE

NMOOD

APPROVED
AS AMENDED

MAR 3 1992

AREA MANAGER

*See Instructions On Reverse Side

Title 18 U.S.C. Section 1001, makes it a crime for any person knowingly and willfully to make to any department or agency of the United States any false, fictitious or fraudulent statements or representations as to any matter within its jurisdiction.

03013022

2000

1000

1000

000000

000000

Submit to Appropriate
District Office
State Lease - 4 copies
Fee Lease - 3 copies

State of New Mexico
Energy, Minerals and Natural Resources Department

Form C-102
Revised 1-1-89

OIL CONSERVATION DIVISION

DISTRICT I
P.O. Box 1980, Hobbs, NM 88240

P.O. Box 2088
Santa Fe, New Mexico 87504-2088

DISTRICT II
P.O. Drawer DD, Artesia, NM 88210

DISTRICT III
1000 Rio Brazos Rd., Aztec, NM 87410

WELL LOCATION AND ACREAGE DEDICATION PLAT

All Distances must be from the outer boundaries of the section

Operator AMOCO PRODUCTION COMPANY			Lease SAN JUAN 28-7 UNIT		Well No. # 417
Unit Letter K	Section 13	Township 28 NORTH	Range 7 WEST	County RIO ARRIBA	
Actual Footage Location of Well: 1450 feet from the SOUTH line and 1450 feet from the WEST line					
Ground level Elev. 6692	Producing Formation Fruitland Coal	Pool Basin Fruitland Coal Gas		Dedicated Acreage: w/2 320.00 Acres	
<p>1. Outline the acreage dedicated to the subject well by colored pencil or hatchure marks on the plat below.</p> <p>2. If more than one lease is dedicated to the well, outline each and identify the ownership thereof (both as to working interest and royalty).</p> <p>3. If more than one lease of different ownership is dedicated to the well, have the interest of all owners been consolidated by communitization, unitization, force-pooling, etc.? <input type="checkbox"/> Yes <input type="checkbox"/> No If answer is "yes" type of consolidation _____</p> <p>If answer is "no" list the owners and tract descriptions which have actually been consolidated. (Use reverse side of this form if necessary.) _____</p> <p>No allowable will be assigned to the well until all interests have been consolidated (by communitization, unitization, forced-pooling, or otherwise) or until a non-standard unit, eliminating such interest, has been approved by the Division.</p>					

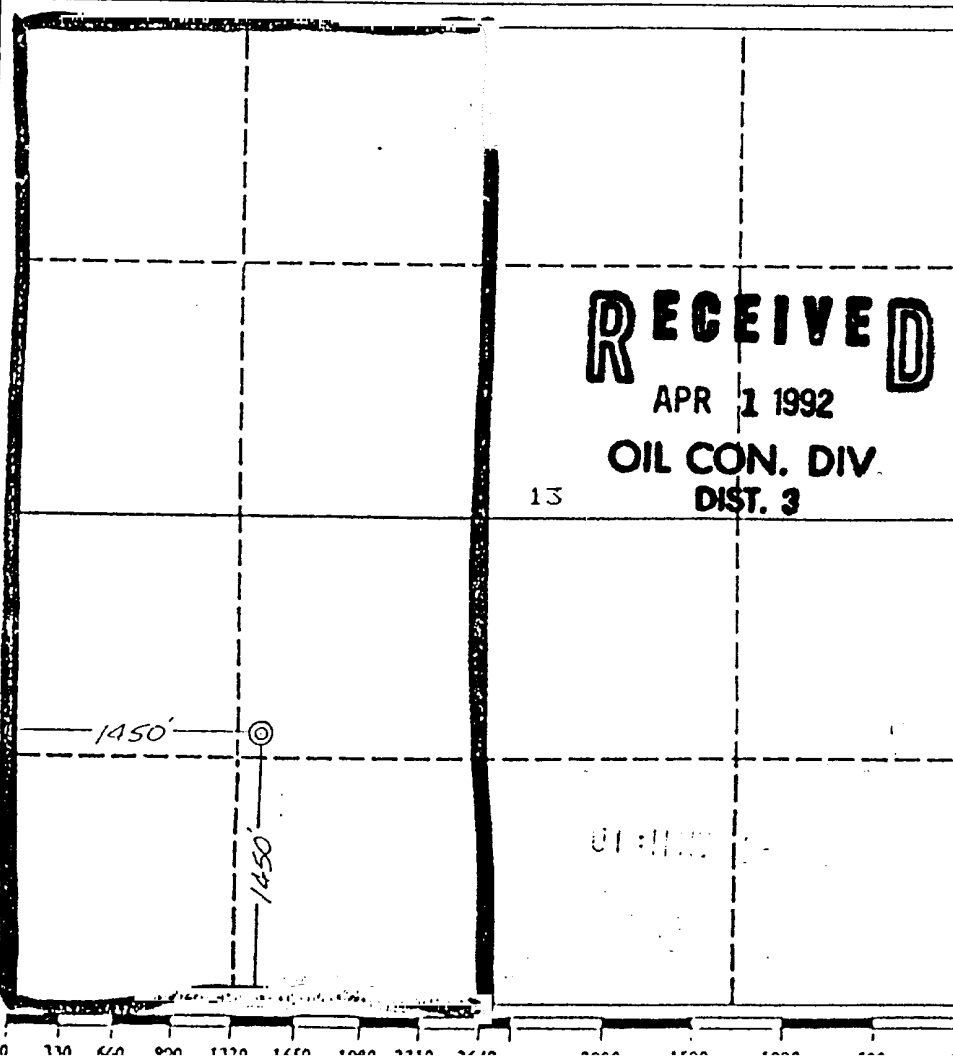

OPERATOR CERTIFICATION I hereby certify that the information contained herein is true and complete to the best of my knowledge and belief.	
Signature <i>J. Hampton</i>	RECEIVED
Printed Name J. L. Hampton	
Position Sr Staff Admin Supr	
Company Amoco Prod	
Date 10-26-90	
SURVEYOR CERTIFICATION I hereby certify that the well location shown on this plat was plotted from field notes of actual surveys made by me or under my supervision, and that the same is true and correct to the best of my knowledge and belief.	
Date Surveyed October 1, 1990	
Signature & Seal of Professional Surveyor <i>Gary D. Vann</i>	RECEIVED NEW MEXICO 2016 GARY D. VANN REGISTERED PROFESSIONAL LAND SURVEYOR
Certification No. 7016	

RECEIVED
JAN 10 1964

U.S. DEPARTMENT OF AGRICULTURE

OFFICE OF THE SECRETARY

WASHINGTON, D.C.

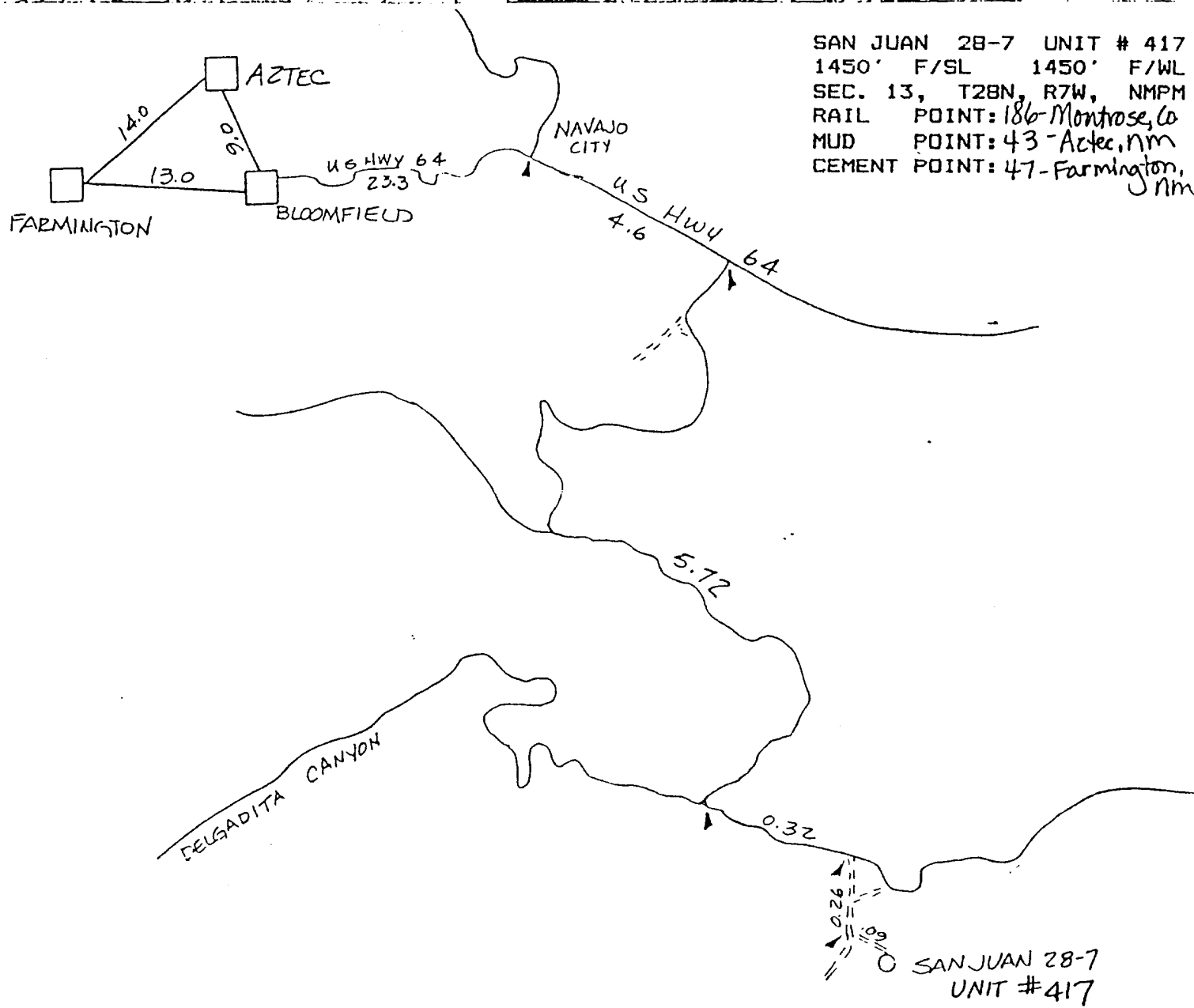
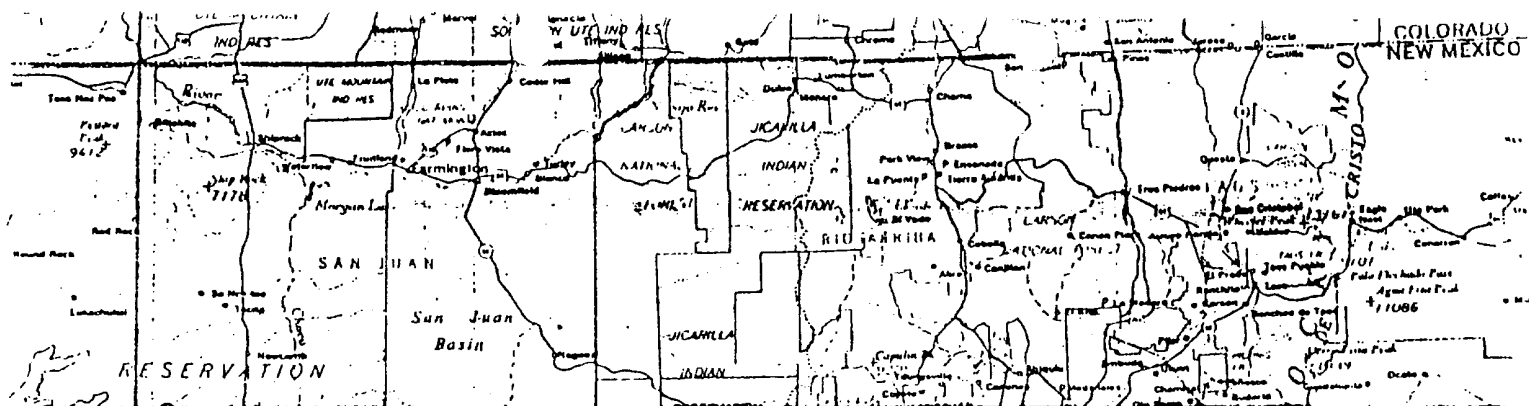

DEVIATION REPORT

Name of Company MERIDIAN OIL INC. AMOCO		Address PO Box 4289, Farmington, NM		
Lease Name & Number San Juan 28-7 Unit #417	Unit Letter K	Sec. 13	TwN 28N	Rge 7W
Pool and Formation Basin Fruitland Coal		County Rio Arriba		

Depth (Ft.)	Deviation (Degrees)
246'	1/4
751'	3/4
1250'	3/4
1780'	1
2276'	3/4
2774'	3/4
3273'	1 1/4

Depth (Ft.)	Deviation (Degrees)
----------------	------------------------

RECEIVED
FEB 3 1993
OIL CON. DIV.
DIST. 3

I, the undersigned, certify that I, acting in my capacity as Petroleum Engineer for **MERIDIAN OIL INC.**, am authorized by said Company to make this report; and that this report was prepared under my supervision and directions, and that the facts stated herein are true to the best of my knowledge and belief.

Subscribed and sworn to before me this 11th day of November, 1992.

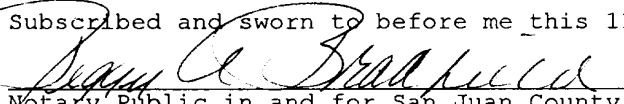
Notary Public in and for San Juan County, New Mexico
My commission expires August 17, 1996.

UNITED STATES
DEPARTMENT OF THE INTERIOR
BUREAU OF LAND MANAGEMENT

Sundry Notices and Reports on Wells

1. Type of Well
GAS

2. Name of Operator

~~Meridian Oil Inc.~~ *NMOOD*

3. Address & Phone No. of Operator

PO Box 4289, Farmington, NM 87499 (505) 326-9700

4. Location of Well, Footage, Sec., T, R, M

1450' FSL, 1450' FWL Sec. 13, T-28-N, R-7-W, NMPM

5. Lease Number
SF-079290A

6. If Indian, All. or
Tribe Name

7. Unit Agreement Name

San Juan 28-7 Unit
8. Well Name & Number
San Juan 28-7 U #417

9. API Well No.
30-039-25035 *25178*

10. Field and Pool
Basin Frt Coal

11. County and State
Rio Arriba Co, NM

12. CHECK APPROPRIATE BOX TO INDICATE NATURE OF NOTICE, REPORT, OTHER DATA

Type of Submission

Type of Action

☐ Notice of Intent

☐ Abandonment

☐ Change of Plans

☒ Subsequent Report

☐ Recompletion

☐ New Construction

☐ Final Abandonment

☐ Plugging Back

☐ Non-Routine Fracturing

☐ Casing Repair

☐ Water Shut off

☐ Altering Casing

☐ Conversion to Injection

☐ Other -

13. Describe Proposed or Completed Operations

11-04-92 Spudded well at 12 noon. Drilled to 246'. Ran 5 jts. 8 5/8", 24.0#, K-55 surface casing set at 242'. Cemented with 235 sks. Class "B" with 3% calcium chloride and 1/4#/sx flocele (277 cu.ft.) circulated to surface. WOC 12 hrs. Tested 600#/30 min., ok.

11-08-92 TD 3493'. Ran 85 jts. 4 1/2", 10.5#, K-55 casing, 3481' set @ 3493'. Float collar set @ 3448'. Stage tool @ 2753'. Cemented first stage with 155 sks. Class "B" 65/35 Pozmix, 6% gel, 5#/sx gilsonite, 1/4#/sx cello-seal and 2% calcium chloride, (274 cu.ft.) followed by 80 sks. Class "B" w/2% calcium chloride (94 cu.ft.), 2nd stage with 735 sks. Class "B" 65/35 Pozmix, 6% gel, 2% calcium chloride, 5#/sx gilsonite, and 1/4#/sx cello-seal (1301 cu.ft.), tailed w/100 sx Class "B" w/2% calcium chloride (118 cu.ft.). WOC 18 hours. Circ 20 bbl. to surface.

14. I hereby certify that the foregoing is true and correct.

Signed *James D. Hall* Title Regulatory Affairs Date 11/11/92

(This space for Federal or State Office use)

APPROVED BY _____ Title _____

CONDITION OF APPROVAL, if any:

ACCEPTED FOR RECORD

Date _____

NOV 11 1992

NMOOD

RECEIVED FOR RECORD

DEPARTMENT OF THE INTERIOR
BUREAU OF LAND MANAGEMENT

(See other instructions on reverse side)

Expires: December 31, 1991

5. LEASE DESIGNATION AND SERIAL NO.

SF-079290A

6. IF INDIAN, ALLOTTEE OR TRIBE NAME

7. UNIT AGREEMENT NAME

San Juan 28-7 Unit

8. FARM OR LEASE NAME, WELL NO.

San Juan 28-7 Unit#417

9. API WELL NO.

30-039-25035

10. FIELD AND POOL, OR WILDCAT

Basin Fruitland Coal

11. SEC., T., R., M., OR BLOCK AND SURVEY OR AREA

Sec.13, T-28-N, R-7-W
NMMPM

12. COUNTY OR PARISH

Rio Arriba

13. STATE

NM

WELL COMPLETION OR RECOMPLETION REPORT AND LOG *

1a. TYPE OF WELL: OIL WELL ☐ GAS WELL ☒ DRY ☐ Other _____

b. TYPE OF COMPLETION:

NEW WELL ☐ WORK OVER ☐ DEEP-EN ☐ PLUG BACK ☐ DIFF. REVR. ☐ Other _____

2. NAME OF OPERATOR

Meridian Oil Inc. Ameca prod. Co.

3. ADDRESS AND TELEPHONE NO.

PO Box 4289, Farmington, NM 87409

4. LOCATION OF WELL (Report location clearly and in accordance with any State requirements)*

At surface 1450'FSL, 1450'FWL

At top prod. interval reported below

At total depth

14. PERMIT NO.

DATE ISSUED

15. DATE SPUDDED

11-04-92

16. DATE T.D. REACHED

11-07-92

17. DATE COMPL. (Ready to prod.)

12-02-92

18. ELEVATIONS (DF, RKB, RT, GR, ETC.)*

6692'GL

19. ELEV. CASINGHEAD

20. TOTAL DEPTH, MD & TVD

3493'

21. PLUG, BACK T.D., MD & TVD

22. IF MULTIPLE COMPL. HOW MANY?

23. INTERVALS DRILLED BY

ROTARY TOOLS

CABLE TOOLS

24. PRODUCING INTERVAL(S). OF THIS COMPLETION—TOP, BOTTOM, NAME (MD AND TVD)*

Fruitland Coal (3276-3439)

FEB 1 1993

25. WAS DIRECTIONAL SURVEY MADE

no

26. TYPE ELECTRIC AND OTHER LOGS RUN

DIL, DENS, NEUT, GR, ML, GR

OIL CON. DIV.
DIST. 3

27. WAS WELL CORRED

no

28. CASING RECORD (Report all strings set in well)

CASING SIZE/GRADE	WEIGHT, LB./FT.	DEPTH SET (MD)	HOLE SIZE	TOP OF CEMENT, CEMENTING RECORD	AMOUNT PULLED
8 5/8"	24.0#	241'	12 1/4"	277 cf 235	
4 1/2"	10.5#	3493'	7 7/8"	1787 cf 1070	

29. LINER RECORD

SIZE	TOP (MD)	BOTTOM (MD)	BACKS CEMENT*	SCREEN (MD)	SIZE	DEPTH SET (MD)	PACKER SET (MD)
					2 3/8"	3456'	

31. PERFORATION RECORD (Interval, size and number)

3276-80', 3284-88', 3298-3304',
3321-58', 3413-39'

32. ACID, SHOT, FRACTURE, CEMENT, SQUEEZE, ETC.

DEPTH INTERVAL (MD)	AMOUNT AND KIND OF MATERIAL USED
3276-3439'	174,500#20/40 sand, N2 and foam

33. PRODUCTION

DATE FIRST PRODUCTION		PRODUCTION METHOD (Flowing, gas lift, pumping—size and type of pump)					WELL STATUS (Producing or shut-in)	
shut in, waiting on pipeline; capable of comm. hydrocarbon production								
DATE OF TEST	HOURS TESTED	CHOKE SIZE	PROD'N. FOR TEST PERIOD	OIL—BBL.	GAS—MCF.	WATER—BBL.	GAS-OIL RATIO	
			→					
FLOW, TUBING PRESS.	CASING PRESSURE	CALCULATED 24-HOUR RATE	OIL—BBL.	GAS—MCF.	WATER—BBL.	OIL GRAVITY-API (CORR.)		
SI 542	SI 539	→		1119 mcf/d	pitot gge			

34. DISPOSITION OF GAS (Sold, used for fuel, vented, etc.)

to be sold BHP @ 3423 597

TEST WITNESSED BY

35. LIST OF ATTACHMENTS

none

36. I hereby certify that the foregoing and attached information is complete and correct as determined from all available records.

SIGNED

[Signature]

TITLE

Regulatory Affairs

DATE

1-27-93

*(See Instructions and Spaces for Additional Data on Reverse Side)

Title 18 U.S.C. Section 1001, makes it a crime for any person knowingly and willfully to make to any department or agency of the United States any false, fictitious or fraudulent statements or representations as to any matter within its jurisdiction.

NMOCD

37. SUMMARY OF POROUS ZONES: (Show all important zones of porosity and contents thereof; cored intervals; and all drill-stem, tests, including depth interval tested, cushion used, time tool open, flowing and shut-in pressures, and recoveries):

FORMATION	TOP	BOTTOM	DESCRIPTION, CONTENTS, ETC.	NAME	TOP	
					MEAS. DEPTH	TRUE VERT. DEPTH

38.

GEOLOGIC MARKERS

Ojo Alamo	2530'	2719'	White, cr-gr ss.	Ojo Alamo	2530'	
Kirtland	2719'	3152'	Gry sh interbedded w/tight, gry, fine-gr ss.	Kirtland	2719'	
Fruitland	3152'	3440'	Dk gry-gry carb sh, coal, grn silts, light-med gry, tight, fine gr ss.	Fruitland	3152'	
Pictured Cliffs	3440'	3493'	Bn-Gry, fine grn, tight ss.	Pic.Cliffs	3440'	