

UNITED STATES
DEPARTMENT OF THE INTERIOR

BUREAU OF LAND MANAGEMENT

APPLICATION FOR PERMIT TO DRILL OR DEEPEN

Form approved.
Budget Bureau No.1004-0136
Expires: December 31, 1991

1a. TYPE OF WORK

DRILL ☒

DEEPEEN ☐

b. TYPE OF WELL

OIL WELL ☐

GAS WELL ☒

OTHER

SINGLE ZONE ☐

MULTIPLE ZONE ☒

2. NAME OF OPERATOR

Attention:

Amoco Production Company

Bobbe Bren-Carley

3. ADDRESS AND TELEPHONE NO.

P.O. Box 800, Denver, Colorado 80201

(303) 830-4542

4. LOCATION OF WELL (Report locat on clearly and in accordance with any State requirements. *)

At surface

800' FNL

1040' FWL

At proposed prod. zone

14. DISTANCE IN MILES AND DIRECTION FROM NEAREST TOWN OR POST OFFICE

15. DISTANCE FROM PROPOSED* LOCATION TO NEAREST PROPERTY OR LEASE LINE, FT. (Also to nearest drlg. unit line, if any)

16. NO. OF ACRES IN LEASE

1988

17. NO. OF ACRES ASSIGNED TO THIS WELL

320 W/2

18. DISTANCE FROM PROPOSED LOCATION* TO NEAREST WELL, DRILLING, COMPLETED, OR APPLIED FOR, ON THIS LEASE FT.

19. PROPOSED DEPTH

7500'

20. ROTARY OR CABLE TOOLS

Rotary

21. ELEVATIONS (Show whether DF, RT, GR., etc.)

6144

22. APPROX. DATE WORK WILL START*

10-01-93

23. PROPOSED CASING AND CEMENTING PROGRAM

SIZE OF HOLE	GRADE, SIZE OF CASING	WEIGHT PER FOOT	SETTING DEPTH	QUANTITY OF CEMENT
17 1/2"	13 3/8" J-55	61#	400'	625cf CI B W/2% CaCl2 (Cement to surface)
12 1/4"	9 5/8" J-55	36#	3170'	513cf CI B /1542cf CI B/129 cf CI B (")
8 3/4"	7" J-55	23#	6918'	727cf CI B/251cf CI B(Cement to surface)

Notice of Staking was submitted: 8-10-93

Lease Description:

T28N-R7W:

Sec. 27:W/2, W/2NE/4

Sec. 28:W/2

Sec. 29:E/2

Sec. 32:Lots 1,2,N/2 SE/4, NE/4 (E/2)

Sec. 33:Lots 1,2,3,4, N/2 S/2, N/2 (all)

RECEIVED
SEP 24 1993
OIL CON. DIV.
NOV 9 1993

IN ABOVE SPACE DESCRIBE PROPOSED PROGRAM: If proposal is to deepen, give data on present productive zone and proposed new productive zone. If proposal is to drill or deepen directionally, give pertinent data on subsurface locations and measured and true vertical depths. Give blowout preventer program, if any.

24.

SIGNED

Bobbe Bren-Carley

TITLE Sr. Bus. Analyst

DATE

09-10-1993

(This space for Federal or State office use.)

PERMIT NO.

APPROVAL DATE

Application approval does not warrant or certify that the applicant holds legal or equitable title to those rights in the subject lease which would entitle the applicant to conduct operations thereon.

CONDITIONS OF APPROVAL, IF ANY:

APPROVED BY

TITLE

SEP 21 1993
DATE

DISTRICT MANAGER

*See Instructions On Reverse Side

Title 18 U.S.C. Section 1001, makes it a crime for any person knowingly and willfully to make to any department or agency of the United States any false, fictitious or fraudulent statements or representations as to any matter within its jurisdiction.

Submit to Appropriate
District Office
State Lease - 4 copies
Fee Lease - 3 copies

Energy, Minerals and Natural Resources Department

Form C-102
Revised 1-1-89

OIL CONSERVATION DIVISION

DISTRICT I
P.O. Box 1980, Hobbs, NM 88240

P.O. Box 2088
Santa Fe, New Mexico 87504-2088

RECEIVED
BLM

DISTRICT II
P.O. Drawer DD, Artesia, NM 88210

DISTRICT III
1000 Rio Brazos Rd., Aztec, NM 87410

WELL LOCATION AND ACREAGE DEDICATION PLAT

All Distances must be from the outer boundaries of the section.

03 SEP 13 PM 12:51

070 FARMINGTON, NM

Operator AMOCO PRODUCTION COMPANY			Lease <i>San Juan Unit 28-7</i>		Well No. <i>193M</i>
Unit Letter D	Section 28	Township 28 NORTH	Range 7 WEST	County NMPM RIO ARRIBA	
Actual Footage Location of Well: 800 feet from the NORTH line and 1040 feet from the WEST line					
Ground level Elev. 6144	Producing Formation <i>Blanco Mesquite</i>		Pool <i>Blanco Mesquite</i>	Dedicated Acreage: 320 1/2 Acres	
<p>1. Outline the acreage dedicated to the subject well by colored pencil or hatchure marks on the plat below.</p> <p>2. If more than one lease is dedicated to the well, outline each and identify the ownership thereof (both as to working interest and royalty).</p> <p>3. If more than one lease of different ownership is dedicated to the well, have the interest of all owners been consolidated by communitization, unitization, force-pooling, etc.? <input type="checkbox"/> Yes <input type="checkbox"/> No If answer is "yes" type of consolidation _____</p> <p>If answer is "no" list the owners and tract descriptions which have actually been consolidated. (Use reverse side of this form if necessary.) _____</p> <p>No allowable will be assigned to the well until all interests have been consolidated (by communitization, unitization, forced-pooling, or otherwise) or until a non-standard unit, eliminating such interest, has been approved by the Division.</p>					

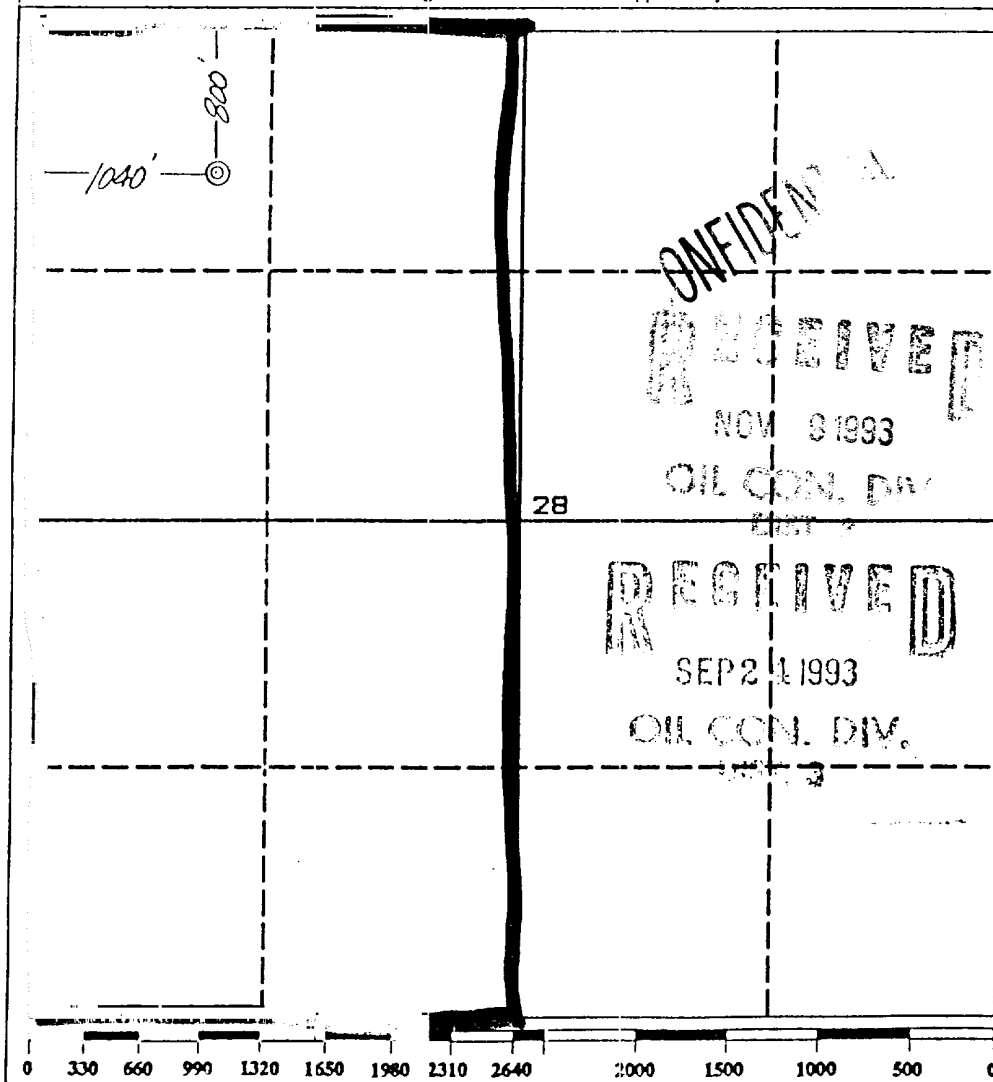

OPERATOR CERTIFICATION I hereby certify that the information contained herein is true and complete to the best of my knowledge and belief.	
Signature <i>Julie L. Acevedo</i>	Printed Name Julie L. Acevedo
Position <i>Sr. Staff Assistant</i>	Company <i>Amoco Production Co.</i>
Date <i>11-5-93</i>	
SURVEYOR CERTIFICATION I hereby certify that the well location shown on this plat was plotted from field notes of actual surveys made by me or under my supervision, and that the same is true and correct to the best of my knowledge and belief.	
Date Surveyed August 2, 1993	
Signature & Seal of Professional Surveyor <i>GARY D. VANN</i> 7016	
GARY Certification 7016	

Submit to Appropriate
District Office
State Lease - 4 copies
Fee Lease - 3 copies

STATE OF NEW MEXICO
Energy, Minerals and Natural Resources Department

Form C-102
Revised 1-1-89

OIL CONSERVATION DIVISION

DISTRICT I
P.O. Box 1980, Hobbs, NM 88240

P.O. Box 2088
Santa Fe, New Mexico 87504-2088

RECEIVED
BLM

DISTRICT II
P.O. Drawer DD, Artesia, NM 88210

DISTRICT III
1000 Rio Brazos Rd., Aztec, NM 87410

WELL LOCATION AND ACREAGE DEDICATION PLAT

All Distances must be from the outer boundaries of the section.

93 SEP 13 PM 12:51

070 FARMINGTON, NM

Operator AMOCO PRODUCTION COMPANY			Lease <i>San Juan Unit 28-7</i>		Well No. <i>193M</i>
Unit Letter D	Section 28	Township 28 NORTH	Range 7 WEST	County RIO ARriba	
Actual Footage Location of Well: 800 feet from the NORTH line and 1040 feet from the WEST line					
Ground level Elev. 6144	Producing Formation <i>Basin Dakota</i>		Pool <i>Basin Dakota</i>	Dedicated Acreage: 300 4/2 Acres	

- Outline the acreage dedicated to the subject well by colored pencil or hatchure marks on the plat below.
- If more than one lease is dedicated to the well, outline each and identify the ownership thereof (both as to working interest and royalty).
- If more than one lease of different ownership is dedicated to the well, have the interest of all owners been consolidated by communitization, unitization, force-pooling, etc.?
☐ Yes ☐ No If answer is "yes" type of consolidation _____
If answer is "no" list the owners and tract descriptions which have actually been consolidated. (Use reverse side of this form if necessary.) _____
No allowable will be assigned to the well until all interests have been consolidated (by communitization, unitization, forced-pooling, or otherwise) or until a non-standard unit, eliminating such interest, has been approved by the Division.

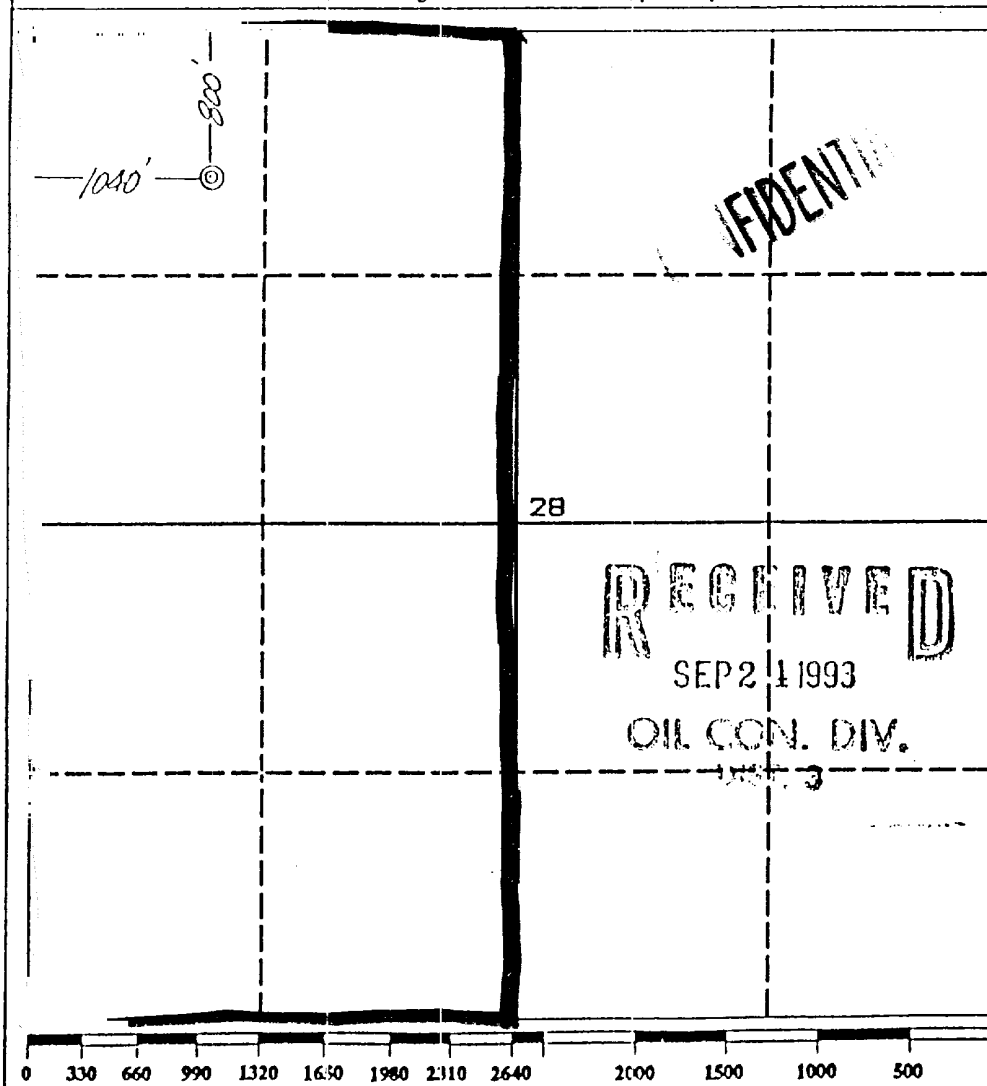

OPERATOR CERTIFICATION

I hereby certify that the information contained herein is true and complete to the best of my knowledge and belief.

Signature
Julie L. Acevedo
Printed Name
Julie L. Acevedo
Position
Sr. Staff Assistant
Company
Amoco Production Co
Date
11-5-93

SURVEYOR CERTIFICATION

I hereby certify that the well location shown on this plat was plotted from field notes of actual surveys made by me or under my supervision, and that the same is true and correct to the best of my knowledge and belief.

Date Surveyed
August 2, 1993

Signature & Seal of
Professional Surveyor
GARY D. VANN
7016
REGISTERED PROFESSIONAL LAND SURVEYOR

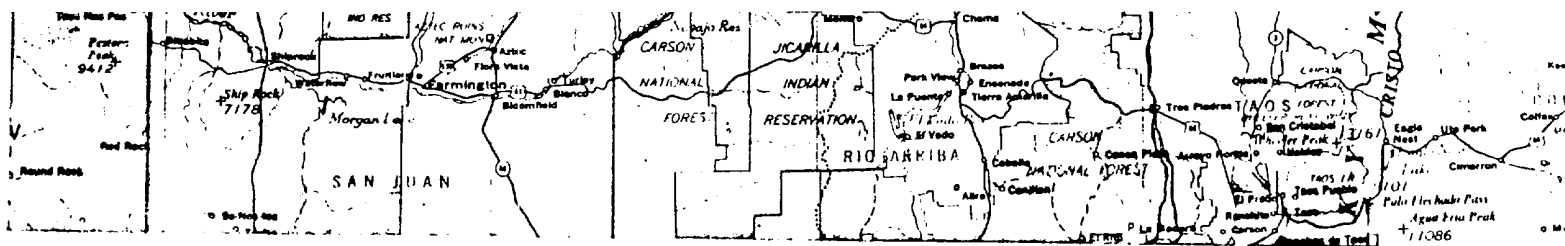

REF. # 553
 800' F/NL 1040' F/WL
 SEC. 28, T28N, R7W, NMPM
 RAIL POINT: 179.45 miles from Montrose
 MUD POINT: 36.45 miles from Aztec
 CEMENT POINT: 40.45 miles from Farmington

