

**UNITED STATES
DEPARTMENT OF THE INTERIOR**
BUREAU OF LAND MANAGEMENT

Form approved.
Budget Bureau No. 1004-0136
Expires: December 31, 1991

RECEIVED
BLM

APPLICATION FOR PERMIT TO DRILL OR DEEPEN

1a. TYPE OF WORK DRILL <input checked="" type="checkbox"/> DEEPEN <input type="checkbox"/>		5. LEASE DESIGNATION AND SERIAL NO. SF-079294	
b. TYPE OF WELL OIL WELL <input type="checkbox"/> GAS WELL <input checked="" type="checkbox"/> OTHER <input type="checkbox"/>		6. IF INDIAN, ALLOTTEE OR TRIBE NAME	
2. NAME OF OPERATOR Amoco Production Company <i>000778</i>		7. UNIT AGREEMENT NAME San Juan 28-7 Unit #221M	
3. ADDRESS AND TELEPHONE NO. P.O. Box 800, Denver, Colorado 80201 (303) 830-5427		8. FARM OR LEASE NAME, WELL NO. <i>1013</i>	
4. LOCATION OF WELL (Report location clearly and in accordance with any State requirements. *) At surface 1850' FSL 1850' FEL At proposed prod. zone		9. API WELL NO. <i>30-039-25358</i>	
14. DISTANCE IN MILES AND DIRECTION FROM NEAREST TOWN OR POST OFFICE* 40 miles from Aztec, NM		10. FIELD AND POOL, OR WILDCAT <i>72319 71599</i> Blanco Mesaverde/Basin Dakota	
15. DISTANCE FROM PROPOSED* LOCATION TO NEAREST PROPERTY OR LEASE LINE, FT. (Also to nearest drig. unit line, if any)		11. SEC., T., R., M., OR BLK. AND SURVEY OR AREA Section 25	
16. NO. OF ACRES IN LEASE 1136 acres		12. COUNTY OR PARISH <i>RA</i>	
17. NO. OF ACRES ASSIGNED TO THIS WELL E/320 acres E/2		13. STATE	
18. DISTANCE FROM PROPOSED LOCATION* TO NEAREST WELL, DRILLING, COMPLETED, OR APPLIED FOR, ON THIS LEASE, FT. 7179'		20. ROTARY OR CABLE TOOLS	
21. ELEVATIONS (Show whether DF, RT, GR., etc.) 6209' GR		22. APPROX. DATE WORK WILL START* <i>02-15-94</i>	
23. PROPOSED CASING AND CEMENTING PROGRAM <i>This section is subject to technical and procedural review pursuant to 43 CFR 3165.3 and appeal pursuant to 43 CFR 3165.4</i>			
24. IN ABOVE SPACE DESCRIBE PROPOSED PROGRAM: If proposal is to deepen, give data on present productive zone and proposed new productive zone. If proposal is to drill or deepen directionally, give pertinent data on subsurface locations and measured and true vertical depths. Give blowout preventer program, if any.			

CONFIDENTIAL

J

DRILLING OPERATIONS AUTHORIZED ARE SUBJECT TO COMPLIANCE WITH ATTACHED "GENERAL REQUIREMENTS" QUANTITY OF CEMENT

Notice of Staking submitted: 8/2/93 as the San Juan 28-7 Unit #221M

Lease Description:

T28N, R7W
Sec. 25: S/2
Sec. 26: SE/4
Sec. 36: All

RECEIVED
FEB 16 1994
OIL CON. DIV.
DIST. 3

CONFIDENTIAL

IN ABOVE SPACE DESCRIBE PROPOSED PROGRAM: If proposal is to deepen, give data on present productive zone and proposed new productive zone. If proposal is to drill or deepen directionally, give pertinent data on subsurface locations and measured and true vertical depths. Give blowout preventer program, if any.

24. SIGNED *DeAnne J. Llanoy* TITLE Staff Assistant DATE 01-14-1994

PERMIT NO. _____ APPROVAL DATE _____
Application approval does not warrant or certify that the applicant holds legal or equitable title to those rights in the subject lease which would entitle the applicant to conduct operations thereon.
CONDITIONS OF APPROVAL, IF ANY:

**APPROVED
AS AMENDED**

APPROVED BY *ok* TITLE NMOCD
FEB 03 1994
DISTRICT MANAGER

* See Instructions On Reverse Side

The 18 U.S.C. Section 1001, makes it a crime for any person knowingly and willfully to make to any department or agency of the United States any false, fictitious or fraudulent statements or representations as to any matter within its jurisdiction.

Submit to Appropriate District Office
 State Lease - 4 copies
 Fee Lease - 3 copies

State of New Mexico
 Energy, Minerals and Natural Resources Department

Form C-102
 Revised 1-1-89

OIL CONSERVATION DIVISION

P.O. Box 2088
 Santa Fe, New Mexico 87504-2088

DISTRICT I
 P.O. Box 1980, Hobbs, NM 88240

DISTRICT II
 P.O. Drawer DD, Artesia, NM 88210

DISTRICT III
 1000 Rio Brazos Rd., Aztec, NM 87410

WELL LOCATION AND ACREAGE DEDICATION PLAT
 All Distances must be from the outer boundaries of the section

RECEIVED
 BLA...
 APR 11: 06
 CONFIDENTIAL
 070 FARMINGTON, NM

Operator AMOCO PRODUCTION COMPANY			Lease San Juan 28-7 Unit		Well No. 221M
Unit Letter J	Section 25	Township 28 NORTH	Range 7 WEST	County NMPM	RIO ARRIBA
Actual Footage Location of Well: 1850 feet from the SOUTH line and 1850 feet from the EAST line					
Ground level Elev. 6209	Producing Formation Blanco Mesaverde		Pool Blanco Mesaverde	Dedicated Acreage: E/2 320 Acres	

- Outline the acreage dedicated to the subject well by colored pencil or hachure marks on the plat below.
- If more than one lease is dedicated to the well, outline each and identify the ownership thereof (both as to working interest and royalty).
- If more than one lease of different ownership is dedicated to the well, have the interest of all owners been consolidated by communization, unitization, force-pooling, etc.?
 Yes No If answer is "yes" type of consolidation _____
 If answer is "no" list the owners and tract descriptions which have actually been consolidated. (Use reverse side of this form if necessary.)
 No allowable will be assigned to the well until all interests have been consolidated (by communization, unitization, forced-pooling, or otherwise) or until a non-standard unit, eliminating such interest, has been approved by the Division.

OPERATOR CERTIFICATION
 I hereby certify that the information contained herein is true and complete to the best of my knowledge and belief.
 Signature: Kelly Stearns
 Printed Name: Kelly Stearns
 Position: Asst. Business Analyst
 Company: Amoco Production Company
 Company #: 8-2-93
 Date: _____

SURVEYOR CERTIFICATION
 I hereby certify that the well location shown on this plat was plotted from field notes of actual surveys made by me or under my supervision, and that the same is true and correct to the best of my knowledge and belief.
 Date Surveyed: **July 26, 1993**
 Signature & Seal of Professional Surveyor: Gary D. Vann
 Gary D. Vann
 Registered Professional Land Surveyor
 7016

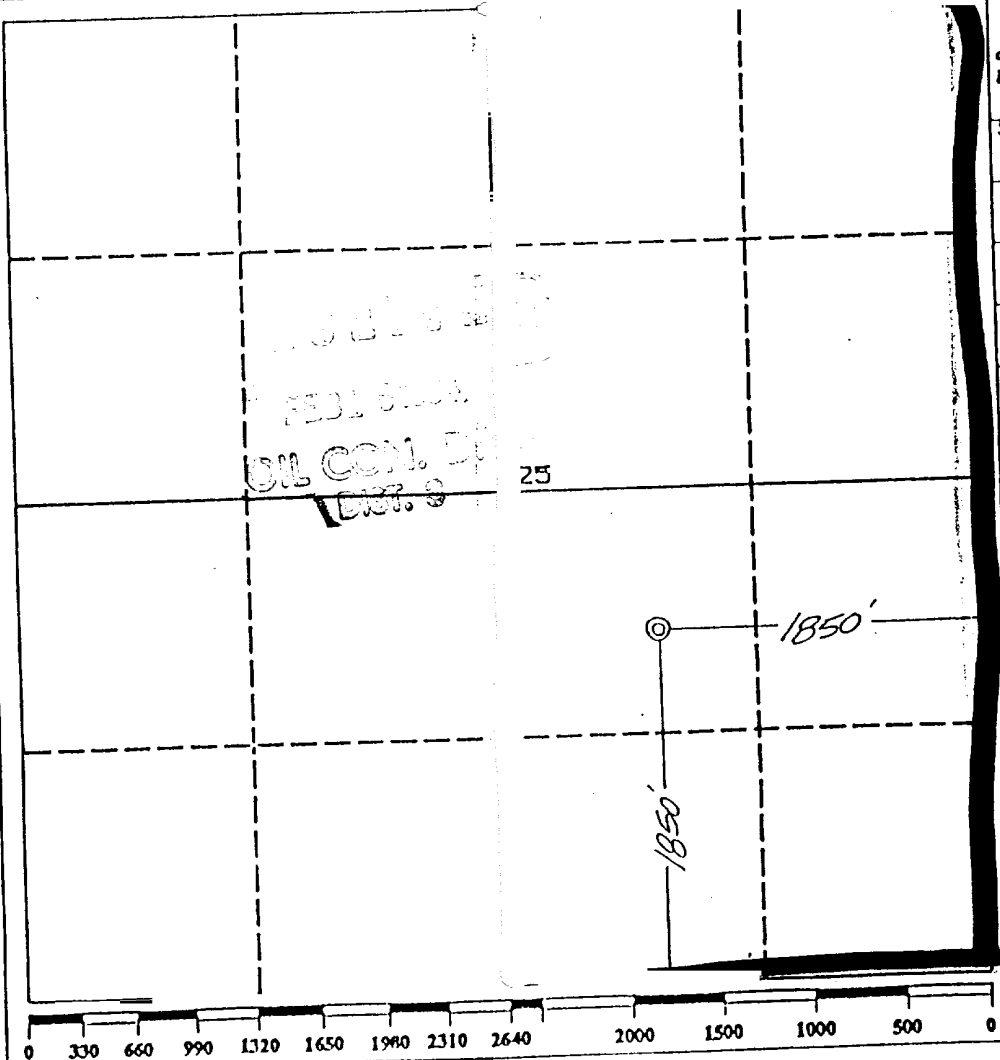

Submit to Appropriate District Office
 State Lease - 4 copies
 Fee Lease - 3 copies

State of New Mexico
 Energy, Minerals and Natural Resources Department

Form C-102
 Revised 1-1-89

OIL CONSERVATION DIVISION

P.O. Box 2088
 Santa Fe, New Mexico 87504-2088

DISTRICT I
 P.O. Box 1980, Hobbs, NM 88240

DISTRICT II
 P.O. Drawer DD, Artesia, NM 88210

DISTRICT III
 1000 Rio Brazos Rd., Aztec, NM 87410

WELL LOCATION AND ACREAGE DEDICATION PLAT
 All Distances must be from the outer boundaries of the section.

CONFIDENTIAL

Operator AMOCO PRODUCTION COMPANY			Lease San Juan 28-7 Unit		Well No. 221M
Unit Letter J	Section 25	Township 28 NORTH	Range 7 WEST	County NMPM	RIO ARRIBA
Actual Footage Location of Well: 1850 feet from the SOUTH line and 1850 feet from the EAST line					
Ground level Elev. 6209	Producing Formation Basin Dakota		Pool Basin Dakota		Dedicated Acreage: E/2 320 Acres

- Outline the acreage dedicated to the subject well by colored pencil or hatchure marks on the plat below.
- If more than one lease is dedicated to the well, outline each and identify the ownership thereof (both as to working interest and royalty).
- If more than one lease of different ownership is dedicated to the well, have the interest of all owners been consolidated by communitization, unitization, force-pooling, etc.?

Yes No If answer is "yes" type of consolidation _____

If answer is "no" list the owners and tract descriptions which have actually been consolidated. (Use reverse side of this form if necessary.)

No allowable will be assigned to the well until all interests have been consolidated (by communitization, unitization, forced-pooling, or otherwise) or until a non-standard unit, eliminating such interest, has been approved by the Division.



OPERATOR CERTIFICATION
 I hereby certify that the information contained herein is true and complete to the best of my knowledge and belief.

Signature: *Kelly Stearns*
 Printed Name: **Kelly Stearns**
 Position: **Asst. Business Analyst**
 Company: **Amoco Production Company**
 Date: **8-3-93**

SURVEYOR CERTIFICATION
 I hereby certify that the well location shown on this plat was plotted from field notes of actual surveys made by me or under my supervision, and that the same is true and correct to the best of my knowledge and belief.

Date Surveyed: **July 26, 1993**
 Signature & Seal of Professional Surveyor: *Gary D. Wann*
GARY D. VANN
NEW MEXICO
REGISTERED PROFESSIONAL LAND SURVEYOR
7016
 Gary Wann
 7016

CONFIDENTIAL

RECEIVED

FEB 1 6 1994

OIL CON. DIV
DIST. 3

BLM ROW APPLICATION
AMOCO PRODUCTION COMPANY
REF. # 508
SE1/4 SEC. 25, T28N, R7W, NMPM
RIO ARRIBA COUNTY, NM
NO ROW NEEDED
SEE AMOCO DELGADITA MESA QUAD

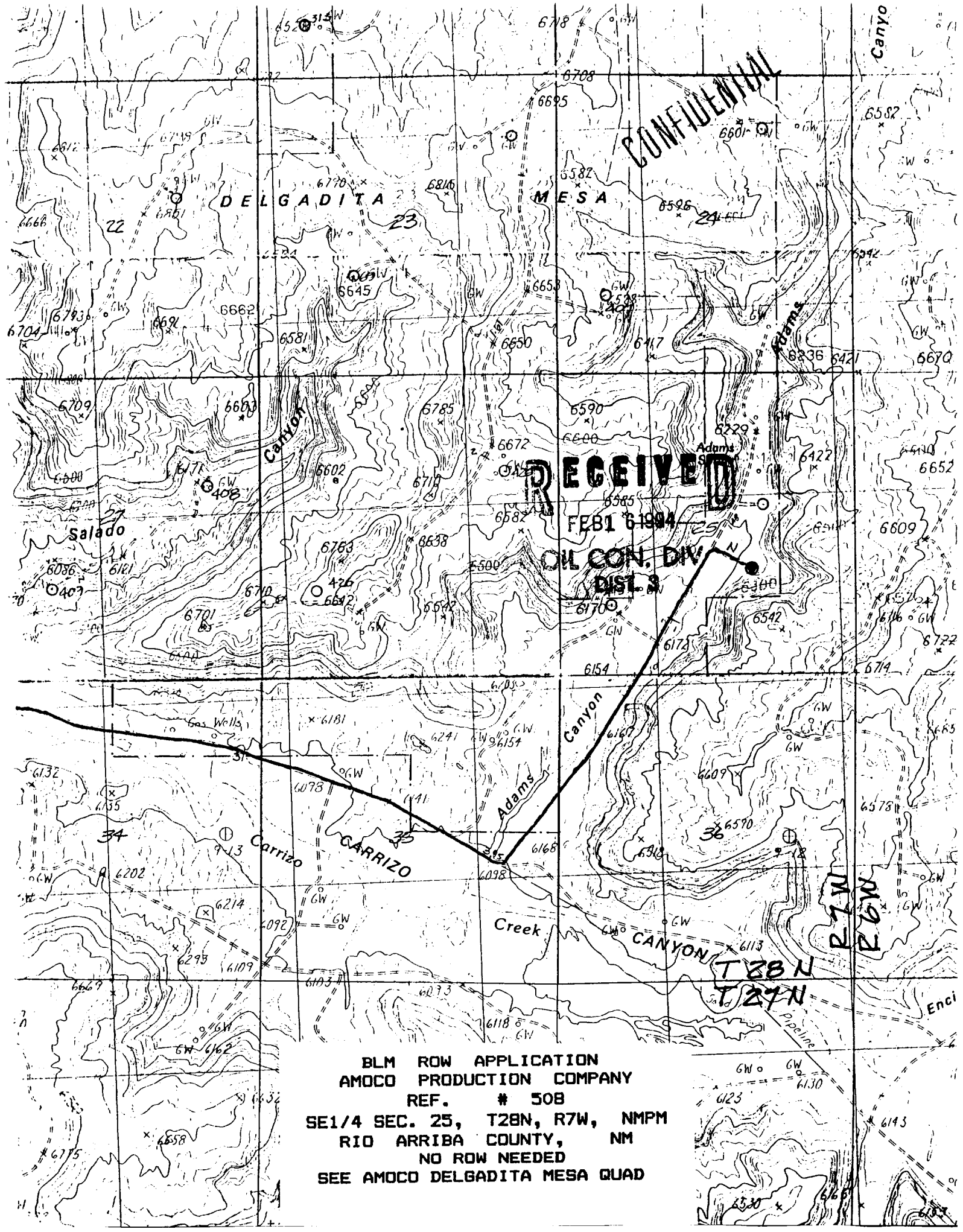

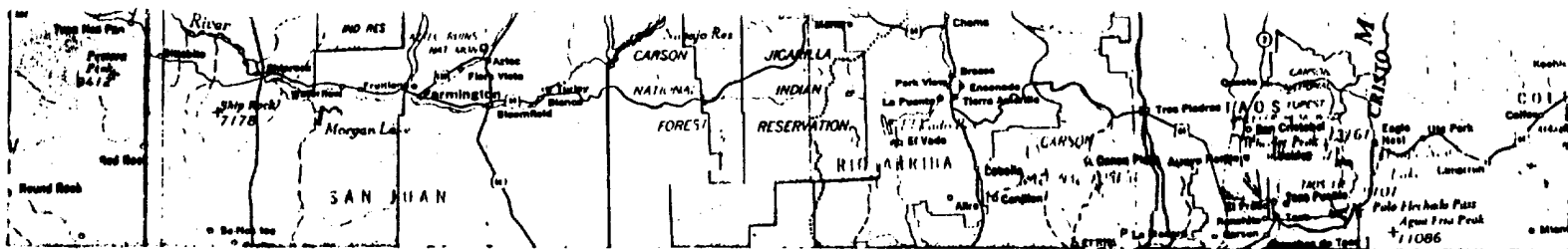

REF. # 508
 1850' F/SL 1850' F/EL
 SEC. 25, T28N, R7W, NMPM
 RAIL POINT: 183.23 miles from Montrose, CO
 MUD POINT: 40.23 miles from Aztec, NM
 CEMENT POINT: 44.23 miles from Farmington, NM

CONFIDENTIAL

