

UNITED STATES
DEPARTMENT OF THE INTERIOR
BUREAU OF LAND MANAGEMENT(Other instructions on
reverse side)FORM APPROVED
OMB NO. 1004-0136
Expires February 28, 1995

APPLICATION FOR PERMIT TO DRILL OR DEEPEN

1a. TYPE OF WORK

DRILL ☒DEEPEN ☐

b. TYPE OF WELL

OIL WELL ☐GAS WELL ☒OTHER ☐SINGLE ZONE ☒MULTIPLE ZONE ☐

2. NAME OF OPERATOR

Conoco Inc.

3. ADDRESS AND TELEPHONE NO

10 Desta Dr. Ste 430E, Midland, Tx. 79705-4500

4. LOCATION OF WELL (Report location clearly and in accordance with any State requirements)

At surface

1480' FSL & 790' FWL

At proposed prod. zone

1480' FSL & 790' FWL

14. DISTANCE IN MILES AND DIRECTION FROM NEAREST TOWN OR POST OFFICE*

5. DISTANCE FROM PROPOSED*

LOCATION TO NEAREST
PROPERTY OR LEASE LINE, FT
(Also to nearest drlg. unit line, if Any)

16. NO OF ACRES IN LEASE

8. DISTANCE FROM PROPOSED LOCATION*

TO NEAREST WELL, DRILLING, COMPLETED,
OR APPLIED FOR, ON THIS LEASE, FT.

19. PROPOSED DEPTH

7644'

20. ROTARY OR CABLE TOOLS

Rotary

21. ELEVATIONS (Show whether DF, RT, GR, etc.)

6219' GR and appeal pursuant to 43 CFR 3165.4.

22. APPROX. DATE WORK WILL START*

6/1/99

23

PROPOSED CASING AND CEMENTING PROGRAM

SIZE OF HOLE	GRADE, SIZE OF CASING	WEIGHT PER FOOT	SETTING DEPTH	QUANTITY OF CEMENT
12-1/4"	H-40, 9-5/8"	32.3#	250'	150 sxs, circ.
8-3/4"	J-55, 7"	20#	3128'	422 sxs, circ.
6-1/4"	J/K-55, 4-1/2"	9.5#	7344'	582 sxs, toc @ 2900'

It is proposed to drill a vertical wellbore to be downhole commingled in the Blanco Mesaverde and Basin Dakota Pools (DHC #2246-see referenced description) An NOS was filed 10/2/98. The well will be drilled and equipped according to the following additional attachments:

1. Well Location & Acreage Dedication Plat (C-102).
2. Proposed Well Plan Outline.
3. Cementing Plan.
4. Blowout Preventer Hookup.
5. Surface Use Plan including temporary pipeline tie specifications and Production Facility layout.

APD/ROW

This application includes ROW's for the well pad, access road, cathodic protection and pipeline.

DRILLING OPERATIONS AUTHORIZED ARE
SUBJECT TO COMPLIANCE WITH ATTACHED
"GENERAL REQUIREMENTS"

IN ABOVE SPACE DESCRIBE PROPOSED PROGRAM: If proposal is to deepen give data on present productive zone and proposed new productive zone. If proposal is to drill or deepen directionally, give pertinent data on subsurface locations and measured and true vertical depths. Give blowout preventer program, if any.

24.

SIGNED

Jo Ann Johnson

TITLE

Jo Ann Johnson

Sr. Property Analyst

DATE

May 5, 1999

(This space for Federal or State office use)

PERMIT NO

APPROVAL DATE

8/3/99

Application approval does not warrant or certify that the applicant holds legal or equitable title to those rights in the subject lease which would entitle the applicant to conduct operations thereon.

CONDITIONS OF APPROVAL, IF ANY:

APPROVED BY

AS/Duane W. Spencer

TITLE

Team Lead, Petroleum Management

DATE

AUG - 3 1999

*See Instructions On Reverse Side

Title 18 U.S.C. Section 1001, makes it a crime for any person knowingly and willfully to make to any department or agency of the United States any false, fictitious or fraudulent statements or representations as to any matter within its jurisdiction.

HOLD C104 FOR DAKOTA 1152(S)

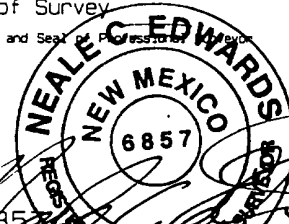
<div style="display: flex; justify-content: space-between;"> <div style="width: 45%;"> <p>2596</p> <p>31A</p> </div> <div style="width: 5%; text-align: center;"> <p>5280.00'</p> </div> </div> <div style="text-align: center; margin-top: 20px;"> <p>RECEIVED</p> <p>AUG 05 1999</p> <p>OIL CON. DIV.</p> <p>DIST. 3</p> </div> <div style="display: flex; justify-content: space-between; margin-top: 20px;"> <div style="width: 45%;"> <p>5280.00'</p> </div> <div style="width: 5%; text-align: center;"> <p>20</p> </div> <div style="width: 5%; text-align: center;"> <p>5280.00'</p> </div> </div> <div style="display: flex; justify-content: space-between; margin-top: 20px;"> <div style="width: 45%;"> <p>790'</p> <p>1480'</p> </div> <div style="width: 5%; text-align: center;"> <p>219</p> <p>31</p> </div> <div style="width: 5%; text-align: center;"> <p>5286.60'</p> </div> </div>	<p>17 OPERATOR CERTIFICATION</p> <p>I hereby certify that the information contained herein is true and complete to the best of my knowledge and belief</p> <div style="margin-top: 20px;"> <p><i>Mike L. Mankin</i></p> <p>Signature</p> <p>Mike L. Mankin</p> <p>Printed Name</p> <p>Right-Of-Way Agent</p> <p>Title</p> <p>12-15-98</p> <p>Date</p> </div> <hr/> <p>18 SURVEYOR CERTIFICATION</p> <p>I hereby certify that the well location shown on this plat was plotted from field notes of actual surveys made by me or under my supervision and that the same is true and correct to the best of my belief.</p> <div style="margin-top: 20px;"> <p>NOVEMBER 30, 1998</p> <p>Date of Survey</p> <p><i>Neale C. Edwards</i></p> <p>Signature and Seal of Professional Surveyor</p> </div> <div style="text-align: center; margin-top: 10px;">  </div> <p>6857</p> <p>Certificate No. 6857</p>
---	--

District I
PO Box 1980, Hobbs, NM 88241-1980

District II
PO Drawer 00, Artesia, NM 88211-0719

District III
1000 Rio Brazos Rd., Aztec, NM 87410

District IV
PO Box 2088, Santa Fe, NM 87504-2088

State of New Mexico
Energy, Minerals & Natural Resources Department

OIL CONSERVATION DIVISION
PO Box 2088
Santa Fe, NM 87504-2088

Form C-102
Revised February 21, 1994
Instructions on back
Submit to Appropriate District Office
State Lease - 4 Copies
Fee Lease - 3 Copies

☒ AMENDED REPORT

WELL LOCATION AND ACREAGE DEDICATION PLAT

API Number 30-039-26172		Pool Code 72319 / 71599		Pool Name BLANCO MESAVERDE / BASIN DAKOTA	
Property Code 016608		Property Name SAN JUAN 28-7 UNIT			Well Number 219M
CGRID No. 005073		Operator Name CONOCO, INC.			Elevation 6219'

UL or Lot No.	Section	Township	Range	Lot 1/4	Feet from the	North/South Line	Feet from the	East/West Line	County
L	20	28N	7W		1480	SOUTH	790	WEST	RIO ARRIBA

UL or Lot No.	Section	Township	Range	Lot 1/4	Feet from the	North/South Line	Feet from the	East/West Line	County
Dedicated Acres					Joint or Infill	Consolidation Code	Order No.		

NO ALLOWABLE WILL BE ASSIGNED TO THIS COMPLETION UNTIL ALL INTERESTS HAVE BEEN CONSOLIDATED OR A NON-STANDARD UNIT HAS BEEN APPROVED BY THE DIVISION

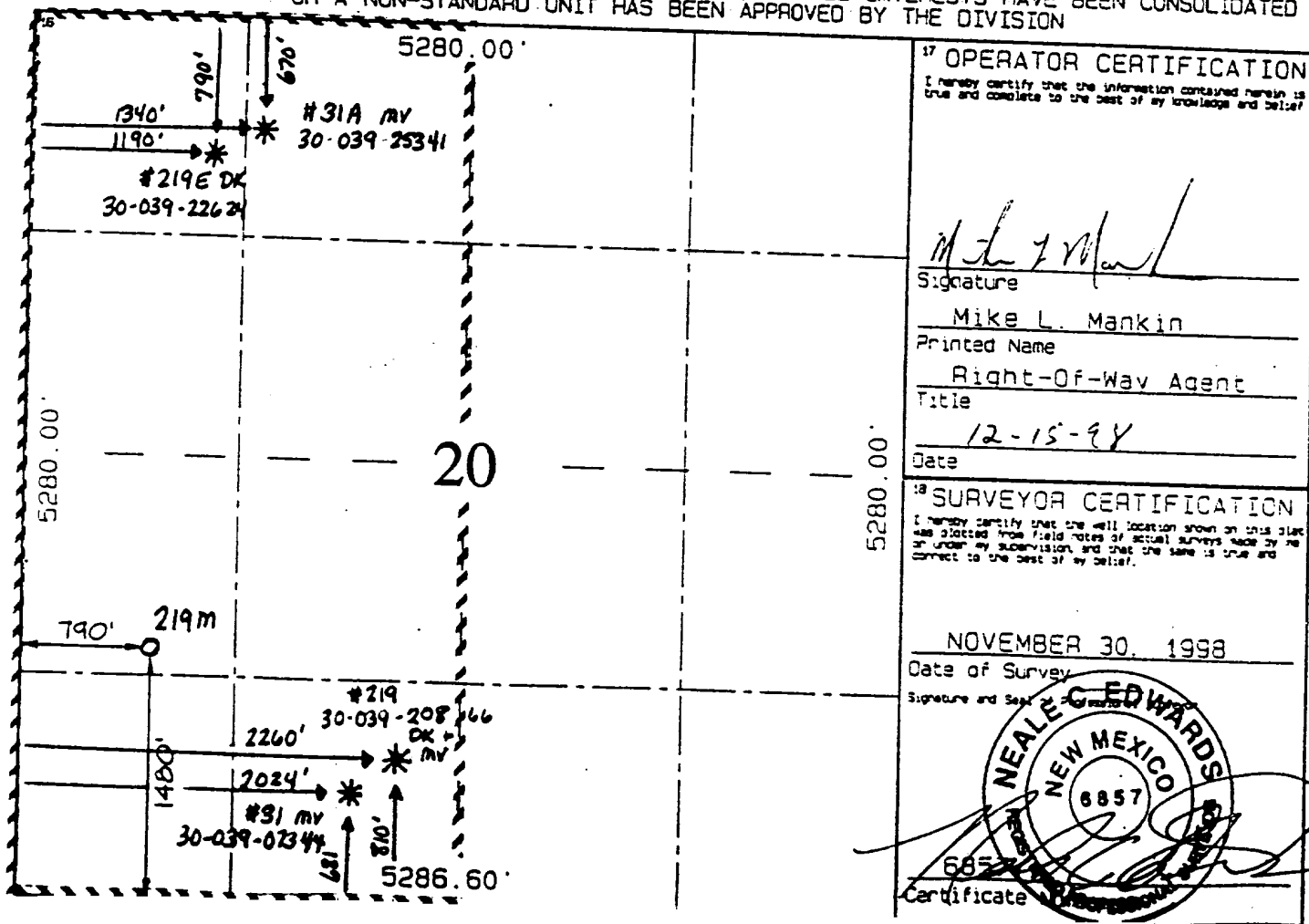

EST. GL = 6226

EST. KB = 6241

WELL NAM **SJ 28-7 UNIT No. 219M**LOCATION: **SEC 20, T-28N, R-7W, RIO ARRIBA CO., NM**

TVD IN 1000	MD	FORMATION TOPS & TYPE	DRILLING PROBLEMS	TYPE OF FORMATION EVALUATION	HOLE SIZE	CASING SIZE DEPTH	FRAC GRAD. psi/ft	FORMATION PRESSURE PSI	MUD WT TYPE	DAYS
0					12-1/4"	9-5/8" 32.3# H-40 STC @ 250'		NORMAL	AIR/AIR MIST/AERATED FLUID	1
					8-3/4"				AIR/AIR MIST/AERATED FLUID	
1										
2		OJAM @ 1899' KRLD @ 2044' FRLD @ 2385'	POSSIBLE WATERFLOW POSSIBLE GAS FLOW POSSIBLE LOST RETURNS POSSIBLE DIFFERENTIAL STICKING					432 PSI 360 PSI		
3		PCCF @ 2828' LEWS @ 2983'			8-3/4"	CIRCULATE CEMENT TO SURFACE 7" 20# J-55 STC @ 3128				3
4		CHRA @ 3756'			8-1/4"			400 PSI		
		CLFH/MV @ 4451' MENF @ 4586'	PROBABLE LOST RETURNS IF FLUID IN HOLE				0.5	457 PSI		
5		PTLK @ 5033' MNCS @ 5472'	PROBABLE LOST RETURNS PROBABLE LOST RETURNS							
6		GLLP @ 6251'	PROBABLE LOST RETURNS							
7		GRHN @ 6993' GRRS DKOT @ 7051' PAGU @ 7224' T.D. @ 7344'	POSSIBLE WATERFLOW POSSIBLE OVERPRESSURE IN DEEP DAKOTA	CASED HOLE LOGS	8-1/4"	4-1/2" 9.5# J/K-55 STC @ 7344' CEMENT TO 2900'	0.5	713 PSI BHT = 175 deg F	AIR/AIR MIST/AERATED FLUID	8
8										
		NOTE: PERMIT TO 7844'								

DATE 01/27/99 APPROVAL *[Signature]* PAS 1/28/99
 PREPARED: *[Signature]* RES. ENGINEER
 Ricky Joye Ted Kelly *[Signature]* 1/29/99
 DRILLING ENGINEER PROD. ENGINEER

[Signature] 1/28/99
 GEOLOGIST
[Signature]
 DRILLING MGR.

4:01 PM

Directions from Blanco, NM Post Office to Conoco San Juan 28-7 Unit #219M

1480' FSL & 790' FWL, Section 20, T28N, R7W, N.M.P.M., Rio Arriba County, NM.

Travel Easterly on US Hwy 64 for 1.3 miles across the San Juan River to County Road 4450;

Go right (Southerly) on County Road 4450 for 3.6 miles to major road intersection;

Go left (Southeasterly) for 5.7 miles to fork in road;

Go left which is straight (Easterly) along Carrizo Wash for 4.5 miles to fork in road;

Go left which is straight (North-easterly) along Carrizo Wash for 1.5 miles to the head of Delgadita Canyon;

Go left (North-easterly) up Delgadita Canyon for 0.2 miles to fork in road;

Go left (North-westerly) for 0.1 miles to fork in road;

Go left (North-westerly) for 0.2 miles to fork in road;

Go right which is straight (North-westerly) for 0.2 miles to new access on left-hand side of road which continues for 3210' to staked location.