

(SUBMIT IN TRIPLICATE)

UNITED STATES
DEPARTMENT OF THE INTERIOR
GEOLOGICAL SURVEY

Land Office Santa Fe
Lease No. 080236
Unit _____

SUNDRY NOTICES AND REPORTS ON WELLS

NOTICE OF INTENTION TO DRILL.....	<input checked="" type="checkbox"/>	SUBSEQUENT REPORT OF WATER SHUT-OFF.....
NOTICE OF INTENTION TO CHANGE PLANS.....		SUBSEQUENT REPORT OF SHOOTING OR ACIDIZING.....
NOTICE OF INTENTION TO TEST WATER SHUT-OFF.....		SUBSEQUENT REPORT OF ALTERING CASING.....
NOTICE OF INTENTION TO RE-DRILL OR REPAIR WELL.....		SUBSEQUENT REPORT OF RE-DRILLING OR REPAIR.....
NOTICE OF INTENTION TO SHOOT OR ACIDIZE.....		SUBSEQUENT REPORT OF ABANDONMENT.....
NOTICE OF INTENTION TO PULL OR ALTER CASING.....		SUPPLEMENTARY WELL HISTORY.....
NOTICE OF INTENTION TO ABANDON WELL.....		

(INDICATE ABOVE BY CHECK MARK NATURE OF REPORT, NOTICE, OR OTHER DATA)

November 6, 1957

Well No. 2 is located 2110 ft. from N line and 990 ft. from E line of sec. 31
SW SE NE of Section 31 27 North 12 West NMPM
(1/4 Sec. and Sec. No.) (Twp.) (Range) (Meridian)
Unmanned San Juan New Mexico
(Field) (County or Subdivision) (State or Territory)

The elevation of the derrick floor above sea level is ft. (Will furnish later.)

DETAILS OF WORK

(State names of and expected depths to objective sands; show sizes, weights, and lengths of proposed casings; indicate mudding jobs, cementing points, and all other important proposed work)

Gallegos-Federal No. 2

It is proposed to drill a development well to test the Gallup formation to an approximate total depth of 5100'. Approximately 300' of 8-5/8" O.D. surface casing will be set and cemented to surface. If commercial production is encountered, 5-1/2" O.D. production casing will be set and cemented. All possible producing horizons will be adequately cored and/or tested.

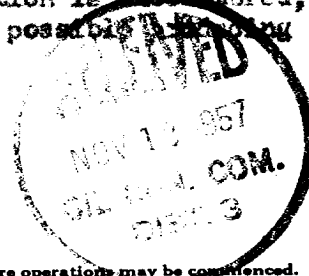

I understand that this plan of work must receive approval in writing by the Geological Survey before operations may be commenced.

Company Gulf Oil Corporation
Address Production Department
P. O. Box 2027
Denver, Colorado
By _____ Title Area Production Superintendent

cc: New Mexico Oil Conservation Commission (2)

NEW MEXICO OIL CONSERVATION COMMISSION

Well Location and Acreage Dedication Plat

Section A.

Date 11-6-57

Operator Gulf Oil Corporation Lease Gallegos Federal
Well No. 2 Unit Letter # Section 31 Township 27 North Range 12 West NMPM
Located 2310 Feet From North Line, 990 Feet From East Line
County San Juan G. L. Elevation 5863 Dedicated Acreage 40 Acres
Name of Producing Formation Gallup Pool Unnamed

1. Is the Operator the only owner* in the dedicated acreage outlined on the plat below?
Yes ✓ No
2. If the answer to question one is "no," have the interests of all the owners been consolidated by communitization agreement or otherwise? Yes No . If answer is "yes,"
Type of Consolidation
3. If the answer to question two is "no," list all the owners and their respective interests below:

Owner

Land Description

RECEIVED

NOV 8 1957

U. S. GEOLOGICAL SURVEY
WASHINGTON, NEW MEXICO



Section B

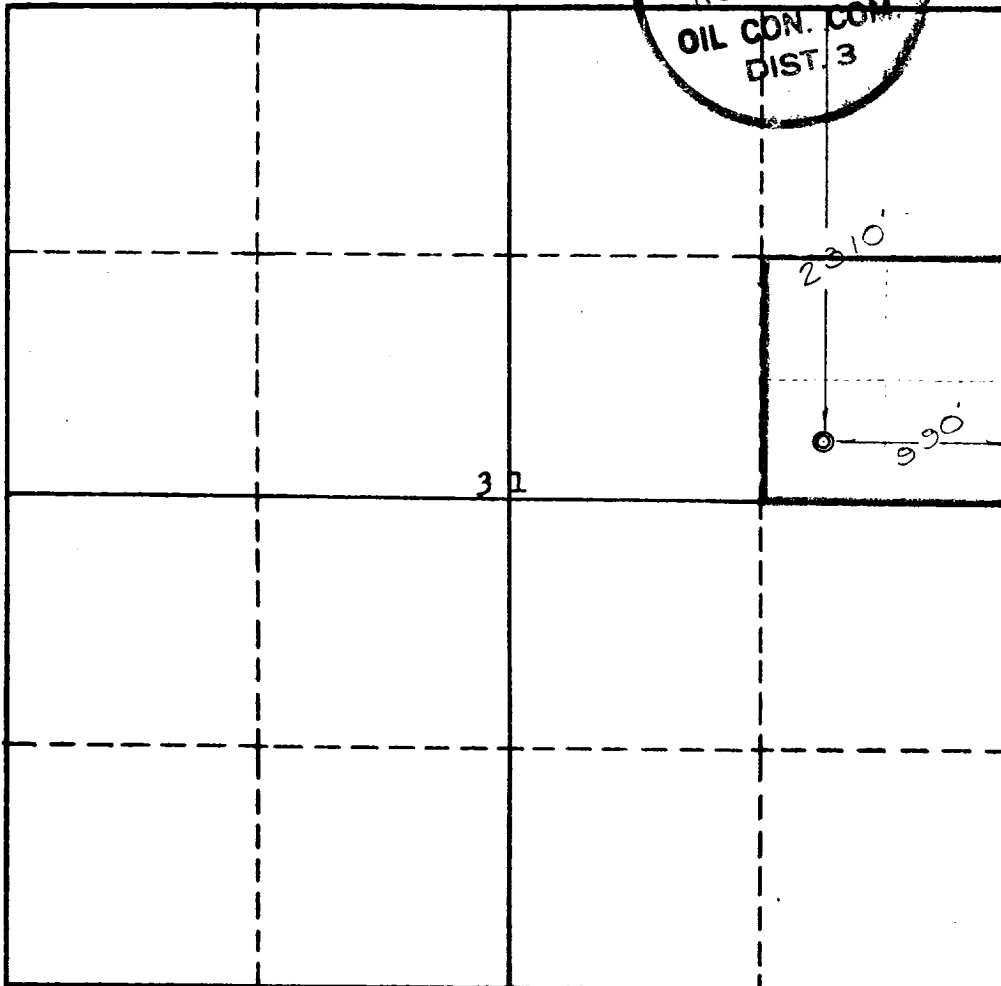

This is to certify that the information in Section A above is true and complete to the best of my knowledge and belief.

Gulf Oil Corporation

(Operator)

ORIGINAL SIGNED BY
W. D. MITCHELL

(Representative)

Production Department
P. O. Box 2097

Denver, Colorado

This is to certify that the well location shown on the plat in Section B was plotted from field notes of actual surveys made by me or under my supervision and that the same is true and correct to the best of my knowledge and belief.

Date Surveyed Nov. 3, 1957

Ernest V. Echshawk
Ernest V. Echshawk
Registered Land Surveyor.

Certificate No. 1545



