

New Mexico

(SUBMIT IN TRIPLICATE)

UNITED STATES
DEPARTMENT OF THE INTERIOR
GEOLOGICAL SURVEY

Land Office

Lease No. 03196

Unit Frost

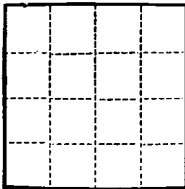

SUNDRY NOTICES AND REPORTS ON WELLS

NOTICE OF INTENTION TO DRILL	X	SUBSEQUENT REPORT OF WATER SHUT-OFF
NOTICE OF INTENTION TO CHANGE PLANS		SUBSEQUENT REPORT OF SHOOTING OR ACIDIZING
NOTICE OF INTENTION TO TEST WATER SHUT-OFF		SUBSEQUENT REPORT OF ALTERING CASING
NOTICE OF INTENTION TO RE-DRILL OR REPAIR WELL		SUBSEQUENT REPORT OF RE-DRILLING OR REPAIR
NOTICE OF INTENTION TO SHOOT OR ACIDIZE		SUBSEQUENT REPORT OF ABANDONMENT
NOTICE OF INTENTION TO PULL OR ALTER CASING		SUPPLEMENTARY WELL HISTORY
NOTICE OF INTENTION TO ABANDON WELL		

(INDICATE ABOVE BY CHECK MARK NATURE OF REPORT, NOTICE, OR OTHER DATA)

April 13, 1961

Well No. 9 is located 1090 ft. from {NNW} line and 990 ft. from {E} line of sec. 25

SE Section 25
(1/4 Sec. and Sec. No.)

27-7 10 W
(Twp.) (Range)

N.M.P.M.
(Meridian)

Basin Dakota
(Field)

San Juan
(County or Subdivision)

New Mexico
(State or Territory)

The elevation of the derrick floor above sea level is 6514 ft.

DETAILS OF WORK

(State names of and expected depths to objective sands; show sizes, weights, and lengths of proposed casings; indicate mudding jobs, cementing points, and all other important proposed work)

It is intended to drill a well thru the Dakota formation using rotary tools and to perforate & water fracture possible producing zones. Est. T.D. 7010'.

Casing Program:

9 5/8" @ 280' with 320 sacks cement circulated to surface.

4 1/2" @ 7010' with two stage tool set at 4990'.

1st stage 300 sks. - 150% to cover 100' above Gallup top.

2nd stage 720 sks. - 150% to cover Fruitland top.

The E/2 of Section 25 is dedicated to this well.

I understand that this plan of work must receive approval in writing by the Geological Survey before operations may be commenced.

Company El Paso Natural Gas Company

Address Box 990

Farmington, New Mexico

Original signed R. G. MILLER
By

Title Petroleum Engineer

NEW MEXICO OIL CONSERVATION COMMISSION

Well Location and Acreage Dedication Plat

Section A.

Date **March 30, 1961**

Operator **EL PASO NATURAL GAS COMPANY** Lease **FROST** NM **03198**
 Well No. **9** Unit Letter **P** Section **25** Township **27-N** Range **10-W** N.M.M.
 Location **1090** Foot From **SOUTH** Line **990** Block **EAST** Land
 County **SAN JUAN** G. L. Elevation **6504** Borehole No. **302.16** Area
 Name of Producing Formation **DAKOTA** Pool **BASIN DAKOTA**

1. Is the Operator the only owner in the dedicated acreage outlined on the plat hereon?
 Yes ☐ No ☒
2. If the answer to question one is "no", have the interests of all the owners been consolidated by a unitization agreement or otherwise? Yes ☒ No ☐ If answer is "yes", Type of Consolidation:

Operating Agreement

3. If the answer to question two is "no", list all the owners and their respective interests in the dedicated acreage:
 Owner _____ Unit Description _____



Section B.

I, as the Operator, certify that the information in Section A above is true and complete to the best of my knowledge and belief.

El Paso Natural Gas Company

Operator
 Original Signed **R. G. MILLER**
 Representative

Box 990

Address
Farmington, New Mexico

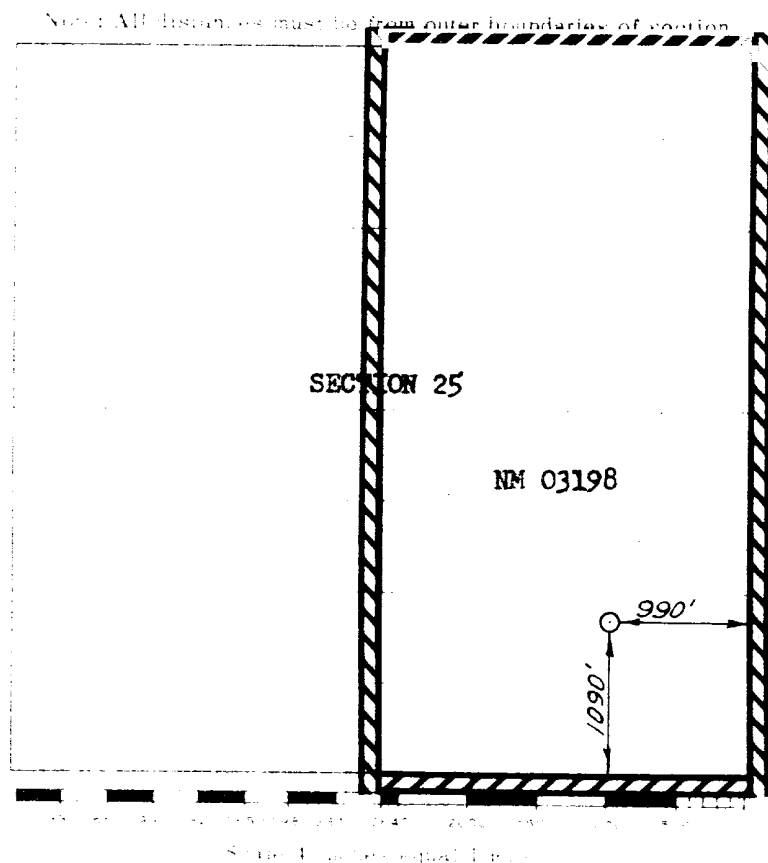

This is to certify that the above plat was prepared from the boundaries of a land survey made by me or under my supervision and that the same are true and correct to the best of my knowledge and belief.

(Seal)

Date surveyed

March 29, 1961

David O. Kilner
 Registered Professional Landman and/or Land Surveyor

Farmington, New Mexico