

NEW MEXICO OIL CONSERVATION COMMISSION

Well Location and Acreage Dedication Plat

Section A.

Date **February 5, 1959**

Operator **PAN AMERICAN PETROLEUM CORPORATION** Lease **JACK FROST "B"**
 Well No. **1** Unit Letter **P** Section **27** Township **27 NORTH** Range **10 WEST** NMPM
 Located **1089** Feet From **THE SOUTH** Line, **986** Feet From **THE EAST** Line
 County **SAN JUAN** G. L. Elevation ***** Dedicated Acreage **160** Acres
 Name of Producing Formation **Dakota** Pool **Angel Peak Dakota**

1. Is the Operator the only owner in the dedicated acreage outlined on the plat below?
 Yes ☐ No ☒ ***To be reported later**
2. If the answer to question one is "no", have the interests of all the owners been consolidated by communitization agreement or otherwise? Yes ☒ No ☐ . If answer is "yes", Type of Consolidation.
Communitized Acreage
3. If the answer to question two is "no", list all the owners and their respective interests below:

Owner

Land Description

RECEIVED

FEB 6 1959

**GEOLOGICAL SURVEY
NEW MEXICO**

Section B.

Note: All distances must be from outer boundaries of section.

This is to certify that the information in Section A above is true and complete to the best of my knowledge and belief.

PAN AMERICAN PETROLEUM CORPORATION

(Operator)

R. M. Bauer, Jr. *RMBauer, Jr.*

(Representative)

Box 487, Farmington, New Mexico

(Address)

REF. GLO Plat dated: 19 July 1915

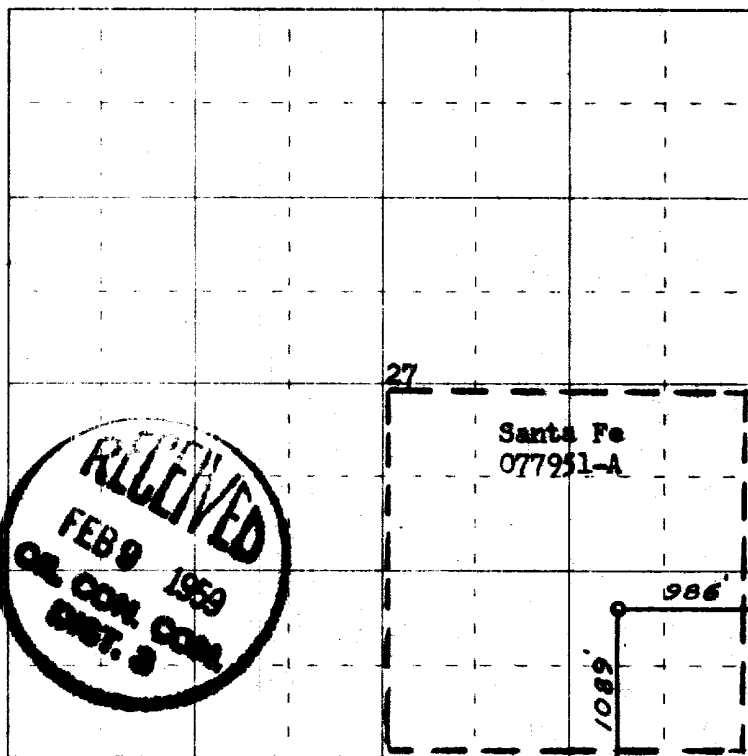

0 330 660 990 1320 1650 1980 2310 2640 2000 1500 1000 500 0

Scale 4 inches equal 1 mile

This is to certify that the above plat was prepared from field notes of actual surveys made by me or under my supervision and that the same are true and correct to the best of my knowledge and belief.

(Seal)

Farmington, New Mexico

Date Surveyed **28 December 1958**

James P. Leese
 Registered Professional Engineer and/or Land Surveyor
JAMES P. LEESE N. MEX. REG. NO. 1463

