

N. M. O. C. C.

Form 9-331a
(Feb. 1951)

Budget Bureau 42-R388.2
Approval expires 12-31-52

(SUBMIT IN TRIPLICATE)
UNITED STATES
DEPARTMENT OF THE INTERIOR
GEOLOGICAL SURVEY

Land Office New Mexico
Lease No. 93693
Unit Harmond, 5

SUNDRY NOTICES AND REPORTS ON WELLS

NOTICE OF INTENTION TO DRILL	<input checked="" type="checkbox"/>	SUBSEQUENT REPORT OF WATER SHUT-OFF	
NOTICE OF INTENTION TO CHANGE PLANS		SUBSEQUENT REPORT OF SHOOTING OR ACIDIZING	
NOTICE OF INTENTION TO TEST WATER SHUT-OFF		SUBSEQUENT REPORT OF ALTERING CASING	
NOTICE OF INTENTION TO RE-DRILL OR REPAIR WELL		SUBSEQUENT REPORT OF REDRILLING OR REPAIR	
NOTICE OF INTENTION TO SHOOT OR ACIDIZE		SUBSEQUENT REPORT OF ABANDONMENT	
NOTICE OF INTENTION TO PULL OR ALTER CASING		SUPPLEMENTARY WELL HISTORY	
NOTICE OF INTENTION TO ABANDON WELL			

(INDICATE ABOVE BY CHECK MARK NATURE OF REPORT, NOTICE, OR OTHER DATA)

3-17, 1952

Well No. 5 is located 1550 ft. from [N] line and 1650 ft. from [E] line of sec. 25

SW 1/4 NE 1/4 SEC. 25

(1/4 Sec. and Sec. No.)

WINDCAT

(Field)

27

(Twp.)

3

(Range)

1

(Meridian)

San Juan

(County or Subdivision)

New Mexico

(State or Territory)

The elevation of the derrick floor above sea level is 5982.8 ft.

DETAILS OF WORK

(State names of and expected depths to objective sands; show sizes, weights, and lengths of proposed casings; indicate mudding jobs, cementing points, and all other important proposed work)

It is intended to drill a Pictured Cliff well on this location with rotary and complete with cable-tools.

103/4" surface 135' circulate cement
5 1/2" production string 2150' cement with 200 sacks

I understand that this plan of work must receive approval in writing by the Geological Survey before operations may be commenced.

Company Great Lakes Oil-Chem. Co.

Address 502 Mich. Nat. Bldg.

Grand Rapids 2 Mich.

By

Title

supt.

Company Great Lakes Oil & Chemical Co.

Lease HAMMOND Well No. 5

Sec. 25 T. 27 N., R. 3 W., N.M.P.M.

Location 1550' from the North line and 1650'
from the East line.

San Juan County

New Mexico

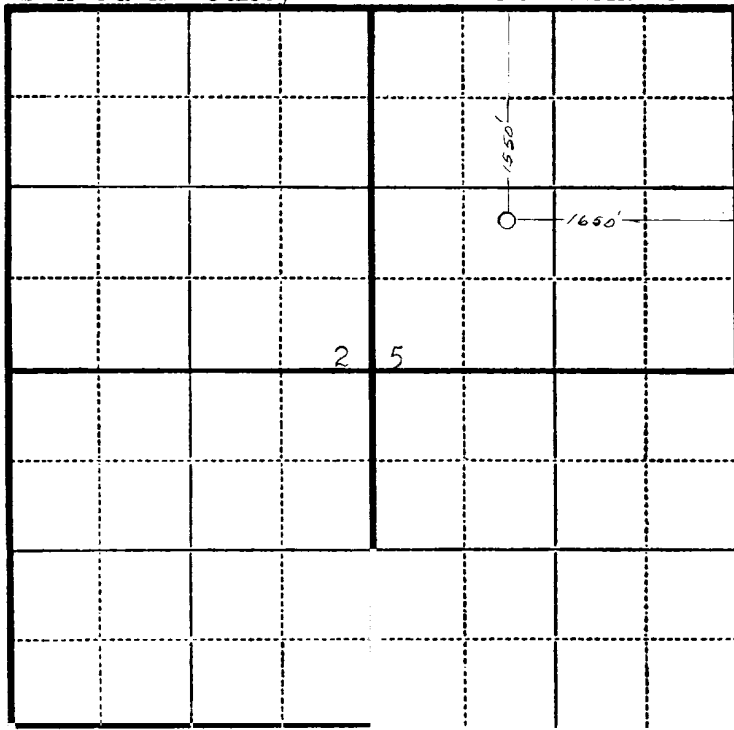

Scale—4 inches equals 1 mile.

This is to certify that the above plat was prepared from field notes of actual surveys made by me or under my supervision and that the same are true and correct to the best of my knowledge and belief.

Charles J. Pinkles

Seal:

Registered Professional
Engineer and Land Surveyor.

Charles J. Pinkles
N. Mex. Reg. No. 1302

Surveyed October 4, 1951

New Mexico Oil Conservation Commission

1000 RIO BRAZOS ROAD

AZTEC, NEW MEXICO

May 7, 1959

Mr. Elvis Utz
O. C. C.
Box 871
Santa Fe, New Mexico

Re: Supplement NW 4694
Egan # 5 Hammond
G-25-27-8
Letters 4-30-59 and 5-5-59

Dear Elvis:

I agree that re-classification to non-marginal should be effective 2-26-59.

However, the April and May schedules show production for February 414 MCF and March 4672 MCF or a total of 5086 MCF. Does subject supplement indicate all that production in February, or should the remark be as follows:

"Production charged as of March (5086)"?

Yours very truly,

A. R. Kendrick
Engineer, District # 3

ARK/wgh

cc: Mr. John Egan

