

	X		

(SUBMIT IN TRIPLICATE)

UNITED STATES  
DEPARTMENT OF THE INTERIOR  
GEOLOGICAL SURVEY

Land Office \_\_\_\_\_  
Lease No. **87-078092**  
Unit \_\_\_\_\_  
Dearthit Federal

SUNDRY NOTICES AND REPORTS ON WELLS

NOTICE OF INTENTION TO DRILL.....	X	SUBSEQUENT REPORT OF WATER SHUT-OFF.....
NOTICE OF INTENTION TO CHANGE PLANS.....		SUBSEQUENT REPORT OF SHOOTING OR ACIDIZING.....
NOTICE OF INTENTION TO TEST WATER SHUT-OFF.....		SUBSEQUENT REPORT OF ALTERING CASING.....
NOTICE OF INTENTION TO RE-DRILL OR REPAIR WELL.....		SUBSEQUENT REPORT OF RE-DRILLING OR REPAIR.....
NOTICE OF INTENTION TO SHOOT OR ACIDIZE.....		SUBSEQUENT REPORT OF ABANDONMENT.....
NOTICE OF INTENTION TO PULL OR ALTER CASING.....		SUPPLEMENTARY WELL HISTORY.....
NOTICE OF INTENTION TO ABANDON WELL.....		

(INDICATE ABOVE BY CHECK MARK NATURE OF REPORT, NOTICE, OR OTHER DATA)

September 1, 1961

Well No. 1 is located 790 ft. from N line and 1850 ft. from E line of sec. 27  
NE/4 SW/4 Sec. 27 27N 11W NM/PM  
 (1/4 Sec. and Sec. No.) (Twp.) (Range) (Meridian)  
Basin Dakota San Juan New Mexico  
 (Field) (County or Subdivision) (State or Territory)

The elevation of the derrick floor above sea level is 6370 ft. G.L.

DETAILS OF WORK

(State names of and expected depths to objective sands; show sizes, weights, and lengths of proposed casings; indicate mudding jobs; cementing points, and all other important proposed work)

Propose to drill with rotary tools to an approximate depth of 6750 feet or to test the Dakota formation. Casing program will be as follows:

10 3/4" 32.30# surface set @ approximately 200' w/160 ex cement.  
 4 1/2" 10.50# set @ total depth with 400 ex cement, or cement to cover the Gallup formation.

A DV tool will be placed for the protection of the Pictured Cliffs formation.

Will perforate 1 sand-water frac the Dakota formation.

I understand that this plan of work must receive approval in writing by the Geological Survey before operations may be commenced.

Company Southwest Production Company

Address 207 Petr. Club Plaza  
Farmington, New Mexico

Original signed by  
 By Carl W. Smith  
 Title Production Superintendent

## NEW MEXICO OIL CONSERVATION COMMISSION

## Well Location and Acreage Dedication Plat

Section A.

Date 9/1/61

Operator SOUTHWEST PRODUCTION COMPANY Lease Southit Federal  
 Well No. 1 Unit Letter C Section 27 Township 27 NORTH Range 11 WEST, NMPM  
 Located 790 Feet From the NORTH Line 1850 Feet From the WEST Line  
 County SAN JUAN G. L. Elevation 6370.0 Dedicated Acreage 1/320 Acres  
 Name of Producing Formation Dakota Pool Basin Dakota

1. Is the Operator the only owner in the dedicated acreage outlined on the plat below?  
 Yes ☒ No ☐
2. If the answer to question one is "no", have the interests of all the owners been consolidated by communitization agreement or otherwise? Yes ☐ No ☐ If answer is "yes", Type of Consolidation.

3. If the answer to question two is "no", list all the owners and their respective interests below:

Owner

Land Description

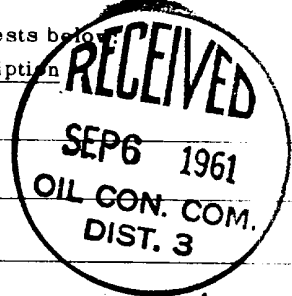

Section B.

Note: All distances must be from outer boundaries of section.

This is to certify that the information in Section A above is true and complete to the best of my knowledge and belief.

**Southwest Production Company**

Original signed (Operator)  
Carl W. Smith

(Representative)

**207 Petr. Club Plaza**

(Address)

**Farmington, New Mexico**

Ref: GLO plat dated 19 July 1915

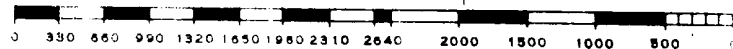
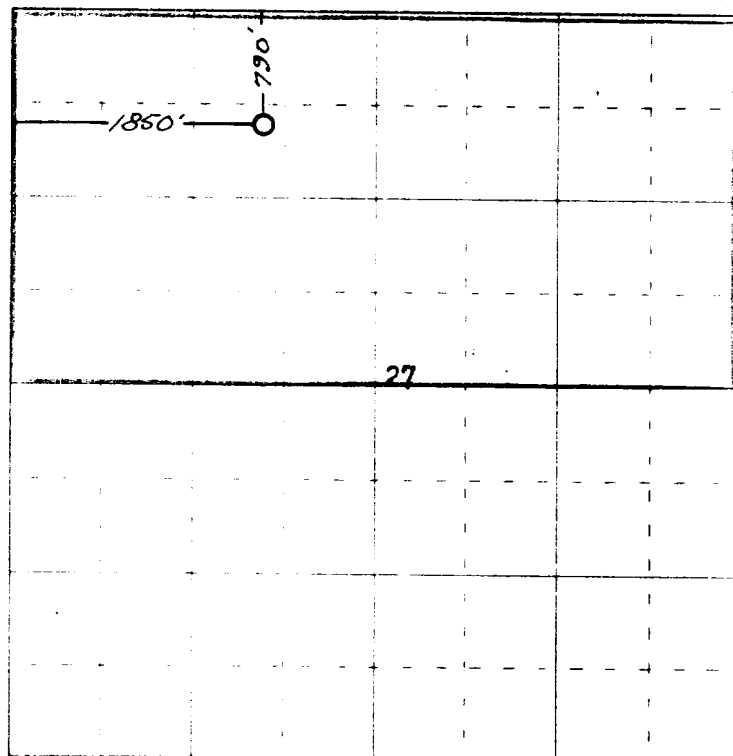

Scale 4 inches equal 1 mile

This is to certify that the above plat was prepared from field notes of actual surveys made by me or under my supervision and that the same are true and correct to the best of my knowledge and belief.

Date Surveyed 30 August 1961

James P. Leese  
 Registered Professional Engineer and/or Land Surveyor  
 James P. Leese N. Mex. Reg. No. 1463  
 San Juan Engineering Company

