

UNITED STATES
DEPARTMENT OF THE INTERIOR
BUREAU OF LAND MANAGEMENT

APPLICATION FOR PERMIT TO DRILL, DEEPEN, OR PLUG BACK

1a. TYPE OF WORK PLUG BACK	5. LEASE NUMBER SF-077952
1b. TYPE OF WELL GAS	6. IF INDIAN, ALL. OR TRIBE NAME
2. OPERATOR MERIDIAN OIL CO.	7. UNIT AGREEMENT NAME
3. ADDRESS & PHONE NO. OF OPERATOR P.O. BOX 4289 FARMINGTON, NM 87499 (505) 326-9700	8. FARM OR LEASE NAME GORDON
4. LOCATION OF WELL 990' FSL; 990' FEL	9. WELL NO. #3
14. DISTANCE IN MILES FROM NEAREST TOWN	10. FIELD, POOL, OR WILDCAT BASIN FRUITLAND COAL
	11. SEC. T. R. M OR BLK. SEC. 23, T27N, R10W
	12. COUNTY SAN JUAN
	13. STATE NM
15. DISTANCE FROM PROPOSED LOCATION TO NEAREST PROPERTY OR LEASE LINE.	16. ACRES IN LEASE
	17. ACRES ASSIGNED TO 320
18. DISTANCE FROM PROPOSED LOCATION TO NEAREST WELL DR. COMPL., OR APPLIED FOR ON THIS LEASE.	19. PROPOSED DEPTH
	20. ROTARY OR CABLE TO
21. ELEVATIONS (DF, FT, GR, ETC.) 6267' DF	22. APPROX. DATE WORK WILL START

23. PROPOSED CASING AND CEMENTING PROGRAM

*SEE OPERATIONS PLAN

RECEIVED

APR 18 1990

24. AUTHORIZED BY: *[Signature]* (SHL)
REGULATORY AFFAIRS

OIL CON. DIV
DIST. 3

4-2-90
DATE

PERMIT NO. _____ APPROVAL DATE _____

APPROVED BY _____ TITLE _____ DATE _____

NOTE: THIS FORMAT IS ISSUED IN LIEU OF US BLM FORM 3160-3.

*Requires NMCCD approval for the
Cenozoic location.*

Hold over for NSL

(E)

APPROVED

APR 13 1990

AREA MANAGER

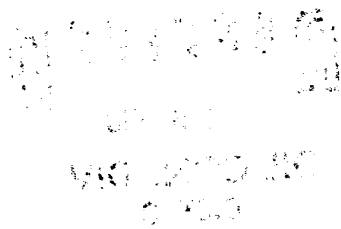

1911

1911

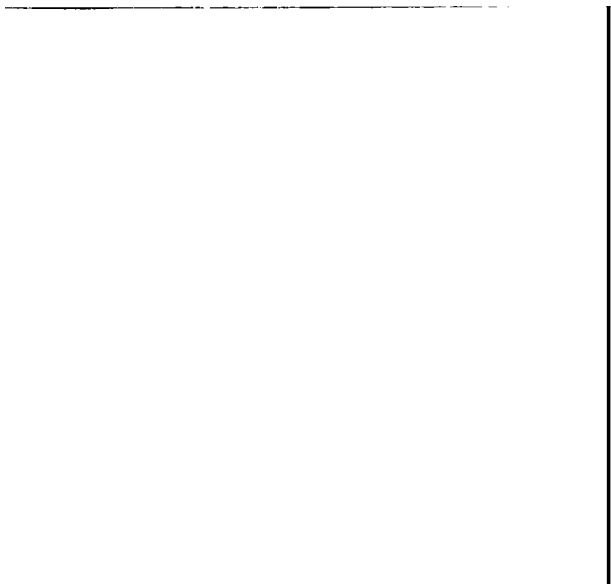

Submit to Appropriate
District Office
State Leases - 4 copies
Fee Leases - 3 copies

State of New Mexico
Energy, Minerals and Natural Resources Department

Form C-102
Revised 1-1-89

OIL CONSERVATION DIVISION
P.O. Box 2088
Santa Fe, New Mexico 87504-2088

DISTRICT I
P.O. Box 1980, Hobbs, NM 88240

DISTRICT II
P.O. Drawer DD, Artesia, NM 88210

DISTRICT III
1000 Rio Brazos Rd., Aztec, NM 87410

WELL LOCATION AND ACREAGE DEDICATION PLAT
All Distances must be from the outer boundaries of the section

Operator Meridian Oil Inc.			Lease Gordon (SF-077952)		Well No. 3
Unit Letter P	Section 23	Township 27	Range 10	County San Juan	
Actual Footage Location of Well: 990 feet from the South line and 990 feet from the East line					
Ground level Elev. 6267'DF	Producing Formation Fruitland Coal		Pool Basin	Dedicated Acreage: 320 Acres	

1. Outline the acreage dedicated to the subject well by colored pencil or hatchure marks on the plat below.
2. If more than one lease is dedicated to the well, outline each and identify the ownership thereof (both as to working interest and royalty).
3. If more than one lease of different ownership is dedicated to the well, have the interest of all owners been consolidated by communitization, unitization, force-pooling, etc.?
 Yes No If answer is "yes" type of consolidation _____
 If answer is "no" list the owners and tract descriptions which have actually been consolidated. (Use reverse side of this form if necessary).
 No allowable will be assigned to the well until all interests have been consolidated (by communitization, unitization, forced-pooling, or otherwise) or until a non-standard unit, eliminating such interest, has been approved by the Division.

Note: not resurveyed
taken from plat by
C. Beeson Neal

RECEIVED
APR 18 1990
OIL CON. DIV.
DIST. 3

23

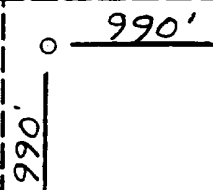

OPERATOR CERTIFICATION

I hereby certify that the information contained herein is true and complete to the best of my knowledge and belief.

Peggy Bradford
Signature

Peggy Bradford
Printed Name

Regulatory Affairs
Position

Meridian Oil Inc.
Company

4-3-90
Date

Date

SURVEYOR CERTIFICATION

I hereby certify that the well location shown on this plat was plotted from field notes of actual surveys made by me or under my supervision, and that the same is true and correct to the best of my knowledge and belief.

Date Surveyed

Neale C. Edwards
Signature of Surveyor



Neale C. Edwards
Certificate No.

FRUITLAND RECOMPLETION PROCEDURE
GORDON #3

1. Prepare location for workover. Install or replace anchors as necessary.
 2. MOL with workover rig, hold safety meeting, install safety signs and proper fire equipment at strategic points. Comply with all BLM, NMOCD, and MOI regulations.
 3. Rig up blow lines, record tubing and casing pressures and blow well down. Kill well as necessary with water. ND existing swage and tree and replace with a 2000 psi independent type wellhead. NU 6" 3000 psi BOP and stripping head.
 4. TOOH with tubing.
 5. PU 5 1/2" casing scraper on 2 3/8" 4.7# J-55 EUE tubing and TIH. TOOH.
 6. RU wireline unit. Run GR-CCL-CNL. Set a 5 1/2" CIBP near casing shoe to isolate the Pictured Cliffs formation. Pressure test casing to 3000 psi for 15 minutes.
 7. Perforations will be selected from log.
 8. Perforate Fruitland coal over interval selected from logs.
 9. TIH with tubing and swab wellbore dry.
 10. RU service company. Hold pre-frac safety meeting with all personnel on location. PT surface lines. Fracture stimulate well with 70 quality nitrogen foam, 40/70 mesh and 20/40 mesh sand, and 30# linear guar gel. Maximum pressure is limited to 3000 psi.
 12. Open well up after shut down. Record flowing pressures periodically until well logs off.
 13. TIH with tubing and CO to PBTB.
 14. Land 1 1/2" 2.9# EUE tubing near bottom perf. ND BOP. NU tree. Rig down and release rig.
-

GORDON #3

WELLBORE DIAGRAMS

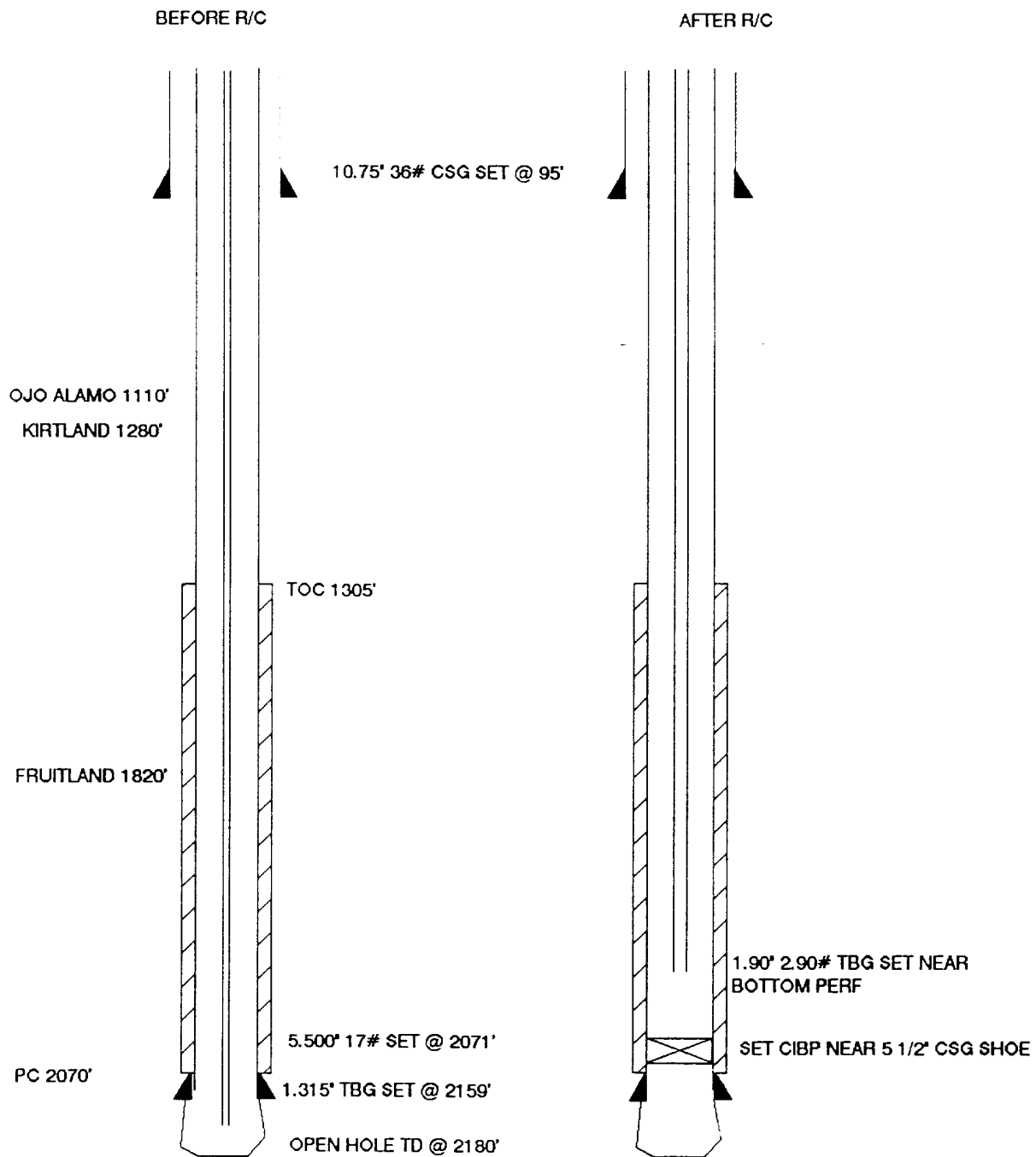

WORKOVER / RECOMPLETION B.O.P. SCHEMATIC

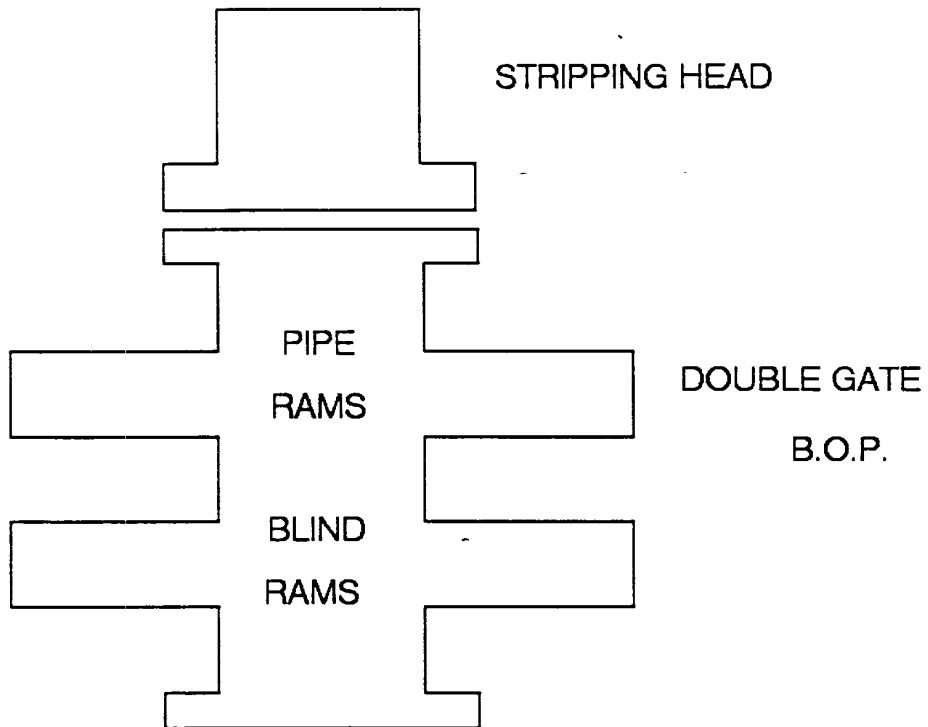

MINIMUM: 6" 2000 PSI DOUBLE GATE B.O.P.
MAXIMUM ANTICIPATED SHUT-IN WELLHEAD
PRESSURE IS LESS THAN 2000 PSI