

(SUBMIT IN TRIPLICATE)

Land Office **Santa Fe**

Lease No. **NM 020496**

UNITED STATES
DEPARTMENT OF THE INTERIOR
GEOLOGICAL SURVEY

Unit
RECEIVED

MAR 30 1962

SUNDRY NOTICES AND REPORTS ON WELLS

NOTICE OF INTENTION TO DRILL.....	<input checked="" type="checkbox"/>	SUBSEQUENT REPORT OF WATER SHUT-OFF.....
NOTICE OF INTENTION TO CHANGE PLANS.....		SUBSEQUENT REPORT OF SHOOTING OR ACIDIZING.....
NOTICE OF INTENTION TO TEST WATER SHUT-OFF.....		SUBSEQUENT REPORT OF ALTERING CASING.....
NOTICE OF INTENTION TO RE-DRILL OR REPAIR WELL.....		SUBSEQUENT REPORT OF RE-DRILLING OR REPAIR.....
NOTICE OF INTENTION TO SHOOT OR ACIDIZE.....		SUBSEQUENT REPORT OF ABANDONMENT.....
NOTICE OF INTENTION TO PULL OR ALTER CASING.....		SUPPLEMENTARY WELL HISTORY.....
NOTICE OF INTENTION TO ABANDON WELL.....		

(INDICATE ABOVE BY CHECK MARK NATURE OF REPORT, NOTICE, OR OTHER DATA)

March 30, 1962

Angel Peak

Well No. 2 is located 1750 ft. from ~~XXXX~~ S line and 990 ft. from ~~XXXX~~ W line of sec. 20

SW/4 Sec. 20
(1/4 Sec. and Sec. No.)

27N
(Twp.)

11W
(Range)

N.M.P.M.
(Meridian)

Basin Dakota
(Field)

San Juan
(County or Subdivision)

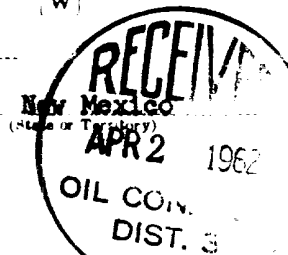

The elevation of the derrick floor above sea level is 6198 ft.

DETAILS OF WORK

(State names of and expected depths to objective sands; show sizes, weights, and lengths of proposed casings; indicate mudlogging, cementing points, and all other important proposed work)

It is intended to mud drill a well with rotary tools thru the Dakota formation and to perforate and water fracture possible producing zones. Estimated Total Depth 6577'.

Casing Program:

9 5/8" @ 280' with 200 sacks cement circulated to surface.
4 1/2" at 6577' using two stage cementing tool set 100' below base of Pictured Cliffs. First stage with 250 sacks cement to cover 100' above Gallup. Second stage with 120 sacks cement to cover 100' above Fruitland.

The W/2 of Section 20 is dedicated to this well.

I understand that this plan of work must receive approval in writing by the Geological Survey before operations may be commenced.

Company **El Paso Natural Gas Company**

Address **Box 990**

Farmington, New Mexico

By *D. W. Meehan*

Title **Petroleum Engineer**

ok

Well Location and Acreage Dedication Plat

Section A.

Date **March 21, 1962**

Operator **El Paso Natural Gas Company** Lease **Angel Peak NM 020496**
 Well No. **2** Unit Letter **L** Section **20** Township **27-N** Range **11-W** NMPM
 Located **1750** Feet From **South** Line **990** Feet From **West** Line
 County **San Juan** G. L. Elevation **6188** Dedicated Acreage **320** Acres
 Name of Producing Formation **Dakota** Pool **Basin Dakota**

1. Is the Operator the only owner in the dedicated acreage outlined on the plat below?

Yes ☒ No ☐2. If the answer to question one is "no", have the interests of all the owners been consolidated by communitization agreement or otherwise? Yes ☐ No ☐ If answer is "yes", Type of Consolidation.

3. If the answer to question two is "no", list all the owners and their respective interests.

Owner

Land Description



Section B.

This is to certify that the information in Section A above is true and complete to the best of my knowledge and belief.

El Paso Natural Gas Company

(Operator)
 Original Signed **D. W. Meehan**
 (Representative)

Box 990

(Address)

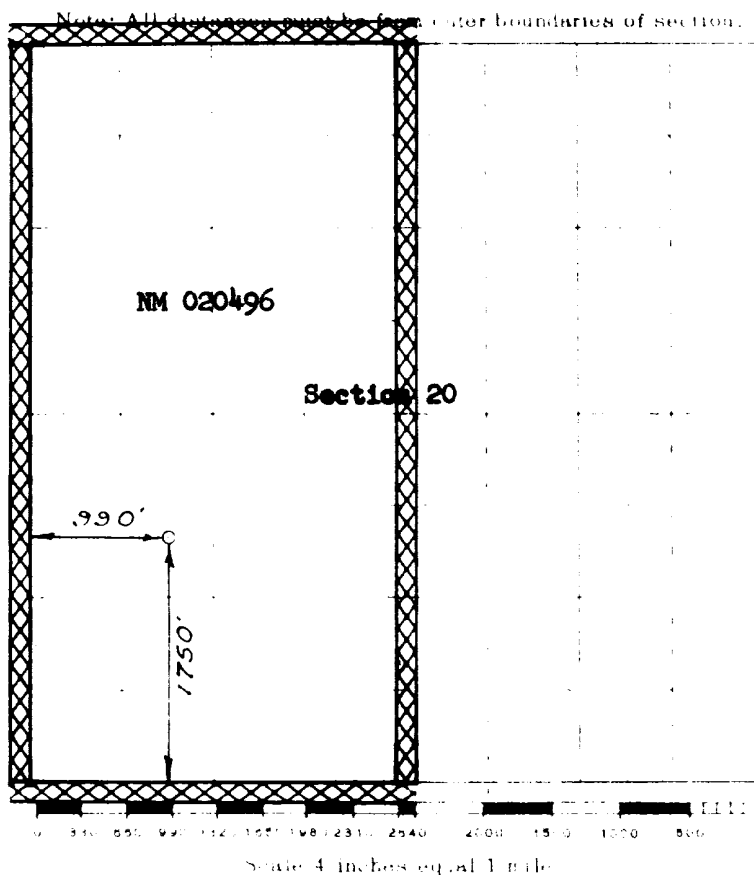
Farmington, New Mexico

This is to certify that the above plat was prepared from field notes of actual surveys made by me or under my supervision and that the same are true and correct to the best of my knowledge and belief.

(Seal)

Date Surveyed **October 17, 1960**

Farmington, New Mexico

David O. Kilnen
 Registered Professional Engineer and/or Land Surveyor

(SUBMIT IN TRIPLICATE)

Land Office **New Mexico**
Lease No. **020496**
Unit

UNITED STATES
DEPARTMENT OF THE INTERIOR
GEOLOGICAL SURVEY

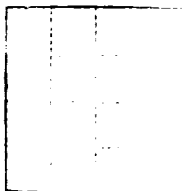

SUNDRY NOTICES AND REPORTS ON WELLS

NOTICE OF INTENTION TO DRILL	SUBSEQUENT REPORT OF WATER SHUT-OFF	X
NOTICE OF INTENTION TO CHANGE PLANS	SUBSEQUENT REPORT OF SHOOTING OR ACIDIZING	
NOTICE OF INTENTION TO TEST WATER SHUT-OFF	SUBSEQUENT REPORT OF ALTERING CASING	
NOTICE OF INTENTION TO RE-DRILL OR REPAIR WELL	SUBSEQUENT REPORT OF RE-DRILLING OR REPAIR	
NOTICE OF INTENTION TO SHOOT OR ACIDIZE	SUBSEQUENT REPORT OF ABANDONMENT	
NOTICE OF INTENTION TO PULL OR ALTER CASING	SUPPLEMENTARY WELL HISTORY	
NOTICE OF INTENTION TO ABANDON WELL		

INDICATE ABOVE BY CHECK MARK NATURE OF REPORT, NOTICE, OR OTHER DATA

April 12,

19 62

Angel Peak
Well No. 2 is located 1750 ft. from ~~XXXX~~ line and 990 ft. from ~~XXX~~ line of sec. 22

S.W. Section 20
(4 Sec. and 36 Sec. No.)

27-N

11-W

N.M.P.M.

Basin Dakota
(Field)

San Juan

New Mexico
(State or Territory)

The elevation of the derrick floor above sea level is 6198 ft.

DETAILS OF WORK

(State names of and expected depths to objective sands; show sizes, weights, and lengths of proposed casings; indicate mudding jobs, cementing points, and all other important proposed work.)

Spud date 4-6-62

On 4-7-62 T.D. 308'.

Ran 10 joints 9 5/8" 32.3# J-55 casing (295') @ 307',
w/200 sks. regular, 1/4 cu. ft. Strata-Crete "6"/sk., 2#
A-6. Circulate to surface. Held 600#/30 minutes.

RECEIVED
APR 16 1962

U. S. GEOLOGICAL SURVEY
FARMINGTON, NEW MEXICO

I understand that this plan of work must receive approval in writing by the Geological Survey before operations may be commenced.

Company El Paso Natural Gas Company

Address Box 990

Farmington, New Mexico

By *D. W. Neekhan*

Title Petroleum Engineer