

(SUBMIT IN TRIPLICATE)

UNITED STATES
DEPARTMENT OF THE INTERIOR
GEOLOGICAL SURVEY

Santa Fe
Land Office
Lease No. 077952
Unit J.C. Gordon

SUNDRY NOTICES AND REPORTS ON WELLS

NOTICE OF INTENTION TO DRILL.....	<input checked="" type="checkbox"/>	SUBSEQUENT REPORT OF WATER SHUT-OFF.....
NOTICE OF INTENTION TO CHANGE PLANS.....	<input type="checkbox"/>	SUBSEQUENT REPORT OF SHOOTING OR ACIDIZING.....
NOTICE OF INTENTION TO TEST WATER SHUT-OFF.....	<input type="checkbox"/>	SUBSEQUENT REPORT OF ALTERING CASING.....
NOTICE OF INTENTION TO RE-DRILL OR REPAIR WELL.....	<input type="checkbox"/>	SUBSEQUENT REPORT OF REDRILLING OR REPAIR.....
NOTICE OF INTENTION TO SHOOT OR ACIDIZE.....	<input type="checkbox"/>	SUBSEQUENT REPORT OF ABANDONMENT.....
NOTICE OF INTENTION TO PULL OR ALTER CASING.....	<input type="checkbox"/>	SUPPLEMENTARY WELL HISTORY.....
NOTICE OF INTENTION TO ABANDON WELL.....	<input type="checkbox"/>	

(INDICATE ABOVE BY CHECK MARK NATURE OF REPORT, NOTICE, OR OTHER DATA)

April 16, 1951, 19

Well No. 1 is located 990 ft. from {N} line and 990 ft. from {E} line of sec. 24

NE/4 NE/4 Sec. 24 27N 10W N.M.P.M.
(1/4 Sec. and Sec. No.) (Twp.) (Range) (Meridian)
Fulcher-Kutz San Juan New Mexico
(Field) (County or Subdivision) (State or Territory)

The elevation of the derrick floor above sea level is 6540 ft. Ground

DETAILS OF WORK

(State names of and expected depths to objective sands; show sizes, weights, and lengths of proposed casings; indicate mudding jobs, cementing points, and all other important proposed work)

Drill with Rotary tools to top of Picture Cliffs Sand.
Set approximately 105 feet 9-5/8" O.D. 40# 3rd, thd. SmIs. Casing cemented to surface with 60 Sacks cement.
Set 5 1/2" O.D. 15# 3rd, thd. SmIs. casing on Picture Cliffs sand Cemented with 150 Sacks.
Drill Plug and complete with Cable tools.
Estimated T.D. 2456 Feet
Designated Drilling unit NE/4 of Section 24

I understand that this plan of work must receive approval in writing by the Geological Survey before operations may be commenced.

Company Byrd-Frost, Inc.
Address P.O. Box 911
Durango, Colorado
By John Carothers
Title Dist. Office Mgr.

Company Byrd- Frost, Inc., Dallas, Texas

Lease Joe C. Gordon Well No. 1

Sec. 24 T. 27 N., R. 10 W., N.M.P.M.

Location 990' from the North line and 990' from the East line.

San Juan County

New Mexico

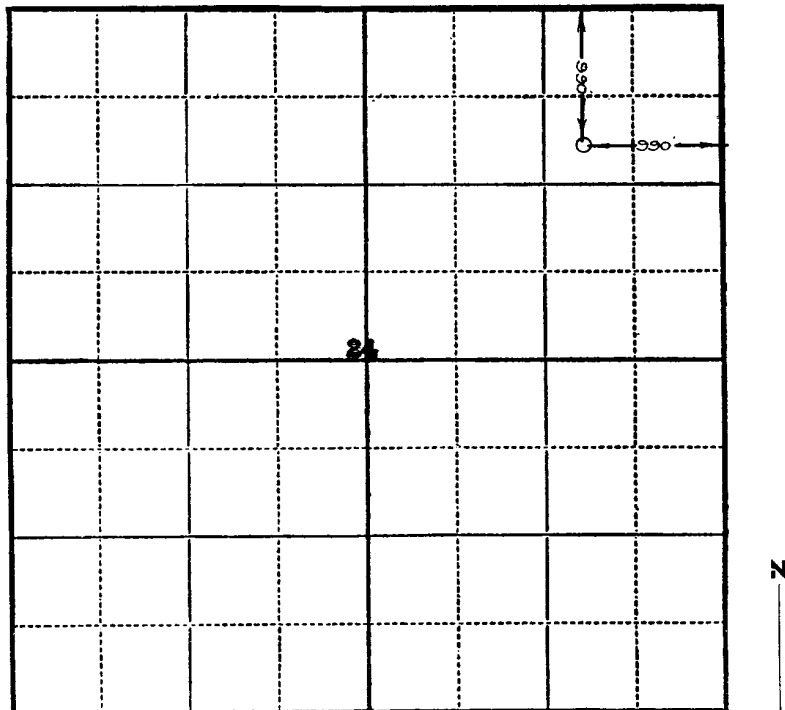

Scale—4 inches equals 1 mile.

This is to certify that the above plat was prepared from field notes of actual surveys made by me or under my supervision and that the same are true and correct to the best of my knowledge and belief.

Charles J. Finklea

Seal:

Registered Professional **Charles J. Finklea**
Engineer and Land Surveyor **N. Mex. Reg. No. 1302**

Farmington, New Mexico

Surveyed April 14, 19 51