

(SUBMIT IN TRIPLICATE)

UNITED STATES  
DEPARTMENT OF THE INTERIOR  
GEOLOGICAL SURVEY

Budget Bureau No. 42-R368.4.  
Approval expires 12-31-60.

Land Office New Mexico  
Lease No. 03380  
Unit Florance

RECEIVED

SUNDRY NOTICES AND REPORTS ON WELLS

MAR 12 1958  
U. S. GEOLOGICAL SURVEY  
FARMINGTON, NEW MEXICO

NOTICE OF INTENTION TO DRILL		SUBSEQUENT REPORT OF WATER SHUT-OFF	
NOTICE OF INTENTION TO CHANGE PLANS	<input checked="" type="checkbox"/>	SUBSEQUENT REPORT OF SHOOTING OR ACIDIZING	
NOTICE OF INTENTION TO TEST WATER SHUT-OFF		SUBSEQUENT REPORT OF ALTERING CASING	
NOTICE OF INTENTION TO RE-DRILL OR REPAIR WELL		SUBSEQUENT REPORT OF RE-DRILLING OR REPAIR	
NOTICE OF INTENTION TO SHOOT OR ACIDIZE		SUBSEQUENT REPORT OF ABANDONMENT	
NOTICE OF INTENTION TO PULL OR ALTER CASING		SUPPLEMENTARY WELL HISTORY	
NOTICE OF INTENTION TO ABANDON WELL			

(INDICATE ABOVE BY CHECK MARK NATURE OF REPORT, NOTICE, OR OTHER DATA)

March 10, 1958

Well No. 10-D(PM) is located 790 ft. from [N] line and 1650 ft. from [E] line of sec. 17

NE Sec. 17  
(1/4 Sec. and Sec. No.)

27N  
(Twp.)

6W  
(Range)

N.M.P.M.  
(Meridian)

Blanco M. V. - So. Blanco P.C.  
(Field)

San Juan  
(County or Subdivision)

New Mexico  
(State or Territory)

The elevation of the derrick floor above sea level is 6741 ft.

DETAILS OF WORK

(State names of and expected depths to objective sands; show sizes, weights, and lengths of proposed casings; indicate mudding jobs, cementing points, and all other important proposed work)

This well was originally intended to be completed in the Mesa Verde formation. Subsequent events, however, have brought about a change in plans. It is now intended to dually complete this well in the Mesa Verde and Pictured Cliffs formations, perforating and fracturing all possible productive zones in said formations. Casing program remains unchanged from original intentions.

The E/2 of Section 17 is dedicated to the Mesa Verde formation.  
The NE/4 of Section 17 is dedicated to the Pictured Cliffs formation.

E/2 & NE/4: NM 03380

I understand that this plan of work must receive approval in writing by the Geological Survey before operations may be commenced.

Company El Paso Natural Gas Company

Address Box 997  
Farmington, New Mexico

Original Signed D. C. Johnston  
By \_\_\_\_\_  
Title Petroleum Engineer

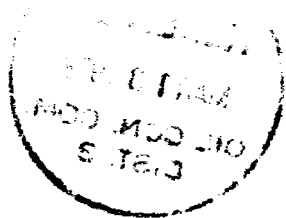

\_\_\_\_\_

## NEW MEXICO OIL CONSERVATION COMMISSION

## Well Location and Acreage Dedication Plat

Section A.

Date **JANUARY 31, 1958**

Operator **EL PASO NATURAL GAS COMPANY** Lease **FLORANCE** **NM 03380**  
 Well No. **10-D (PM)** Unit Letter **B** Section **17** Township **27N** Range **8W** NMPM  
 Located **790** Feet From **NORTH** Line, **1650** Feet From **EAST** Line  
 County **SAN JUAN** G. L. Elevation **6771** Dedication Acreage **320 & 160** Acres  
 Name of Producing Formation **MESA VERDE AND PICTURED CLIFF** Pool **BLANCO EXT. & SO. BLANCO P.C.**

1. Is the Operator the only owner in the dedicated acreage outlined on the plat below?

Yes ☒ No

2. If the answer to question one is "no", have the interests of all the owners been consolidated by communitization agreement or otherwise? Yes No If answer is "yes", Type of Consolidation.

3. If the answer to question two is "no", list all the owners and their respective interests below:

Owner

Land Description



**RECEIVED**  
**MAR 12 1958**  
 U. S. GEOLOGICAL SURVEY  
 FARMINGTON, NEW MEXICO

Section B.

This is to certify that the information in Section A above is true and complete to the best of my knowledge and belief.

**El Paso Natural Gas Company**

(Operator)

**Original Signed D. C. Johnston**

(Representative)

**Box 997**

(Address)

**Farmington, New Mexico**

**NOTE: THIS PLAT IS RE-ISSUED TO  
 SHOW DEDICATION FOR DUAL  
 COMPLETION WELL. 3 10 58**

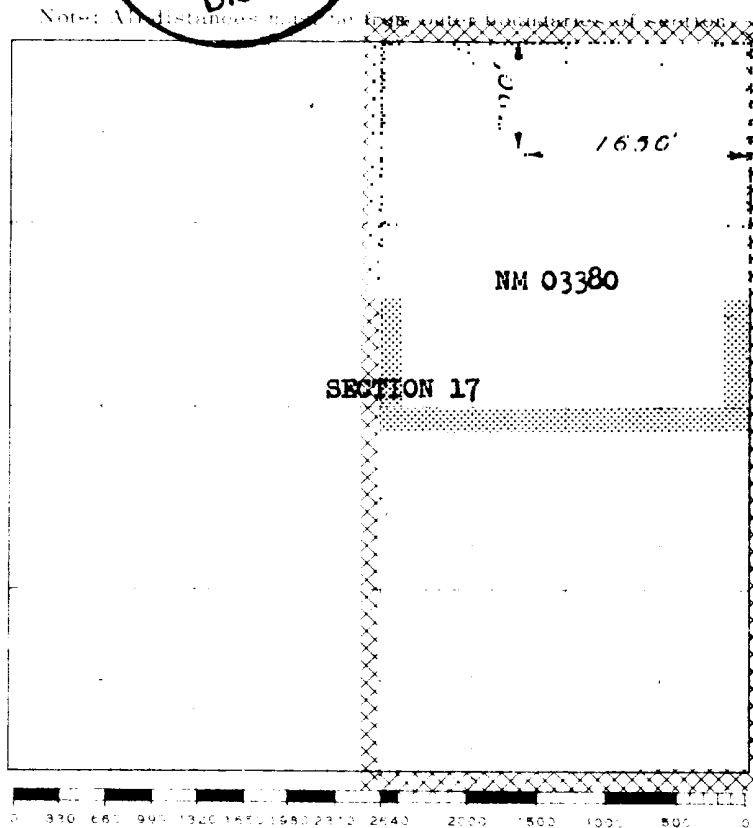

Scale 1 inch equals 1 mile

This is to certify that the above plat was prepared from field notes of actual surveys made by me or under my supervision and that the same are true and correct to the best of my knowledge and belief.

(Seal)

Date Surveyed **October 16, 1957**

*David C. Kilmer*  
 Registered Professional Engineer and/or Land Surveyor

Farmington, New Mexico