

(SUBMIT IN TRIPLICATE)

UNITED STATES
DEPARTMENT OF THE INTERIOR
GEOLOGICAL SURVEY

Land Office 255A W

Lease No. 255A W

Unit 255A W

SUNDRY NOTICES AND REPORTS ON WELLS

NOTICE OF INTENTION TO DRILL.....	SUBSEQUENT REPORT OF WATER SHUT-OFF.....
NOTICE OF INTENTION TO CHANGE PLANS.....	SUBSEQUENT REPORT OF SHOOTING OR ACIDIZING.....
NOTICE OF INTENTION TO TEST WATER SHUT-OFF.....	SUBSEQUENT REPORT OF ALTERING CASING.....
NOTICE OF INTENTION TO RE-DRILL OR REPAIR WELL.....	SUBSEQUENT REPORT OF REDRILLING OR REPAIR.....
NOTICE OF INTENTION TO SHOOT OR ACIDIZE.....	SUBSEQUENT REPORT OF ABANDONMENT.....
NOTICE OF INTENTION TO PULL OR ALTER CASING.....	SUPPLEMENTARY WELL HISTORY.....
NOTICE OF INTENTION TO ABANDON WELL.....	

(INDICATE ABOVE BY CHECK MARK NATURE OF REPORT, NOTICE, OR OTHER DATA)

January 17, 1963

Well No. 1 is located 342 ft. from N line and 1750 ft. from E line of sec. 14

3/4 Section 14 (1/4 Sec. and Sec. No.) 27E (Twp.) 9N (Range) 100 (Meridian)

Valchar (Field) San Juan (County or Subdivision) 100 (State or Territory)

The elevation of the derrick floor above sea level is _____ ft.

DETAILS OF WORK

(State names of and expected depths to objective sands; show sizes, weights, and lengths of proposed casings; indicate mudlogging jobs, cementing points, and all other important proposed work)

It is our intention to drill well no. 1 on the above described property to an approximate depth of 2200' to test the Pictured Cliff formation.

Casing program is as follows:

150' of 13-3/8" 40 lb 40 up on cemented with 150 sacks of regular cement.
2200' of 7" 20 lb 5-55 casing to be cemented with 200 sacks of regular cement.

3/4 of Section 14 is the designated drilling unit.

I understand that this plan of work must receive approval in writing by the Geological Survey before operations may be commenced.

Company Shelly Oil Company

Address Box 126

Armington, New Mexico

By C. E. Cooper

Title District Manager

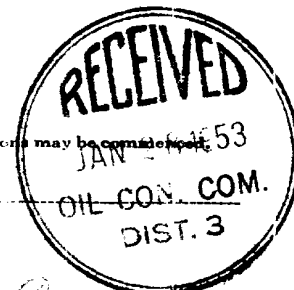

Company Skelly Oil Company

Lease Gentle Well No. 1

Sec. 14, T. 27 N., R. 9 E., N.M.P.M.

Location 990' from the South line and 1750' from the West line.

San Juan County

New Mexico

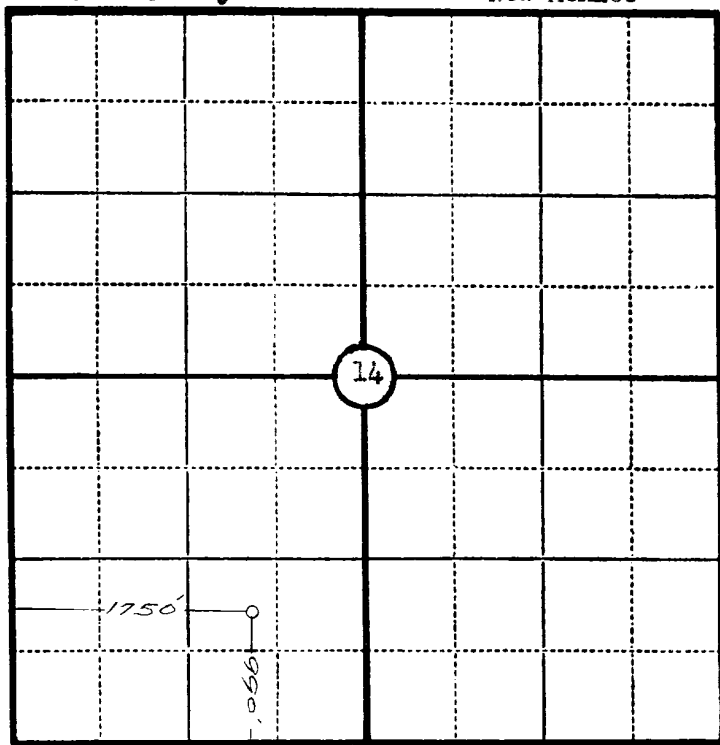

Scale—4 inches equal 1 mile.

This is to certify that the above plat was prepared from field notes of actual surveys made by me or under my supervision and that the same are true and correct to the best of my knowledge and belief.

Charles J. Finkbea

Seal:

Registered Professional
Engineer and Land Surveyor.

Charles J. Finkbea
N. Mex. Reg. No. 1302

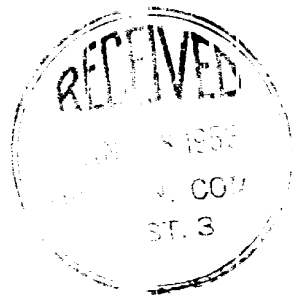

Surveyed January 17, 19 53