

COPY

SOUTHERN UNION GAS COMPANY

Burt Building  
DALLAS 1, TEXAS

November 23, 1951



Mr. P. T. McGrath  
United States Geological Survey  
P. O. Box 965  
Farmington, New Mexico

Re: S. F. 078354 - Fed. N.M. 02294  
Communitized Unit: SW $\frac{1}{4}$  Sec. 17,  
T-27-N., R-9-W., N. M. P. M.  
Southern Union Gas Co's Riddle No. 1 well

Dear Mr. McGrath:

Attached are three copies each of surveyor's plat and "notice of intention to drill" Riddle No. 1 well, 990' from South line and 1090' from West line (SW $\frac{1}{4}$  SW $\frac{1}{4}$ ) Section 17, T-27-N., R-9-W., N.M.P.M., Fulcher-Kutz field, San Juan County, New Mexico.

Please send us a collect telegram when you approve this notice.

Yours very truly,

*Van Thompson*  
Van Thompson

VT/ba  
Attach-

cc: Bay Petroleum Corp.,  
444 17th Street  
Denver, Colorado

bcc: New Mexico Oil Conservation Com. ✓  
Box 967, Aztec, N. M.

H. C. Montgomery - Farmington  
Land & Lease Dept.  
Measurement Dept.

October 1944

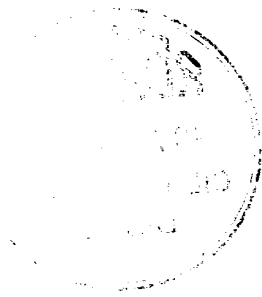

Washington, D.C.  
October 1944  
B. O. Thompson

Washington, D.C.  
October 1944  
B. O. Thompson

Washington, D.C.

Washington, D.C.  
October 1944  
B. O. Thompson

Washington, D.C.

Washington, D.C.

Washington, D.C.

Washington, D.C.

Washington, D.C.  
October 1944  
B. O. Thompson

Washington, D.C.  
October 1944  
B. O. Thompson

Washington, D.C.  
October 1944  
B. O. Thompson

Santa Fe

Land Office **076354**

Lease **SW 1/4 Sec. 17, T-27N, R-9W.,**  
Unit **N.M.P.M.**

UNIT: **UNITED STATES**

**UNITED STATES**  
**DEPARTMENT OF THE INTERIOR**  
**GEOLOGICAL SURVEY** S.U.G. Fed-N.M.02294- **SW 1/4**  
Bay Pot. Corp.-Fed-S.F.076354- **SW 1/4**

STATE OF NEW MEXICO  
**OIL CONSERVATION**  
**COMMISSION**  
DISTRICT NO. 3  
Phone 90 P. O. Box 697  
AZTEC, NEW MEXICO

# **SUNDRY NOTICES AND REPORTS ON WELLS**

NOTICE OF INTENTION TO DRILL.....	SUBSEQUENT REPORT OF WATER SHUT-OFF.....
NOTICE OF INTENTION TO CHANGE PLANS.....	SUBSEQUENT REPORT OF SHOOTING OR ACIDIZING.....
NOTICE OF INTENTION TO TEST WATER SHUT-OFF.....	SUBSEQUENT REPORT OF ALTERING CASING.....
NOTICE OF INTENTION TO RE-DRILL OR REPAIR WELL.....	SUBSEQUENT REPORT OF REDRILLING OR REPAIR.....
NOTICE OF INTENTION TO SHOOT OR ACIDIZE.....	SUBSEQUENT REPORT OF ABANDONMENT.....
NOTICE OF INTENTION TO PULL OR ALTER CASING.....	SUPPLEMENTARY WELL HISTORY.....
NOTICE OF INTENTION TO ABANDON WELL.....	

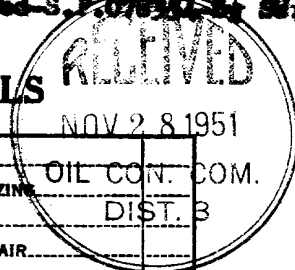

(INDICATE ABOVE BY CHECK MARK NATURE OF REPORT, NOTICE, OR OTHER DATA)

**November 23,** **51**

19

Well No. **1 Riddle** is located **990** ft. from **[N]** line and **1090** ft. from **[E]** line of sec. **17**  
**SW 1/4 SW 1/4 Sec. 17** **27 North** **West** **U.M.P.M.** **W**

**Pulcher, John (No.)** **Santa Juan County** **(Mer) New Mexico**  
(Field) (County or Subdivision) (State or Territory)

**Will be furnished**

The elevation of the derrick floor above sea level is \_\_\_\_\_ ft.

## **DETAILS OF WORK**

(State names of and expected depths to objective sands; show sizes, weights, and lengths of proposed casings; indicate mudding jobs, cementing points, and all other important proposed work)

**The objective sand is the Pictured Cliffs. The top is expected at about 2300'. The producing string will be 5 1/2" O.D. casing which will be cemented.**

**Approximate casing program:**

**100' of 8-5/8" O.D. cemented**  
**2300' of 5 1/2" O.D. cemented with about 100 sacks**  
**2400' of 1" siphon line.**

**Well will be drilled with rotary tools to top of Pictured Cliffs sand, and 5 1/2" O.D. casing set. Well will be drilled into pay zone with cable tools. The well will then be shot with approximately 150 quarts of nitro glycerine.**

I understand that this plan of work must receive approval in writing by the Geological Survey before operations may be commenced.

**SOUTHERN UNION GAS COMPANY**

Company **1104 Bart Building**  
Address **Dallas 1, Texas**

By **Van Thompson**  
Title **Manager, Exploration Dept.**

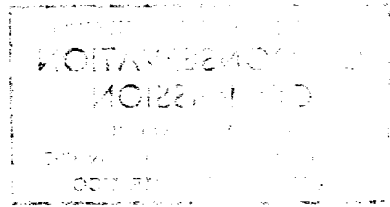

(SUMMIT IN TRIPLICATE)

UNITED STATES

DEPARTMENT OF THE INTERIOR

GEOLOGICAL SURVEY

# SUMMIT NOTICES AND REPORTS ON WELLS

1. NAME OF WELL	2. LOCATION	3. DATE OF REPORT
4. NAME OF REPORTER	5. TITLE OF REPORT	6. SUMMARY
7. DESCRIPTION OF WELL	8. RESULTS OF DRILLING	9. ANALYSES
10. COMMENTS	11. RECOMMENDATIONS	12. SIGNATURE

10

is located \_\_\_\_\_ ft from \_\_\_\_\_ line and \_\_\_\_\_

(Name of well) (Location of well) (Date of report)

The location of the derrick floor above \_\_\_\_\_

## INDEX

The following is a list of the wells and reports included in this index:

- 1. \_\_\_\_\_
- 2. \_\_\_\_\_
- 3. \_\_\_\_\_
- 4. \_\_\_\_\_
- 5. \_\_\_\_\_
- 6. \_\_\_\_\_
- 7. \_\_\_\_\_
- 8. \_\_\_\_\_
- 9. \_\_\_\_\_
- 10. \_\_\_\_\_

It is noted that this list of wells is not complete and that it is subject to change.

Company \_\_\_\_\_

Address \_\_\_\_\_

City \_\_\_\_\_ State \_\_\_\_\_

Company Southern Union Gas Company

Lease Riddle Well No. 1

Sec. 17 T. 27 N., R. 9 W., N.M.P.M.

Location 990' from the South line and 1090' from the West line.



San Juan County

New Mexico

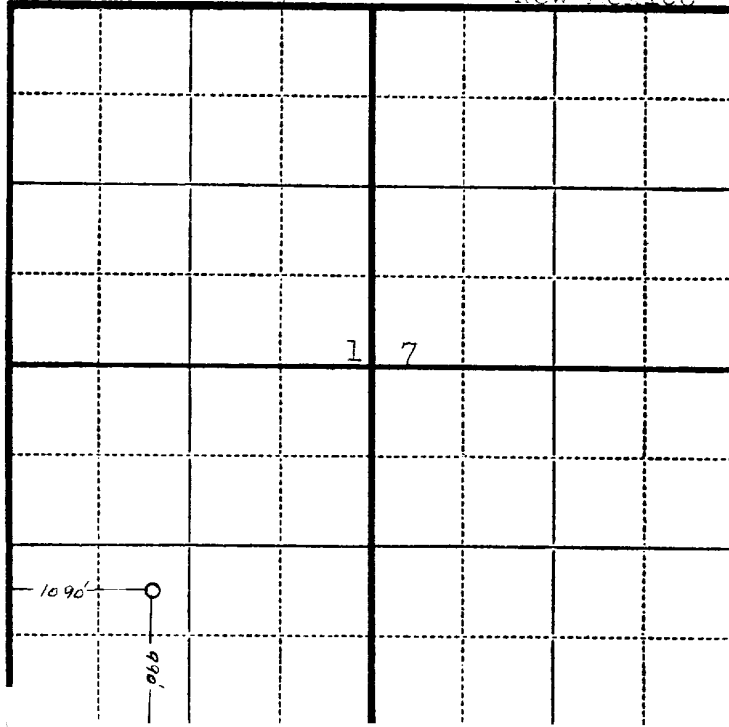

Scale—4 inches equals 1 mile.

This is to certify that the above plat was prepared from field notes of actual surveys made by me or under my supervision and that the same are true and correct to the best of my knowledge and belief.

*Charles J. Finklea*

Seal:

Registered Professional Charles J. Finklea  
Engineer and Land Surveyor. N. Mex. Reg. No. 1302

Surveyed October 11, 1951