

(SUBMIT IN TRIPLICATE)

Indian Agency: _____

UNITED STATES
DEPARTMENT OF THE INTERIOR
GEOLOGICAL SURVEY

Navajo Allotted

Allottee L-149-Ind. 8466

Lease No. John Charles

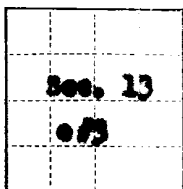

SUNDRY NOTICES AND REPORTS ON WELLS

NOTICE OF INTENTION TO DRILL.....	X	SUBSEQUENT REPORT OF WATER SHUT-OFF.....
NOTICE OF INTENTION TO CHANGE PLANS.....		SUBSEQUENT REPORT OF SHOOTING OR ACIDIZING.....
NOTICE OF INTENTION TO TEST WATER SHUT-OFF.....		SUBSEQUENT REPORT OF ALTERING CASING.....
NOTICE OF INTENTION TO REDRILL OR REPAIR WELL.....		SUBSEQUENT REPORT OF REDRILLING OR REPAIR.....
NOTICE OF INTENTION TO SHOOT OR ACIDIZE.....		SUBSEQUENT REPORT OF ABANDONMENT.....
NOTICE OF INTENTION TO PULL OR ALTER CASING.....		SUPPLEMENTARY WELL HISTORY.....
NOTICE OF INTENTION TO ABANDON WELL.....		

(INDICATE ABOVE BY CHECK MARK NATURE OF REPORT, NOTICE, OR OTHER DATA)

John Charles

November 7, 1956

Well No. 2 is located 1500 ft. from N line and 1750 ft. from W line of sec. 13

SW/4 Section 13
(1/4 Sec. and Sec. No.)

27N
(Twp.)

9W
(Range)

N.H.P.M.
(Meridian)

South Elanco - P.C.
(Field)

San Juan
(County or Subdivision)

New Mexico
(State or Territory)

The elevation of the derrick floor above sea level is _____ ft.

DETAILS OF WORK

(State names of and expected depths to objective sands; show sizes, weights, and lengths of proposed casings; indicate rauding jobs, cementing points, and all other important proposed work)

It is our intention to drill well No. 3 to approximately 2200' to test the Pictured Cliffs formation. Our casing program is as follows:

**190' of 8-5/8" od 28# casing - cemented with 150 lbs. reg. cement - circulated.
2200' of 5-1/2" od 14# casing - cemented with 150 lbs. reg. cement.**

I understand that this plan of work must receive approval in writing by the Geological Survey before operations may be commenced.

Company Shelly Oil Company

Address Box 426

Farmington, New Mexico

By Signed: [Signature]

Title District Foreman

NEW MEXICO
OIL CONSERVATION COMMISSION

Form C-128

Well Location and/or Gas Proration Plat

Date November 7, 1956

Operator Skelly Oil Company Lease John Charles

Well No. 3 Section 13 Township 27 N. Range 9 W. NMPM

Located 1500 Feet From South Line, 1750 Feet From West Line,

San Juan County, New Mexico. G. L. Elevation _____

Name of Producing Formation Pictured Cliffs Pool South Blanco Dedicated Acreage 140

(Note: All distances must be from outer boundaries of Section)

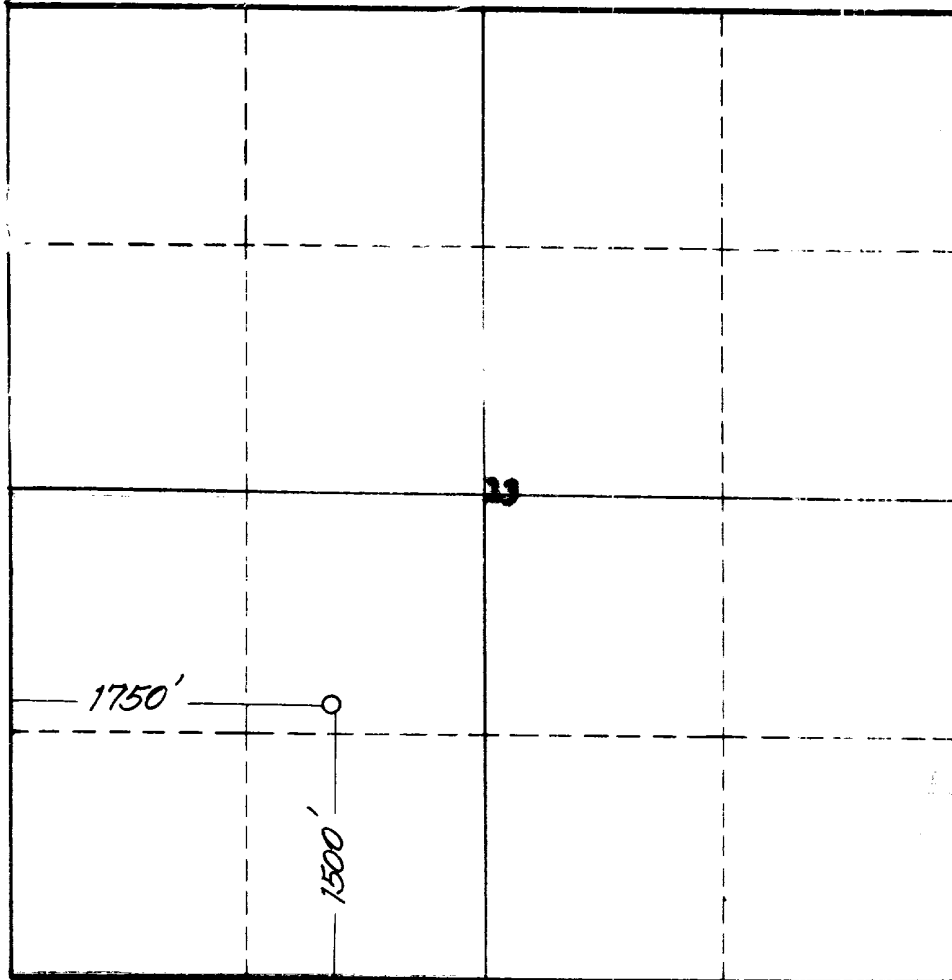

SCALE: 1"=1000'

NOTE

This section of form is to be used for gas wells only.



1. Is this Well a Dual Comp.? Yes No
2. If the answer to Question 1 is yes, are there any other dually completed wells within the dedicated acreage? Yes _____ No _____

Name James P. Leese
Position District Foreman
Representing Skelly Oil Company
Address Box 426, Farmington, New Mexico

This is to certify that the above plat was prepared from field notes of actual surveys made by me or under my supervision and that the same are true and correct to the best of my knowledge and belief.

Date Surveyed 28 Oct. 1956
James P. Leese
Registered Professional Engineer and/or
Land Surveyor James P. Leese
N.M. Reg. No. 1463