

(SUBMIT IN TRIPLICATE)

UNITED STATES  
DEPARTMENT OF THE INTERIOR  
GEOLOGICAL SURVEY

Land Office \_\_\_\_\_  
Lease No. **SF-079115**  
Unit \_\_\_\_\_  
**Jenkins Federal**

SUNDRY NOTICES AND REPORTS ON WELLS

NOTICE OF INTENTION TO DRILL	<input checked="" type="checkbox"/>	SUBSEQUENT REPORT OF WATER SHUT-OFF	
NOTICE OF INTENTION TO CHANGE PLANS		SUBSEQUENT REPORT OF SHOOTING OR ACIDIZING	
NOTICE OF INTENTION TO TEST WATER SHUT-OFF		SUBSEQUENT REPORT OF ALTERING CASING	
NOTICE OF INTENTION TO RE-DRILL OR REPAIR WELL		SUBSEQUENT REPORT OF RE-DRILLING OR REPAIR	
NOTICE OF INTENTION TO SHOOT OR ACIDIZE		SUBSEQUENT REPORT OF ABANDONMENT	
NOTICE OF INTENTION TO PULL OR ALTER CASING		SUPPLEMENTARY WELL HISTORY	<input checked="" type="checkbox"/>
NOTICE OF INTENTION TO ABANDON WELL			

(INDICATE ABOVE BY CHECK MARK NATURE OF REPORT, NOTICE, OR OTHER DATA)

3/21/61, 1961

Well No. 1 is located 1850 ft. from ☒ S line and 790 ft. from ☒ E line of sec. 13  
NE 1/4 Sec. 13 27N 12W NMPM  
(1/4 Sec. and Sec. No.) (Twp.) (Range) (Meridian)  
Basin Dakota San Juan New Mexico  
(Field) (County or Subdivision) (State or Territory)

The elevation of the derrick floor above sea level is 6095.6 ft. G.L.

DETAILS OF WORK

(State names of and expected depths to objective sands; show sizes, weights, and lengths of proposed casings; indicate mudding jobs, cementing points, and all other important proposed work)

Propose to drill with rotary tools to an approximate depth of 6500' or to test the Dakota formation. Casing program will be as follows:

10 3/4" 32.75# surface set at approximately 300' w/250 sx cement.  
 9 1/8" 15.50# to be set at total depth w/400 sx or adequate cement will be placed on bottom to cover the Gallup formation & a DV tool will be placed for the protection of the Pictured Cliffs formation.

Will perforate and sand frac the Dakota formation.

I understand that this plan of work must receive approval in writing by the Geological Survey before operations may be commenced.

Company Southwest Production Company  
 Address 162 Petr. Center Bldg.  
Farmington, N. M.  
 By \_\_\_\_\_  
 Title Production Supt.

Original signed by  
Carl W. Smith

NUMBER OF COPIES RECEIVED	
DISTRIBUTION	
SANTA FE	
FILE	
U.S.G.S.	
LAND OFFICE	
TRANSPORTER	OIL GAS
PRODUCTION OFFICE	
OPERATOR	

**NEW MEXICO OIL CONSERVATION COMMISSION**  
**WELL LOCATION AND ACREAGE DEDICATION PLAT**  
 SEE INSTRUCTIONS FOR COMPLETING THIS FORM ON THE REVERSE SIDE

FORM C-128  
Revised 5/1/57

**SECTION A**

Operator <b>SOUTHWEST PRODUCTION COMPANY</b>		Lease <b>Jenkins Federal SP-079115</b>		Well No. <b>1</b>
Unit Letter <b>I</b>	Section <b>13</b>	Township <b>27 NORTH</b>	Range <b>12 WEST</b>	County <b>SAN JUAN</b>
Actual Footage Location of Well: <b>1850</b> feet from the <b>SOUTH</b> line and <b>790</b> feet from the <b>EAST</b> line				
Ground Level Elev. <b>6095.6</b>	Producing Formation <b>Dakota</b>	Pool <b>Basin Dakota</b>	Dedicated Acreage: <b>5/320</b> Acres	

Ref: GLO plat dated 19 July 1915

1. Is the Operator the only owner in the dedicated acreage outlined on the plat below? YES ☒ NO ☐ ("Owner" means the person who has the right to drill into and to produce from any pool and to appropriate the production either for himself or for himself and another. (65-3-29 (e) NMSA 1935 Comp.)
2. If the answer to question one is "no," have the interests of all the owners been consolidated by communitization agreement or otherwise? YES ☐ NO ☐ . If answer is "yes," Type of Consolidation \_\_\_\_\_
3. If the answer to question two is "no," list all the owners and their respective interests below:

Owner	Land Description

**SECTION B**

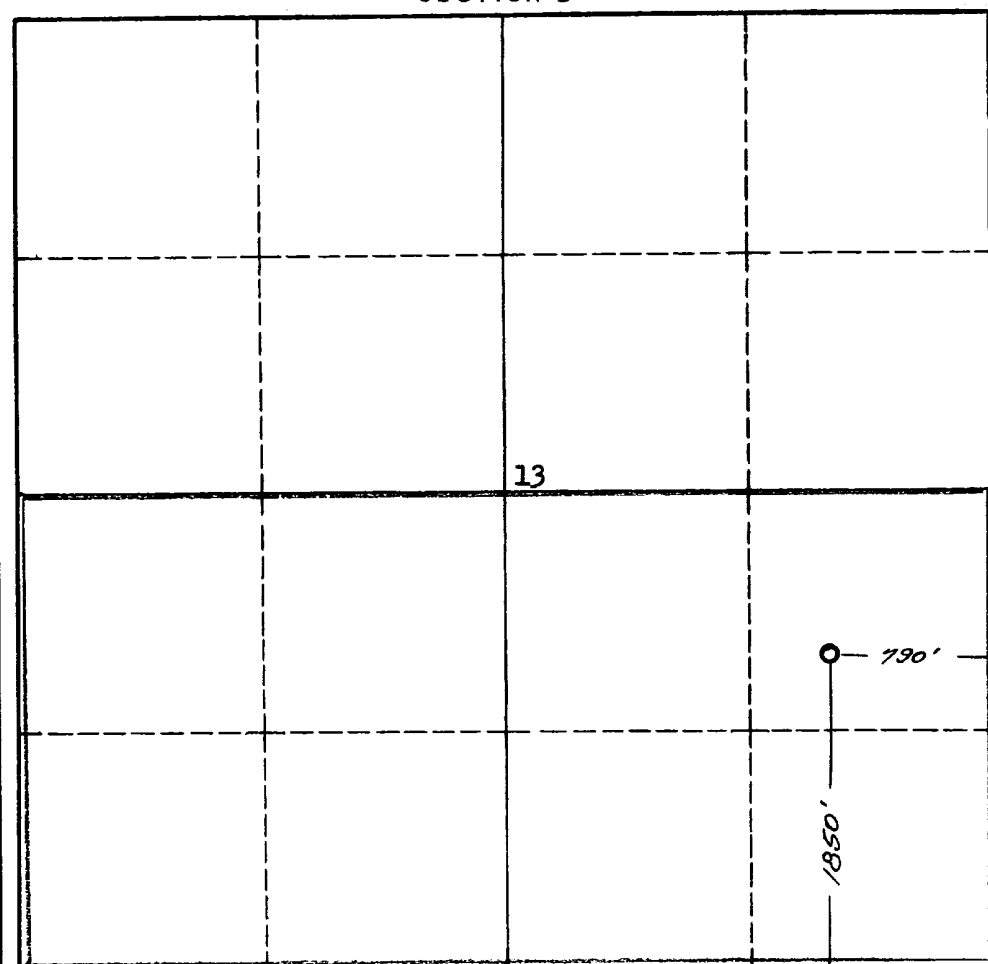

**CERTIFICATION**

I hereby certify that the information in SECTION A above is true and complete to the best of my knowledge and belief.

Name	Original signed by <b>Carl W. Smith</b>
Position	<b>Production Supt.</b>
Company	<b>Southwest Production Co.</b>
Date	<b>3/20/61</b>

I hereby certify that the well location shown on the plat in SECTION B was plotted from field notes of actual surveys made by me or under my supervision, and that the same is true and correct to the best of my knowledge and belief.

Date Surveyed	<b>12 July 1960</b>
Registered Professional Engineer and/or Land Surveyor	<b>James P. Lease</b>
Certificate No.	<b>1463</b>

San Juan Engineering Company

## INSTRUCTIONS FOR COMPLETION OF FORM C-128

1. Operator shall furnish and certify to the information called for in Section A.
  2. Operator shall outline the dedicated acreage for *both* oil and gas wells on the plat in Section B.
  3. A registered professional engineer or land surveyor registered in the State of New Mexico or approved by the Commission shall show on the plat the location of the well and certify this information in the space provided.
  4. All distances shown on the plat must be from the outer boundaries of the Section.
  5. If additional space is needed for listing owners and their respective interests as required in question 3 of Section A, please use space below.
-