

NEW MEXICO  
OIL CONSERVATION COMMISSION

WELL LOCATION AND GAS PRORATION PLAT

MAY 4, 1956

EL PASO NATURAL GAS COMPANY

FLORANCE "D"

NM 03380

6

18

27-N

8-W

1590

NORTH

890

WEST

SAN JUAN

6047

PICTURED CLIFF

SO. BLANCO

160<sup>26</sup>  
(1882 PLAT)

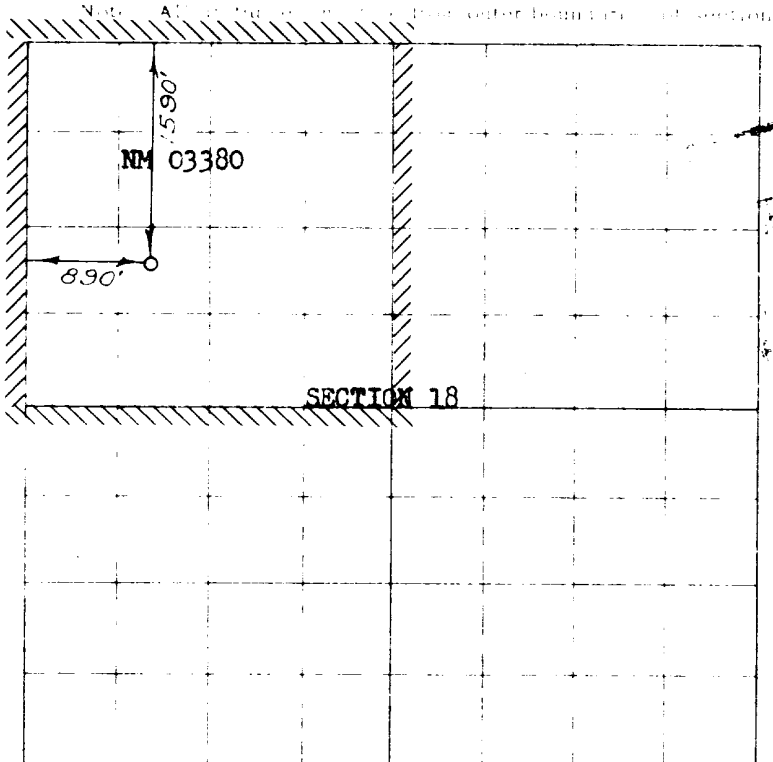

Scale: 1 inch = equal 1 mile

NOTE

This section of  
form is to be used  
for gas wells only

This is to certify that the above plat was prepared from  
field notes of actual surveys made by me or under my  
supervision and that the same are true and correct to the  
best of my knowledge and belief.

Date Surveyed MAY 1, 1956

E. O. Walker  
Registered Professional Engineer and Land Surveyor

1. Is this well a Dual Completion?

Yes \_\_\_\_\_ No X

2. If the answer to Question 1

is yes, are there any other fully  
completed wells within the  
dedicated acreage?

Yes \_\_\_\_\_ No \_\_\_\_\_

Name F. W. Boyd

Position Petroleum Engineer

Representing El Paso Natural Gas Co.

Address Box 997, Farmington, N.M.

Seal:

Farmington, New Mexico



UNITED STATES  
DEPARTMENT OF THE INTERIOR  
GEOLOGICAL SURVEY  
P. O. Box 965  
Farmington, New Mexico

June 4, 1956



El Paso Natural Gas Company  
Box 997  
Farmington, New Mexico

Re: New Mexico 03380

Gentlemen:

Receipt is acknowledged of your "Notice of Intention to Drill" dated June 1, 1956 covering your well No. 6-D Florance in NW $\frac{1}{4}$  sec. 18, T. 27 N., R. 8 W., N. M. P. M., San Juan County, New Mexico, So. Blanco pool.

Your proposed work is hereby approved subject to compliance with the provisions of the "Oil and Gas Operating Regulations" revised May 25, 1942, a copy of which will be sent to you on request, and subject to the following conditions:

1. Drilling operations so authorized are subject to the attached sheet for general conditions of approval.
2. Furnish copies of all logs.

Very truly yours,

(Orig. Sig.) P. T. McGrath

P. T. McGrath  
District Engineer

PTMcGrath:ac

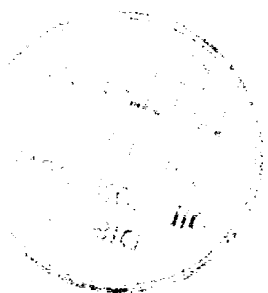

---

---

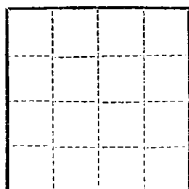

(SUBMIT IN TRIPLICATE)

UNITED STATES  
DEPARTMENT OF THE INTERIOR  
GEOLOGICAL SURVEY

Land Office New Mexico  
Lease No. 03380  
Unit Florencia

SUNDRY NOTICES AND REPORTS ON WELLS

NOTICE OF INTENTION TO DRILL	<input checked="" type="checkbox"/>	SUBSEQUENT REPORT OF WATER SHUT-OFF
NOTICE OF INTENTION TO CHANGE PLANS		SUBSEQUENT REPORT OF SHOOTING OR ACIDIZING
NOTICE OF INTENTION TO TEST WATER SHUT-OFF		SUBSEQUENT REPORT OF ALTERING CASING
NOTICE OF INTENTION TO RE-DRILL OR REPAIR WELL		SUBSEQUENT REPORT OF RE-DRILLING OR REPAIR
NOTICE OF INTENTION TO SHOOT OR ACIDIZE		SUBSEQUENT REPORT OF ABANDONMENT
NOTICE OF INTENTION TO PULL OR ALTER CASING		SUPPLEMENTARY WELL HISTORY
NOTICE OF INTENTION TO ABANDON WELL		

(INDICATE ABOVE BY CHECK MARK NATURE OF REPORT, NOTICE, OR OTHER DATA)

June 1, 1956

Well No. 6-D is located 1590 ft. from N line and 890 ft. from W line of sec. 18  
NE Section 18 27N 8W EDPM  
 (1/4 Sec. and Sec. No.) (Twp.) (Range) (Meridian)  
So. Blanco San Juan New Mexico  
 (Field) (County or Subdivision) (State or Territory)

The elevation of the derrick floor above sea level is 6057 ft.

DETAILS OF WORK

(State names of and expected depths to objective sands; show sizes, weights, and lengths of proposed casings; indicate mudding jobs, cementing points, and all other important proposed work)

It is intended to drill a well thru the Pictured Cliff formation using rotary tools and to perforate and water fracture possible producing zones. Estimated Total Depth 2200'.

Casing Program:

9 5/8" at 120' with 125 sacks regular cement circulated to surface.  
5 1/2" at 2200' with 75 sacks regular cement, 75 sacks Pozmix.

The NE/4 of Section 18 is dedicated to this well.  
(NE/4) NM 03380.

I understand that this plan of work must receive approval in writing by the Geological Survey before operations may be commenced.

Company El Paso Natural Gas Company

Address Box 997

Farmington, New Mexico

By [Signature]  
Title Petroleum Engineer

1000

1

1000

1

1

1000

1000

1000

1000

1000

1000

1000

1000

1000

1000

1000

1000

1000

1000

1000

1000

1000

1000

1000

1000

1000

1000

1000

1000

1000

1000

1000

1000

1000

1000

1000

1000

1000

1000

1000

1000

1000

1000

1000

1000

1000

1000

1000

1000