

UNITED STATES
DEPARTMENT OF THE INTERIOR
GEOLOGICAL SURVEY

APPLICATION FOR PERMIT TO DRILL, DEEPEN, OR PLUG BACK

1a. TYPE OF WORK
 DRILL DEEPEN PLUG BACK

b. TYPE OF WELL
 OIL WELL GAS WELL OTHER
 SINGLE ZONE MULTIPLE ZONE

2. NAME OF OPERATOR
Austral Oil Company Incorporated

3. ADDRESS OF OPERATOR
2700 Humble Building, Travis at Bell, Houston, Texas

4. LOCATION OF WELL (Report location clearly and in accordance with any State requirements.)*
At surface 1450' from lease line a 1450' from north line of sec. 15, T-27-N, R-9-E
 At proposed prod. zone **same**

14. DISTANCE IN MILES AND DIRECTION FROM NEAREST TOWN OR POST OFFICE*
20 miles SE of Alconfield

15. DISTANCE FROM PROPOSED* LOCATION TO NEAREST PROPERTY OR LEASE LINE, FT. (Also to nearest drlg. unit line, if any)
1450

16. NO. OF ACRES IN LEASE
20

18. DISTANCE FROM PROPOSED LOCATION* TO NEAREST WELL, DRILLING COMPLETED, OR APPLIED FOR, ON THIS LEASE, FT.
200'

19. PROPOSED DEPTH
7000'

21. ELEVATIONS (Show whether DF, RT, GR, etc.)
GR 18

5. LEASE DESIGNATION AND SERIAL NO.
Federal SF 078357

6. IF INDIAN, ALIOTTEE OR TRIBE NAME

7. UNIT AGREEMENT NAME

8. FARM OR LEASE NAME
Federal

9. WELL NO.
1-15

10. FIELD AND POOL, OR WILDCAT
Basin-Nakota

11. SEC., T., R., M., OR BLK. AND SURVEY OR AREA
12 COUNTY OR PARISH 13. STATE
San Juan New Mexico
NOV 15 1964

17. NO. OF ACRES ASSIGNED TO THIS WELL
20

20. ROOM NO. OF GEOLOGICAL SURVEY, WASHINGTON, D. C.

22. APPROX. DATE WORK WILL START
November 12, 1964

23. PROPOSED CASING AND CEMENTING PROGRAM

SIZE OF HOLE	SIZE OF CASING	WEIGHT PER FOOT	SETTING DEPTH	QUANTITY OF CEMENT
12 1/2	7-7/8	28	325	25 SACKS CEMENT
7-7/8	5-1/2	11.5	7000	24 SACKS

2 - 4 1/2" casing 100'

This well is to be known as the Federal (0441) 1-15 and is to be drilled to approximately 7,000'. This will be a Nakota Gas Test. There is a possibility also that the Mesa Verde formation may be productive. The surface casing is to be a 7-7/8" ID and set at 325' and cement full length with approximately 25 sacks of cement. Production casing will be 4 1/2" ID and set through the lower most productive zone with quantity of cement to be determined from depth of sands to be protected. A stage cementing tool will be set 50' below the base of the Pictured Cliff formation and adequate cement will be used to bring cement up to at least 50' above top of the Pictured Cliff formation. Also if the Mesa Verde formation is found to be productive, this procedure will be followed. The well will be drilled with water to about 4,000' after which mud will be used to a total depth.

IN ABOVE SPACE DESCRIBE PROPOSED PROGRAM: If proposal is to deepen or plug back, give data on present productive zone and proposed new productive zone. If proposal is to drill or deepen directionally, give pertinent data on subsurface locations and measured and true vertical depths. Give blowout preventer program, if any.

24. SIGNED C. R. Geffs C. R. Geffs TITLE Senior Petroleum Engineer DATE November 12, 1964

(This space for Federal or State office use)

PERMIT NO. _____ APPROVAL DATE _____

APPROVED BY _____ TITLE _____

CONDITIONS OF APPROVAL, IF ANY:

*See Instructions On Reverse Side

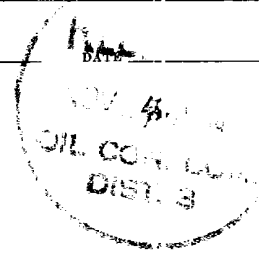

Instructions

General: This form is designed for submitting proposals to perform certain well operations, as indicated, on all types of lands and leases for appropriate action by either a Federal or a State agency, or both, pursuant to applicable Federal and/or State laws and regulations. Any necessary special instructions concerning the use of this form and the number of copies to be submitted, particularly with regard to local, area, or regional procedures and practices, either are shown below or will be issued by, or may be obtained from, the local Federal and/or State office.

Item 1: If the proposal is to redrill to the same reservoir at a different subsurface location or to a new reservoir, use this form with appropriate notations. Consult applicable State or Federal regulations concerning subsequent work proposals or reports on the well.

Item 4: If there are no applicable State requirements, locations on Federal or Indian land should be described in accordance with Federal requirements. Consult local State or Federal office for specific instructions.

Item 14: Needed only when location of well cannot readily be found by road from the land or lease description. A plat, or plats, separate or on this reverse side, showing the roads to, and the surveyed location of, the well, and any other required information, should be furnished when required by Federal or State agency offices.

Items 15 and 18: If well is to be, or has been directionally drilled, give distances for subsurface location of hole in any present or objective production zone.

Item 22: Consult applicable Federal or State regulations, or appropriate officials, concerning approval of the proposal before operations are started.

NEW MEXICO OIL CONSERVATION COMMISSION
Well Location and Acreage Dedication Plat

Section A.

Date November 12, 1964

Operator AUSTRAL OIL CO. INC. Lease FEDERAL (6443)
Well No. 1-15 Unit Letter F Section 15 Township 27 N Range 9W N.M.P.M.
Located 1450 Feet From north Line, 1450 Feet From west Line
County San Juan G. L. Elevation 6101 Dedicated Acreage 1/4 (320) Acres
Name of Producing Formation Dakota Pool Basin

1. Is the Operator the only owner* in the dedicated acreage outlined on the plat below?
Yes X No _____.
2. If the answer to question one is "no," have the interests of all the owners been consolidated by communitization agreement or otherwise? Yes _____ No _____. If answer is "yes," Type of Consolidation _____
3. If the answer to question two is "no," list all the owners and their respective interests below:

Owner	Land Description

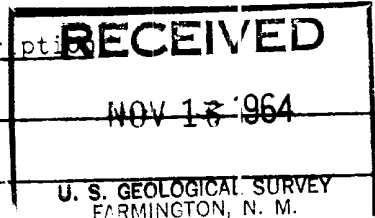
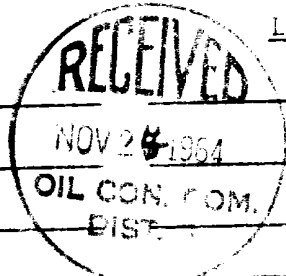

Section B

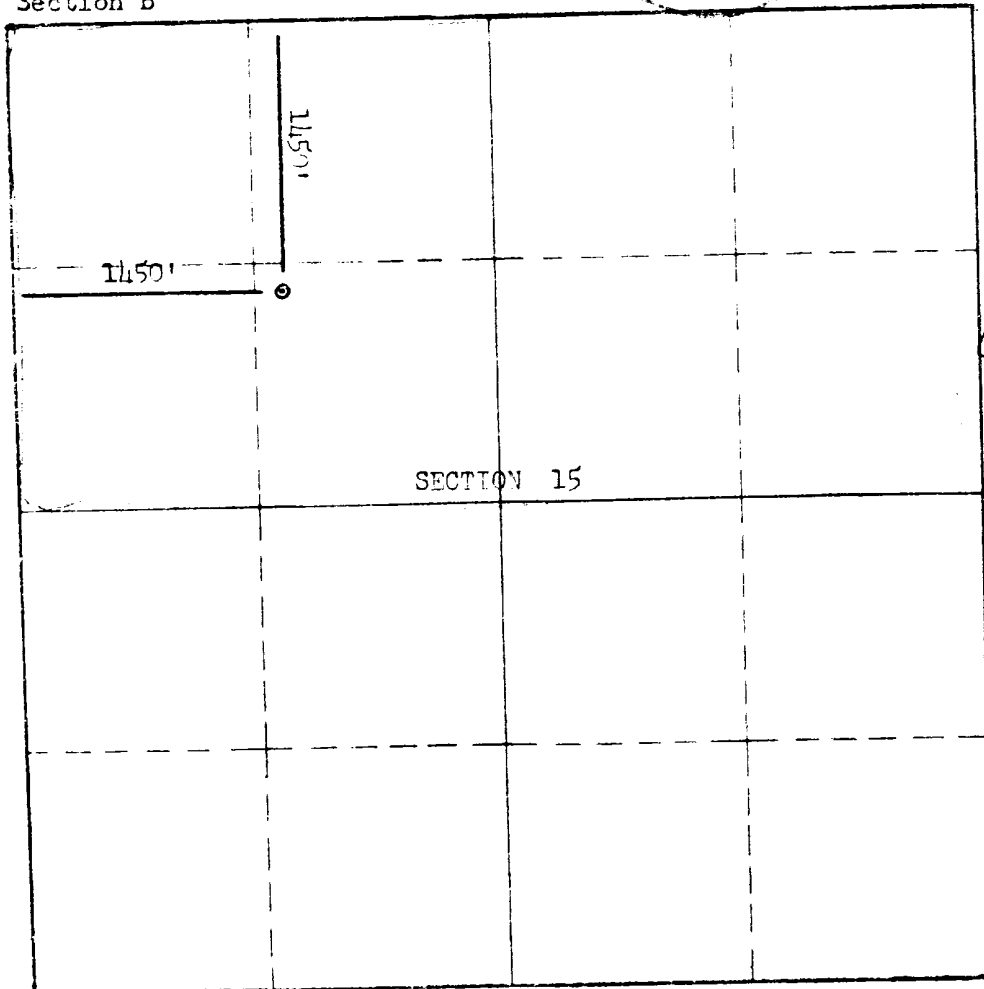

This is to certify that the information in Section A above is true and complete to the best of my knowledge and belief.

Austral Oil Co. Inc.
(Operator)

C. R. Geff's
(Representative)
300 San Jacinto Bldg.
Houston, Texas 77002
Address:

This is to certify that the well location shown on the plat in Section B was plotted from field notes of actual surveys made by me or under my supervision and that the same is true and correct to the best of my knowledge and belief.

Date Surveyed Nov. 9, 1964
Stephen H. Kinney
STEPHEN H. KINNEY

Registered Professional Engineer and/or Land Surveyor

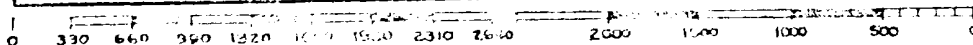

Certificate No. 803

(See instructions for completing this form on the reverse side)