

(SUBMIT IN TRIPLICATE)

UNITED STATES
DEPARTMENT OF THE INTERIOR
GEOLOGICAL SURVEY

Budget Bureau No. 42-B358.4.
Approval expires 12-31-60.

Land Office **Santa Fe, N.M.**
Lease No. **078009-A**
Rex No. **I**
Unit _____

SUNDRY NOTICES AND REPORTS ON WELLS

RECEIVED

OCT 16 1957

NOTICE OF INTENTION TO DRILL.....	<input checked="" type="checkbox"/>	SUBSEQUENT REPORT OF WATER SHUT-OFF.....	
NOTICE OF INTENTION TO CHANGE PLANS.....		SUBSEQUENT REPORT OF SHOOTING OR ACIDIZING.....	
NOTICE OF INTENTION TO TEST WATER SHUT-OFF.....		SUBSEQUENT REPORT OF ALTERING CASING.....	
NOTICE OF INTENTION TO RE-DRILL OR REPAIR WELL.....		SUBSEQUENT REPORT OF RE-DRILLING OR REPAIR.....	
NOTICE OF INTENTION TO SHOOT OR ACIDIZE.....		SUBSEQUENT REPORT OF ABANDONMENT.....	
NOTICE OF INTENTION TO PULL OR ALTER CASING.....		SUPPLEMENTARY WELL HISTORY.....	
NOTICE OF INTENTION TO ABANDON WELL.....			

(INDICATE ABOVE BY CHECK MARK NATURE OF REPORT, NOTICE, OR OTHER DATA)

October 14, 1957

Well No. **I** is located **990** ft. from **N** line and **990** ft. from **E** line of sec. **18**
NW1/4 **27N** **13W** **18PM**
 (1/4 Sec. and Sec. No.) (Twp.) (Range) (Meridian)
Wilcox **San Juan** **New Mexico**
 (Field) (County or Subdivision) (State or Territory)

The elevation of the derrick floor above sea level is **6055** ft.

DETAILS OF WORK

(State names of and expected depths to objective sands; show sizes, weights, and lengths of proposed casings; indicate mudding jobs, cementing points, and all other important proposed work)

We propose to drill a 12 1/4" hole to 250' and set 9 5/8" surface casing and cement with 150 sacks of cement. We will then drill a 8 3/4" hole to the top of the Gallup formation at approximately 5400'. We will core the Gallup and test the formation. If the formation is favorable we will set 7" casing. If unfavorable we propose to drill to the Dakota and test this formation. If favorable we propose to set 5 1/2" casing and cement with 300 sacks of cement. If both formations indicate production can be obtained we will seriously consider a dual completion.

I understand that this plan of work must receive approval in writing by the Geological Survey before operations may be commenced.

Company **Rex Uranium Corporation**
 Address **P.O. Box 1238**
Farmington, N.M.

By **R. D. Scanlon**
 Title **President**

NEW MEXICO OIL CONSERVATION COMMISSION
Well Location and Acreage Dedication Plat

Section A.

Date August 11, 1958

Operator Rex Uranium Corporation Lease SP 078009-C
Well No. 2 Unit Letter D Section 18 Township 27N Range 13W NMPM
Located 990 Feet From North Line, 990 Feet From West Line
County San Juan G. L. Elevation 6056 Dedicated Acreage 40 Acres
Name of Producing Formation Calup Pool Undesignated

1. Is the Operator the only owner* in the dedicated acreage outlined on the plat below?
Yes X No .
2. If the answer to question one is "no," have the interests of all the owners been consolidated by communitization agreement or otherwise? Yes No . If answer is "yes," Type of Consolidation
3. If the answer to question two is "no," list all the owners and their respective interests below:

Owner

Land Description

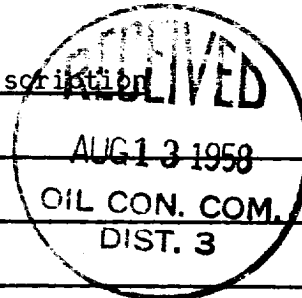

Section B

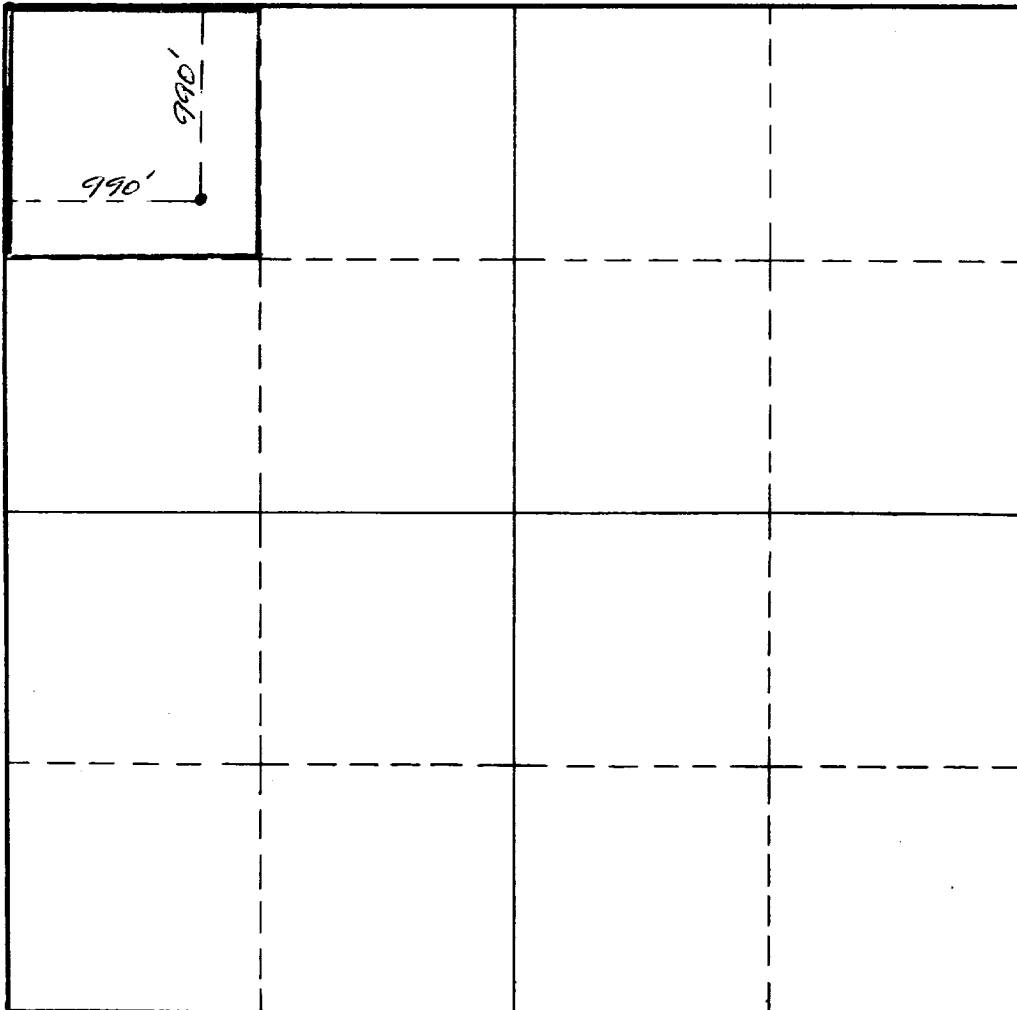

This is to certify that the information in Section A above is true and complete to the best of my knowledge and belief.

Rex Uranium Corporation

(Operator)

(Representative)

Box 1238, Farmington, N.M.

Address

This is to certify that the well location shown on the plat in Section B was plotted from field notes of actual surveys made by me or under my supervision and that the same is true and correct to the best of my knowledge and belief.

Date Surveyed Oct. 9, 1957

E. J. Scanlon
Registered Professional
Engineer and/or Land Surveyor.

Certificate No. 1457

(See instructions for completing this form on the reverse side)

INSTRUCTIONS FOR COMPLETION:

1. Operator shall furnish and certify to the information called for in Section A.
2. Operator shall outline the dedicated acreage for both oil and gas wells on the plat in Section B.
3. A registered professional engineer or land surveyor registered in the State of New Mexico or approved by the Commission shall show on the plat the location of the well and certify this information in the space provided.
4. All distances shown on the plat must be from the outer boundaries of Section.
5. If additional space is needed for listing owners and their respective interests as required in question 3, Section A, please use space below

* "Owner" means the person who has the right to drill into and to produce from any pool and to appropriate the production either for himself or for himself and another. (65-3-29 (e) NMSA 1953 Comp.)