

(SUBMIT IN TRIPLICATE)  
**UNITED STATES  
DEPARTMENT OF THE INTERIOR  
GEOLOGICAL SURVEY**

Land Office **Santa Fe**  
Lease No. **NM 060402**  
Unit **Fairfield**

## SUNDRY NOTICES AND REPORTS ON WELLS

NOTICE OF INTENTION TO DRILL	<input checked="" type="checkbox"/>	SUBSEQUENT REPORT OF WATER SHUT-OFF	
NOTICE OF INTENTION TO CHANGE PLANS		SUBSEQUENT REPORT OF SHOOTING OR ACIDIZING	
NOTICE OF INTENTION TO TEST WATER SHUT-OFF		SUBSEQUENT REPORT OF ALTERING CASING	
NOTICE OF INTENTION TO RE-DRILL OR REPAIR WELL		SUBSEQUENT REPORT OF RE-DRILLING OR REPAIR	
NOTICE OF INTENTION TO SHOOT OR ACIDIZE		SUBSEQUENT REPORT OF ABANDONMENT	
NOTICE OF INTENTION TO PULL OR ALTER CASING		SUPPLEMENTARY WELL HISTORY	
NOTICE OF INTENTION TO ABANDON WELL			

(INDICATE ABOVE BY CHECK MARK NATURE OF REPORT, NOTICE, OR OTHER DATA)

July 30, 1962

Well No. 2 is located 790 ft. from N line and 790 ft. from E line of sec. 15

NE NE Section 15 27N 13W NMPM  
(1/4 Sec. and Sec. No.) (Twp.) (Range) (Meridian)  
Basin Dakota San Juan New Mexico  
(Field) (County or Subdivision) (State or Territory)

The elevation of the derrick floor above sea level is 5965 ft. (Est.)

### DETAILS OF WORK

(State names of and expected depths to objective sands; show sizes, weights, and lengths of proposed casings; indicate mudding jobs, cementing points, and all other important proposed work)

**Dakota Test:** Estimated total depth 6250 feet.  
**Surface Casing:** 200 feet of 8-5/8" OD, J-55, 24#, cemented to surface.  
**Production Casing:** Approximately 6250 feet of 4-1/2" OD, N-80, 10.75#, cemented with 250 sacks of cement.

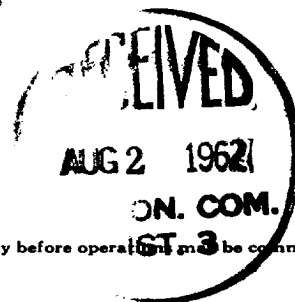

I understand that this plan of work must receive approval in writing by the Geological Survey before operations may be commenced.

Company W. H. Hudson  
Address 1126 Mercantile Securities  
Building  
Dallas 1, Texas  
By J. B. Avant  
Title Geologist

NEW MEXICO OIL CONSERVATION COMMISSION  
Well Location and Acreage Dedication Plat

Section A.

Date July 30, 1962

Operator W. H. HUDSON Lease FAIRFIELD  
Well No. 2 Unit Letter A Section 15 Township 27 N Range 13 W NMPM  
Located 790 Feet From north Line, 790 Feet From east Line  
County San Juan G. L. Elevation 5955 Dedicated Acreage 320 (Ea) Acres  
Name of Producing Formation Dakota Pool Basin

1. Is the Operator the only owner\* in the dedicated acreage outlined on the plat below?  
Yes X No       .
2. If the answer to question one is "no," have the interests of all the owners been consolidated by communitization agreement or otherwise? Yes        No       . If answer is "yes," Type of Consolidation
3. If the answer to question two is "no," list all the owners and their respective interests below:

Owner

Land Description

Section B

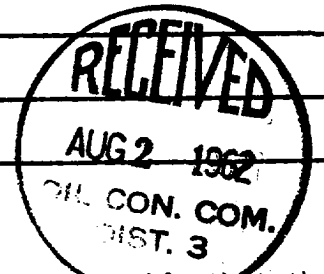
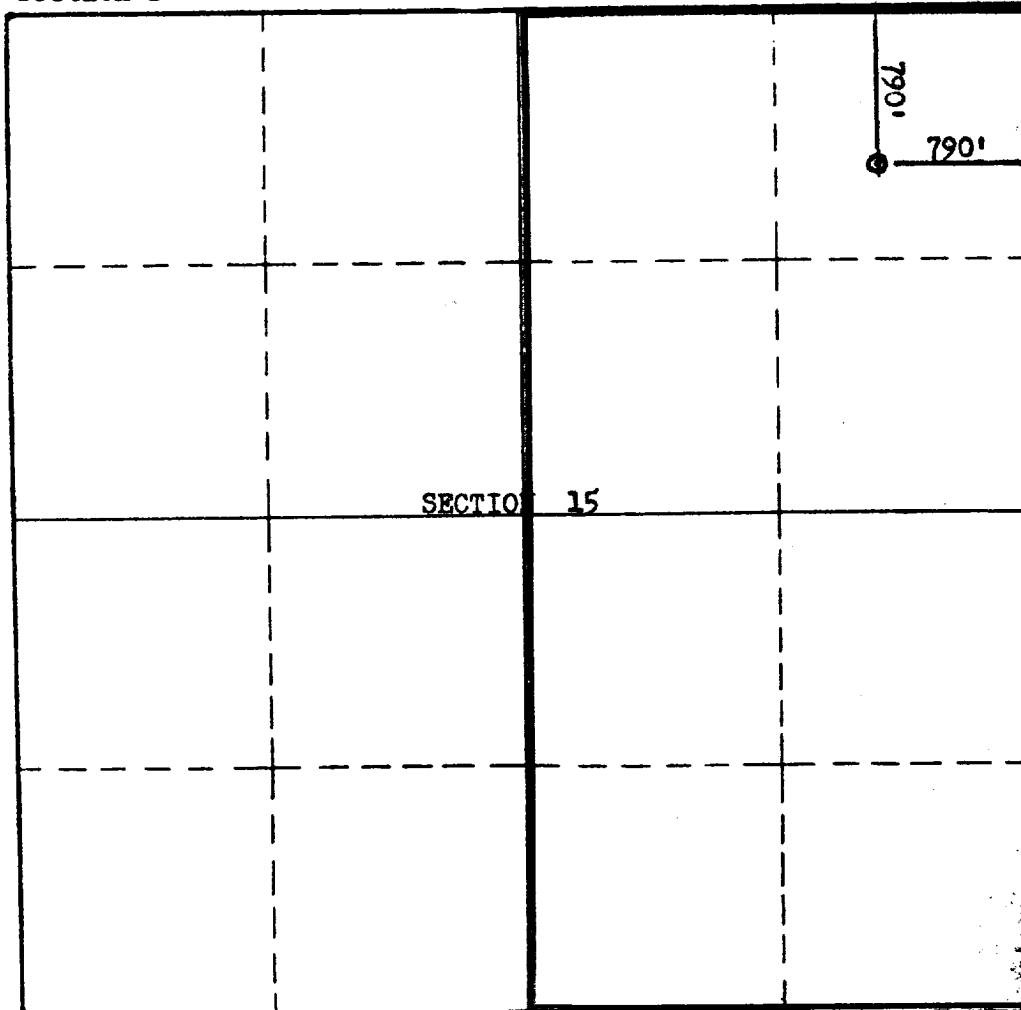

This is to certify that the information in Section A above is true and complete to the best of my knowledge and belief.

W. H. Hudson

(Operator)

J. B. Avant  
(Representative)

1126 Mercantile Securities Bldg.  
Dallas 1, Texas

Address

This is to certify that the well location shown on the plat in Section B was plotted from field notes of actual surveys made by me or under my supervision and that the same is true and correct to the best of my knowledge and belief.

Date Surveyed July 24, 1962

Stephen H. Kinney  
Registered Professional  
Engineer and/or Land Surveyor.

Certificate No. 803