

(SUBMIT IN TRIPLICATE)

UNITED STATES  
DEPARTMENT OF THE INTERIOR  
GEOLOGICAL SURVEY

Indian Agency \_\_\_\_\_

Allottee \_\_\_\_\_

Lease No. 14-22-403-2002

Tract 75

SUNDRY NOTICES AND REPORTS ON WELLS

NOTICE OF INTENTION TO DRILL	<input checked="" type="checkbox"/>	SUBSEQUENT REPORT OF WATER SHUT-OFF	<input type="checkbox"/>
NOTICE OF INTENTION TO CHANGE PLANS	<input type="checkbox"/>	SUBSEQUENT REPORT OF SHOOTING OR ACIDIZING	<input type="checkbox"/>
NOTICE OF INTENTION TO TEST WATER SHUT-OFF	<input type="checkbox"/>	SUBSEQUENT REPORT OF ALTERING CASING	<input type="checkbox"/>
NOTICE OF INTENTION TO REDRILL OR REPAIR WELL	<input type="checkbox"/>	SUBSEQUENT REPORT OF REDRILLING OR REPAIR	<input type="checkbox"/>
NOTICE OF INTENTION TO SHOOT OR ACIDIZE	<input type="checkbox"/>	SUBSEQUENT REPORT OF ABANDONMENT	<input type="checkbox"/>
NOTICE OF INTENTION TO PULL OR ALTER CASING	<input type="checkbox"/>	SUPPLEMENTARY WELL HISTORY	<input type="checkbox"/>
NOTICE OF INTENTION TO ABANDON WELL	<input type="checkbox"/>		

(INDICATE ABOVE BY CHECK MARK NATURE OF REPORT, NOTICE, OR OTHER DATA)

June 19, 1963

Well No. 2 is located 625 ft. from N line and 640 ft. from E line of sec. 14

14 (4 Sec. and Sec. No.) 27-E (Twp.) 15-W (Range) 107N (Meridian)  
Wildcat (Field) San Juan (County or Subdivision) New Mexico (State or Territory)

The elevation of the derrick floor above sea level is 9875 ft. (Est.)

DETAILS OF WORK

(State names of and expected depths to objective sands; show sizes, weights, and lengths of proposed casings; indicate mudlogging, cementing points, and all other important proposed work)

This is a 3000' Gallup test with Basal Gallup expected at 4000' and the Samaroo expected at 4900'.

8-5/8", 32# casing will be set at approximately 120 feet and cemented to surface. In the event of production, 4-1/2" 9.2# casing will be set through same to be completed.

I understand that this plan of work must receive approval in writing by the Geological Survey before operations may be commenced.

Company William O. Callaway

Address 1840 Western Federal Bldg.

Denver, 2, Colorado

By William O. Callaway

Title Operator

## NEW MEXICO OIL CONSERVATION COMMISSION

Well Location and Acreage Dedication Plat

Section A.

Date \_\_\_\_\_

Operator WILLIAM O. CALLAWAY Lease NAVAJO  
 Well No. 2 Unit Letter A Section 14 Township 27 NORTH Range 15 WEST NMPM  
 Located 625 Feet From the NORTH Line, 660 Feet From the EAST Line  
 County SAN JUAN G. L. Elevation 5860' Dedicated Acreage 40 Acres  
 Name of Producing Formation GALLUP Pool WILDCAT

1. Is the Operator the only owner in the dedicated acreage outlined on the plat below?  
 Yes X No \_\_\_\_\_
2. If the answer to question one is "no", have the interests of all the owners been consolidated by communitization agreement or otherwise? Yes \_\_\_\_\_ No \_\_\_\_\_. If answer is "yes", Type of Consolidation \_\_\_\_\_
3. If the answer to question two is "no", list all the owners and their respective interests below:

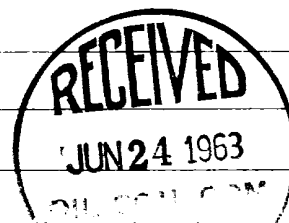
OwnerLand Description

Section B.

Note: All distances must be from outer boundaries of section.

This is to certify that the information in Section A above is true and complete to the best of my knowledge and belief.

WILLIAM O. CALLAWAY

(Operator)

(Representative)

1840 Western Federal Building

(Address)

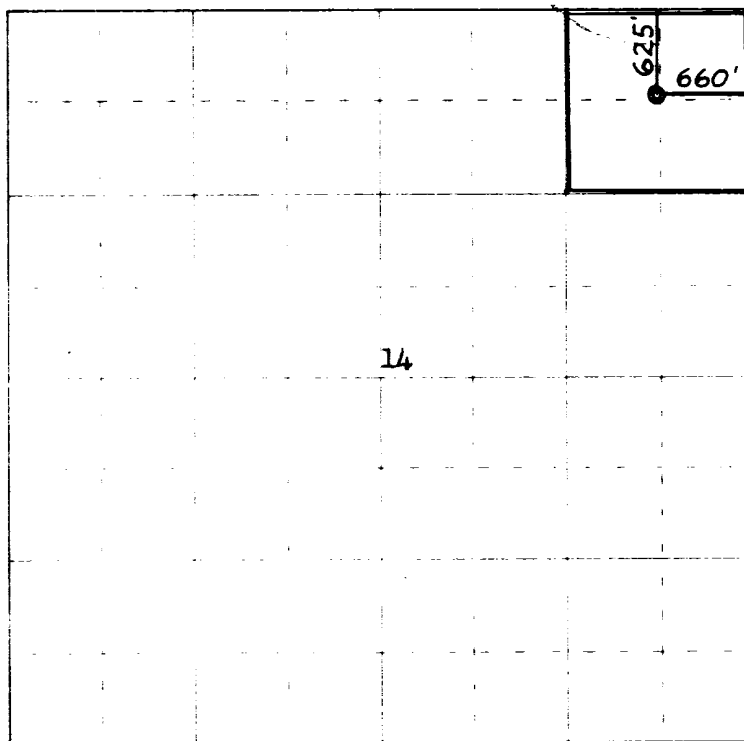
Denver 2, Colorado

0 330 660 990 1320 1650 1980 2310 2640 2000 1500 1000 500 0

Scale 4 inches equal 1 mile

This is to certify that the above plat was prepared from field notes of actual surveys made by me or under my supervision and that the same are true and correct to the best of my knowledge and belief.

Date Surveyed 19 June 1963

James P. Lease  
 Registered Professional Engineer and/or Land Surveyor  
 James P. Lease, N. Mex. Reg. No. 1463

Farmington, New Mexico