

Form 381a
(Feb. 1951)

(SUBMIT IN TRIPLICATE)

Land Office Santa Fe
Lease No. 078736
Unit 34 Section 10

UNITED STATES
DEPARTMENT OF THE INTERIOR
GEOLOGICAL SURVEY

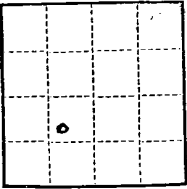

SUNDRY NOTICES AND REPORTS ON WELLS

NOTICE OF INTENTION TO DRILL	<input checked="" type="checkbox"/>	SUBSEQUENT REPORT OF WATER SHUT-OFF	
NOTICE OF INTENTION TO CHANGE PLANS		SUBSEQUENT REPORT OF SHOOTING OR ACIDIZING	
NOTICE OF INTENTION TO TEST WATER SHUT-OFF		SUBSEQUENT REPORT OF ALTERING CASING	DEC 4 1953
NOTICE OF INTENTION TO RE-DRILL OR REPAIR WELL		SUBSEQUENT REPORT OF RE-DRILLING OR REPAIR	
NOTICE OF INTENTION TO SHOOT OR ACIDIZE		SUBSEQUENT REPORT OF ABANDONMENT	U. S. GEOLOGICAL SURVEY FARMINGTON, N. M.
NOTICE OF INTENTION TO PULL OR ALTER CASING		SUPPLEMENTARY WELL HISTORY	
NOTICE OF INTENTION TO ABANDON WELL			

(INDICATE ABOVE BY CHECK MARK NATURE OF REPORT, NOTICE, OR OTHER DATA)

December 3, 1953

Well No. 3 ~~is~~ located 1650 ft. from S line and 1650 ft. from W line of sec. 10

34 section 10
(1/4 Sec. and Sec. No.)

27N
(Twp.)

12W
(Range)

119K
(Meridian)

New Mexico
(Field)

Santa Fe
(County or Subdivision)

New Mexico
(State or Territory)

The elevation of the derrick floor above sea level is _____ ft.

DETAILS OF WORK

(State names of and expected depths to objective sands; show sizes, weights, and lengths of proposed casings; indicate mudding jobs, cementing points, and all other important proposed work)

Approximately 100' of 10-3/4" surface casing will be used and cement circulated and approximately 1500' of 7" casing will be set on top of the Pictured Cliffs and cemented with 100 sacks. Rotary tools will be used to the casing point and the well will be drilled in with cable tools. The gas zone will be shot with a approximately 200 qts. of SNG to estimated total depth of 1600'.

I understand that this plan of work must receive approval in writing by the Geological Survey before operations may be commenced.

Company Danube Oil Company

Address 213 First National Bank Building
Amarillo, Texas

By H. D. Thompson

Title Partner

Company..... Danube Oil Company.....

Lease..... Well No.....

Sec. 10....., T. 27 N....., R. 12 W., N.M.P.M.

Location..... 1650' from the South line and 1650' from the West line.

Elevation..... 5845 Ungraded ground.....

RECEIVED

DEC 4 1953
U.S. GEOLOGICAL SURVEY
SARASOTA, FLA.

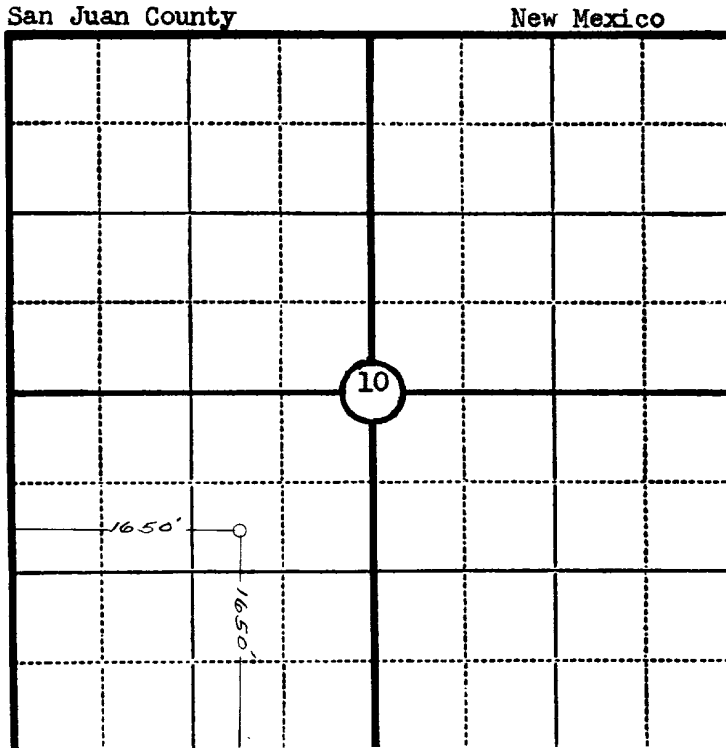

Scale—4 inches equal 1 mile.

This is to certify that the above plat was prepared from field notes of actual surveys made by me or under my supervision and that the same are true and correct to the best of my knowledge and belief.

Ernest V. Echohawk

Seal:

Registered Professional
Engineer and Land Surveyor.

Ernest V. Echohawk
N. Mex. Reg. No. 1545

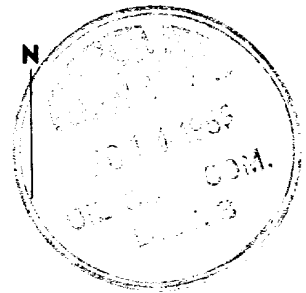

Surveyed December 3....., 19.53..