

(SUBMIT IN TRIPLICATE)

UNITED STATES
DEPARTMENT OF THE INTERIOR
GEOLOGICAL SURVEY

Budget Bureau 42-R358.2
Approval expires 12-31-52.

Land Office **Santa Fe**

Lease No. **7-49-Ind-846**

Unit **Charley - Pah**

SUNDRY NOTICES AND REPORTS ON WELLS

NOTICE OF INTENTION TO DRILL.....	<input checked="" type="checkbox"/>	SUBSEQUENT REPORT OF WATER SHUT-OFF.....
NOTICE OF INTENTION TO CHANGE PLANS.....		SUBSEQUENT REPORT OF SHOOTING OR ACIDIZING.....
NOTICE OF INTENTION TO TEST WATER SHUT-OFF.....		SUBSEQUENT REPORT OF ALTERING CASING.....
NOTICE OF INTENTION TO RE-DRILL OR REPAIR WELL.....		SUBSEQUENT REPORT OF RE-DRILLING OR REPAIR.....
NOTICE OF INTENTION TO SHOOT OR ACIDIZE.....		SUBSEQUENT REPORT OF ABANDONMENT.....
NOTICE OF INTENTION TO PULL OR ALTER CASING.....		SUPPLEMENTARY WELL HISTORY.....
NOTICE OF INTENTION TO ABANDON WELL.....		

(INDICATE ABOVE BY CHECK MARK NATURE OF REPORT, NOTICE, OR OTHER DATA)

September 24, 1953

Well No. **1** is located **1700'** ft. from **N** line and **1750'** ft. from **W** line of sec. **12**

NE/4 12 (1/4 Sec. and Sec. No.) **27N** (Twp.) **9E** (Range) **N.M.P.M.** (Meridian)
Falcher - Ints (Field) **San Juan** (County or Subdivision) **New Mexico** (State or Territory)

The elevation of the derrick floor above sea level is **5973** ft.

DETAILS OF WORK

(State names of and expected depths to objective sands; show sizes, weights, and lengths of proposed casings; indicate mudlogging jobs, cementing points, and all other important proposed work)

It is our intention to drill well #1 approximately 2200' to test the fractured Cliff formation. Casing program is as follows: 130' of 10 3/4" casing to be cemented with 150 sacks regular cement. 2100' of 7" OD casing to be cemented with 150 sacks regular cement. The designated drilling unit is the NE/4 of Section 12.

RECEIVED

OCT 6 1953

U. S. GEOLOGICAL SURVEY

FARMINGTON, N.M.

I understand that this plan of work must receive approval in writing by the Geological Survey before operations.

Company **Skelly Oil Co.**

Address **Box 426,**

Farmington, New Mexico

By **J. E. Cooper**
Title **District Foreman**

Company Skelly Oil Company

Lease Charley-Pah Well No. 2

Sec. 12, T. 27 N., R. 9 W., N.M.P.M.

Location 1700' from the North line and 1750' from
the West line.

San Juan County

New Mexico

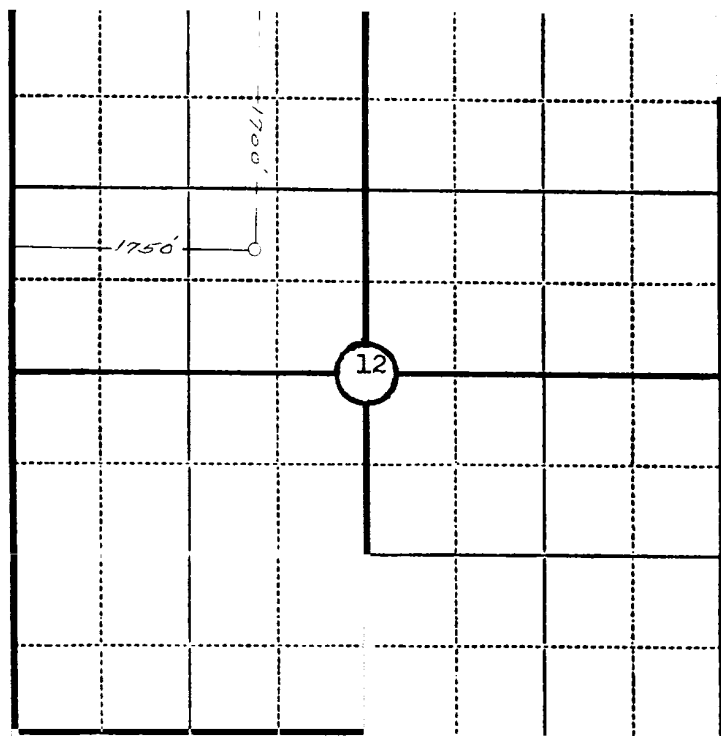

N

Scale—4 inches equal 1 mile.

This is to certify that the above plat was prepared from field notes of actual surveys made by me or under my supervision and that the same are true and correct to the best of my knowledge and belief.

Seal:

Registered Professional
Engineer and Land Surveyor.

Charles J. Finklea
N. Mex. Reg. No. 1302

Surveyed September 22, 19 53