

Form 9-331a  
(Feb. 1951)

			X

(SUBMIT IN TRIPLICATE)

UNITED STATES  
DEPARTMENT OF THE INTERIOR  
GEOLOGICAL SURVEY

Budget Bureau 42-R358.2.  
Approval expires 12-31-52.  
Land Office Santa Fe  
Lease No. 077875

Drs. Unit

RECEIVED  
MAR 18 1953

U. S. GEOLOGICAL SURVEY  
SARASOTA, N. M.

## SUNDRY NOTICES AND REPORTS ON WELLS

NOTICE OF INTENTION TO DRILL.....	X	SUBSEQUENT REPORT OF WATER SHUT-OFF.....
NOTICE OF INTENTION TO CHANGE PLANS.....		SUBSEQUENT REPORT OF SHOOTING OR ACIDIZING.....
NOTICE OF INTENTION TO TEST WATER SHUT-OFF.....		SUBSEQUENT REPORT OF ALTERING CASING.....
NOTICE OF INTENTION TO RE-DRILL OR REPAIR WELL.....		SUBSEQUENT REPORT OF RE-DRILLING OR REPAIR.....
NOTICE OF INTENTION TO SHOOT OR ACIDIZE.....		SUBSEQUENT REPORT OF ABANDONMENT.....
NOTICE OF INTENTION TO PULL OR ALTER CASING.....		SUPPLEMENTARY WELL HISTORY.....
NOTICE OF INTENTION TO ABANDON WELL.....		

(INDICATE ABOVE BY CHECK MARK NATURE OF REPORT, NOTICE, OR OTHER DATA)

March 18, 1953

19

Turner-Pipkin  
Well No. 2 is located 1650 ft. from [N] line and 890 ft. from [E] line of sec. 7

NE 1/4 Sec. 7

(1/4 Sec. and Sec. No.)

T 27N E 10W

(Twp.)

(Range)

N.M.P.M.

(Meridian)

Fulcher-Kutz Est.

(Field)

San Juan County

(County or Subdivision)

New Mexico

(State or Territory)

The elevation of the derrick floor above sea level is 5981 ft.

## DETAILS OF WORK

(State names of and expected depths to objective sands; show sizes, weights, and lengths of proposed casings; indicate mudding jobs, cementing points, and all other important proposed work)

I understand that this plan of work must receive approval in writing by the Geological Survey before operations may be commenced.

Company

Address

By

Title

100-11-10

MAR 13 1953

GEOLOGICAL SURVEY  
MOSCOW, N. M.

Company.....J. Glenn Turner.....

Turner-Pirkin

Lease.....S.E.C77875.....Well No.....2.....

Sec.....7....., T.....27 N....., R.....10 W., N.M.P.M..

Location.....1650' from the North line and 890' from  
the East line.

Elevation.....5971 Ungraded ground.....

San Juan County

New Mexico

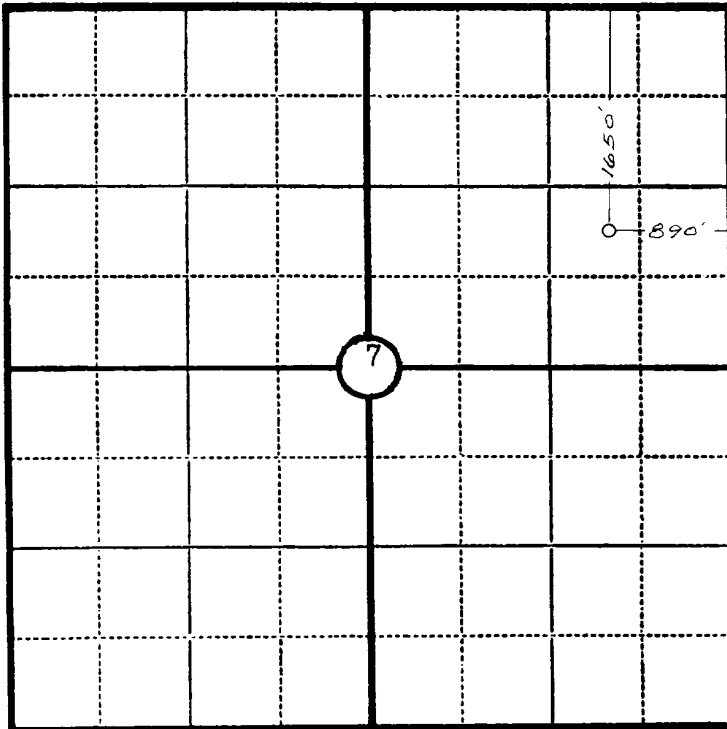

N

Scale—4 inches equal 1 mile.

This is to certify that the above plat was prepared from field notes of actual surveys made by me or under my supervision and that the same are true and correct to the best of my knowledge and belief.

Seal:

*James P. Leese*  
Registered Professional  
Engineer and Land Surveyor.

James P. Leese  
N. Mex. Reg. No. 1463

Surveyed.....March 13....., 19..53..