

Santa Fe

(SUBMIT IN TRIPLICATE)

Land Office **070050**

Lease No. _____

Unit **N 1/2 Sec. 3**

UNITED STATES
DEPARTMENT OF THE INTERIOR
GEOLOGICAL SURVEY

SUNDRY NOTICES AND REPORTS ON WELLS

NOTICE OF INTENTION TO DRILL.....	SUBSEQUENT REPORT OF WATER SHUT-OFF.....
NOTICE OF INTENTION TO CHANGE PLANS.....	SUBSEQUENT REPORT OF SHOOTING OR ACIDIZING.....
NOTICE OF INTENTION TO TEST WATER SHUT-OFF.....	SUBSEQUENT REPORT OF ALTERING CASING.....
NOTICE OF INTENTION TO RE-DRILL OR REPAIR WELL.....	SUBSEQUENT REPORT OF REDRILLING OR REPAIR.....
NOTICE OF INTENTION TO SHOOT OR ACIDIZE.....	SUBSEQUENT REPORT OF ABANDONMENT.....
NOTICE OF INTENTION TO PULL OR ALTER CASING.....	SUPPLEMENTARY WELL HISTORY.....
NOTICE OF INTENTION TO ABANDON WELL.....	

(INDICATE ABOVE BY CHECK MARK NATURE OF REPORT, NOTICE, OR OTHER DATA)

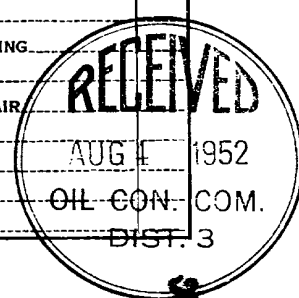

Farmington, N. M. July 29

Well No. **1** is located **640** ft. from **N** line and **640** ft. from **E** line of sec. **3**
SW 1/4 of Sec. 3 **27-N** **2-W** **RMPN**
 (1/4 Sec. and Sec. No.) (Twp.) (Range) (Meridian)
FULCHER-KUTZ (EXT) **San Juan** **New Mexico**
 (Field) (County or Subdivision) (State or Territory)

Will furnish when made.

The elevation of the derrick floor above sea level is _____ ft.

DETAILS OF WORK

(State names of and expected depths to objective sands; show sizes, weights, and lengths of proposed casings; indicate mudding jobs, cementing points, and all other important proposed work)

Propose to drill with rotary tools to the top of Pictured Cliffs Formation expected at approx. 2500' below surface; complete drilling with cable tools to bottom of Pictured Cliffs Formation; and shoot with solidified nitro glycerin.

Casing program: approx. 100' of 8 1/8" OD 24 1/2 Lbs/sq ft casing cement to surface. 5 1/2" OD 12 1/2 Lbs/sq ft casing to be set on top of Pictured Cliffs Formation, cement with 150 sacks regular cement, 1" tubing to be set to within 50' of Total depth for production.

I understand that this plan of work must receive approval in writing by the Geological Survey before operations may be commenced.

Company **Byrd Oil Corporation**

Address **1405 Tower Petroleum Building**

Dallas 1, Texas

By **James Woodard**
Agent, Farmington

RECEIVED

JUL 29 1952

U. S. GEOLOGICAL SURVEY
FARMINGTON, N. M.

Company Byrd Oil Corporation

Lease _____ Well No. Christine Hughes # 1

Sec. 3 T. 27 N., R. 9 W., N.M.P.M.

Location 660' from the South line and 660' from the West line.

San Juan County

New Mexico

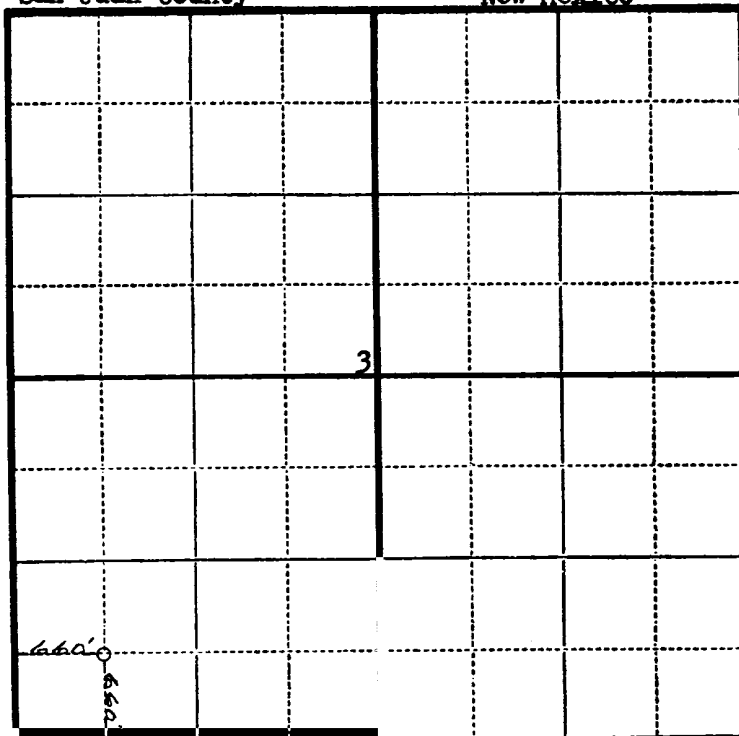

N

Scale—4 inches equals 1 mile.

This is to certify that the above plat was prepared from field notes of actual surveys made by me or under my supervision and that the same are true and correct to the best of my knowledge and belief.

Seal:

James P. Leese
Registered Professional
Engineer and Land Surveyor.

James P. Leese
N. Mex. Reg. No. 1463

Surveyed July 19, 19 52