

(SUBMIT IN TRIPLICATE)

UNITED STATES
DEPARTMENT OF THE INTERIOR
GEOLOGICAL SURVEYLand Office Santa Fe
Lease No. 080112
Unit Riddle

SUNDRY NOTICES AND REPORTS ON WELLS

NOTICE OF INTENTION TO DRILL.....	<input checked="" type="checkbox"/>	SUBSEQUENT REPORT OF WATER SHUT-OFF.....
NOTICE OF INTENTION TO CHANGE PLANS.....	<input type="checkbox"/>	SUBSEQUENT REPORT OF SHOOTING OR ACIDIZING.....
NOTICE OF INTENTION TO TEST WATER SHUT-OFF.....	<input type="checkbox"/>	SUBSEQUENT REPORT OF ALTERING CASING.....
NOTICE OF INTENTION TO RE-DRILL OR REPAIR WELL.....	<input type="checkbox"/>	SUBSEQUENT REPORT OF RE-DRILLING OR REPAIR.....
NOTICE OF INTENTION TO SHOOT OR ACIDIZE.....	<input type="checkbox"/>	SUBSEQUENT REPORT OF ABANDONMENT.....
NOTICE OF INTENTION TO PULL OR ALTER CASING.....	<input type="checkbox"/>	SUPPLEMENTARY WELL HISTORY.....
NOTICE OF INTENTION TO ABANDON WELL.....	<input type="checkbox"/>	

(INDICATE ABOVE BY CHECK MARK NATURE OF REPORT, NOTICE, OR OTHER DATA)

April 18, 1957

Well No. 3-F(PM) is located 1150 ft. from N line and 113.3 ft. from E line of sec. 20
NE Section 20 28N 3W N.M.P.M.
($\frac{1}{4}$ Sec. and Sec. No.) (Twp.) (Range) (Meridian)
San Juan Co. Est. & Blanco San Juan New Mexico
(Field) (County or Subdivision) (State or Territory)

The elevation of the derrick floor above sea level is 5996 ft.

DETAILS OF WORK

(State names of and expected depths to objective sands; show sizes, weights, and lengths of proposed casings; indicate mudding jobs, cementing points, and all other important proposed work)

It is intended to drill & dual complete a well in the Pictured Cliffs formation & Mesa Verde formation. Mud circulation will be used thru the Pictured Cliffs formation & set intermediate casing. Gas circulation will be used thru the Mesa Verde & a production liner will be set. Possible productive intervals will be perforated & fractured. Estimated Total Depth 4865'.

Casing Program:

10-3/4" at 170' with 125 sacks cement circulated to the surface.

7-5/8" at 2475' with 250 sacks cement.

5-1/2" liner at 4865' with 300 sacks cement.

The N/2 of Section 20 is dedicated to the Mesa Verde.

The NE/4 of Section 20 is dedicated to the Pictured Cliffs.

N/2 & NE/4 SF 080112.

I understand that this plan of work must receive approval in writing by the Geological Survey before operation may be commenced.

Company El Paso Natural Gas CompanyAddress Box 997Farmington, New MexicoBy ORIGINAL SIGNED E. S. OBERLYTitle Petroleum Engineer



NEW MEX.CO
OIL CONSERVATION COMMISSION

WELL LOCATION AND/OR GAS PROGRATION PLAT

APRIL 11, 1957

EL PASO NATURAL GAS COMPANY

RIDDLE

SF 080112

3-F (PM)

20

28 N

8 W

1150

NORTH

1131.3

EAST

SAN JUAN

5986

P.C. & M.V.

BLANCO MV

160 AC PC
320 AC MV
(1919 PLAT)

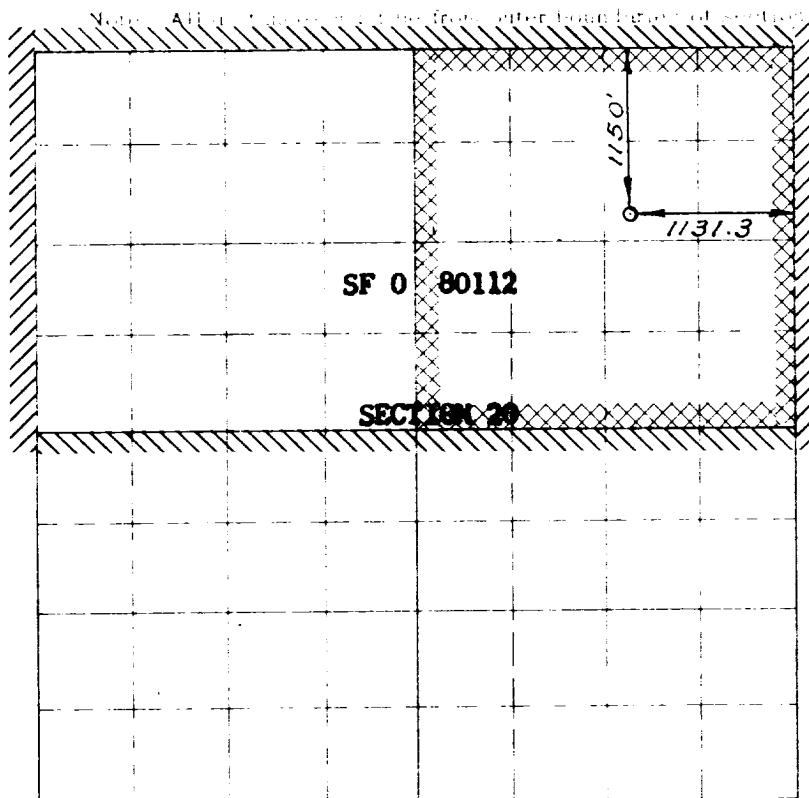

Scale 1 inch equals 1 mile

NOTE

This section of
form is to be used
for gas wells only

This is to certify that the above plat was prepared from
field notes of actual surveys made by me or under my
observation and that the same are true and correct to the
best of my knowledge and belief.

Date surveyed MARCH 13, 1957

E. O. Oberly
Registered Professional Engineer and/or Land Surveyor

1. Is this well a Dual Comp.

Yes X No

2. If the answer to Question 1
is yes, are there any other fully
completed wells within the
dedicated acreage.

Yes No X

OR.GINAL SIGNED E.S.OBERLY

Name

Position Petroleum Engineer

Representing El Paso Natural Gas

Address Box 997, Farmington, N.M.

(Seal)

Farmington, New Mexico