

(SUBMIT IN TRIPLICATE)

UNITED STATES  
DEPARTMENT OF THE INTERIOR  
GEOLOGICAL SURVEY

Land Office Santa Fe  
Lease No. 078499  
Unit Tapp

RECEIVED  
FEB 4 1958  
U.S. GEOLOGICAL SURVEY

SUNDRY NOTICES AND REPORTS ON WELLS

NOTICE OF INTENTION TO DRILL.....	<input checked="" type="checkbox"/>	SUBSEQUENT REPORT OF WATER SHUT-OFF.....	
NOTICE OF INTENTION TO CHANGE PLANS.....		SUBSEQUENT REPORT OF SHOOTING OR ACIDIZING.....	
NOTICE OF INTENTION TO TEST WATER SHUT-OFF.....		SUBSEQUENT REPORT OF ALTERING CASING.....	
NOTICE OF INTENTION TO RE-DRILL OR REPAIR WELL.....		SUBSEQUENT REPORT OF RE-DRILLING OR REPAIR.....	
NOTICE OF INTENTION TO SHOOT OR ACIDIZE.....		SUBSEQUENT REPORT OF ABANDONMENT.....	
NOTICE OF INTENTION TO PULL OR ALTER CASING.....		SUPPLEMENTARY WELL HISTORY.....	
NOTICE OF INTENTION TO ABANDON WELL.....			

(INDICATE ABOVE BY CHECK MARK NATURE OF REPORT, NOTICE, OR OTHER DATA)

February 4, 1958

Well No. 4(FM) is located 1695 ft. from S line and 1000 ft. from W line of SW Sec. 16  
(1/4 Sec. and Sec. No.) (Twp.) (Range) (Meridian)  
Blanco NV - Astec P. C. San Juan New Mexico  
(Field) (County or Subdivision) (State or Territory)

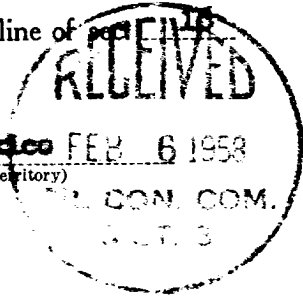

The elevation of the derrick floor above sea level is 5853 ft.

DETAILS OF WORK

(State names of and expected depths to objective sands; show sizes, weights, and lengths of proposed casings; indicate mudding jobs, cementing points, and all other important proposed work)

It is intended to drill & dual complete a well in the Pictured Cliffs formation & Mesa Verde formation. Mud circulation will be used thru the Pictured Cliffs formation & set intermediate casing. Gas circulation will be used thru the Mesa Verde & a production liner will be set. Possible productive intervals will be perforated & fractured. Estimated Total Depth 4725'.

Casing Program:

- 10 3/4" at 170' with 150 sacks cement circulated to the surface.
- 7 5/8" at 2421' with 250 sacks cement.
- 5 1/2" liner at 4225' with 300 sacks cement.

The W/2 of Section 16 is dedicated to the Mesa Verde.  
The SW/4 of Section 16 is dedicated to the Pictured Cliffs.

W/2: 078499

I understand that this plan of work must receive approval in writing by the Geological Survey before operations may be commenced.

Company El Paso Natural Gas Company  
Address Box 997  
Farmington, New Mexico  
By Original Signed D. C. Johnston  
Title Petroleum Engineer

Well Location and Acreage Dedication Plat

Section A.

Date **JANUARY 31, 1958**

Operator **EL PASO NATURAL GAS COMPANY** Lease **TAPP** **SF 078499**  
 Well No. **4 (PM)** Unit Letter **L** Section **16** Township **28 N** Range **8 W** NMPM  
 Located **1696** Feet From **SOUTH** Line **1000** Feet From **WEST** Line  
 County **SAN JUAN** G. L. Elevation **5843** Dedicated Acreage **320 & 160** Acres  
 Name of Producing Formation **MESA VERDE & PICTURED CLIFF** Pool **BLANCO MV AND AZTEC FC EXT.**

1. Is the Operator the only owner in the dedicated acreage outlined on the plat below?  
 Yes  No
2. If the answer to question one is "no", have the interests of all the owners been consolidated by communitization agreement or otherwise? Yes  No  If answer is "yes", Type of Consolidation:
3. If the answer to question two is "no", list all the owners and their respective interests below:

Owner	Land Description
-------	------------------

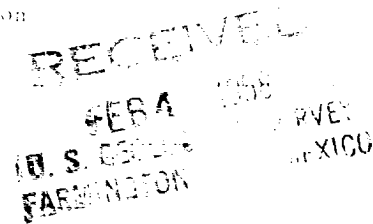

Section B.

This is to certify that the information in Section A above is true and complete to the best of my knowledge and belief.

**El Paso Natural Gas Company**  
 (Operator)  
**Original Signed D. C. Johnston**  
 (Representative)  
**Box 997**  
 (Address)  
**Farmington, New Mexico**

**NOTE: THIS PLAT IS RE-ISSUED TO SHOW CORRECTED ELEVATION. 2 3 58**

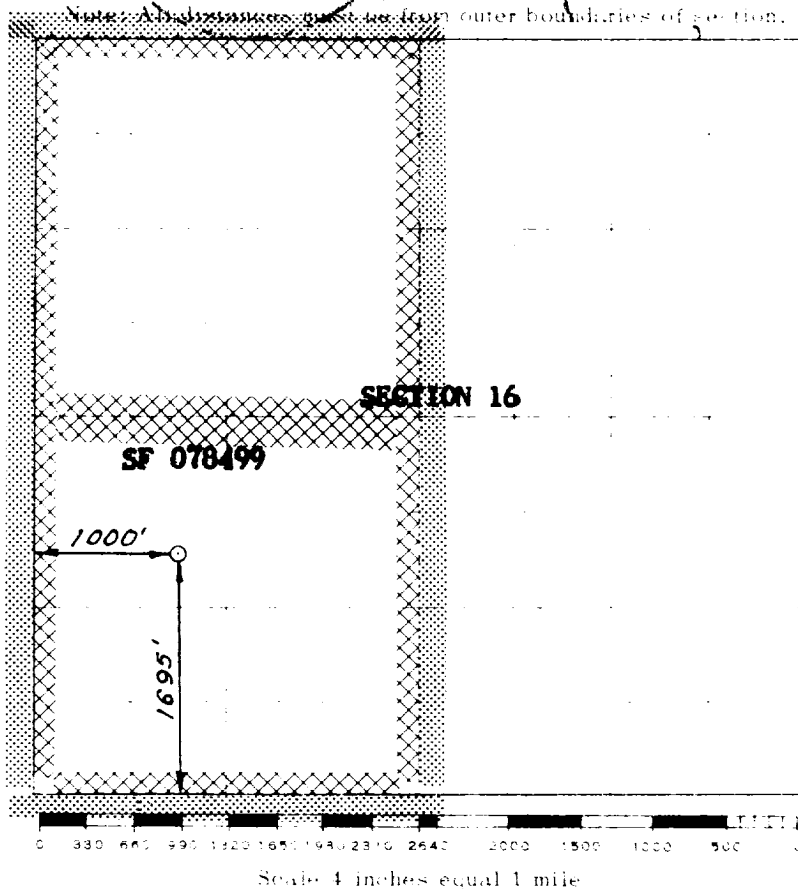

This is to certify that the above plat was prepared from field notes of actual surveys made by me or under my supervision and that the same are true and correct to the best of my knowledge and belief.

(Seal)

Farmington, New Mexico

Date Surveyed **SEPTEMBER 22, 1957**

*David O. Kilmer*  
 Registered Professional Engineer and or Land Surveyor