

District I  
P.O. Box 1980 Hobbs, NM

District II  
P.O. Drawer 100, Artesia, NM 88221

District III  
1000 Rio Brazos Rd, Aztec, NM 87410

State of New Mexico  
Energy, Minerals and Natural Resources Department

SUBMIT 1 COPY TO  
APPROPRIATE  
DISTRICT OFFICE  
AND 1 COPY TO  
SANTA FE OFFICE

OIL CONSERVATION DIVISION

2040 South Pacheco Street  
Santa Fe, New Mexico 87505

FEB 0 8 1999

**PIT REMEDIATION AND CLOSURE REPORT**

**RECEIVED**  
NOV 12 1998

**OIL CON. DIV.**  
**DIST. 3**

*Approved*

<b>Operator:</b> PNM Gas Services ( Williams )		<b>Telephone:</b> 324-3764	
<b>Address:</b> 603 W. Elm Street Farmington, NM 87401			
<b>Facility or Well Name:</b> Navajo B #6 Drip			
<b>Location:</b>	Unit <u>N</u>	Sec <u>19</u>	T <u>27 N</u> R <u>8 W</u> County <u>San Juan</u>
<b>Pit Type:</b>	Separator <input type="checkbox"/>	Dehydrator <input type="checkbox"/>	Other <u>Manual drip blowdown</u>
<b>Land Type:</b>	BLM <input type="checkbox"/>	State <input type="checkbox"/>	Fee <input type="checkbox"/> Other <u>Navajo</u>
<b>Pit Location:</b>	Pit dimensions: length <u>15</u> ' width <u>15</u> ' depth <u>3</u> '		
(Attach diagram)	Reference: wellhead <input checked="" type="checkbox"/> other <input type="checkbox"/>		
	Footage from reference: <u>255'</u>		
	Direction from reference: <u>50</u> Degrees <input type="checkbox"/> East <input type="checkbox"/> North <input type="checkbox"/> of <input checked="" type="checkbox"/> West <input checked="" type="checkbox"/> South <input checked="" type="checkbox"/>		
<b>Depth to Ground Water:</b>	Less than 50 feet (20 points) 50 feet to 99 feet (10 points) Greater than 100 feet (0 points) <u>10</u>		
(Vertical distance from contaminants to seasonal high water elevation of ground water)			
<b>Wellhead Protection Area:</b>	Yes (20 points) No (0 points) <u>0</u>		
(Less than 200 feet from a private domestic water source, or, less than 1,000 feet from all other water sources)			
<b>Distance to Surface Water:</b>	Less than 200 feet (20 points) 200 feet to 1,000 feet (10 points) Greater than 1,000 feet (0 points) <u>0</u>		
(Horizontal distance to perennial lakes, ponds, rivers, streams, creeks, irrigation canals and ditches)			
<b>RANKING SCORE (TOTAL POINTS) :</b>			<u>10</u>

Date Remediation Started: \_\_\_\_\_ Date Completed: \_\_\_\_\_

Remediation Method: Excavation \_\_\_\_\_ Approx. Cubic Yard \_\_\_\_\_  
(Check all appropriate sections) Landfarmed \_\_\_\_\_ Amount Landfarmed (cubic yds) \_\_\_\_\_  
Other \_\_\_\_\_

Remediation Location: Onsite \_\_\_\_\_ Offsite \_\_\_\_\_  
(i.e., landfarmed onsite, name and location of offsite facility)

Backfill Material Location: \_\_\_\_\_

## General Description of Remedial Action:

No remedial action necessary. Lab results below OCD/BLM standards.

RECEIVED  
NOV 12 1998  
OIL CON. DIV.  
DIST. 3

Ground Water Encountered: No ☒ Yes ☐ Depth \_\_\_\_\_Final Pit Closure  
Sampling:Sample Location 5 pt composite-4 side walls and center of pit bottom(if multiple samples, attach  
sample result and diagram of  
sample locations and depths.)Sample depth 7'Sample date 6/17/98 Sample time 3:45:00 PM

## Sample Results

Benzene (ppm) < 0.0010Total BTEX (ppm) < 0.0070Field headspace (ppm) N/DTPH (ppm) < 25.00 Method 8015AVertical Extent (ft) \_\_\_\_\_ Risk Analysis form attached Yes ☐ No ☒Ground Water Sample: Yes ☐ No ☒ (If yes, see attached Groundwater Site Summary Report)

I HEREBY CERTIFY THAT THE INFORMATION ABOVE IS TRUE AND COMPLETE TO THE BEST OF MY KNOWLEDGE AND MY BELIEF

DATE **October 29, 1998**

SIGNATURE

Maureen GannonPRINTED NAME **Maureen Gannon**  
AND TITLE **Project Manager**

Navajo #B6 Drip  
Williams  
Lease # I-149-IND8468  
(N)-19-27N-8W  
San Juan County

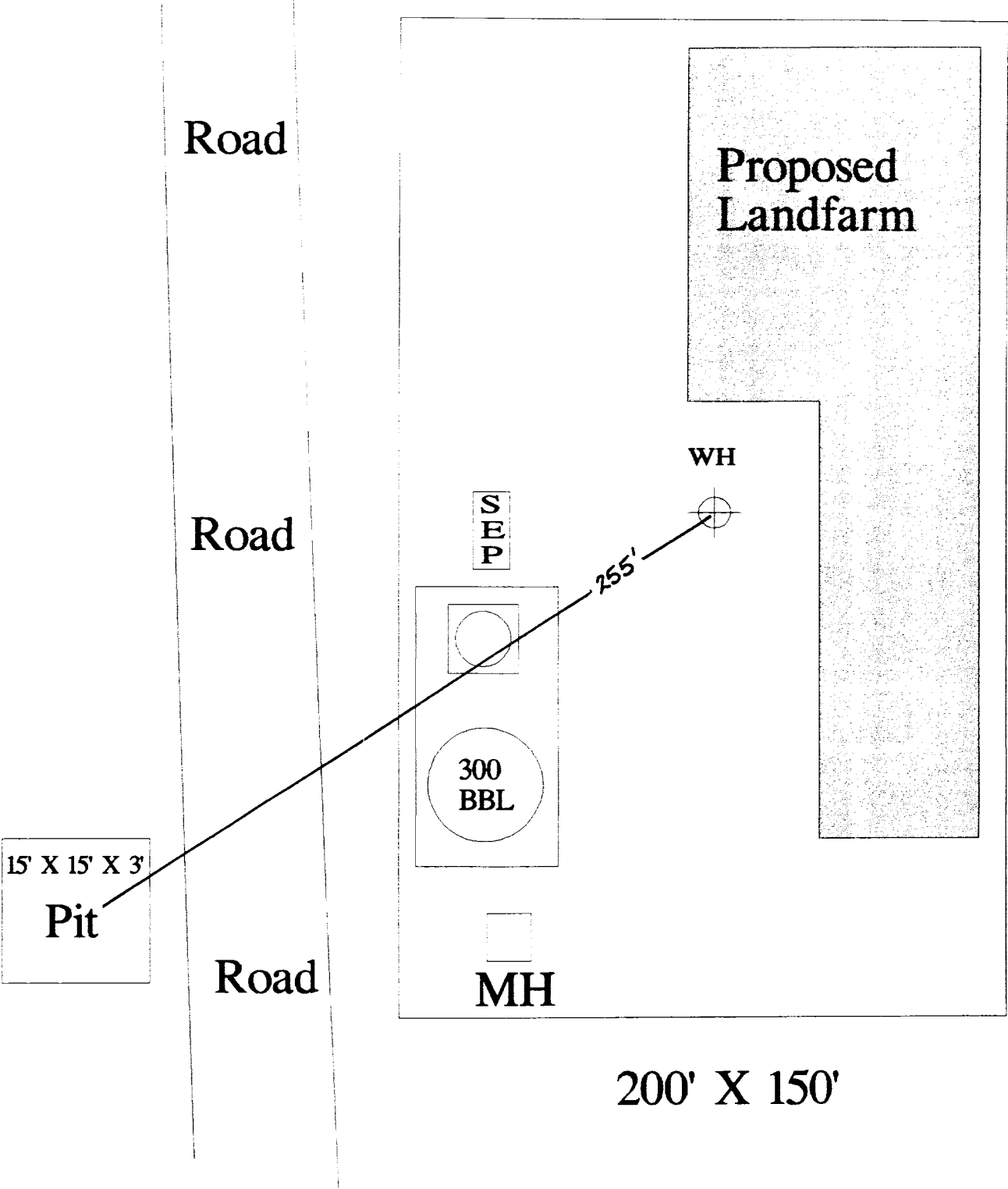

OFF: (505) 325-5667

**ON SITE**

LAB: (505) 325-1556

**TECHNOLOGIES, LTD.**

**On Site Technologies, LTD.**

**Date:** 24-Jun-98

---

**CLIENT:** PNM - Public Service Company of NM

**Project:** Navajo B6 Drip

**Lab Order:** 9806073

**CASE NARRATIVE**

---

Samples were analyzed using the methods outlined in the following references:

Test Methods for Evaluating Solid Waste, Physical/Chemical Methods, SW846, 3rd Edition

All method blanks, laboratory spikes, and/or matrix spikes met quality assurance objectives.

OFF: (505) 325-5667



LAB: (505) 325-1556

## ANALYTICAL REPORT

Date: 24-Jun-98

**Client:** PNM - Public Service Company of NM  
**Work Order:** 9806073  
**Lab ID:** 9806073-01A     **Matrix:** SOIL  
**Project:** Navajo B6 Drip

**Client Sample Info:** Navajo B6 Drip  
**Client Sample ID:** 9806171545; Composite  
**Collection Date:** 6/17/98 3:45:00 PM  
**COC Record:** 5239

Parameter	Result	PQL	Qual	Units	DF	Date Analyzed
<b>DIESEL RANGE ORGANICS</b>		<b>SW8015</b>				<b>Analyst: DC</b>
T/R Hydrocarbons: C10-C28	ND	25		mg/Kg	1	6/24/98
<b>BTEX</b>		<b>SW8020A</b>				<b>Analyst: HR</b>
Benzene	ND	1		µg/Kg	1	6/19/98
Toluene	ND	2		µg/Kg	1	6/19/98
Ethylbenzene	ND	1		µg/Kg	1	6/19/98
m,p-Xylene	ND	2		µg/Kg	1	6/19/98
o-Xylene	ND	1		µg/Kg	1	6/19/98

**Qualifiers:** PQL - Practical Quantitation Limit  
ND - Not Detected at Practical Quantitation Limit  
J - Analyte detected below Practical Quantitation Limit  
B - Analyte detected in the associated Method Blank

S - Spike Recovery outside accepted recovery limits  
R - RPD outside accepted recovery limits  
E - Value above quantitation range  
Surr: - Surrogate

1 of 1

P.O. BOX 2606 • FARMINGTON, NM 87499