

District I  
P.O. Box 1980 Hobbs  
**DEPUTY OIL & GAS INSPECTOR**  
District III  
P.O. Drawer DD Artesia, NM 88221  
District III  
1000 Rio Brazos Rd, Aztec, NM 87410

State of New Mexico  
Energy, Minerals and Natural Resources Department

SUBMIT 1 COPY TO  
APPROPRIATE  
DISTRICT OFFICE  
AND 1 COPY TO  
SANTA FE OFFICE

OIL CONSERVATION DIVISION

2040 South Pacheco Street  
Santa Fe, New Mexico 87505

RECEIVED  
JUL 31 1998  
OIL CON. DIV.  
DIST. 3

PIT REMEDIATION AND CLOSURE REPORT

Operator:	PNM Gas Services ( Cross Timbers )			Telephone:	324-3764		
Address:	603 W. Elm Street Farmington, NM 87401						
Facility or Well Name:	Johnson Com B #1						
Location:	Unit	H	Sec	21	T	27 N	R 10 W County San Juan
Pit Type:	Separator	<input checked="" type="checkbox"/>	Dehydrator	<input type="checkbox"/>	Other		
Land Type:	BLM	<input checked="" type="checkbox"/>	State	<input type="checkbox"/>	Fee	<input type="checkbox"/>	Other No
Pit Location:	Pit dimensions:	length	20	width	20	depth	3
(Attach diagram)	Reference:	wellhead	<input checked="" type="checkbox"/>	other			
	Footage from reference:	180'					
	Direction from reference:	5	Degrees		East	North	<input checked="" type="checkbox"/>
					West	South	
Depth to Ground Water:	Less than 50 feet (20 points)						
	50 feet to 99 feet (10 points)						
(Vertical distance from contaminants to seasonal high water elevation of ground water)	Greater than 100 feet (0 points)			20			
Wellhead Protection Area:	Yes (20 points)						
(Less than 200 feet from a private domestic water source, or, less than 1,000 feet from all other water sources)	No (0 points)			0			
Distance to Surface Water:	Less than 200 feet (20 points)						
	200 feet to 1,000 feet (10 points)						
(Horizontal distance to perennial lakes, ponds, rivers, streams, creeks, irrigation canals and ditches)	Greater than 1,000 feet (0 points)			0			
RANKING SCORE (TOTAL POINTS):							20

Date Remediation Started: 5/4/98 Date Completed: 5/8/98Remediation Method: Excavation X Approx. Cubic Yard 367

(Check all appropriate sections)

Landfarmed X Amount Landfarmed (cubic yds) 367

Other \_\_\_\_\_

Remediation Location: Onsite X Offsite \_\_\_\_\_

(i.e., landfarmed onsite, name and location of offsite facility)

Backfill Material Location: \_\_\_\_\_

## General Description of Remedial Action:

Excavated contaminated soil to a pit size of 31' X 32' X 10' and landfarmed soil onsite within a bermed area at a depth of 6" to 12". Soil was aerated by disking/plowing until soil met regulatory levels.\*\*\* Sandstone encountered at 10'. See attached risk analysis and lab analysis form.Ground Water Encountered: No ☒ Yes ☐ Depth \_\_\_\_\_Final Pit Closure  
Sampling:Sample Location Bottom of excavation.

(if multiple samples, attach sample result and diagram of sample locations and depths.)

Sample depth 10'Sample date 5/5/98 Sample time 8:45:00 AM

## Sample Results

Benzene (ppm) \*\*\* 54.0000Total BTEX (ppm) 540.0000

Field headspace (ppm) \_\_\_\_\_

TPH (ppm) 150.00 Method 8015Vertical Extent (ft) \_\_\_\_\_ Risk Analysis form attached Yes ☒ No ☐Ground Water Sample: Yes ☐ No ☒ (If yes, see attached Groundwater Site Summary Report)

I HEREBY CERTIFY THAT THE INFORMATION ABOVE IS TRUE AND COMPLETE TO THE BEST OF MY KNOWLEDGE AND MY BELIEF

DATE July 27, 1998SIGNATURE Mary CookPRINTED NAME Gary Cook  
AND TITLE Environmental Technician III

Johnson Corn B #1  
Cross Timbers  
Sec. 21, 27N, 10W, H

5/4/98

start of excavation:

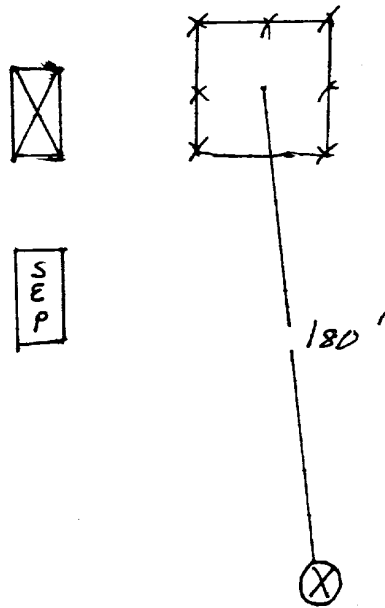

End of excavation:

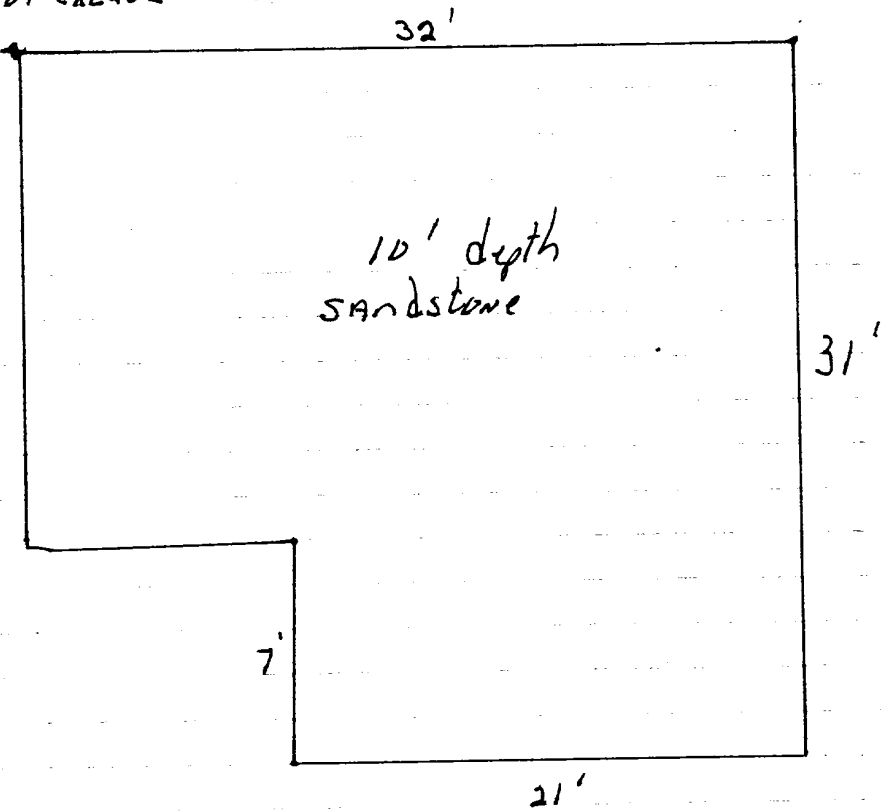

OFF: (505) 325-5667



LAB: (505) 325-1556

**On Site Technologies, LTD.**

**Date:** 15-May-98

---

**CLIENT:** PNM - Public Service Company of NM

**Project:** Johnson Com B#1

**Lab Order:** 9805012

**CASE NARRATIVE**

---

Samples were analyzed using the methods outlined in the following references:

Test Methods for Evaluating Solid Waste, Physical/Chemical Methods, SW846, 3rd Edition

All method blanks, laboratory spikes, and/or matrix spikes met quality assurance objectives.

OFF: (505) 325-5667



LAB: (505) 325-1556

## ANALYTICAL REPORT

Date: 15-May-98

**Client:** PNM - Public Service Company of NM  
**Work Order:** 9805012  
**Lab ID:** 9805012-01A     **Matrix:** SOIL  
**Project:** Johnson Com B#1

**Client Sample Info:** Johnson Com B#1  
**Client Sample ID:** 9805050845; Bottom  
**Collection Date:** 5/5/98 8:45:00 AM  
**COC Record:** 7130

Parameter	Result	PQL	Qual	Units	DF	Date Analyzed
<b>DIESEL RANGE ORGANICS</b>		<b>SW8015</b>				Analyst: HR
T/R Hydrocarbons: C10-C28	150	25		mg/Kg	1	5/13/98
<b>BTEX</b>		<b>SW8020A</b>				Analyst: DC
Benzene	54000	2500		µg/Kg	2500	5/6/98
Toluene	250000	5000		µg/Kg	2500	5/6/98
Ethylbenzene	26000	2500		µg/Kg	2500	5/6/98
m,p-Xylene	170000	5000		µg/Kg	2500	5/6/98
o-Xylene	40000	2500		µg/Kg	2500	5/6/98

540000  
540.0 ppm

**Qualifiers:** PQL - Practical Quantitation Limit  
ND - Not Detected at Practical Quantitation Limit  
J - Analyte detected below Practical Quantitation Limit  
B - Analyte detected in the associated Method Blank

S - Spike Recovery outside accepted recovery limits  
R - RPD outside accepted recovery limits  
E - Value above quantitation range  
Surr: - Surrogate

1 of 1

P.O. BOX 2606 • FARMINGTON, NM 87499

- THE ONLY ANALYTICAL LABORATORY SERVING THE ELECTRICITY INDUSTRY -

OFF: (505) 325-5667



LAB: (505) 325-1556

## ANALYTICAL REPORT

Date: 15-May-98

<b>Client:</b>	PNM - Public Service Company of NM	<b>Client Sample Info:</b>	Johnson Com B#1
<b>Work Order:</b>	9805012	<b>Client Sample ID:</b>	9805050850; Walls
<b>Lab ID:</b>	9805012-02A	<b>Matrix:</b>	SOIL
<b>Project:</b>	Johnson Com B#1	<b>Collection Date:</b>	5/5/98 8:50:00 AM
		<b>COC Record:</b>	7130

Parameter	Result	PQL	Qual	Units	DF	Date Analyzed
<b>DIESEL RANGE ORGANICS</b>		<b>SW8015</b>				Analyst: HR
T/R Hydrocarbons: C10-C28	ND	25		mg/Kg	1	5/13/98
<b>BTEX</b>		<b>SW8020A</b>				Analyst: DC
Benzene	ND	1		µg/Kg	1	5/6/98
Toluene	2.4	2		µg/Kg	1	5/6/98
Ethylbenzene	1.8	1		µg/Kg	1	5/6/98
m,p-Xylene	4.4	2		µg/Kg	1	5/6/98
o-Xylene	3.6	1		µg/Kg	1	5/6/98

12.2  
0.0122 ppm

**Qualifiers:**

PQL - Practical Quantitation Limit

ND - Not Detected at Practical Quantitation Limit

J - Analyte detected below Practical Quantitation Limit

B - Analyte detected in the associated Method Blank

S - Spike Recovery outside accepted recovery limits

R - RPD outside accepted recovery limits

E - Value above quantitation range

Surr: - Surrogate

1 of 1

P.O. BOX 2606 • FARMINGTON, NM 87499

- TECHNOLOGY BLENDING INDUSTRY WITH THE ENVIRONMENT -

Johnson Gas Com B<sup>#</sup>1  
 (H) 21-27N-10W  
 Cross Timbers  
 San Juan County  
 Lab Sample # 9805280820  
 Field headspace: 7.8 ppm

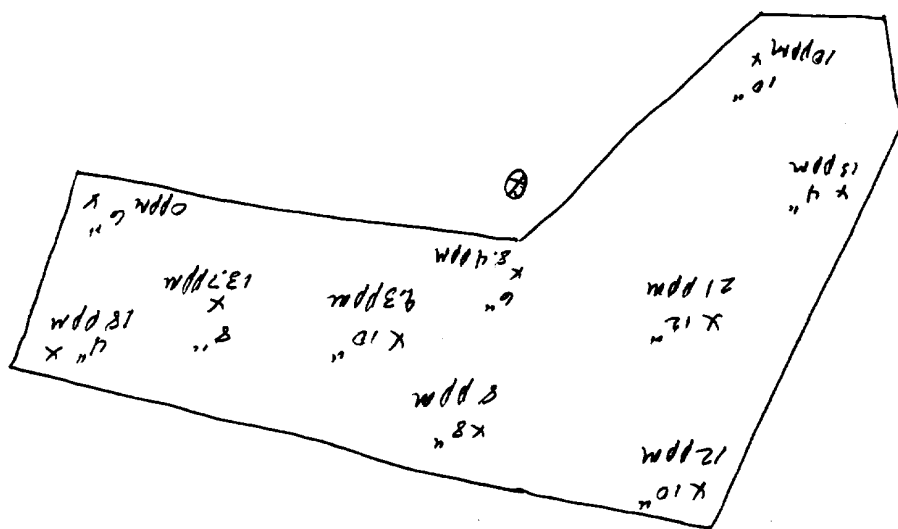

OFF: (505) 325-5667

# ON SITE

LAB: (505) 325-1556

TECHNOLOGIES, LTD.

**On Site Technologies, LTD.**

**Date:** 03-Jun-98

---

**CLIENT:** PNM - Public Service Company of NM

**Project:** Landfarm Compositess

**Lab Order:** 9805082

## CASE NARRATIVE

---

Samples were analyzed using the methods outlined in the following references:

Test Methods for Evaluating Solid Waste, Physical/Chemical Methods, SW846, 3rd Edition

All method blanks, laboratory spikes, and/or matrix spikes met quality assurance objectives.



OFF: (505) 325-5667

# ON SITE

TECHNOLOGIES, LTD.

LAB: (505) 325-1556

## ANALYTICAL REPORT

Date: 03-Jun-98

<b>Client:</b>	PNM - Public Service Company of NM	<b>Client Sample Info:</b>	Johnson Gas Com B#1
<b>Work Order:</b>	9805082	<b>Client Sample ID:</b>	9805250820; Landfarm
<b>Lab ID:</b>	9805082-03A	<b>Matrix:</b>	SOIL
<b>Project:</b>	Landfarm Compositess	<b>Collection Date:</b>	5/28/98 8:20:00 AM
		<b>COC Record:</b>	5223

Parameter	Result	PQL	Qual	Units	DF	Date Analyzed
<b>DIESEL RANGE ORGANICS</b>		<b>SW8015</b>				Analyst: HR
T/R Hydrocarbons: C10-C28	ND	25		mg/Kg	1	6/1/98

**Qualifiers:**

PQL - Practical Quantitation Limit  
ND - Not Detected at Practical Quantitation Limit  
J - Analyte detected below Practical Quantitation Limit  
B - Analyte detected in the associated Method Blank

S - Spike Recovery outside accepted recovery limits  
R - RPD outside accepted recovery limits  
E - Value above quantitation range  
Surr: - Surrogate

1 of 1

P.O. BOX 2606 • FARMINGTON, NM 87499



**Environmental Services**

---

Well Name:	Johnson Com B #1
Well Legals:	Unit H, Sec 21, T27N, R10W
Pit Type:	Separator
Horizontal Distance to Surface Water:	Less than 200 feet
Groundwater Depth:	Greater than 100 feet

---

**RISK ANALYSIS**

PNM requests closure of their former pit on the Johnson Com B #1 well site using a limited risk analysis based on the following conditions:

1. Groundwater is estimated to be at a depth of 225 feet based upon the elevation of the site and the elevation of the nearest "listed" or "named" wash (East Fork Canyon). (Reference: topographic map.)
2. PNM excavated 339 cubic yards of soil from the former pit. Subsurface lateral contamination has been remediated (see attached analytical results). Source removal minimizes the possibility of surface water contamination.
3. Sandstone was encountered at 10 feet below ground surface. Bedrock/sandstone provides a barrier between remaining contamination and groundwater. Vertical migration through bedrock or sandstone to groundwater is unlikely.
4. PNM excavated and performed remediation to the maximum depth and horizontal extent practicable.

PNM believes their former pit on the Johnson Com B #1 well site poses minimal threat to groundwater, human health and the environment based upon our past experience in excavating over 800 pits.

---