

	X		

5-USGS
1-WD
2-Gulf
1-D
1-F

(SUBMIT IN TRIPLICATE)

UNITED STATES
DEPARTMENT OF THE INTERIOR
GEOLOGICAL SURVEY

Budget Bureau No. 42-R358.4.
Approval expires 12-31-60.

Land Office _____
Lease No. **SF-078897**
Unit _____
Oneda Federal

SUNDRY NOTICES AND REPORTS ON WELLS

NOTICE OF INTENTION TO DRILL	<input checked="" type="checkbox"/>	SUBSEQUENT REPORT OF WATER SHUT-OFF	
NOTICE OF INTENTION TO CHANGE PLANS		SUBSEQUENT REPORT OF SHOOTING OR ACIDIZING	
NOTICE OF INTENTION TO TEST WATER SHUT-OFF		SUBSEQUENT REPORT OF ALTERING CASING	
NOTICE OF INTENTION TO RE-DRILL OR REPAIR WELL		SUBSEQUENT REPORT OF RE-DRILLING OR REPAIR	
NOTICE OF INTENTION TO SHOOT OR ACIDIZE		SUBSEQUENT REPORT OF ABANDONMENT	
NOTICE OF INTENTION TO PULL OR ALTER CASING		SUPPLEMENTARY WELL HISTORY	
NOTICE OF INTENTION TO ABANDON WELL			

(INDICATE ABOVE BY CHECK MARK NATURE OF REPORT, NOTICE, OR OTHER DATA)

July 20, 19 61

Well No. 1 is located 1850 ft. from S line and 1830 ft. from W line of sec. 30
NE/4 SW/4 Sec. 30 27N 11W NMPM
 (1/4 Sec. and Sec. No.) (Twp.) (Range) (Meridian)
Basin Dakota San Juan New Mexico
 (Field) (County or Subdivision) (State or Territory)

The elevation of the derrick floor above sea level is 6143 ft. G.L.

DETAILS OF WORK

(State names of and expected depths to objective sands; show sizes, weights, and lengths of proposed casings; indicate mudding jobs, cementing points, and all other important proposed work)

Propose to drill with rotary tools to an approximate depth of 6450' or to test the Dakota formation. Casing program will be as follows:

10 3/4" 32.50# surface set at approximately 200' with 160 sx cement.
 4 1/2" 10.50# set at total depth with 475 sx cement or cement to cover the Gallup formation.

USGS will be consulted after the well is logged concerning the necessity of setting a DV tool for the Pictured Cliffs formation.

Will perforate and sand-water frac the Dakota formation.

I understand that this plan of work must receive approval in writing by the Geological Survey before operations may be commenced.

Company Southwest Production Company
 Address 162 Petr. Center Bldg.,
Farmington, New Mexico

Original signed by
Carl W. Smith

By _____
 Title Production Superintendent

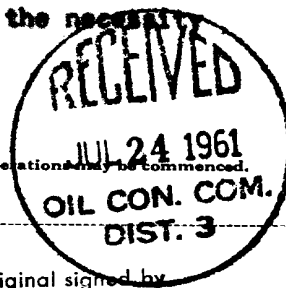

NUMBER OF COPIES RECEIVED	
DISTRIBUTION	
SANTA FE	
FILE	
U.S.G.S.	
LAND OFFICE	
TRANSPORTER	OIL GAS
PRODUCTION OFFICE	
OPERATOR	

NEW MEXICO OIL CONSERVATION COMMISSION
WELL LOCATION AND ACREAGE DEDICATION PLAT
 SEE INSTRUCTIONS FOR COMPLETING THIS FORM ON THE REVERSE SIDE

FORM C-128
Revised 5/1/57

SECTION A

Operator SOUTHWEST PRODUCTION COMPANY			Lease OMEDA FEDERAL (SF-078897)		Well No. 1
Unit Letter K	Section 30	Township 27 NORTH	Range 11 WEST	County SAN JUAN	
Actual Footage Location of Well: 1850 feet from the SOUTH line and 1830 feet from the WEST line					
Ground Level Elev. 6143.0	Producing Formation DAKOTA		Pool BASIN DAKOTA		Dedicated Acreage: 377.16 Acres 1/289

Ref: GLO plat dated 19 July 1915

1. Is the Operator the only owner in the dedicated acreage outlined on the plat below? YES ☒ NO ☐ ("Owner" means the person who has the right to drill into and to produce from any pool and to appropriate the production either for himself or for himself and another. (65-3-29 (e) NMSA 1935 Comp.)
2. If the answer to question one is "no," have the interests of all the owners been consolidated by communitization agreement or otherwise? YES ☐ NO ☐ . If answer is "yes," Type of Consolidation _____
3. If the answer to question two is "no," list all the owners and their respective interests below:

Owner	Land Description

SECTION B

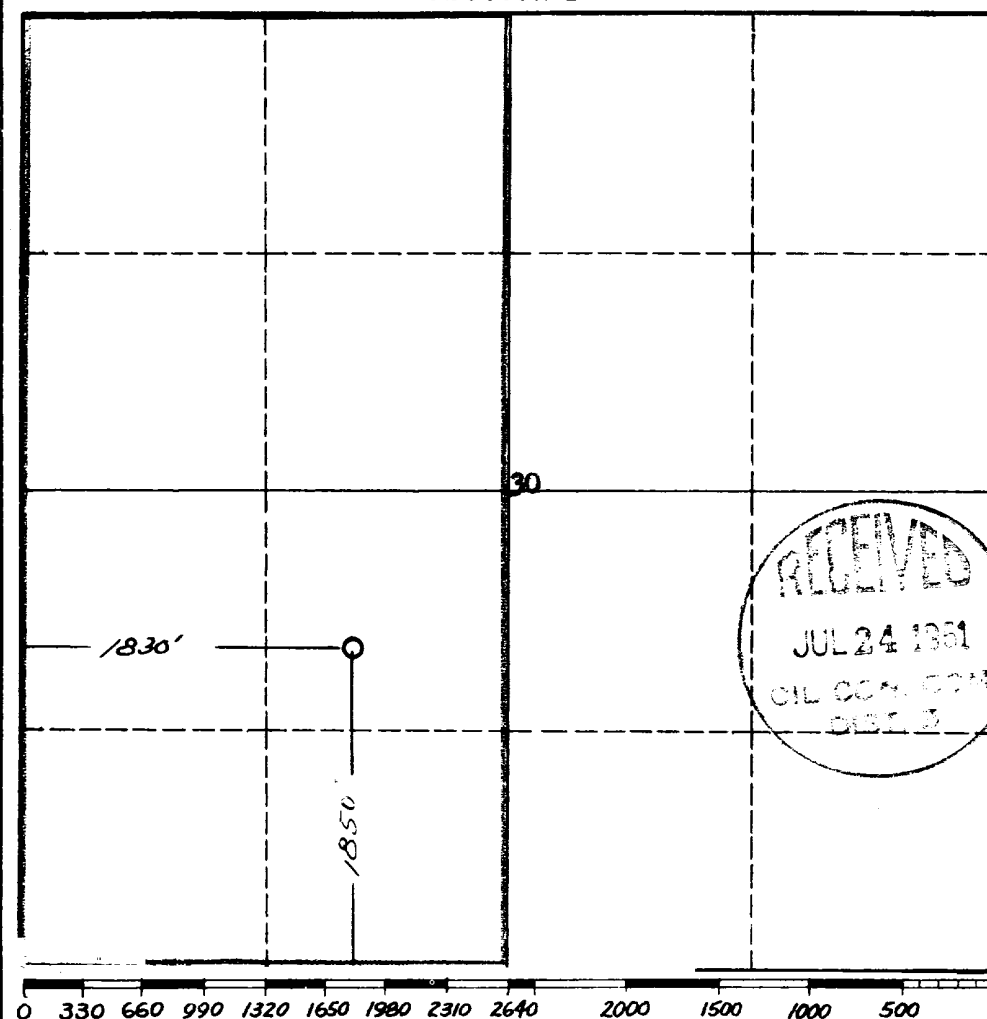

CERTIFICATION

I hereby certify that the information in SECTION A above is true and complete to the best of my knowledge and belief.

Name	Original signed by Carl W. Smith
Position	Production Superintendent
Company	Southwest Production Co.
Date	7/20/61

I hereby certify that the well location shown on the plat in SECTION B was plotted from field notes of actual surveys made by me or under my supervision, and that the same is true and correct to the best of my knowledge and belief.

Date Surveyed	18 July 1961
Registered Professional Engineer and/or Land Surveyor	<i>James P. Lease</i> James P. Lease
Certificate No.	1563
San Juan Engineering Company	

INSTRUCTIONS FOR COMPLETION OF FORM C-128

1. Operator shall furnish and certify to the information called for in Section A.
 2. Operator shall outline the dedicated acreage for *both* oil and gas wells on the plat in Section B.
 3. A registered professional engineer or land surveyor registered in the State of New Mexico or approved by the Commission shall show on the plat the location of the well and certify this information in the space provided.
 4. All distances shown on the plat must be from the outer boundaries of the Section.
 5. If additional space is needed for listing owners and their respective interests as required in question 3 of Section A, please use space below.
-