

5-USGS

1-WD

1-D

1-F

(SUBMIT IN TRIPLICATE)

UNITED STATES
DEPARTMENT OF THE INTERIOR
GEOLOGICAL SURVEY

Budget Bureau No. 42-R353.4
Approval expires 12-31-60.

Land Office

Lease No. **NM-03523**

Unit

Holloway Federal "B"

			X

SUNDRY NOTICES AND REPORTS ON WELLS

NOTICE OF INTENTION TO DRILL	<input checked="" type="checkbox"/>	SUBSEQUENT REPORT OF WATER SHUT-OFF	
NOTICE OF INTENTION TO CHANGE PLANS		SUBSEQUENT REPORT OF SHOOTING OR ACIDIZING	
NOTICE OF INTENTION TO TEST WATER SHUT-OFF		SUBSEQUENT REPORT OF ALTERING CASING	
NOTICE OF INTENTION TO RE-DRILL OR REPAIR WELL		SUBSEQUENT REPORT OF RE-DRILLING OR REPAIR	
NOTICE OF INTENTION TO SHOOT OR ACIDIZE		SUBSEQUENT REPORT OF ABANDONMENT	
NOTICE OF INTENTION TO PULL OR ALTER CASING		SUPPLEMENTARY WELL HISTORY	
NOTICE OF INTENTION TO ABANDON WELL			

(INDICATE ABOVE BY CHECK MARK NATURE OF REPORT, NOTICE, OR OTHER DATA)

October 26, 19 61

Well No. 1 is located 890 ft. from [N] line and 890 ft. from [E] line of sec. 31

NE/4 NE/4 Sec. 31 27N 11W NMPM
(1/4 Sec. and Sec. No.) (Twp.) (Range) (Meridian)
Basin Dakota San Juan New Mexico
(Field) (County or Subdivision) (State or Territory)

The elevation of the derrick floor above sea level is 6105 ft. GL

DETAILS OF WORK

(State names of and expected depths to objective sands; show sizes, weights, and lengths of proposed casings; indicate mudding jobs, cementing points, and all other important proposed work)

Propose to drill with rotary tools to an approximate depth of 6320 feet or to test the Dakota formation. Casing program will be as follows:

10 3/4" 32.50# surface casing set at approx. 200 feet w/150 sx cement
4 1/2" 10.50# casing set at total depth w/300 sx cement or cement to cover the Gallup formation.

Will perforate and sand-water frac the Dakota formation.

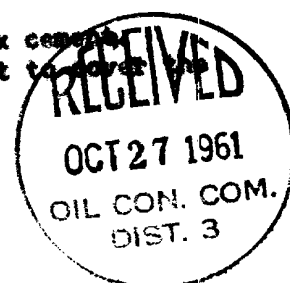

I understand that this plan of work must receive approval in writing by the Geological Survey before operations may be commenced.

Company Southwest Production Company

Address 207 Petr. Club Plaza
Farmington, New Mexico

Original signed by
Carl W. Smith

By _____
Title Superintendent

NEW MEXICO OIL CONSERVATION COMMISSION

Well Location and Acreage Dedication Plat

Section A.

Date 10/26/61

Operator SOUTHWEST PRODUCTION COMPANY Lease Holloway Federal "B" NM-03323
 Well No. 1 Unit Letter A Section 31 Township 27 NORTH Range 11 WEST, NMPM
 Located 890 Feet From the NORTH Line, 890 Feet From the EAST Line
 County SAN JUAN G. L. Elevation 6105.0 Dedicated Acreage N/430 317.77 Acres
 Name of Producing Formation Dakota Pool Basin Dakota

1. Is the Operator the only owner in the dedicated acreage outlined on the plat below?
 Yes X No _____
2. If the answer to question one is "no", have the interests of all the owners been consolidated by communitization agreement or otherwise? Yes _____ No _____. If answer is "yes", Type of Consolidation.
3. If the answer to question two is "no", list all the owners and their respective interests below:

Owner

Land Description

RECEIVED

OCT 27 1961

N. COM.

DIST. 3

Section B.

Note: All distances must be from outer boundaries of section.

This is to certify that the information in Section A above is true and complete to the best of my knowledge and belief.

Southwest Production Co.

(Operator) Original signed by
 Carl W. Smith

(Representative)

207 Petr. Club Plaza

(Address)
Farmington, New Mexico

Ref: GLO plat dated 19 July 1915

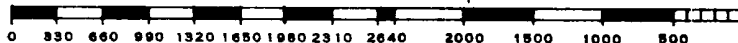
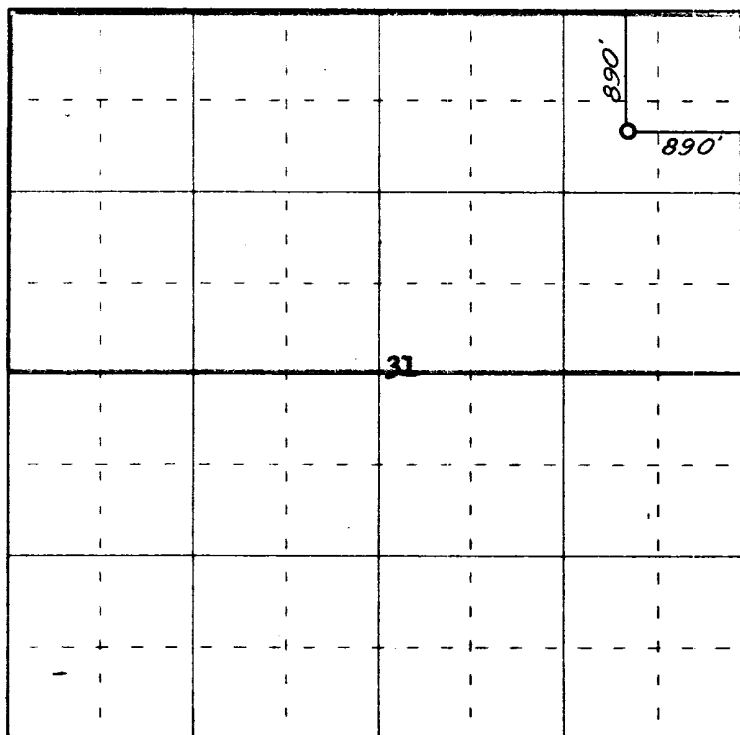

Scale 4 inches equal 1 mile

This is to certify that the above plat was prepared from field notes of actual surveys made by me or under my supervision and that the same are true and correct to the best of my knowledge and belief.

Date Surveyed 25 October 1961

James P. Leese
 Registered Professional Engineer and/or Land Surveyor
 James P. Leese N. Mex. Reg. No. 1463
 San Juan Engineering Company

