

UNITED STATES
DEPARTMENT OF THE INTERIOR
GEOLOGICAL SURVEY

SUBMIT IN TRIPLICATE*
(Other instructions on re-
verse side)

Form approved.
Budget Bureau No. 42-R1424

5. LEASE DESIGNATION AND SERIAL NO.

NOO-C-14-20-2976

6. IF INDIAN, ALLOTTEE OR TRIBE NAME

Navajo Tribal

7. UNIT AGREEMENT NAME

8. FARM OR LEASE NAME

Beautiful Mountain ~~19~~

9. WELL NO.

1

10. FIELD AND POOL, OR WILDCAT

Undesignated

11. SEC., T., R., M., OR BLK. AND
SURVEY OR AREA

Sec. 19-T27N-R19W

N.M.P.M.

12. COUNTY OR PARISH

San Juan

13. STATE

New Mexico

1.

OIL WELL ☒ GAS WELL ☐ OTHER ☐

2. NAME OF OPERATOR

Security Gas & Oil Company

3. ADDRESS OF OPERATOR

c/oWalsh Engineering & Production Corp.

P. O. Box 254, Farmington, New Mexico 87401

4. LOCATION OF WELL (Report location clearly and in accordance with any State requirements.*
See also space 17 below.)

At surface

1980'FNL, 990'FEL

14. PERMIT NO.

15. ELEVATIONS (Show whether DF, RT, GR, etc.)

5713'GR

16. Check Appropriate Box To Indicate Nature of Notice, Report, or Other Data

NOTICE OF INTENTION TO:

TEST WATER SHUT-OFF

FRACTURE TREAT

SHOOT OR ACIDIZE

REPAIR WELL

(Other)

PULL OR ALTER CASING

MULTIPLE COMPLETE

ABANDON*

CHANGE PLANS

SUBSEQUENT REPORT OF:

WATER SHUT-OFF

FRACTURE TREATMENT

SHOOTING OR ACIDIZING

(Other)

REPAIRING WELL

ALTERING CASING

ABANDONMENT*

Change location footage & X

(NOTE: Report results of multiple completion on Well
Completion or Recompletion Report and Log form.)

elev.

17. DESCRIBE PROPOSED OR COMPLETED OPERATIONS (Clearly state all pertinent details, and give pertinent dates, including estimated date of starting any proposed work. If well is directionally drilled, give subsurface locations and measured and true vertical depths for all markers and zones pertinent to this work.)*

February 14, 1974

The well name, location and elevation has been changed as follows:

Previous

Change to:

Name; Beautiful Mountain, Well No.1-19

Beautiful Mountain 19, Well No.1

Location; 775'FNL, 990'FEL

1980'FNL, 990'FEL

Elevation: 5740' GR

5713'GR

Acreage Dedication: NENE Sec.19

SENE Sec. 19

Attached is copy of Well Location and Acreage Dedication Plat.

Acreage Dedication: SE/4NE/4 Section 19

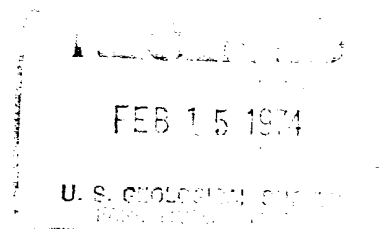
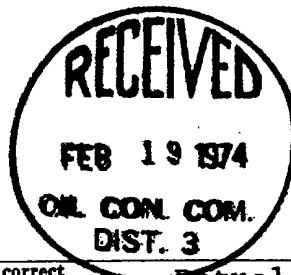

18. I hereby certify that the foregoing is true and correct

For: Security Gas & Oil Co.

SIGNED Ewell N. Walsh

Petroleum Engineer

TITLE

DATE Feb. 14, 1974

(This space for Federal or State office use)

APPROVED BY

CONDITIONS OF APPROVAL, IF ANY:

TITLE

DATE



**NEW MEXICO OIL CONSERVATION COMMISSION
WELL LOCATION AND ACREAGE DEDICATION PLAT**

Form C-102
Supersedes C-128
Effective 1-1-65

All distances must be from the outer boundaries of the Section.

Operator Security Gas & Oil Inc.			Lease Beautiful Mountain 19		Well No. 1
Unit Letter H	Section 19	Township 27N	Range 19W	County San Juan	
Actual Footage Location of Well:					
1980 feet from the North line and		990 feet from the East line			
Ground Level Elev. 5713	Producing Formation Pennsylvanian		Pool Undesignated	Dedicated Acreage: 40 Acres	

1. Outline the acreage dedicated to the subject well by colored pencil or hachure marks on the plat below.
2. If more than one lease is dedicated to the well, outline each and identify the ownership thereof (both as to working interest and royalty).
3. If more than one lease of different ownership is dedicated to the well, have the interests of all owners been consolidated by communitization, unitization, force-pooling, etc?

☐ Yes ☐ No If answer is "yes," type of consolidation _____

If answer is "no," list the owners and tract descriptions which have actually been consolidated. (Use reverse side of this form if necessary.) _____

No allowable will be assigned to the well until all interests have been consolidated (by communitization, unitization, forced-pooling, or otherwise) or until a non-standard unit, eliminating such interests, has been approved by the Commission.

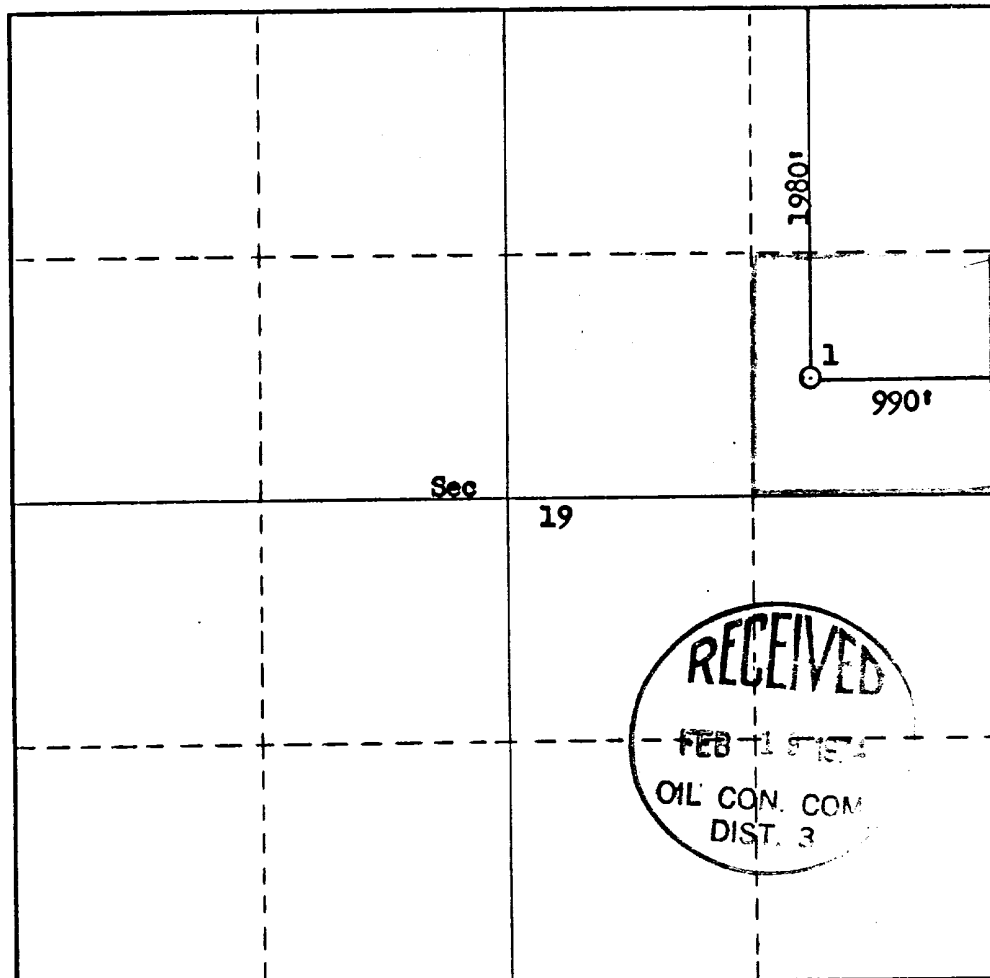

CERTIFICATION

I hereby certify that the information contained herein is true and complete to the best of my knowledge and belief.

For: Security Gas & Oil, Inc

Name <i>Ewell N. Walsh</i>
Position Ewell N. Walsh Petroleum Engineer
Company Walsh Engineering & Production Corporation
Date February 14, 1974

I hereby certify that the well location shown on this plat was plotted from field notes of actual surveys made by me or under my supervision, and that the same is true and correct to the best of my knowledge and belief.

Date Surveyed February 13, 1974
Registered Professional Engineer and/or Land Surveyor <i>Fred B. Kerr</i> Fred B. Kerr
Certificate No. 3950

0 330 660 990 1320 1650 1980 2310 2640 2000 1500 1000 500 0