

J. GREGORY MERRION  
PETROLEUM ENGINEER  
P. O. BOX 807  
FARMINGTON, NEW MEXICO 87401

May 17, 1978

New Mexico Oil Conservation Commission  
P.O. Box 2088  
Santa Fe, New Mexico 87501

RE: Hi Roll #2  
Pic. Cliff Test  
SW/4 Sec. 35, T27N, R13W  
San Juan County, NM

Gentlemen:

Please accept this as our application for administrative approval of an unorthodox location for the above well as shown on the attached survey plat. You will note we have moved the location 150 feet north from the orthodox location to comply with the requirements of the Navajo Indian Irrigation Project.

We are sending a copy of this application to the offset acreage holders along with a request for waiver on their part if they have no objection.

Yours very truly,

MERRION & BAYLESS

By \_\_\_\_\_  
J. GREGORY MERRION

JGM/eh

Enclosure: Intent to Drill  
Survey Plat

cc: 2 copies - Aztec NMOCC  
1 copy - each offset acreage holder

UNITED STATES  
DEPARTMENT OF THE INTERIOR  
GEOLOGICAL SURVEY

APPLICATION FOR PERMIT TO DRILL, DEEPEN, OR PLUG BACK

1A. TYPE OF WORK DRILL ☒ DEEPEN ☐ PLUG BACK ☐

B. TYPE OF WELL  
OIL WELL ☐ GAS WELL ☒ OTHER ☐  
SINGLE ZONE ☒ MULTIPLE ZONE ☐

2. NAME OF OPERATOR  
J. Gregory Merrion and Robert L. Bayless

3. ADDRESS OF OPERATOR  
P.O. Box 1541, Farmington, NM 87401

4. LOCATION OF WELL (Report location clearly and in accordance with any State requirements.)  
At surface  
2000 FSL and 1850 FWL

At proposed prod. zone  
Same

14. DISTANCE IN MILES AND DIRECTION FROM NEAREST TOWN OR POST OFFICE\*  
14 miles south of Farmington

10. DISTANCE FROM PROPOSED\*  
LOCATION TO NEAREST  
PROPERTY OR LEASE LINE, FT.  
(Also to nearest drilg. unit line, if any) 1850'

18. DISTANCE FROM PROPOSED LOCATION\*  
TO NEAREST WELL, DRILLING, COMPLETED,  
OR APPLIED FOR, ON THIS LEASE, FT. 2400'

21. ELEVATIONS (Show whether DF, RT, GR, etc.)  
6034' GL

16. NO. OF ACRES IN LEASE  
640

19. PROPOSED DEPTH  
1300'

17. NO. OF ACRES ASSIGNED  
TO THIS WELL 160

20. ROTARY OR CABLE TOOLS  
Rotary

22. APPROX. DATE WORK WILL START\*  
As soon as possible

D. LEASE DENUMINATION AND SERIAL NO.  
NM 33047  
U. IF INDIAN, ALLOTTED OR TRIBE NAME  
7. UNIT AGREEMENT NAME  
8. FARM OR LEASE NAME  
Hi Roll  
9. WELL NO.  
2  
10. FIELD AND POOL, OR WILDCAT  
NIPP Picture Cliff  
11. SEC., T., R., M., OR BLK.  
AND SURVEY OR AREA  
Sec. 35, T27N, R13W  
12. COUNTY OR PARISH  
San Juan  
13. STATE  
N.M.

23. PROPOSED CASING AND CEMENTING PROGRAM

SIZE OF HOLE	SIZE OF CASING	WEIGHT PER FOOT	SETTING DEPTH	QUANTITY OF CEMENT
7-7/8"	5-1/2"	15.5#	30 ft.	10 sacks
4-3/4"	2-7/8"	6.4#	1300 ft.	100 sacks

Will drill 7-7/8" hole to 30 ft. and set 30 ft. of 5-1/2", 15.5# casing with 10 sacks cement. Will drill 4-3/4" hole to 1300 ft. and run logs. If appears productive, will run 1300 ft. of 2-7/8", 6.4#, J-55 casing and cement with 100 sacks. Will perforate and stimulate as required. Minimum specifications for pressure control equipment which is to be used - none required. Circulating medium will be clear water and natural mud and water loss control additives. The gas from this formation is not dedicated.

ESTIMATED TOPS:

Formation	Depth	Content
Ojo Alamo	Below Surface Alluvium	Water
Kirtland	156 ft.	
Fruitland	1050 ft.	
Picture Cliff	1256 ft.	Natural Gas

IN ABOVE SPACE DESCRIBE PROPOSED PROGRAM: If proposal is to deepen or plug back, give data on present productive zone and proposed new productive zone. If proposal is to drill or deepen directionally, give pertinent data on subsurface locations and measured and true vertical depths. Give blowout preventer program, if any.

24. Robert L. Bayless TITLE Co-Owner DATE May 3, 1978  
(This space for Federal or State office use)

PERMIT NO. \_\_\_\_\_ APPROVAL DATE \_\_\_\_\_

APPROVED BY \_\_\_\_\_ TITLE \_\_\_\_\_ DATE \_\_\_\_\_  
CONDITIONS OF APPROVAL, IF ANY:

**NEW MEXICO OIL CONSERVATION COMMISSION  
WELL LOCATION AND ACREAGE DEDICATION PLAT**

Form C-101  
Supersedes C-110  
Effective 1-4-63

All distances must be from the outer boundaries of the Section.

Operator <b>Merrion &amp; Bayless</b>			Lease <b>Hill Roll</b>		Well No. <b>2</b>
Unit Letter <b>K</b>	Section <b>35</b>	Township <b>27N</b>	Range <b>13W</b>	County <b>San Juan</b>	
Actual Footage Location of Well: <b>2000</b> feet from the <b>South</b> line and <b>1850</b> feet from the <b>West</b> line					
Ground Level Elev. <b>6034</b>	Producing Formation <b>Pictured Cliffs</b>	Pool <b>NIPP Pictured Cliffs</b>		Dedicated Acreage: <b>160</b>	Acreage

1. Outline the acreage dedicated to the subject well by colored pencil or hachure marks on the plat below.
2. If more than one lease is dedicated to the well, outline each and identify the ownership thereof (both as to working interest and royalty).
3. If more than one lease of different ownership is dedicated to the well, have the interests of all owners been consolidated by communitization, unitization, force-pooling, etc?

☐ Yes   ☐ No   If answer is "yes," type of consolidation \_\_\_\_\_

If answer is "no," list the owners and tract descriptions which have actually been consolidated. (Use reverse side of this form if necessary.) \_\_\_\_\_

No allowable will be assigned to the well until all interests have been consolidated (by communitization, unitization, forced-pooling, or otherwise) or until a non-standard unit, eliminating such interests, has been approved by the Commission.

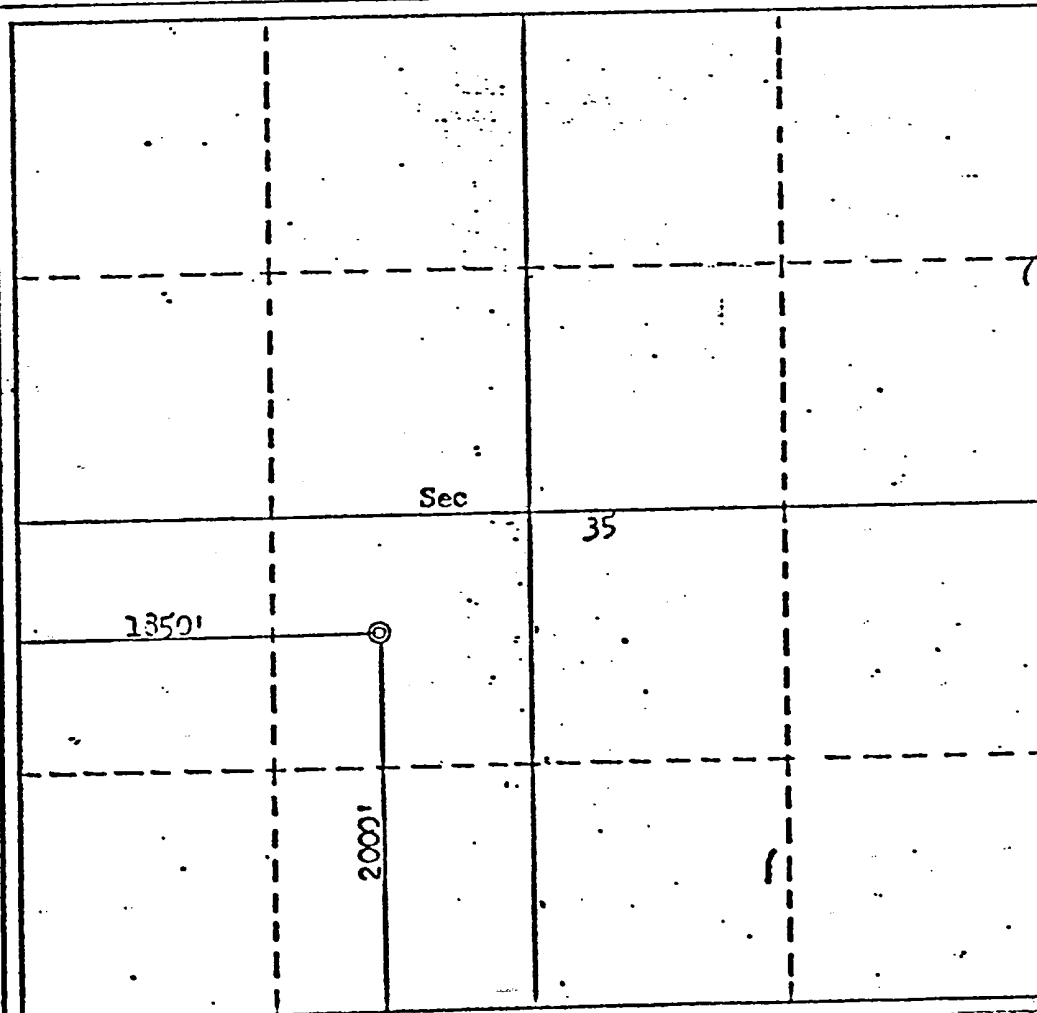

**CERTIFICATION**

I hereby certify that the information contained herein is true and complete to the best of my knowledge and belief.

*Robert L. Bayless*

Name  
**Robert L. Bayless**

Position  
**Co-Owner**

Company  
**Merrion & Bayless**

Date  
**April 5, 1978**

I hereby certify that the well location shown on this plat was plotted from field notes of actual surveys made by me or under my supervision, and that the same is true and correct to the best of my knowledge and belief.

Date Surveyed

**April 3, 1978**

Registered Professional Engineer and/or Land Surveyor

*Fred B. [Signature]*

Certification No.

**3950**

0 330 660 990 1320 1650 1980 2310 2640 2000 1500 1000 500 0

MERRION & BAYLESS  
P.O. Box 507  
Farmington, New Mexico

Proposed - Hi Roll #2  
SW/4 Sec. 35, T27N, R13W  
San Juan County, N.M.

\_\_\_\_\_ hereby consents  
(Company Name)  
to Merrion and Bayless drilling a proposed Pictured Cliffs test gas well  
at a location 2000 feet from the south line and 1850 feet from the west  
line of Section 35, Township 27 North, Range 13 West, San Juan County,  
New Mexico.

By \_\_\_\_\_  
Title: \_\_\_\_\_

Date \_\_\_\_\_

J. GREGORY MERRION  
PETROLEUM ENGINEER  
P. O. BOX 507  
FARMINGTON, NEW MEXICO 87401

CERTIFIED MAIL

May 23, 1978

Phillips Petroleum  
Security Life Bldg.  
Denver, CO 80202

RE: Hi Roll #2  
SW/4 Sec. 35, T27N, R13W  
San Juan County, NM

Gentlemen:

You will note from the enclosed copy of application we are requesting an unorthodox location for the above referred to well, and if you have no objection we would appreciate your signing the enclosed waiver and sending it direct to the New Mexico Oil Conservation Commission, P.O. Box 2088, Santa Fe, New Mexico 87501.

Yours very truly,

MERRION & BAYLESS

By

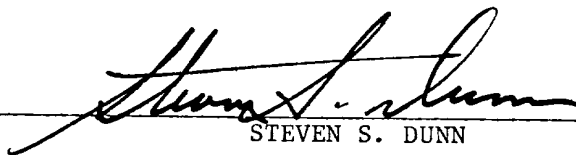
  
STEVEN S. DUNN  
Engineer

SSD/eh

Enclosure: Waiver Form

xc: NMOCC:  
Santa Fe  
~~Attec~~

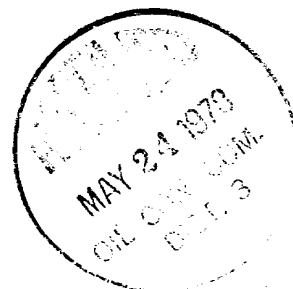

J. GREGORY MERRION  
PETROLEUM ENGINEER  
P. O. BOX 507  
FARMINGTON, NEW MEXICO 87401

CERTIFIED MAIL

May 23, 1978

Dietrich Exploration Co., Inc.  
602 Midland Savings Bldg.  
444 17th Street  
Denver, CO 80202

RE: Hi Roll #2  
SW/4 Sec. 35, T27N, R13W  
San Juan County, NM

Gentlemen:

The enclosed application for unorthodox location is resubmitted to you to fulfill a New Mexico State requirement that offset owners be notified by Certified mail. This application is identical to the one already sent to your offices.

Yours very truly,

MERRION & BAYLESS

By

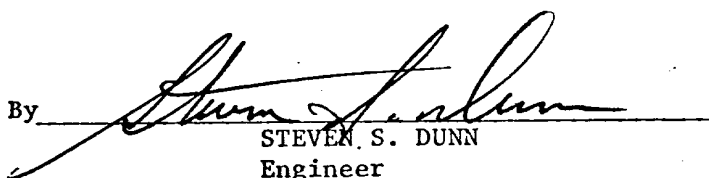
  
STEVEN S. DUNN  
Engineer

SSD/eh

Enclosures

xc: NMOCC, Santa Fe  
NMOCC, Aztec

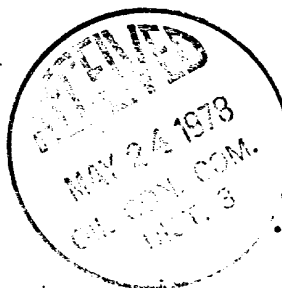

J. GREGORY MERRION  
PETROLEUM ENGINEER  
P. O. BOX 507  
FARMINGTON, NEW MEXICO 87401

CERTIFIED MAIL

May 23, 1978

Jerome P. McHugh & Assoc.  
Suite 1225  
600 South Cherry St.  
Denver, CO 80222

RE: Hi Roll #2  
SW/4 Sec. 35, T27N, R13W  
San Juan County, NM

Gentlemen:

The enclosed application for unorthodox location is resubmitted to you to fulfill a New Mexico State requirement that offset owners be notified by Certified mail. This application is identical to the one already sent to your offices.

Yours very truly,

MERRION & BAYLESS

By

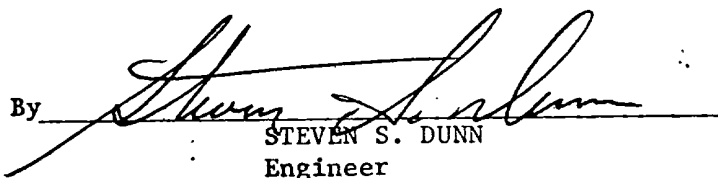
  
STEVEN S. DUNN  
Engineer

SSD/eh

Enclosures

xc: NMOCC, Santa Fe  
~~NMOCC, Aztec~~

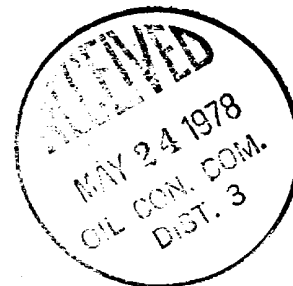

J. GREGORY MERRION  
PETROLEUM ENGINEER  
P. O. BOX 507  
FARMINGTON, NEW MEXICO 87401

CERTIFIED MAIL

May 23, 1978

Dome Petroleum Corp.  
1500 Colorado State Bank Bldg.  
Denver, CO 80202

RE: Hi Roll #2  
SW/4 Sec. 35, T27N, R13W  
San Juan County, NM

Gentlemen:

The enclosed application for unorthodox location is resubmitted to you to fulfill a New Mexico State requirement that offset owners be notified by Certified mail. This application is identical to the one already sent to your offices.

Yours very truly,

MERRION & BAYLESS

By

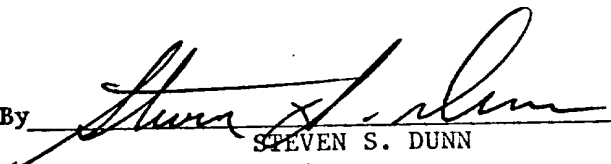
  
STEVEN S. DUNN  
Engineer

SSD/eh

Enclosures

xc: NMOCC, Santa Fe  
NMOCC, Aztec

