

UNITED STATES
DEPARTMENT OF THE INTERIOR
GEOLOGICAL SURVEY

APPLICATION FOR PERMIT TO DRILL, DEEPEN, OR PLUG BACK

1a. TYPE OF WORK

DRILL ☒DEEPEN ☐PLUG BACK ☐

b. TYPE OF WELL

OIL
WELL ☐GAS
WELL ☒

OTHER

SINGLE
ZONE ☐MULTIPLE
ZONE ☐

2. NAME OF OPERATOR

Watson Associates

3. ADDRESS OF OPERATOR

P.O. Box 255, Farmington, New Mexico 87401

4. LOCATION OF WELL (Report location clearly and in accordance with any State requirements.)*

At surface

1500' FNL, 820' FWL

At proposed prod. zone

Same

14. DISTANCE IN MILES AND DIRECTION FROM NEAREST TOWN OR POST OFFICE*

17 miles south of Farmington

15. DISTANCE FROM PROPOSED*
LOCATION TO NEAREST
PROPERTY OR LEASE LINE, FT.
(Also to nearest drlg. unit line, if any)

820'

16. NO. OF ACRES IN LEASE

320

18. DISTANCE FROM PROPOSED LOCATION*
TO NEAREST WELL, DRILLING, COMPLETED,
OR APPLIED FOR, ON THIS LEASE, FT.

None

19. PROPOSED DEPTH

1345'

17. NO. OF ACRES ASSIGNED
TO THIS WELL

160 (NW/4) ✓

20. ROTARY OR CABLE TOOLS

Rotary

21. ELEVATIONS (Show whether DF, RT, GR, etc.)

5971 Gr.

22. APPROX. DATE WORK WILL START*

October 20, 1978

23.

PROPOSED CASING AND CEMENTING PROGRAM

SIZE OF HOLE	SIZE OF CASING	WEIGHT PER FOOT	SETTING DEPTH	QUANTITY OF CEMENT
7 7/8	6"	16#	32'	6 sacks-to surface
4 3/4	2 7/8"	6.5#		65 sacks-to surface

It is proposed to drill a 7 7/8" surface hole to 32' and set one joint of 6", 16# casing cemented to the surface with 6 sacks regular cement. After cement sets 12 hrs. a 4 3/4" hole will be drilled to a total depth of 1345' to test gas possibilities in the Fruitland and Pictured Cliffs formations. An electrical-induction and density log will be run to T.D. and if an evaluation of this log indicates possible gas zones, 2 7/8" tubing will be run to T.D., cemented to surface and, after sufficient setting time the possible zones will be perforated and tested. No blow-out preventer is contemplated as a mud weight sufficient to control the expected low-pressure zones will be used. A master valve and stripping head will be utilized during any completion attempt. Estimated formation tops are: Ojo Alamo Ss.-surface, Kirtland Sh.-125', Fruitland Fm.-990', and Pictured Cliffs Ss.-1285'.

gas not identified

IN ABOVE SPACE DESCRIBE PROPOSED PROGRAM: If proposal is to deepen or plug back, give data on present productive zone and proposed new productive zone. If proposal is to drill or deepen directionally, give pertinent data on subsurface locations and measured and true vertical depths. Give blowout preventer program, if any.

24.

SIGNED

William R. Speer

TITLE

Consulting Geologist

DATE

9/29/78

(This space for Federal or State office use)

PERMIT NO.

APPROVAL DATE

APPROVED BY

TITLE

DATE

CONDITIONS OF APPROVAL, IF ANY:

oh Frank

*See Instructions On Reverse Side

NMOCC

**NEW MEXICO OIL CONSERVATION COMMISSION
WELL LOCATION AND ACREAGE DEDICATION PLAT**

Form C-102
Supersedes C-128
Effective 1-1-65

All distances must be from the outer boundaries of the Section.

Operator Watson Associates			Lease (AM-33042) Kinoco		Well No. 1 111111
Unit Letter E	Section 25	Township 27 North	Range 13 West	County San Juan	
Actual Footage Location of Well: 1500 feet from the North line and 820 feet from the West line					
Ground Level Elev. 5971	Producing Formation Pictured Cliffs Ss.	Pool WFW-Fruitland-P.C. Unit	Dedicated Acreage: NW/4 - 160 Acres		

1. Outline the acreage dedicated to the subject well by colored pencil or hachure marks on the plat below.
2. If more than one lease is dedicated to the well, outline each and identify the ownership thereof (both as to working interest and royalty).
3. If more than one lease of different ownership is dedicated to the well, have the interests of all owners been consolidated by communitization, unitization, force-pooling, etc?

☐ Yes ☐ No If answer is "yes," type of consolidation _____

If answer is "no," list the owners and tract descriptions which have actually been consolidated. (Use reverse side of this form if necessary.) _____

No allowable will be assigned to the well until all interests have been consolidated (by communitization, unitization, forced-pooling, or otherwise) or until a non-standard unit, eliminating such interests, has been approved by the Commission.

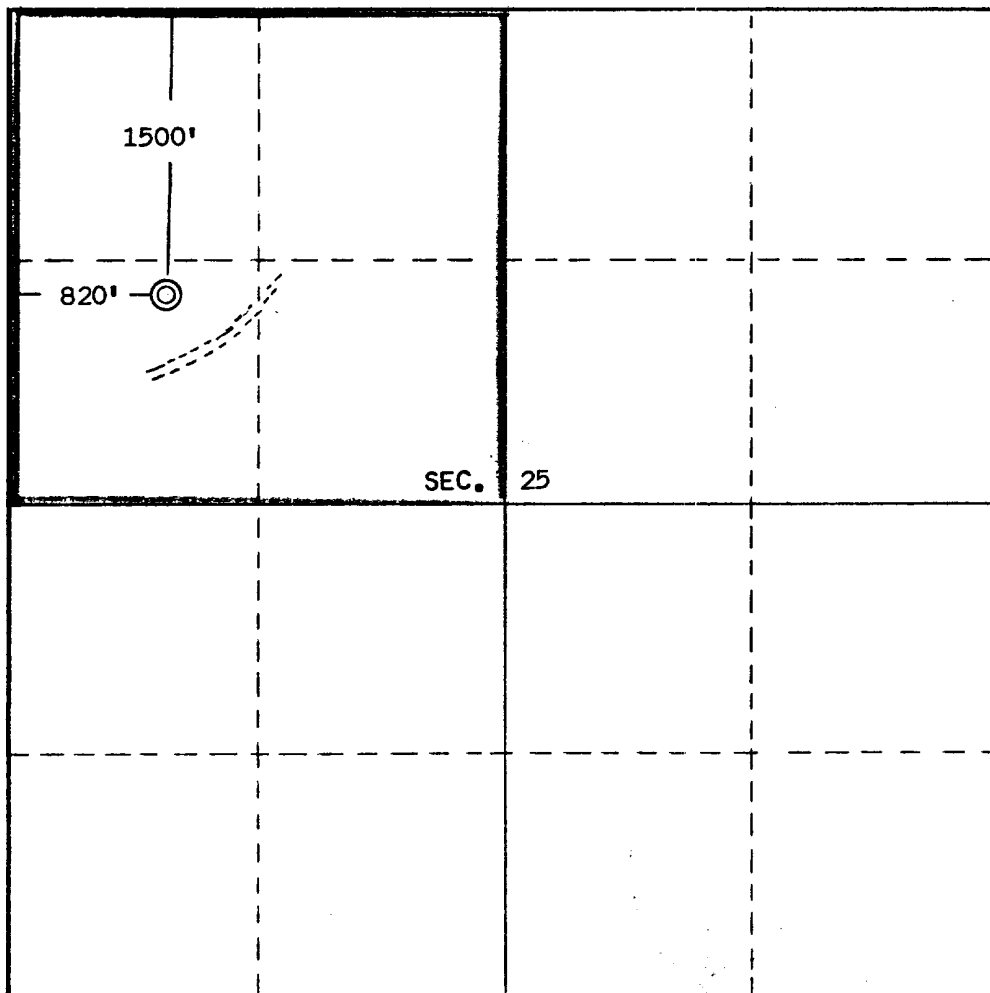

CERTIFICATION

I hereby certify that the information contained herein is true and complete to the best of my knowledge and belief.

Name

Position

Company

Date

I hereby certify that the location shown on this plat was plotted from field notes of actual surveys made by me or under my supervision and that the same is true and correct to the best of my knowledge and belief.

Date Surveyed

Registered Professional Engineer and/or Land Surveyor

Certificate No.

Edgar L. Risenhoover, L.S.

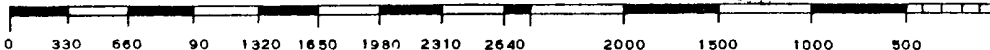

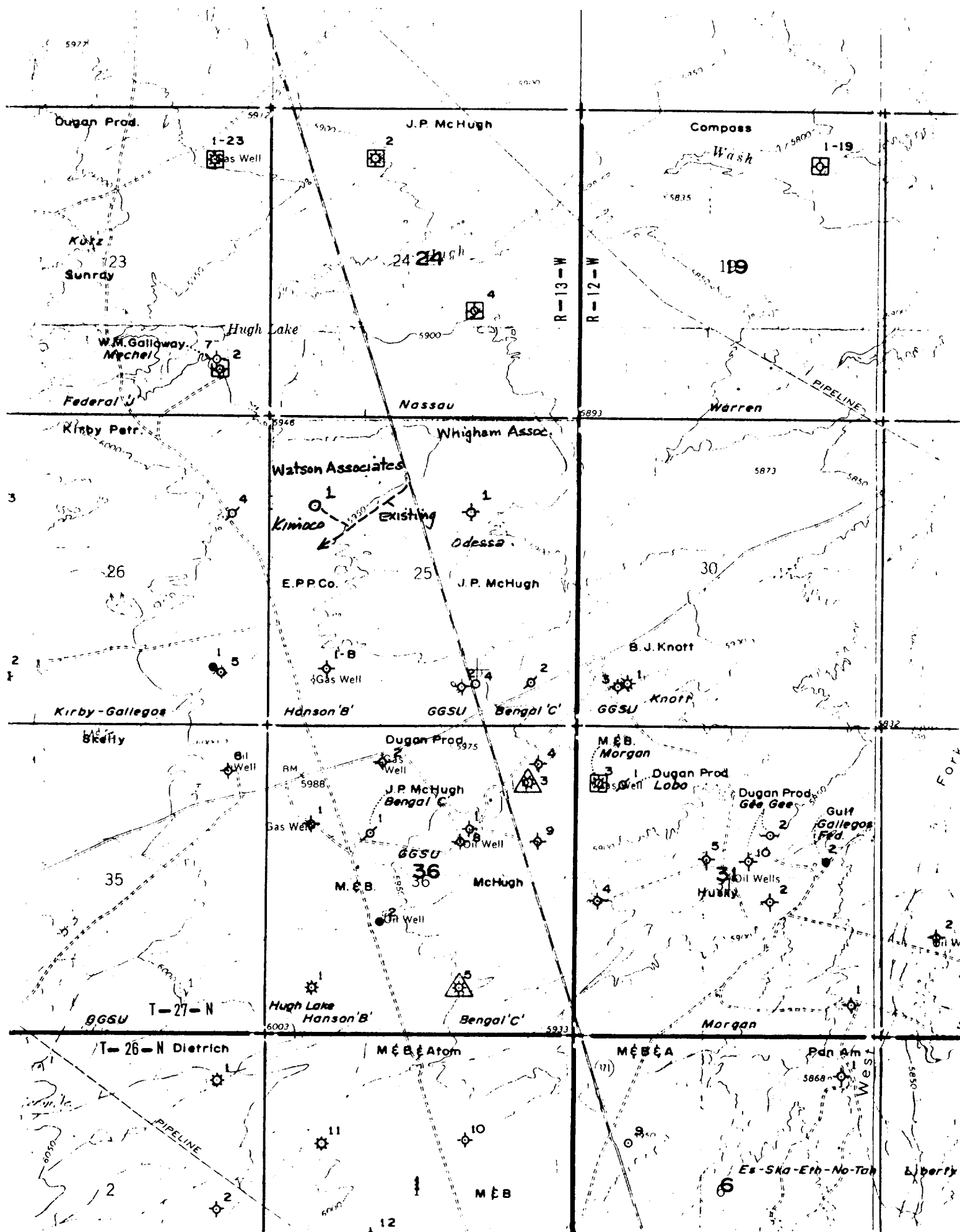

WILLIAM R. SPEER
CONSULTING GEOLOGIST
Petroleum Club Plaza Bldg.
Farmington, New Mexico 87401

P.O. BOX 255 PHONE 505-325-7789

Certified Professional Geologist # 1121
Petroleum and Mineral Evaluation and Management

DEVELOPMENT PLAN FOR SURFACE USE

For proposed Watson Associates #1 Kimoco well located 1500' fr N line, 820' fr W line, Sec. 25, Township 27 North, Range 13 West, N.M.P.M., San Juan County, New Mexico

1. The attached topographic map indicates the proposed location of the well as well as the location of existing roads and existing wells in the immediate area.
2. The proposed location is accessible by existing Highway 371, south of Farmington some 17 miles to within 1700 ft. of the location and by an existing secondary road to within 500 ft. of the location, such that no additional road or location construction is contemplated.
3. The attached rig location layout plan indicates the only dirt work anticipated is the digging to two mud reserve pits, approximately 8'X6'X6' in size, immediately adjacent to the hole. Upon completion of the well all waste materials will be placed in these pits and the pits filled to present terrain level.
4. No additional wells are presently planned on this lease. Should the proposed well prove productive, any production or storage facilities will be installed within a 200 ft. radius of the proposed hole, as dictated by the need of a future tie to a presently-existent gas-gathering system, should the well be gas-productive. The gas-gathering system presently extends to a well in the SE/4SE/4 of the section.
5. Water for drilling the well will be obtained from El Paso Natural Gas Company's Chaco Plant facilities and will be hauled by truck to the location.
6. No permanent camp or airstrip facilities are proposed.
7. Upon completion of the drilling operation, the location will be cleaned up, pits filled, location leveled and any disturbed area not utilized for producing well facilities will be re-seeded as required.
8. The lessee and operator's representative is William R. Speer, P.O. Box 255, Farmington, New Mexico 87401; telephone 325-7789 or 325-2520.

9. Certification:

I hereby certify that I have inspected the proposed drill-site and access route; that I am familiar with the conditions which presently exist; that the statements made in this plan are, to the best of my knowledge, true and correct; and, that the work associated with the operations proposed herein will be performed by me, as agent for Watson Associates, or by their contractors and conditions under which it is approved.

A handwritten signature in cursive script, reading "William R. Speer", is written over a horizontal line.

William R. Speer, Consulting Geologist
for Watson Associates

RIG LOCATION LAYOUT DIAGRAM

for WATSON ASSOCIATES #1 KIMOCO WELL

1500ft. fNI, 820ft. fWI; S25-T27N-R13W
SAN JUAN CO., NEW MEXICO

PROBABLE EXTENT OF
DISTURBED AREA

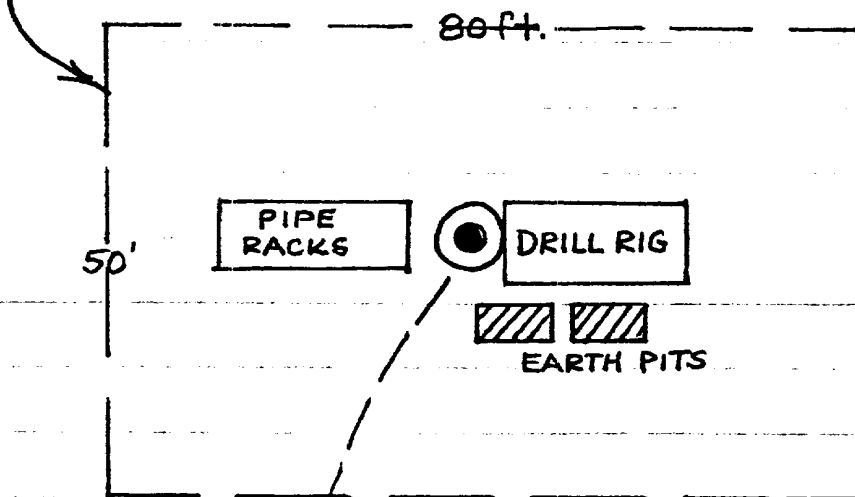

300 ft.

SCALE: 1 INCH = 20 FT.

