

UNITED STATES
DEPARTMENT OF THE INTERIOR
GEOLOGICAL SURVEY

APPLICATION FOR PERMIT TO DRILL, DEEPEN, OR PLUG BACK

1a. TYPE OF WORK

DRILL ☒DEEPEN ☐PLUG BACK ☐

b. TYPE OF WELL

OIL
WELL ☐GAS
WELL ☒

OTHER

SINGLE
ZONE ☒MULTIPLE
ZONE ☐

2. NAME OF OPERATOR

Southern Union Exploration Company

3. ADDRESS OF OPERATOR

First International Bldg., Suite 1800, Dallas, Texas 75270

4. LOCATION OF WELL (Report location clearly and in accordance with any State requirements.*)

At surface

E 1630 FNL & 800 FWL

At proposed prod. zone

Same as above

14. DISTANCE IN MILES AND DIRECTION FROM NEAREST TOWN OR POST OFFICE*

15 miles south of Farmington, New Mexico

15. DISTANCE FROM PROPOSED*

LOCATION TO NEAREST
PROPERTY OR LEASE LINE, FT.
(Also to nearest drig. unit line, if any)

1630

18. DISTANCE FROM PROPOSED LOCATION*
TO NEAREST WELL, DRILLING, COMPLETED,
OR APPLIED FOR, ON THIS LEASE, FT.

800

16. NO. OF ACRES IN LEASE

160

19. PROPOSED DEPTH

1500 Ft.

17. NO. OF ACRES ASSIGNED
TO THIS WELL

160 Acres ✓

20. ROTARY OR CABLE TOOLS

Rotary

21. ELEVATIONS (Show whether DF, RT, GR, etc.)

5823 GL

22. APPROX. DATE WORK WILL START*

9-17-79

23.

PROPOSED CASING AND CEMENTING PROGRAM

| SIZE OF HOLE | SIZE OF CASING | WEIGHT PER FOOT | SETTING DEPTH | QUANTITY OF CEMENT |
|--------------|----------------|-----------------|---------------|--------------------|
| 10 5/8 | 7" | 20 | 300 * | Circulate |
| 5 1/2 | 2 7/8" | 6.50 | 1500 | 775 sacks |

* On 90' of surface casing and cement across the Ojo Alamo behind long string
or cement plug across Ojo Alamo if plugged.

1. We propose to drill to 300' and set 7 inch surface, and cement to the surface.
2. Drill out with 5 1/2 to depth of 1500 feet, then run 2 7/8 tubing and cement to the surface.
3. The Pictured Cliffs Formation will be perforated and evaluated for gas production.
4. 2 7/8" E.U.E., 6.50#, J-55 Tubing will be run and set at approximately 1500 ft. R.K.B.

IN ABOVE SPACE DESCRIBE PROPOSED PROGRAM: If proposal is to deepen or plug back, give location of present productive zone and proposed new productive zone. If proposal is to drill or deepen directionally, give pertinent data on subsurface locations, measured and true vertical depths. Give blowout preventer program, if any.

24.

SIGNED

TITLE

Drilling & Production Eng.

DATE

8/15/79

(This space for Federal or State office use)

PERMIT NO.

APPROVAL DATE

APPROVED BY

TITLE

DATE

CONDITIONS OF APPROVAL, IF ANY:

ok Fmh

NMOC

30-045-23767

5. LEASE DESIGNATION AND SERIAL NO.

N00-C-14-20-5706

6. IF INDIAN, ALLOTTEE OR TRIBE NAME

Indian

7. UNIT AGREEMENT NAME

8. FARM OR LEASE NAME

Susco - Biddoni

9. WELL NO.

#1

10. FIELD AND POOL, OR WILDCAT

WAW Fruitland -
Pictured Cliffs ext11. SEC., T., R., M., OR BLK.
AND SURVEY OR AREA

Sec 32, T27N, R12W

12. COUNTY OR PARISH 13. STATE

San Juan

New Mexico

NEW MEXICO OIL CONSERVATION COMMISSION
WELL LOCATION AND ACREAGE DEDICATION PLAT

Form C-102
Supersedes C-128
Effective 1-1-55

All distances must be from the outer boundaries of the Section.

| | | | | | |
|---|---|-----------------------------|------------------------------------|--|----------------------|
| Operator SOUTHERN UNION EXPLORATION CO. | | | Lease SUSCO BIDDONI | | Well No. 1 |
| Unit Letter E | Section 32 | Township 27 NORTH | Range 12 WEST | County SAN JUAN | |
| Actual Footage Location of Well: 1630 feet from the NORTH line and 800 feet from the WEST line | | | | | |
| Ground Level Elev. 5823 | Producing Formation PICTURED CLIFFS | | Pool NAW PICTURED CLIFFS | Dedicated Acreage: 160 Acres | |

1. Outline the acreage dedicated to the subject well by colored pencil or hachure marks on the plat below.
2. If more than one lease is dedicated to the well, outline each and identify the ownership thereof (both as to working interest and royalty).
3. If more than one lease of different ownership is dedicated to the well, have the interests of all owners been consolidated by communitization, unitization, force-pooling, etc?

☐ Yes ☐ No If answer is "yes," type of consolidation _____

If answer is "no," list the owners and tract descriptions which have actually been consolidated. (Use reverse side of this form if necessary.) _____

No allowable will be assigned to the well until all interests have been consolidated (by communitization, unitization, forced-pooling, or otherwise) or until a non-standard unit, eliminating such interests, has been approved by the Commission.

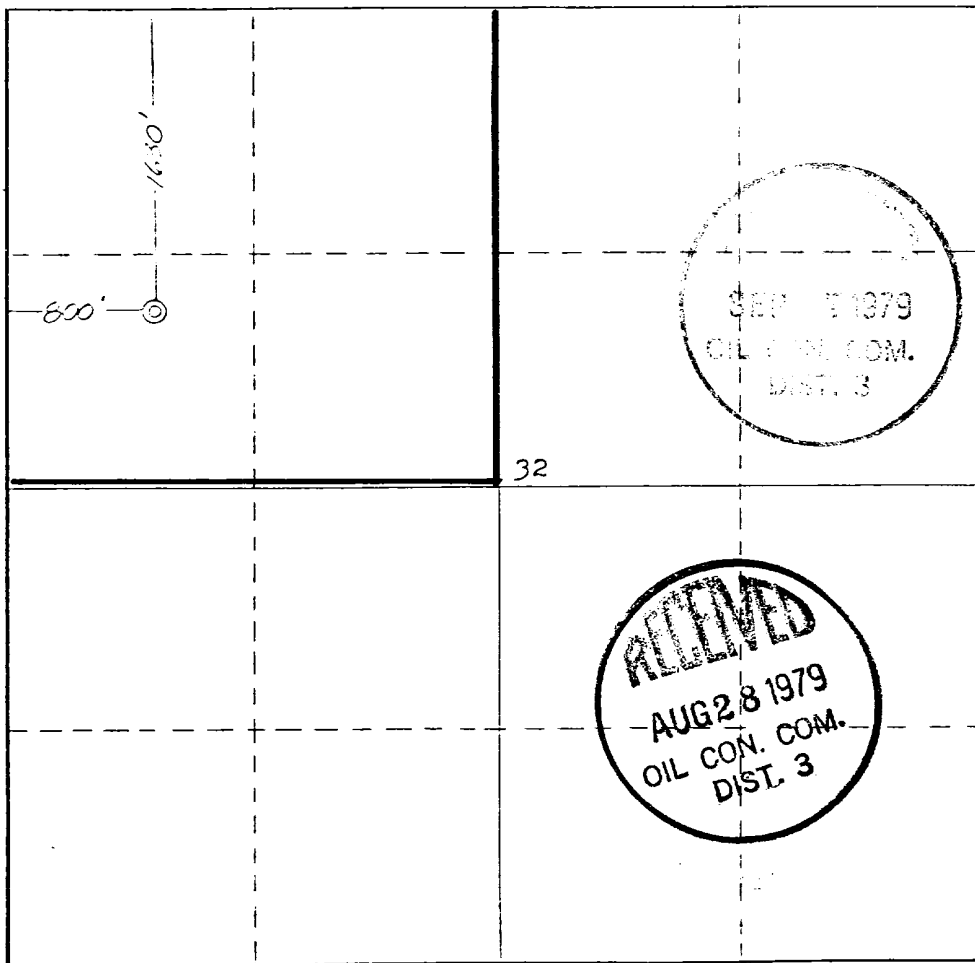

CERTIFICATION

I hereby certify that the information contained herein is true and complete to the best of my knowledge and belief.

Ronald M. Sentz
Name

Ronald M. Sentz

Position

Drilling & Production Engineer

Company

Southern Union Exploration Co.

Date

8/15/79

I hereby certify that the well location shown on this plat was plotted on a field note, actual surveys made by me or under my supervision, and that the same is true and correct to the best of my knowledge and belief.

James P. Leese
Name

Date Surveyed

July 31, 1979

Registered Professional Engineer
and/or Land Surveyor

James P. Leese
Name

Certificate No.

1463



DATE: 10/1/79 BY: [illegible]

September 5, 1979

Mr. A. R. Kendrick
New Mexico Oil Conservation Division
1000 Rio Brazos Road
Aztec, New Mexico 87410

Re: Acreage Dedication

Dear Mr. Kendrick:

SUSCO- Biddoni #1, Section 32, Township 27 North, Range 12 West, 1630'
FNL, 800' FWL. As of this time the acreage has not been dedicated
to any gas transporter.

Sincerely yours,

Ronald M. Sentz
Drilling & Production Engineer

RMS/vgn

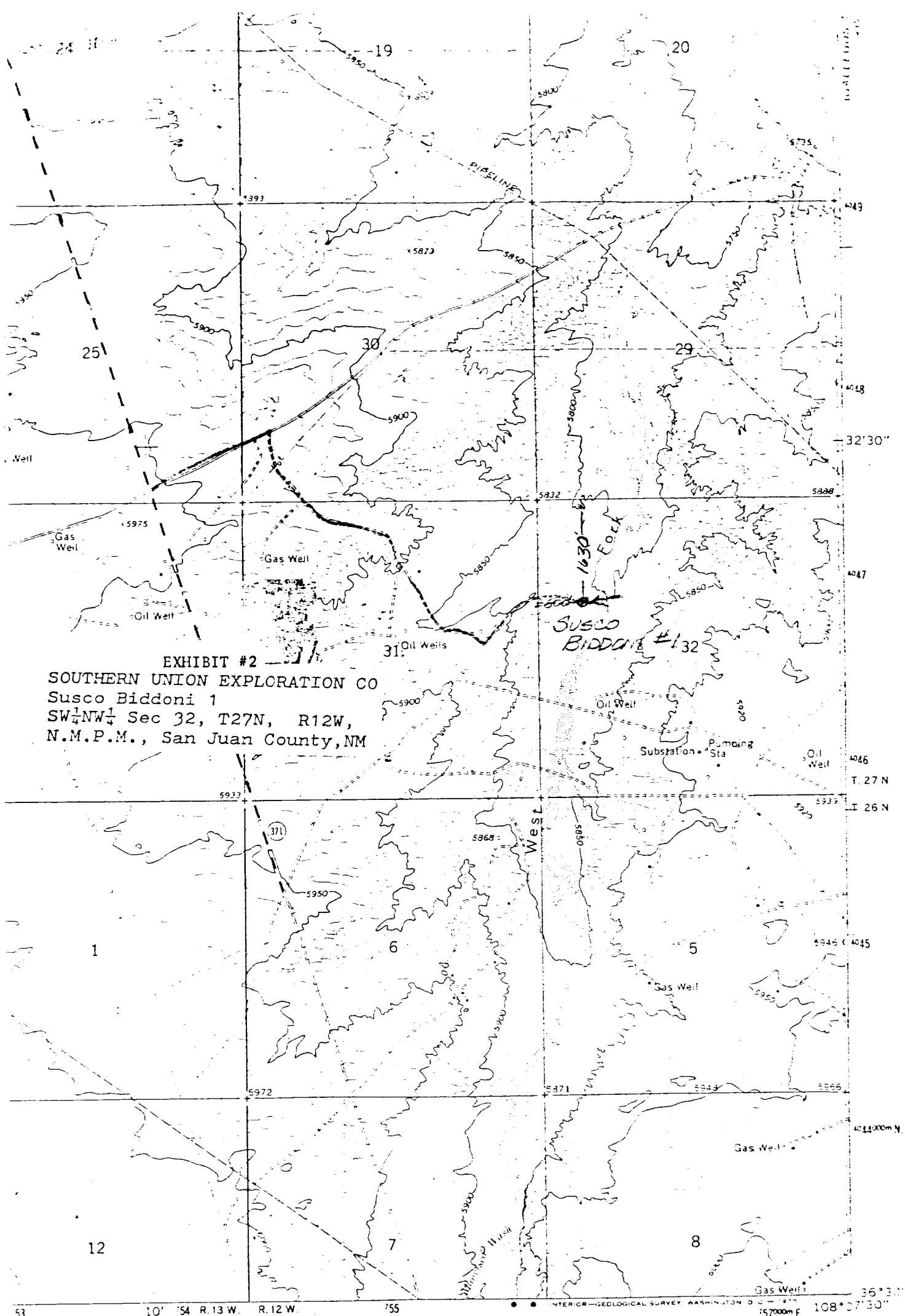

EXHIBIT #2
 SOUTHERN UNION EXPLORATION CO
 Susco Biddoni 1
 SW $\frac{1}{4}$ NW $\frac{1}{4}$ Sec 32, T27N, R12W,
 N.M.P.M., San Juan County, NM

ROAD CLASSIFICATION
 Medium-duty ——— Light-duty ———
 Unimproved dirt =====
 ○ State Route



HUGH LAKE, N. MEX.
 N3630—W10807.5/7.5