

UNITED STATES  
DEPARTMENT OF THE INTERIOR  
GEOLOGICAL SURVEY

APPLICATION FOR PERMIT TO DRILL, DEEPEN, OR PLUG BACK

1a. TYPE OF WORK

DRILL ☒

DEEPEN ☐

PLUG BACK ☐

b. TYPE OF WELL

OIL  
WELL ☐

GAS  
WELL ☒

OTHER

SINGLE  
ZONE ☐

MULTIPLE  
ZONE ☐

2. NAME OF OPERATOR

Dugan Production Corp.

3. ADDRESS OF OPERATOR

Box 208, Farmington, NM 87401

4. LOCATION OF WELL (Report location clearly and in accordance with any State requirements.\*)

At surface

990' FSL - 1650' FEL

At proposed prod. zone

14. DISTANCE IN MILES AND DIRECTION FROM NEAREST TOWN OR POST OFFICE\*

12-1/2 miles south of Farmington, NM

15. DISTANCE FROM PROPOSED\*

LOCATION TO NEAREST

PROPERTY OR LEASE LINE, FT.

(Also to nearest drlg. unit line, if any)

990'

18. DISTANCE FROM PROPOSED LOCATION\*

TO NEAREST WELL, DRILLING, COMPLETED,

OR APPLIED FOR, ON THIS LEASE, FT.

1980'

16. NO. OF ACRES IN LEASE

640

19. PROPOSED DEPTH

1400'

17. NO. OF ACRES ASSIGNED

TO THIS WELL

160

20. ROTARY OR CABLE TOOLS

Rotary

21. ELEVATIONS (Show whether DF, RT, GR, etc.)

6104' GL

22. APPROX. DATE WORK WILL START\*

ASAP

23.

PROPOSED CASING AND CEMENTING PROGRAM

SIZE OF HOLE	SIZE OF CASING	WEIGHT PER FOOT	SETTING DEPTH	QUANTITY OF CEMENT
8-3/4"	7"	20#	90'	35 sx
4-3/4"	2-7/8"	6.4#	1400'	75 sx

Plan to drill 4-3/4" hole to test Pictured CLiffs Fm. Plan to run IES log to TD. If productive, plan to set 2-7/8" tbg for csg, cement, selectively perforate, frac, clean out after frac, run 1-1/4" tbg and complete well.

Plan to use 3000 psi BOP per attached schematic diagram. Will use master valve and stripper head while completing well.

NMERB: Gas not dedicated.



IN ABOVE SPACE DESCRIBE PROPOSED PROGRAM: If proposal is to deepen or plug back, give data on present productive zone and proposed new productive zone. If proposal is to drill or deepen directionally, give pertinent data on subsurface locations and measured and true vertical depths. Give blowout preventer program, if any.

24.

SIGNED Thomas A. Dugan

TITLE Petroleum Engineer

DATE 2-14-79

(This space for Federal or State office use)

PERMIT NO. \_\_\_\_\_

APPROVAL DATE \_\_\_\_\_

APPROVED BY \_\_\_\_\_

TITLE \_\_\_\_\_

CONDITIONS OF APPROVAL, IF ANY:

*ok Smith*

\*See Instructions On Reverse Side

NM000

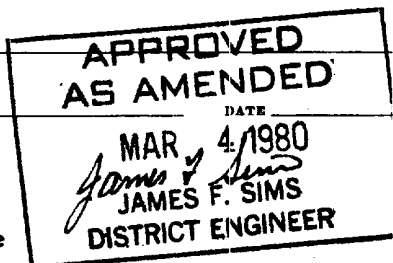

## WELL LOCATION AND ACREAGE DEDICATION PLAT

Supersedes C-12  
Effective 1-1-65

All distances must be from the outer boundaries of the Section.

Operator Dugan Production Corporation		Lease La Lee Ann		Well No. #4
Unit Letter 0	Section 28	Township 27 North	Range 13 West	County San Juan
Actual Footage Location of Well: 990 feet from the South line and 1650 feet from the East line				
Ground Level Elev. 6104	Producing Formation Fruitland PC	Pool WAW	Dedicated Acreage: 160 Acres	

1. Outline the acreage dedicated to the subject well by colored pencil or hachure marks on the plat below.
2. If more than one lease is dedicated to the well, outline each and identify the ownership thereof (both as to working interest and royalty).
3. If more than one lease of different ownership is dedicated to the well, have the interests of all owners been consolidated by communitization, unitization, force-pooling, etc?

☐ Yes ☐ No If answer is "yes," type of consolidation \_\_\_\_\_

If answer is "no," list the owners and tract descriptions which have actually been consolidated. (Use reverse side of this form if necessary.) \_\_\_\_\_

No allowable will be assigned to the well until all interests have been consolidated (by communitization, unitization, forced-pooling, or otherwise) or until a non-standard unit, eliminating such interests, has been approved by the Commission.

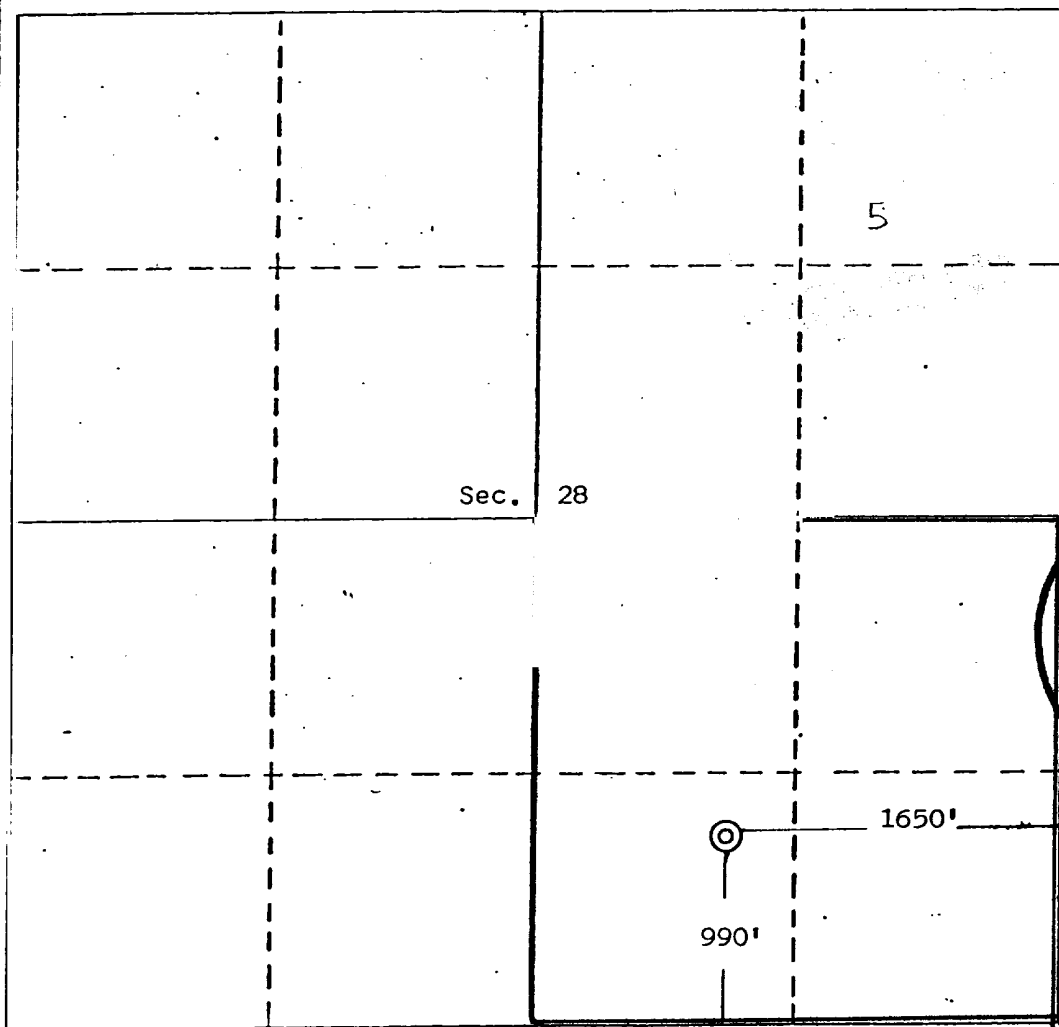

## CERTIFICATION

I hereby certify that the information contained herein is true and complete to the best of my knowledge and belief.

*Thomas A. Dugan*  
Name  
Thomas A. Dugan  
Position  
Petroleum Engineer  
Company  
Dugan Production Corp.  
Date  
2-14-80

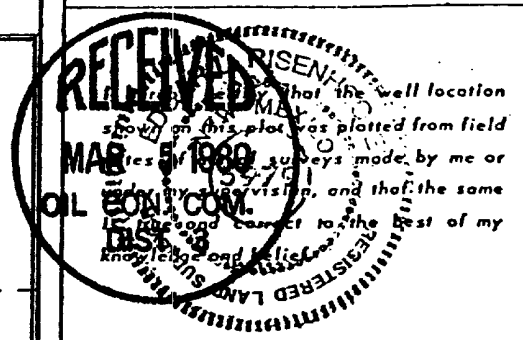

Date Surveyed  
February 12, 1980  
Registered Professional Engineer  
and/or Land Surveyor  
*Edgar L. Risenhoover*  
Certificate No. 5919  
Edgar L. Risenhoover, L.S.